

TP-00935

TP-00935

NOAA FORM 76-35

U.S. DEPARTMENT OF COMMERCE
NATIONAL OCEANIC AND ATMOSPHERIC ADMINISTRATION
NATIONAL OCEAN SURVEY

DESCRIPTIVE REPORT

Type of Survey Shoreline Mapping

Job No. .. CM-7510 Map No. TP-00935

Classification No. III Edition No. ... 1st

LOCALITY

State Ohio

General Locality Lake Erie

Locality Vermilion - on-the lake

1975 TO 19

REGISTRY IN ARCHIVES

DATE

NOAA FORM 76-36A (3-72)		U. S. DEPARTMENT OF COMMERCE NATIONAL OCEANIC AND ATMOSPHERIC ADMIN.	
DESCRIPTIVE REPORT - DATA RECORD		TYPE OF SURVEY <input checked="" type="checkbox"/> ORIGINAL <input type="checkbox"/> RESURVEY <input type="checkbox"/> REVISED	
PHOTOGRAMMETRIC OFFICE Coastal Mapping Division (Rockville)		SURVEY TP. 00935 MAP EDITION NO. (1) MAP CLASS III JOB PH-CM-7510:	
OFFICER-IN-CHARGE Cdr. James Collins		LAST PRECEDING MAP EDITION TYPE OF SURVEY <input type="checkbox"/> ORIGINAL <input type="checkbox"/> RESURVEY <input type="checkbox"/> REVISED JOB PH- MAP CLASS SURVEY DATES: 19__ TO 19__	
I. INSTRUCTIONS DATED			
1. OFFICE		2. FIELD	
Instructions-Aerotriangulation - 10/23/75 Instructions-OFFICE-7/22/76 Memorandum Instructions-VERTICAL DATUM REFERENCES for Map Features, Photogrammetric Surveys, Great Lakes - 7/13/76		Instructions-FIELD-4/15/75	
II. DATUMS			
1. HORIZONTAL: <input checked="" type="checkbox"/> 1927 NORTH AMERICAN		OTHER (Specify)	
2. VERTICAL: <input type="checkbox"/> MEAN HIGH-WATER <input type="checkbox"/> MEAN LOW-WATER <input type="checkbox"/> MEAN LOWER LOW-WATER <input type="checkbox"/> MEAN SEA LEVEL		OTHER (Specify) Lake Erie Low Water Datum on the International Great Lakes Datum 1955	
3. MAP PROJECTION Lambert Conformal Conic		4. GRID(S) STATE Ohio ZONE North	
5. SCALE 1:10,000		STATE ZONE	
III. HISTORY OF OFFICE OPERATIONS			
OPERATIONS		NAME	DATE
1. AEROTRIANGULATION BY METHOD: Analytic LANDMARKS AND AIDS BY		I Raborn	12/75
2. CONTROL AND BRIDGE POINTS PLOTTED BY METHOD: Coradomat CHECKED BY		I Raborn S. Solbeck NA	12/75 12/29/75
3. STEREOSCOPIC INSTRUMENT PLANIMETRY BY COMPILATION CHECKED BY INSTRUMENT: Wild B-8 SCALE: 1:10,000 CONTOURS BY CHECKED BY		L. Harrod G. Vanderhaven NA NA	3/17/77 3/17/77 3/17/77
4. MANUSCRIPT DELINEATION PLANIMETRY BY CHECKED BY METHOD: <i>SMOOTH DRAFTING</i> CONTOURS BY CHECKED BY SCALE: 1:10,000 HYDRO SUPPORT DATA BY CHECKED BY		L. Harrod G. Vanderhaven NA NA NA NA	3/22/77 3/22/77
5. OFFICE INSPECTION PRIOR TO FIELD EDIT BY		G. Fromm	9/19/77
6. APPLICATION OF FIELD EDIT DATA BY CHECKED BY		NA NA	
7. COMPILATION SECTION REVIEW BY		G. FROMM	
8. FINAL REVIEW BY		G. FROMM	12/14/77
9. DATA FORWARDED TO PHOTOGRAMMETRIC BRANCH BY		G. FROMM	1/24/78
10. DATA EXAMINED IN PHOTOGRAMMETRIC BRANCH BY		F.R. WATTS	1/26/78
11. MAP REGISTERED - COASTAL SURVEY SECTION BY		R.T. CATOR	5/1/78

COMPILATION SOURCES

TP-00935

1. COMPILATION PHOTOGRAPHY

CAMERA(S) Wild RC-10(B) Focal length = 152.74 mm		TYPES OF PHOTOGRAPHY LEGEND (C) COLOR (P) PANCHROMATIC (I) INFRARED		TIME REFERENCE	
TIDE STAGE REFERENCE <input type="checkbox"/> PREDICTED TIDES <input checked="" type="checkbox"/> REFERENCE STATION RECORDS <input type="checkbox"/> TIDE CONTROLLED PHOTOGRAPHY				ZONE Eastern MERIDIAN 75th <input checked="" type="checkbox"/> STANDARD <input type="checkbox"/> DAYLIGHT	
NUMBER AND TYPE	DATE	TIME	SCALE	STAGE OF TIDE	
75B(C) 1621 - 1625	4/26/75	1106- 1113	1:25,000	+3.9 Ft. Lake Erie Low Water Datum Cleveland Gauge	

REMARKS The elevation of the Lake Erie Low Water Datum on the International Great Lakes Datum, 1955, is 568.5 ft., Cleveland Gauge.
The above photography was ratioed to 1:10,000 scale.

2. SOURCE OF MEAN HIGH-WATER LINE:

The photography listed above is the source of the shoreline delineated.
Refer to paragraph 35 of the Compilation Report bound with this Descriptive Report.

3. SOURCE OF MEAN LOW-WATER OR MEAN LOWER LOW-WATER LINE:

None

4. CONTEMPORARY HYDROGRAPHIC SURVEYS (List only those surveys that are sources for photogrammetric survey information.)

SURVEY NUMBER	DATE(S)	SURVEY COPY USED	SURVEY NUMBER	DATE(S)	SURVEY COPY USED

5. FINAL JUNCTIONS

NORTH No Contemporary Survey	EAST *TP-00936 & TP-00937	SOUTH No Contemporary Survey	WEST TP-00934
------------------------------------	------------------------------	------------------------------------	------------------

REMARKS *TP-00936 is 1:5,000 scale.

NOAA FORM 76-36C
(3-72)U. S. DEPARTMENT OF COMMERCE
NATIONAL OCEANIC AND ATMOSPHERIC ADMINISTRATION
NATIONAL OCEAN SURVEY

TP-00935

HISTORY OF FIELD OPERATIONS

I. ☒ FIELD INSPECTION OPERATION☐ FIELD EDIT OPERATION

OPERATION	NAME	DATE
1. CHIEF OF FIELD PARTY	W. Bergen	4/22/75
2. HORIZONTAL CONTROL	RECOVERED BY W. Bergen	4/22/75
	ESTABLISHED BY W. Bergen	4/22/75
	PRE-MARKED OR IDENTIFIED BY W. Bergen	4/22/75
3. VERTICAL CONTROL	RECOVERED BY NA	
	ESTABLISHED BY NA	
	PRE-MARKED OR IDENTIFIED BY NA	
4. LANDMARKS AND AIDS TO NAVIGATION	RECOVERED (Triangulation Stations) BY NA	
	LOCATED (Field Methods) BY NA	
	IDENTIFIED BY NA	
5. GEOGRAPHIC NAMES INVESTIGATION	TYPE OF INVESTIGATION	
	<input type="checkbox"/> COMPLETE	
	<input type="checkbox"/> SPECIFIC NAMES ONLY	
	<input checked="" type="checkbox"/> NO INVESTIGATION	NA
6. PHOTO INSPECTION	CLARIFICATION OF DETAILS BY NA	
7. BOUNDARIES AND LIMITS	SURVEYED OR IDENTIFIED BY NA	

II. SOURCE DATA

1. HORIZONTAL CONTROL IDENTIFIED
Pre-marked2. VERTICAL CONTROL IDENTIFIED
None

PHOTO NUMBER	STATION NAME	PHOTO NUMBER	STATION DESIGNATION
75-B(C)2058	Brownhelm USLS 1877 (Sub Sta A)		

3. PHOTO NUMBERS (Clarification of details)

None

4. LANDMARKS AND AIDS TO NAVIGATION IDENTIFIED

None

PHOTO NUMBER	OBJECT NAME	PHOTO NUMBER	OBJECT NAME

5. GEOGRAPHIC NAMES: ☐ REPORT ☒ NONE6. BOUNDARY AND LIMITS: ☐ REPORT ☒ NONE

7. SUPPLEMENTAL MAPS AND PLANS

None

8. OTHER FIELD RECORDS (Sketch books, etc. DO NOT list data submitted to the Geodesy Division)

One Control Station Identification Card (NOAA Form 76-53)

NOAA FORM 76-36C
(3-72)

NOAA FORM 76-36D
(3-72)U. S. DEPARTMENT OF COMMERCE
NATIONAL OCEANIC AND ATMOSPHERIC ADMINISTRATION

RECORD OF SURVEY USE

TP-00935

I. MANUSCRIPT COPIES

COMPILATION STAGES			DATE MANUSCRIPT FORWARDED	
DATA COMPILED	DATE	REMARKS	MARINE CHARTS	HYDRO SUPPORT
Compilation complete pending field edit.		Class III Map Field edit postponed.		
<i>FINAL REVIEW PRIOR TO REGISTRATION</i>	<i>1-26-78</i>	<i>CLASS III MAP</i>		

II. LANDMARKS AND AIDS TO NAVIGATION

1. REPORTS TO MARINE CHART DIVISION, NAUTICAL DATA BRANCH

NUMBER	CHART LETTER NUMBER ASSIGNED	DATE FORWARDED	REMARKS
		<i>3/31/78</i>	<i>ONE PAGE OF DIGITIZED FORM 76-40 WAS SUBMITTED TO MARINE CHART DIVISION AS FINAL REPORT.</i>
			<i>THE COMPUTER CARDS FOR ALL 76-40 LAND- MARKS AND AIDS TO NAVIGATION ARE ON FILE IN THE CMD, SPECIAL PROJECTS SECTION, AND WILL BE DESTROYED 5 YEARS AFTER THE DATE OF FINAL REVIEW.</i>

2. ☐ REPORT TO MARINE CHART DIVISION, COAST PILOT BRANCH. DATE FORWARDED: _____3. ☐ REPORT TO AERONAUTICAL CHART DIVISION, AERONAUTICAL DATA SECTION. DATE FORWARDED: _____

III. FEDERAL RECORDS CENTER DATA

1. ☒ BRIDGING PHOTOGRAPHS; ☒ DUPLICATE BRIDGING REPORT; ☒ COMPUTER READOUTS.
 2. ☒ CONTROL STATION IDENTIFICATION CARDS; ☐ FORM NOS 567 SUBMITTED BY FIELD PARTIES.
 3. ☒ SOURCE DATA (except for Geographic Names Report) AS LISTED IN SECTION II, NOAA FORM 76-36C.
 ACCOUNT FOR EXCEPTIONS:

4. ☐ DATA TO FEDERAL RECORDS CENTER. DATE FORWARDED: _____

IV. SURVEY EDITIONS (This section shall be completed each time a new map edition is registered)

SECOND EDITION	SURVEY NUMBER TP - _____ (2)	JOB NUMBER PH - _____	TYPE OF SURVEY <input type="checkbox"/> REVISED <input type="checkbox"/> RESURVEY MAP CLASS <input type="checkbox"/> II. <input type="checkbox"/> III. <input type="checkbox"/> IV. <input type="checkbox"/> V. <input type="checkbox"/> FINAL
	DATE OF PHOTOGRAPHY	DATE OF FIELD EDIT	
THIRD EDITION	SURVEY NUMBER TP - _____ (3)	JOB NUMBER PH - _____	TYPE OF SURVEY <input type="checkbox"/> REVISED <input type="checkbox"/> RESURVEY MAP CLASS <input type="checkbox"/> II. <input type="checkbox"/> III. <input type="checkbox"/> IV. <input type="checkbox"/> V. <input type="checkbox"/> FINAL
	DATE OF PHOTOGRAPHY	DATE OF FIELD EDIT	
FOURTH EDITION	SURVEY NUMBER TP - _____ (4)	JOB NUMBER PH - _____	TYPE OF SURVEY <input type="checkbox"/> REVISED <input type="checkbox"/> RESURVEY MAP CLASS <input type="checkbox"/> II. <input type="checkbox"/> III. <input type="checkbox"/> IV. <input type="checkbox"/> V. <input type="checkbox"/> FINAL
	DATE OF PHOTOGRAPHY	DATE OF FIELD EDIT	

JOB CM-7510 VERMILION TO FAIRPORT HARBOR

OHIO
SHORELINE MAPPING
SCALE 1"=5,000
1"=10,000
1"=20,000

OFFICIAL MILEAGE FOR COST ACCOUNTS

SHEET NO.	SQ. MILES	SHEET NO.	SQ. MILES
TP-00934	4	TP-00942	9
TP-00935	5	TP-00943	5
TP-00936	2	TP-00944	6
TP-00937	6	TP-00945	8
TP-00938	6	TP-00946	7
TP-00939	4	TP-00947	3
TP-00940	2	TP-00948	5
TP-00941	9	TP-00949	4
		TOTAL	87

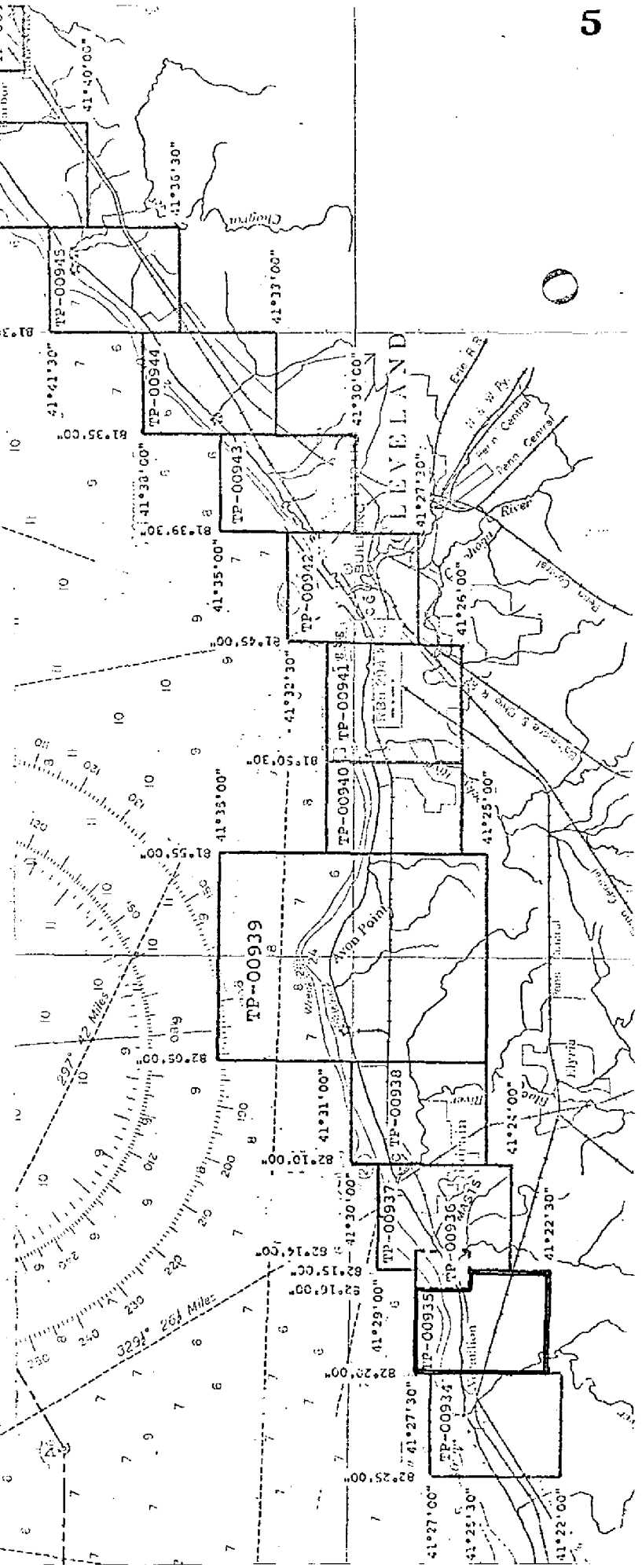

SUMMARY
TP-00934 thru TP-00949

The purpose of this survey is to provide shoreline maps for nautical chart compilation and maintenance. Sixteen maps were compiled along the southern shoreline of Lake Erie from Vermilion to Fairport Harbor, Ohio. Coverage of this area includes four 1:5,000 scale (TP-00936, TP-00947 through TP-00949), eleven 1:10,000 scale (TP-00934, TP-00935, TP-00937, TP-00938, TP-00940 through TP-00946), and one 1:20,000 scale (TP-00939), maps.

Field operations, beginning in April 1975, consisted of premarking control and aerial photography. There was no field inspection of the shoreline prior to compilation.

Eleven strips of natural color photography were furnished. Three strips 1:40,000 scale were flown in May 1975. Five strips 1:25,000 scale and three strips 1:15,000 were flown in April 1975. All photography was taken with the Wild RC-10 (B) camera.

The furnished photography was bridged by analytic aerotriangulation methods and adjusted to ground on the Ohio North State Plane Coordinate System. Ten horizontal control stations and vertical control from USGS quadrangles were weighted in the strip adjustments. This work was done in December 1975 and provided the horizontal and vertical control for compilation.

Compilation was performed in the Special Projects Section (Rockville) during the period from October 1976 through November 1977. All maps were compiled using Wild B-8 stereoplotters. Maps are based on office interpretation of the mapping photography. Landmarks and aids to navigation were not investigated by a field party.

Field edit was postponed in November 1977.

Final review was completed in the Rockville office in December 1977. Maps were found to be satisfactory and meet the National Map Standards of Accuracy.

A Descriptive Report for each map was prepared and contains all pertinent reports and listings of all data used to complete the map.

FIELD INSPECTION

There was no field inspection prior to compilation. Field work accomplished was limited to the recovery and identification of horizontal control necessary for aerotriangulation.

CM-7510



U.S. DEPARTMENT OF COMMERCE
National Oceanic and Atmospheric Administration
NATIONAL OCEAN SURVEY

Lake Survey Center
630 Federal Bldg. & U.S. Crthse
Detroit, MI 48226

Date : May 1, 1975

Reply to Attn. of: CLS113

To : Chief, Surveys Branch (CLS11)

From : Chief, Horizontal Control Section (CLS113)

Subject: Summary Report of Results under Project OPR - 302 - 2 - 75: Photogrammetric Aerotriangulation Control and Paneling Support

1. Objective 2.1 of Project Instructions OPR - 302 - 2 - 75 has been completed in full as required. A summary of the results of this phase of the project are contained herein.
2. Objectives 2.2 and 2.3 will be completed pending final flight plans (expected during the week of May 5th); any effect upon the first phase of this project will be reported accordingly.
3. All designated photo control stations (or substations) were premarked and geodetically positioned in the prescribed manner as directed under the technical provisions of the Project Instructions; accomplished during the period 21 through 27 April 1975. Control Station Identification cards (NOAA Form 76-53) are attached to this report. Position computations for each photo control point/panel were completed in the field and verified in the office. A complete listing of the final coordinates of each of the photo control points is attached.
4. All costs incurred on this project were charged to C11130-83222302.
5. Recovery Notes were written on four NGS published horizontal control stations and will be transmitted to NGS prior to May 31, 1975.
6. No unusual problems were encountered during the field operations associated with this project. The only major deviation from the original project directives was that of substituting station ARP 1966 for station BELL CRGS, 1943; with approval received by telecon from CLS11.
7. Compilation photography for this area was flown on April 26, 1975; at which time all panels were in place except HUNTINGTON Substation A.

Encl: Geographic Coordinates of all Photo Control Points
CSI Cards (11)
Office Position Computations

PHOTO CONTROL POINT COORDINATES OPR-302-2-75

Number	Station	Latitude			Longitude		
		'	"		'	"	
1	BACON LSC, 1974 Substation A (Paneled)	41	46	36.4645 ✓	81	12	22.9039 ✓
2	FALL IN LSC, 1974 Substation A (Paneled)	41	41	32.7575 ✓	81	24	40.2361 ✓
3	MOSS POINT LSC, 1973 SUBSTATION A (Paneled)	41	36	49.2287 ✓	81	31	47.0421 ✓
4	ARP 1966 Marked direct by panel	41	31	01.6580 ✓	81	41	03.7410 ✓
5	WILBUR WRIGHT CRGS, 1943 Substation A (Paneled)	41	27	36.7428 ✓	81	45	48.5900 ✓
6	HUNTINGTON LSC, 1973 Substation A (Paneled)	41	29	24.4997 ✓	81	55	32.3346 ✓
7	SHEFFIELD LAKE LSC, 1973 Substation A (Paneled)	41	29	21.3807 ✓	82	06	46.3737 ✓
8 ✕	ELYRIA H2O LSC, 1973 Substation A (Paneled)	41	27	17.2863 ✓	82	12	54.7748 ✓
9 ✓	BROWNHELM USLS, 1877 Substation A (Paneled)	41	23	16.9177 ✓	82	18	24.6186 ✓
10 ✓	CEYLON, 1956 Substation A (Paneled)	41	23	03.7880 ✓	82	27	39.9497 ✓
11	ROCKY RIVER LSC, 1973 Substation A (Paneled)	41	29	23.7748 ✓	81	50	10.7997 ✓
	Substation B (Pict Point)	41	29	23.6499 ✓	81	50	08.5599 ✓

Photogrammetric Plot Report
Vermilion to Fairport Harbor, Ohio
December 1975

21. Area Covered: This report pertains to the shoreline of Lake Erie from Vermilion to Fairport Harbor, Ohio. This area is covered by four 1:5,000 scale sheets, TP-00936, TP-00947 thru TP-00949, eleven 1:10,000 scale sheets, TP-00934, TP-00935, TP-00937, TP-00938, TP-00940 thru TP-00946, and one 1:20,000 scale sheet TP-00939.

22. Method: Three strips (see sketch) of 1:40,000 scale color photography were bridged by analytic aerotriangulation methods. The three strips were controlled by field identified control paneled in 1975. Five strips of 1:25,000 scale color photography and three strips of 1:15,000 scale color photography were also bridged by analytic aerotriangulation methods. These strips were controlled by common points from the 1:40,000 scale photography. Ties were made between all bridging strips. Points were established for determining ratios for the 1:25,000 and 1:15,000 scale color photography. Ratios were ordered on December 23, 1975, for field edit only. Data for ruling projections were furnished to the Coradomat to be plotted on the Ohio North Plane Coordinate System.

23. Adequacy of Control: The control was adequate with the inclusion of office identified control as checks. Horizontal control station (Elyria H₂O LSC 1973, SS"A") did not meet the National Map Accuracy Standards. This station did hold the bridge adjustment by 6 feet in X and 26 feet in Y. No reason could be determined for the error.

24. Supplemental Data: USGS quadrangles were used to provide vertical control for the adjustment. Lake Survey Charts were also used to assist in locating aids to navigation. These aids were photogrammetrically located and should be field checked.

25. Photography: The photography was adequate as to coverage, overlap and definition.

Respectfully submitted,

Ivey O. Raborn
Ivey O. Raborn

Approved and forwarded:

John D. Perrow, Jr.
John D. Perrow, Jr.

Chief, Aerotriangulation Section

NOTES TO COMPILER

Do not set models 1635 and 1636 on strip 23 and also 1617 and 1618 on strip 24. They were deleted from the job because of overlap in coverage. All aids and landmarks that were located were converted to G.P.'s and a listing was furnished. Identification of the aids by number was made on the photos and charts of the area.

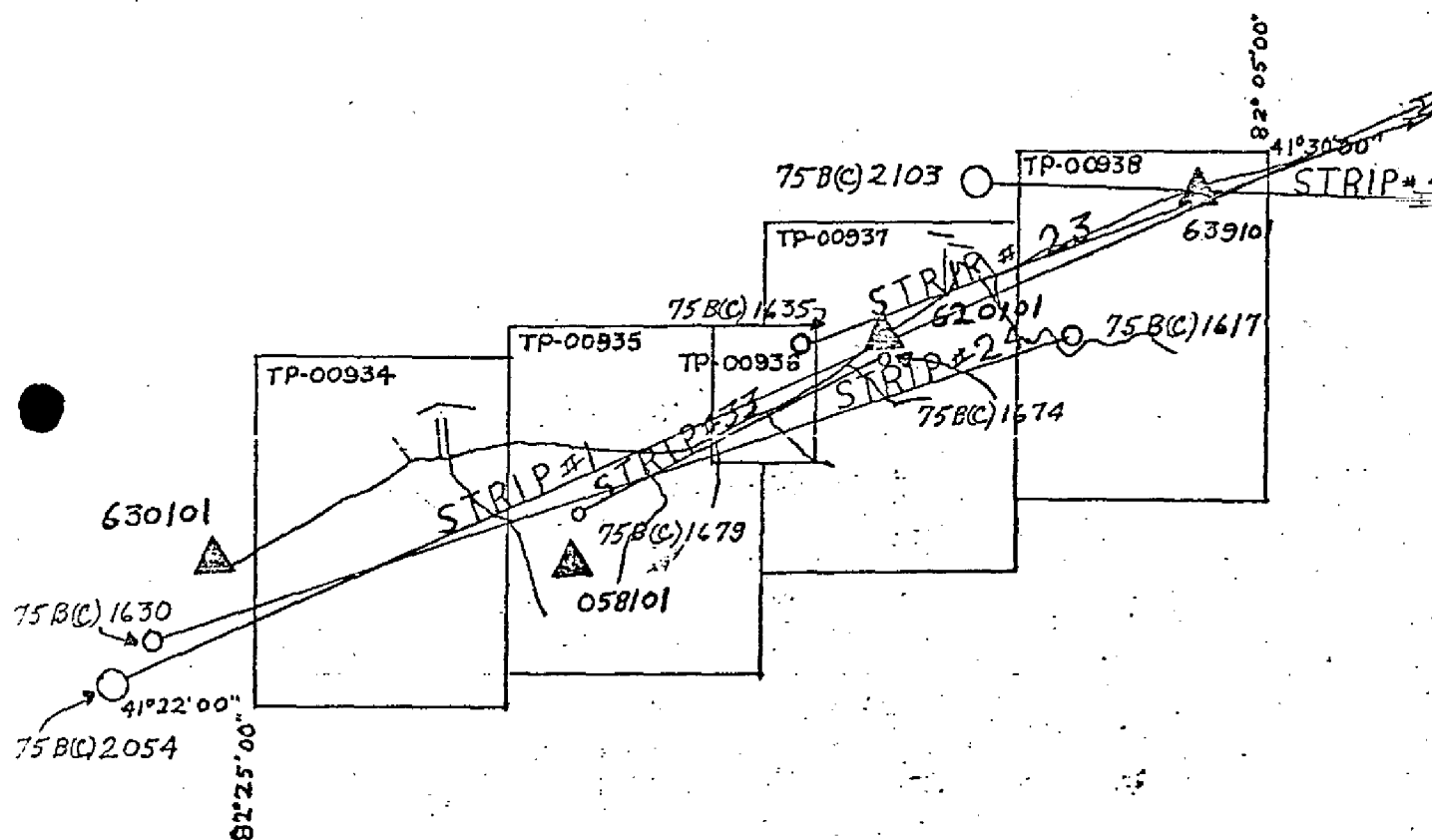

JOB CM-7510
VERMILION TO FAIRPORT HARBOR
OHIO

- 1:40,000
- 1:25,000
- 1:5,000

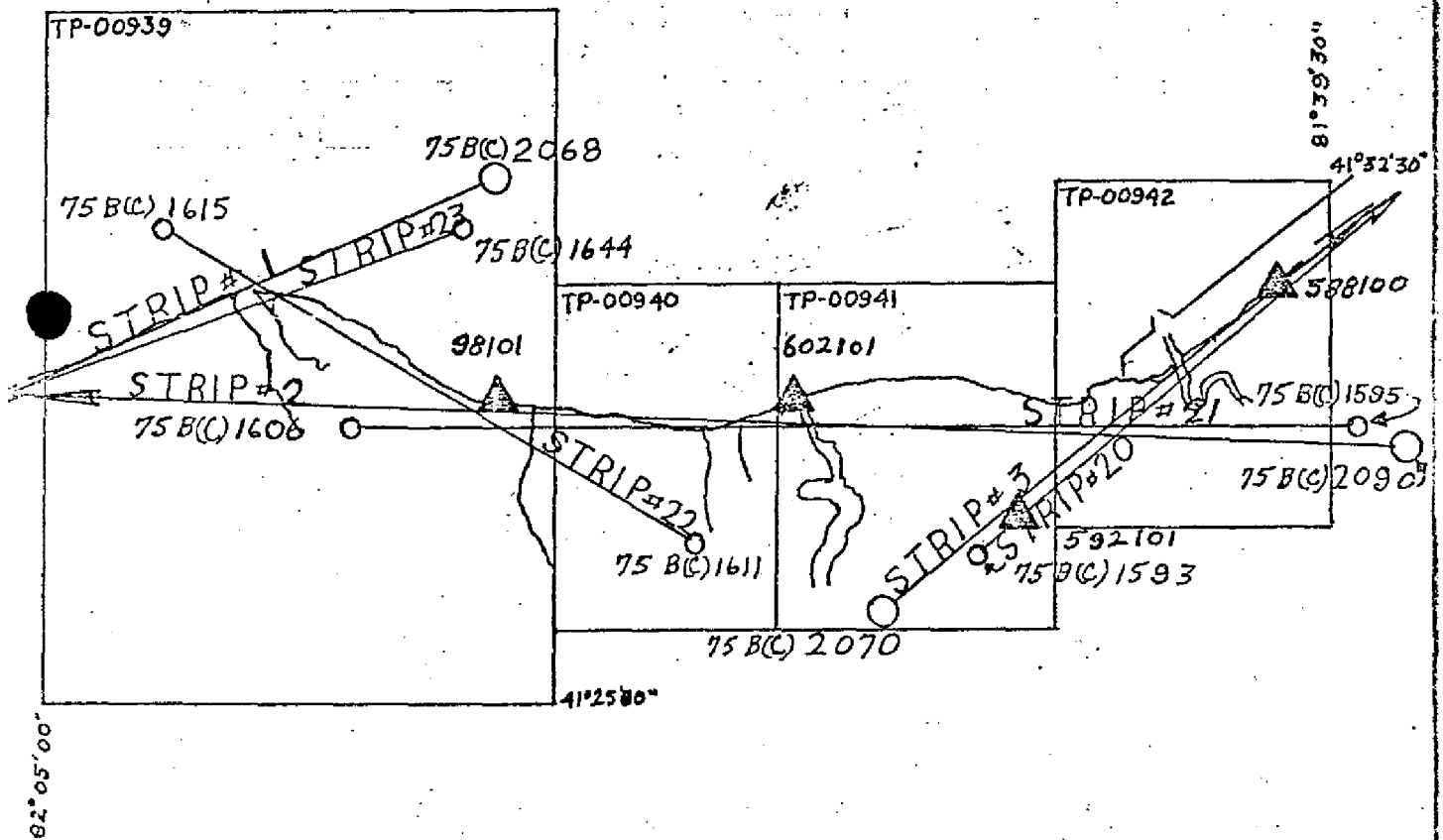

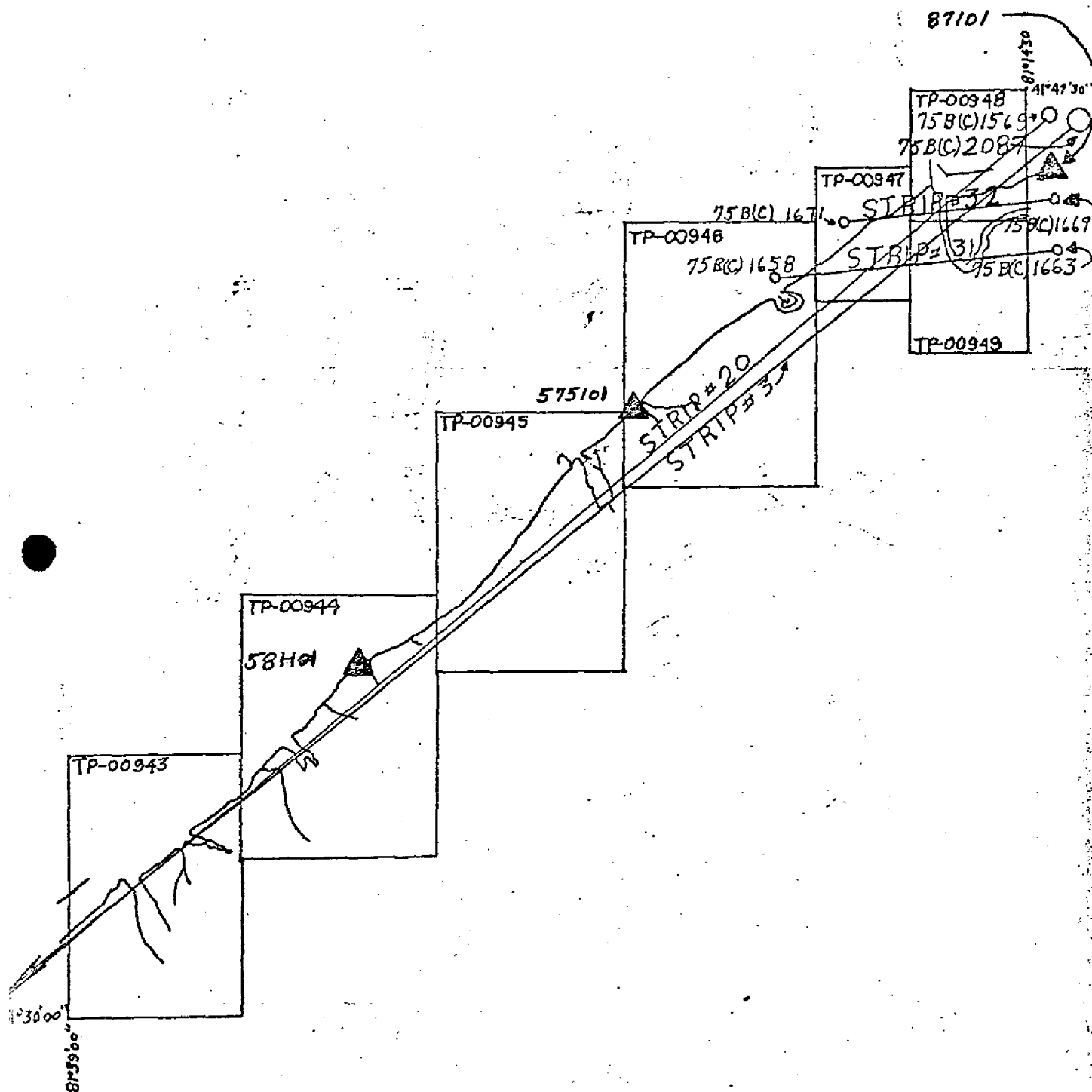

DESCRIPTIVE REPORT CONTROL RECORD

MAP NO.	JOB NO.	SOURCE OF INFORMATION (Index)	AEROTRI-ANGULATION POINT NUMBER	COORDINATES IN FEET		GEOGRAPHIC POSITION		ORIGINATING ACTIVITY
				STATE	ZONE	ϕ LATITUDE	λ LONGITUDE	
TP-00935	CM-7510							
BROWNHELM USLS 1877		Sta 410822	058100	X=		ϕ	41-23-15.39939	
		Sta 1001		Y=		λ	82-18-28.08724	
				X=		ϕ		
				Y=		λ		
				X=		ϕ		
				Y=		λ		
				X=		ϕ		
				Y=		λ		
				X=		ϕ		
				Y=		λ		
				X=		ϕ		
				Y=		λ		
				X=		ϕ		
				Y=		λ		
				X=		ϕ		
				Y=		λ		
COMPUTED BY				COMPUTATION CHECKED BY				DATE
LISTED BY	G. Vandenberg			LISTING CHECKED BY				DATE 9/12/77
HAND PLOTTING BY				HAND PLOTTING CHECKED BY				DATE

TP-00935
Compilation Report

31. Delineation

This map was compiled on the Wild B-8 Stereoplotter using 1:25,000 scale natural color photography taken in 1975. A portion of this manuscript is shown on TP-00936, scale 1:5,000.

32. Control

Refer to the Photogrammetric Plot Report bound with this Descriptive Report.

The identification, density, and placement of horizontal and vertical control was adequate.

33. Supplemental Data

None

34. Contours and Drainage

All drainage is from office interpretation of the color photography.

35. Shoreline and Alongshore Details

The shoreline was compiled by office interpretation of the color photography. The shoreline datum is the lake level at the time of photography.

Alongshore and foreshore features were delineated by office interpretation of the same photography.

There was no preliminary field inspection of the shoreline.

36. Offshore Detail

No unusual problems were encountered in compiling details offshore.

37. Landmarks and Aids

Refer to the 76-40 listing bound with this Descriptive Report for the charted landmark identified from the compilation photography. No fixed aids to navigation fall within the compilation limits of this map.

38. Control for Future Surveys

No form 524 was submitted.

39. Junctions

Refer to form 76-36B, Item #5, of the Descriptive Report.

40. Horizontal and Vertical Accuracy

No comment.

41. thru 45.

Inapplicable

46. Comparison with Existing Maps

A comparison was made with the following USGS quadrangle(s):

Vermilion East, Ohio, 1:24,000, 1969 edition.

No significant differences were noted.

47. Comparison with Nautical Charts

A comparison was made with the following charts:

14826 (formerly LS-35) 20th edition dated 2/18/75, 1:80,000 scale.

Items to be Applied to Nautical Charts Immediately - None

Items to be Carried Forward - None

Submitted by,



Lloyd Harrod

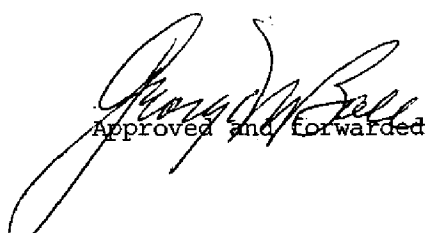

Approved and forwarded:

NOAA FORM 75-74 (7-75)		U.S. DEPARTMENT OF COMMERCE NOAA NATIONAL OCEAN SURVEY	
PHOTOGRAMMETRIC OFFICE REVIEW			
TP - 00935			
1. PROJECTION AND GRIDS GF	2. TITLE GF	3. MANUSCRIPT NUMBERS GF	4. MANUSCRIPT SIZE GF
CONTROL STATIONS			
5. HORIZONTAL CONTROL STATIONS OF THIRD-ORDER OR HIGHER ACCURACY N/A	6. RECOVERABLE HORIZONTAL STATIONS OF LESS THAN THIRD-ORDER ACCURACY (Topographic stations) GF		7. PHOTO HYDRO STATIONS N/A
8. BENCH MARKS N/A	9. PLOTTING OF SEXTANT FIXES N/A	10. PHOTOGRAMMETRIC PLOT REPORT GF	11. DETAIL POINTS GF
ALONGSHORE AREAS (Nautical Chart Data)			
12. SHORELINE GF	13. LOW-WATER LINE N/A	14. ROCKS, SHOALS, ETC. GF	15. BRIDGES GF
16. AIDS TO NAVIGATION None	17. LANDMARKS GF	18. OTHER ALONGSHORE PHYSICAL FEATURES GF	19. OTHER ALONGSHORE CULTURAL FEATURES GF
PHYSICAL FEATURES			
20. WATER FEATURES GF		21. NATURAL GROUND COVER N/A	22. PLANETABLE CONTOURS N/A
23. STEREOSCOPIC INSTRUMENT CONTOURS N/A	24. CONTOURS IN GENERAL N/A	25. SPOT ELEVATIONS N/A	26. OTHER PHYSICAL FEATURES GF
CULTURAL FEATURES			
27. ROADS GF	28. BUILDINGS GF	29. RAILROADS GF	30. OTHER CULTURAL FEATURES GF
BOUNDARIES			
31. BOUNDARY LINES N/A		32. PUBLIC LAND LINES N/A	
MISCELLANEOUS			
33. GEOGRAPHIC NAMES GF		34. JUNCTIONS GF	35. LEGIBILITY OF THE MANUSCRIPT GF
36. DISCREPANCY OVERLAY GF	37. DESCRIPTIVE REPORT GF	38. FIELD INSPECTION PHOTOGRAPHS N/A	39. FORMS GF
40. REVIEWER G. Fromm		SUPERVISOR, REVIEW SECTION OR UNIT G. Ball, Special Projects Section	
41. REMARKS (See attached sheet)			
FIELD COMPLETION ADDITIONS AND CORRECTIONS TO THE MANUSCRIPT			
42. Additions and corrections furnished by the field completion survey have been applied to the manuscript. The manuscript is now complete except as noted under item 43.			
COMPILER		SUPERVISOR	
43. REMARKS			

REVIEW REPORT TP-00935

Shoreline Mapping - Chart Compilation

December 1977

61. General Statement

The map was reviewed in its Class III stage by the Special Projects Section (Rockville). The Descriptive Report contains all of the pertinent information which may be required by users of this map.

62. Comparison with Registered Topographic Surveys - None63. Comparison with Maps of Other Agencies

Refer to the Compilation Report, paragraph 46, bound with this Descriptive Report.

64. Comparison with Contemporary Hydrographic Surveys - None65. Comparison with Nautical Charts

Refer to the Compilation Report, paragraph 47, bound with this Descriptive Report.

66. Adequacy of Results and Future Surveys

This map meets the National Standards of Map Accuracy and complies with compilation instructions and Bureau requirements.

Submitted by:

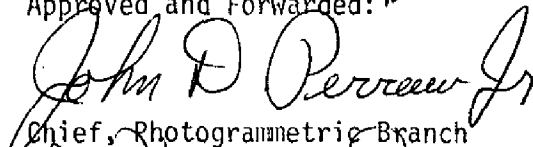

Gregory Fromm

Approved and Forwarded: ^{BW}

Chief, Photogrammetric Branch



Chief, Coastal Mapping Division

December 5, 1977

GEOGRAPHIC NAMES

FINAL NAME SHEETS

CM-7510 (Vermilion to Fairport Harbor, Ohio)

TP-00935

- Brownhelm Creek
- Conrail (RR)
- Lake Erie
- Norfolk & Western ^{RY} (RR)
- Sunnyside
- Vermilion-on-the-Lake
- Vermilion River

Approved by:

Charles E. Harrington
Staff Geographer - C51x2



January 31, 1978

TO: Chief, Photogrammetric Branch

FROM: James Collins (signed) James Collins
Chief, Coastal Mapping Division

SUBJECT: Registration of Job CM-7510, Vermilion Harbor to Fairport
Harbor, Ohio

The subject job comprising one map at 1:20,000 scale, eleven maps
at 1:10,000 scale and four maps at 1:5,000 scale has been compiled
by the Special Projects Section.

No field edit will be obtained for the above maps and you are hereby
instructed to register this job as Class III maps.

Attachment

cc: C3442
C3421



CM-7510
National Archives

Brown Jacket

Computer Readouts
Photogrammetric Plot Report (Duplicate copy)
NOAA Forms 76-53 (Control Station Identification Cards)
Control Index Diagram
NOAA 76-41 Forms (Prepared by Aerotriangulation activity)

Bridging Photography

Job Completion Report

76-40 Listings (Landmarks and Fixed Aids)

Photography (DIAPOSITIVES ONLY)

Strip #1 75B(C) 2053-2068	1:40,000
#2 75B(C) 2090-2104	"
#3 75B(C) 2069-2089	"
Strip #20 75B(C) 1567-1593	1:25,000
#21 75B(C) 1594-1607	"
#22 75B(C) 1608-1616	"
#23 75B(C) 1634-1645	"
#24 75B(C) 1617-1633	"
Strip #31 75B(C) 1656-1665	1:15,000
#32 75B(C) 1666-1673	"
#33 75B(C) 1674-1680	"
#32 (Reject) 75B(C) 1647-1655	1:15,000

LISTING COASTAL MAPPING DIVISION

* SVY	TP-00935	*	LANDMARKS FOR CHARTS	* RPT UNIT	CMD ROCKVILLE, MD.	* PAGE 1 OF 1	*
* JOB	CM-7510	*	TO BE REVISED	STATE	OHIO		*
* PRJ	LAKE ERIE	*		LOCALITY	VERMILION ON THE L	* ORIGINATING ACTIVITY	*
* DTM	NA 1927	*		DATE	11/01/77	* COMPILATION	*
* THE FOLLOWING OBJECTS HAVE NOT BEEN INSPECTED FROM SEAWARD TO DETERMINE THEIR VALUE AS LANDMARKS *							
* CHARTING*	RECORD REASON FOR DELETION	*	DESCRIPTION	* POSITION	CMD *	METHOD AND DATE	*
* NAME	PUT TRIANGULATION NAMES IN ()	*		LATITUDE	ALTEK*	OF LOCATION	* CHARTS
		*		LONGITUDE	DP	OFFICE	* FIELD
		*					* AFFECTED *

[illegible]

TYPE OF ACTION	NAMES OF RESPONSIBLE PERSONNEL	ORIGINATOR
POSITIONS DETERMINED AND/OR VERIFIED BY FIELD AND OFFICE ACTIVITIES	NO FIELD EDIT-CLASS III MAP L. HARROD L. HARROD G. FROMM	FIELD REPRESENTATIVE OFFICE COMPILER DIGITIZER DATA PROCESSER

