

TP-00785

ORIGINAL

TP-00785

NOAA FORM 76-35

U.S. DEPARTMENT OF COMMERCE  
NATIONAL OCEANIC AND ATMOSPHERIC ADMINISTRATION  
NATIONAL OCEAN SURVEY

## DESCRIPTIVE REPORT

Type of Survey ..... Shoreline  
Job No. .... CM-7404 ..... Map No. TP-00785 ...  
Classification No. Final Edition No. ... 1 .....

Field Edited Map

### LOCALITY

State ..... California .....  
Point Vicente to  
General Locality ..... Port Hueneme .....  
Locality ..... Malibu Beach .....

19 74 TO 19 75

### REGISTRY IN ARCHIVES

DATE .....

☆ U.S. GOVERNMENT PRINTING OFFICE: 1974-762-901

18744 ✓  
18740 ✓

NOAA FORM 76-36A  
(2-72)U. S. DEPARTMENT OF COMMERCE  
NATIONAL OCEANIC AND ATMOSPHERIC ADMINISTRATION

TYPE OF SURVEY

SURVEY TP. 00785

NOAA FORM 76-36B  
(3-72)U. S. DEPARTMENT OF COMMERCE  
NATIONAL OCEANIC AND ATMOSPHERIC ADMINISTRATION  
NATIONAL OCEAN SURVEYTP-00785  
COMPILATION SOURCES

## 1. COMPILATION PHOTOGRAPHY

CAMERA(S) Wild RC-8"L"		TYPES OF PHOTOGRAPHY LEGEND		TIME REFERENCE	
TIDE STAGE REFERENCE		(C) COLOR (P) PANCHROMATIC (I) INFRARED		ZONE Pacific	<input checked="" type="checkbox"/> STANDARD
<input checked="" type="checkbox"/> PREDICTED TIDES <input type="checkbox"/> REFERENCE STATION RECORDS <input checked="" type="checkbox"/> TIDE CONTROLLED PHOTOGRAPHY				MERIDIAN 120th	<input type="checkbox"/> DAYLIGHT
NUMBER AND TYPE	DATE	TIME	SCALE	STAGE OF TIDE	
*74L(C) 1051-1054	3/4/74	11:50	1:30,000	0.5 ft. below MLLW	
**74L(I) 2214-2216	4/5/74	08:55	1:30,000	±0.2 ft. of MHW	
**74L(I) 1576-1578	3/21/74	14:35	1:30,000	±0.2 ft. of MLLW	

## REMARKS

\*Bridge and compilation photography (predicted tides)  
 \*\*Tide coordinated photography at MHW and MLLW

## 2. SOURCE OF MEAN HIGH-WATER LINE:

The mean high water line was compiled graphically from the above listed tide coordinated photography. The field edit made a small change to the MHWL, which was riprap.

## 3. SOURCE OF MEAN LOW-WATER OR MEAN LOWER LOW-WATER LINE:

The mean lower low water line was compiled graphically from the above listed tide coordinated photography.

## 4. CONTEMPORARY HYDROGRAPHIC SURVEYS (List only those surveys that are sources for photogrammetric survey information.)

SURVEY NUMBER	DATE(S)	SURVEY COPY USED	SURVEY NUMBER	DATE(S)	SURVEY COPY USED

## 5. FINAL JUNCTIONS

NORTH	EAST	SOUTH	WEST
No survey	TP-00786	No survey	TP-00784

## REMARKS

TP-00785

## HISTORY OF FIELD OPERATIONS

I. ☒ FIELD INSPECTION OPERATION☐ FIELD EDIT OPERATION

OPERATION	NAME	DATE
1. CHIEF OF FIELD PARTY	R. Melby	Feb 1974
2. HORIZONTAL CONTROL	RECOVERED BY ESTABLISHED BY PRE-MARKED OR IDENTIFIED BY	None None None
3. VERTICAL CONTROL	RECOVERED BY ESTABLISHED BY PRE-MARKED OR IDENTIFIED BY	None None None
4. LANDMARKS AND AIDS TO NAVIGATION	RECOVERED ( <i>Triangulation Stations</i> ) BY LOCATED ( <i>Field Methods</i> ) BY IDENTIFIED BY	None None None
5. GEOGRAPHIC NAMES INVESTIGATION	TYPE OF INVESTIGATION <input type="checkbox"/> COMPLETE <input type="checkbox"/> SPECIFIC NAMES ONLY BY <input checked="" type="checkbox"/> NO INVESTIGATION	
6. PHOTO INSPECTION	CLARIFICATION OF DETAILS BY	None
7. BOUNDARIES AND LIMITS	SURVEYED OR IDENTIFIED BY	None

## II. SOURCE DATA

1. HORIZONTAL CONTROL IDENTIFIED		2. VERTICAL CONTROL IDENTIFIED	
None		None	
PHOTO NUMBER	STATION NAME	PHOTO NUMBER	STATION DESIGNATION
3. PHOTO NUMBERS ( <i>Clarification of details</i> )			
None			
4. LANDMARKS AND AIDS TO NAVIGATION IDENTIFIED			
None			
PHOTO NUMBER	OBJECT NAME	PHOTO NUMBER	OBJECT NAME
5. GEOGRAPHIC NAMES: <input type="checkbox"/> REPORT <input checked="" type="checkbox"/> NONE		6. BOUNDARY AND LIMITS: <input type="checkbox"/> REPORT <input checked="" type="checkbox"/> NONE	
7. SUPPLEMENTAL MAPS AND PLANS			
None			
8. OTHER FIELD RECORDS ( <i>Sketch books, etc. DO NOT list data submitted to the Geodesy Division</i> )			
None			

TP-00785  
HISTORY OF FIELD OPERATIONSI. ☐ FIELD INSPECTION OPERATION☒ FIELD EDIT OPERATION

OPERATION	NAME	DATE
1. CHIEF OF FIELD PARTY	Richard E. Alderman	Oct 1975
2. HORIZONTAL CONTROL	RECOVERED BY FAIRWEATHER personnel	Oct 1975
	ESTABLISHED BY None	
	PRE-MARKED OR IDENTIFIED BY None	
3. VERTICAL CONTROL	RECOVERED BY None	
	ESTABLISHED BY None	
	PRE-MARKED OR IDENTIFIED BY None	
4. LANDMARKS AND AIDS TO NAVIGATION	RECOVERED (Triangulation Stations) BY None	
	LOCATED (Field Methods) BY FAIRWEATHER personnel	Oct 1975
	IDENTIFIED BY None	
5. GEOGRAPHIC NAMES INVESTIGATION	TYPE OF INVESTIGATION <input type="checkbox"/> COMPLETE <input type="checkbox"/> SPECIFIC NAMES ONLY BY <input checked="" type="checkbox"/> NO INVESTIGATION	
6. PHOTO INSPECTION	CLARIFICATION OF DETAILS BY J. A. Sowers	Oct 1975
7. BOUNDARIES AND LIMITS	SURVEYED OR IDENTIFIED BY NA	

## II. SOURCE DATA

1. HORIZONTAL CONTROL IDENTIFIED

None

2. VERTICAL CONTROL IDENTIFIED

None

PHOTO NUMBER	STATION NAME	PHOTO NUMBER	STATION DESIGNATION

3. PHOTO NUMBERS (Clarification of details)

74L(I) 1576

4. LANDMARKS AND AIDS TO NAVIGATION IDENTIFIED

None

PHOTO NUMBER	OBJECT NAME	PHOTO NUMBER	OBJECT NAME

5. GEOGRAPHIC NAMES: ☐ REPORT ☒ NONE6. BOUNDARY AND LIMITS: ☐ REPORT ☒ NONE

7. SUPPLEMENTAL MAPS AND PLANS

None

8. OTHER FIELD RECORDS (Sketch books, etc. DO NOT list data submitted to the Geodesy Division)

Map TP-00785 (Field Edit copy); and Field Edit Report,  
OPR-411-FA-75, Map TP-00785

NOAA FORM 76-36D  
(3-72)U. S. DEPARTMENT OF COMMERCE  
NATIONAL OCEANIC AND ATMOSPHERIC ADMINISTRATIONTP-00785  
RECORD OF SURVEY USE

## I. MANUSCRIPT COPIES

COMPILATION STAGES			DATE MANUSCRIPT FORWARDED	
DATA COMPILED	DATE	REMARKS	MARINE CHARTS	HYDRO SUPPORT
Compilation complete pending field edit	4/28/75	Class III manuscript superseded	2/10/76	6/13/75
Field edit applied Compilation complete	4/76	Class I	4/27/76	None
Final Review	Feb 1979	Final	Apr 1979	

## II. LANDMARKS AND AIDS TO NAVIGATION

## 1. REPORTS TO MARINE CHART DIVISION, NAUTICAL DATA BRANCH

None

NUMBER	CHART LETTER NUMBER ASSIGNED	DATE FORWARDED	REMARKS
			None

2. ☐ REPORT TO MARINE CHART DIVISION, COAST PILOT BRANCH. DATE FORWARDED: \_\_\_\_\_3. ☐ REPORT TO AERONAUTICAL CHART DIVISION, AERONAUTICAL DATA SECTION. DATE FORWARDED: \_\_\_\_\_

## III. FEDERAL RECORDS CENTER DATA

1. ☒ BRIDGING PHOTOGRAPHS; ☒ DUPLICATE BRIDGING REPORT; ☐ COMPUTER READOUTS.  
 2. ☐ CONTROL STATION IDENTIFICATION CARDS; ☐ FORM NOS 567 SUBMITTED BY FIELD PARTIES.  
 3. ☒ SOURCE DATA (except for Geographic Names Report) AS LISTED IN SECTION II, NOAA FORM 76-36C.  
 ACCOUNT FOR EXCEPTIONS:

4. ☐ DATA TO FEDERAL RECORDS CENTER. DATE FORWARDED: \_\_\_\_\_

## IV. SURVEY EDITIONS (This section shall be completed each time a new map edition is registered)

SECOND EDITION	SURVEY NUMBER TP - _____ (2)	JOB NUMBER PH - _____	TYPE OF SURVEY <input type="checkbox"/> REVISED <input type="checkbox"/> RESURVEY  MAP CLASS <input type="checkbox"/> II. <input type="checkbox"/> III. <input type="checkbox"/> IV. <input type="checkbox"/> V. <input type="checkbox"/> FINAL
	DATE OF PHOTOGRAPHY	DATE OF FIELD EDIT	
THIRD EDITION	SURVEY NUMBER TP - _____ (3)	JOB NUMBER PH - _____	TYPE OF SURVEY <input type="checkbox"/> REVISED <input type="checkbox"/> RESURVEY  MAP CLASS <input type="checkbox"/> II. <input type="checkbox"/> III. <input type="checkbox"/> IV. <input type="checkbox"/> V. <input type="checkbox"/> FINAL
	DATE OF PHOTOGRAPHY	DATE OF FIELD EDIT	
FOURTH EDITION	SURVEY NUMBER TP - _____ (4)	JOB NUMBER PH - _____	TYPE OF SURVEY <input type="checkbox"/> REVISED <input type="checkbox"/> RESURVEY  MAP CLASS <input type="checkbox"/> II. <input type="checkbox"/> III. <input type="checkbox"/> IV. <input type="checkbox"/> V. <input type="checkbox"/> FINAL
	DATE OF PHOTOGRAPHY	DATE OF FIELD EDIT	

OFFICIAL MILEAGE FOR COST ACCOUNTS

Sheet No.	Area Sq. Miles	Sheet No.	Area Sq. Miles
TP-00777	3	TP-00785	3
TP-00778	2	TP-00786	3
TP-00779	3	TP-00787	1
TP-00780	3	TP-00788	3
TP-00781	3	TP-00789	2
TP-00782	3	TP-00790	3
TP-00783	3	TP-00791	2
TP-00784	3	TP-00792	3
		<b>Total</b>	<b>43</b>

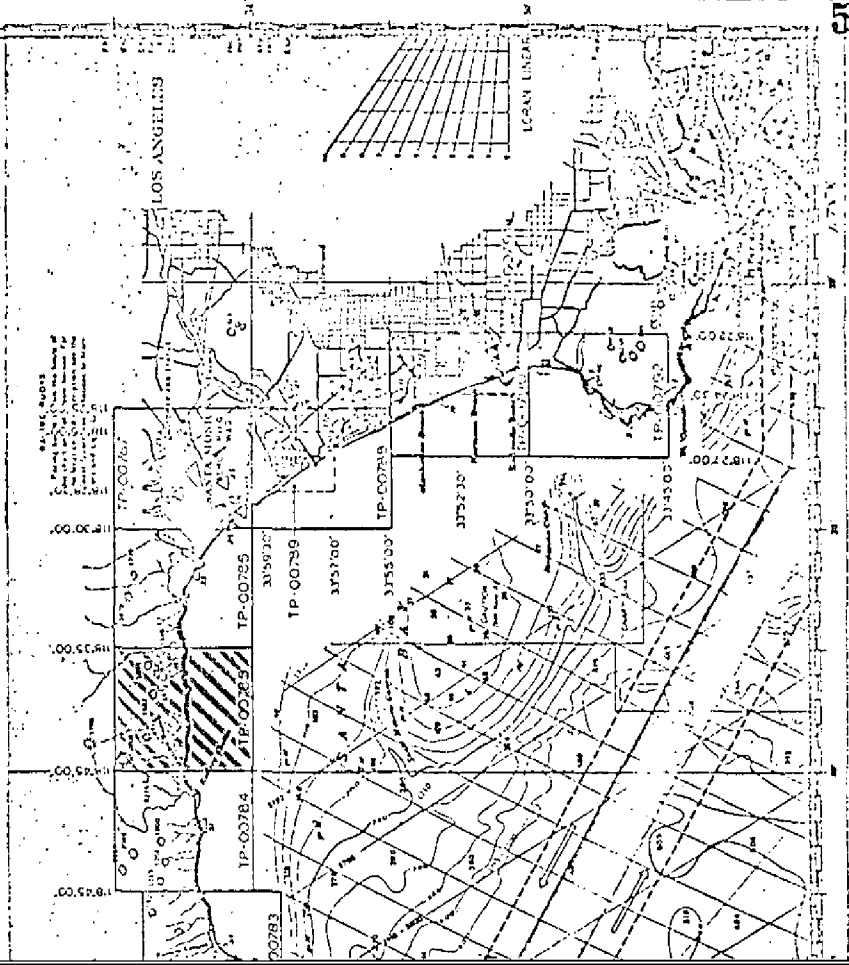

## SUMMARY TO ACCOMPANY

TP-00777 through TP-00792

Maps included in this summary comprise all of project CM-7404, Point Vicente to Port Hueneme, California. All but three of the sixteen maps in this project are 1:10,000 scale. The others, TP-00778, TP-00789 and TP-00791 are each 1:5,000 scale. All are standard shoreline maps, the purpose of which is to provide up-to-date shoreline and alongshore delineation for contemporary hydrographic surveys and for nautical chart construction.

The project area is immediately northwest of the city of Los Angeles. The shoreline is a mixture of wide, smooth, sandy beach and rough, rocky cliff areas.

Field operations prior to delineation did not include clarification of photographic details. They were limited to the recovery and identification of horizontal control and providing ground support needed to obtain tide coordinated photography.

Three sets of photographs were supplied and used for the delineation of each map. Natural color photographs were used for bridging and instrument compilation. Tide coordinated, black and white infrared photographs were used to graphically compile the mean high water line and mean lower low water line. The 1:5,000 scale maps were compiled with 1:15,000 scale photographs. The 1:10,000 scale maps were compiled with 1:30,000 scale photographs.

Bridging was done at the Washington Science Center in January 1975. Ratios were determined and ordered at that time. All maps were compiled at the Atlantic Marine Center in the Spring of 1975.

Field edit was performed in three parts. Maps TP-00785 through TP-00792 were edited in the fall of 1975. The location of some offshore features was not completed until the spring of 1976. At that time Maps TP-00781 through TP-00784 were edited. Maps TP-00777 through TP-00780 were edited in the fall of 1976. All edit was applied at the AMC.

Final Review was performed at the Atlantic Marine Center in the Winter of 1979. The original base maps and all pertinent data was forwarded to the Washington Science Center for reproduction and final registration.



## FIELD INSPECTION

TP-00785

Field inspection was limited to the recovery and identification of horizontal control for aerotriangulation, and ground support for the acquisition of tide coordinated infrared photography.

Photogrammetric Plot Report  
Point Vicente to Port Hueneme  
Job CM-7404

8

JANUARY 1975

21. Area Covered

The area covered by this report is the southwest coast of California from Point Vicente to Port Hueneme. This area is covered by thirteen 1:10,000-scale sheets, TP-00777 thru TP-00792, with the exception of sheets TP-00778, 789, and 791, which are at a scale of 1:5,000.

22. Method

Five strips of 1:30,000-scale color photography were bridged by analytic aerotriangulation methods. The five strips of bridging photography were controlled by field-identified control including some control from previous airport surveys which were used as checks.

Common points were located on the bridging photography and the tide-controlled IR for ratio purposes. In addition, common points were located on the bridging and compilation photography. The points read on the bridging strips are more than adequate for compilation purposes. Tie points were used in all five strips to insure an adequate junction of all strips during the strip adjustments.

23. Adequacy of Control

Control checked well within map accuracy standards and is more than sufficient for intended use. The results from the 1:30,000 bridging photography were adequate enough so as to not make it necessary to bridge the 1:15,000 compilation photography. See attached sheet for accuracy of control in strip adjustment.

24. Supplemental Data

USGS quadrangles were used to provide vertical control for the adjustment.

25. Photography

The coverage, overlap, and quality of the photography was adequate for the job.

Submitted by,

Approved and forwarded:

Brian F. Thornton

John D. Perrow, Jr.  
Chief, Aerotriangulation Section

Attachment

# List and Accuracy of Control Used in Strip Adjustment

	POINT	X-ERROR	Y-ERROR
Strip #1:	9101	0	0
	11114.	0	0
	13101	0	0
Strip #2:	13101	.381	.253
	24101	-1.368	-.581
	28100	1.455	.573
	34100	-.475	-.246
Strip #3:	28100	.626	1.068
	50100	-.267	1.023
	58101	.064	-.204
Strip #4:	108101	-1.954	-.873
	111111	2.718	3.046
	113101	-.123	-2.005
	117100	-1.029	-.525
	58101	.382	.363
Strip #5:	99100	.001	.001
	110801	-.004	-.001
	111801	1.078	.017

POINT VICENTE TO PORT HUENEME, CALIFORNIA

1:30.000 BRIGGING PHOTOS

1:15,000 COMPILATION PHOTOS

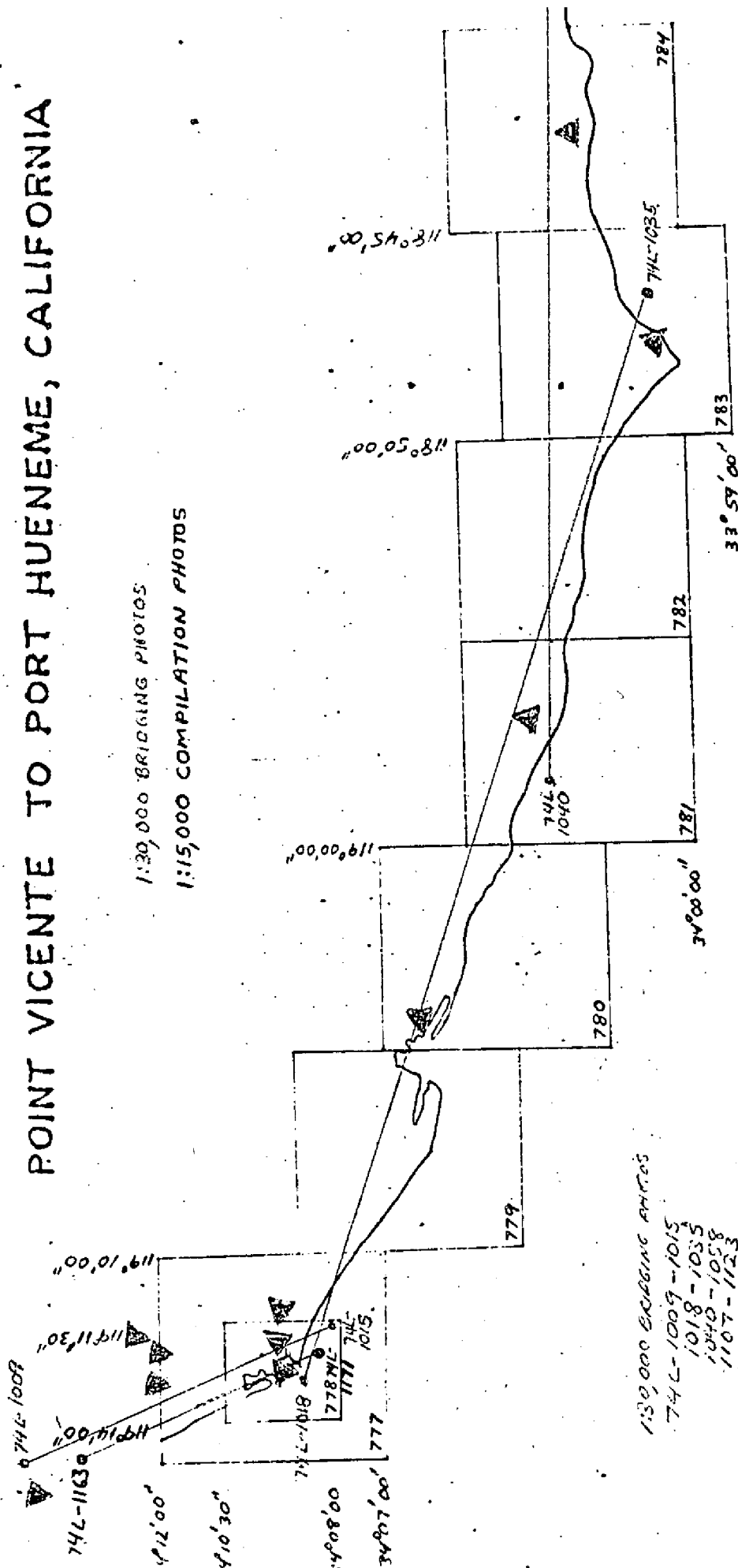

1130000 EXCISE TAXES

74C-1009-1015

1018-1035

8501-2011

1099-1101

15,000 completion

74-6-1163-1191

1172-1182

6611-0511

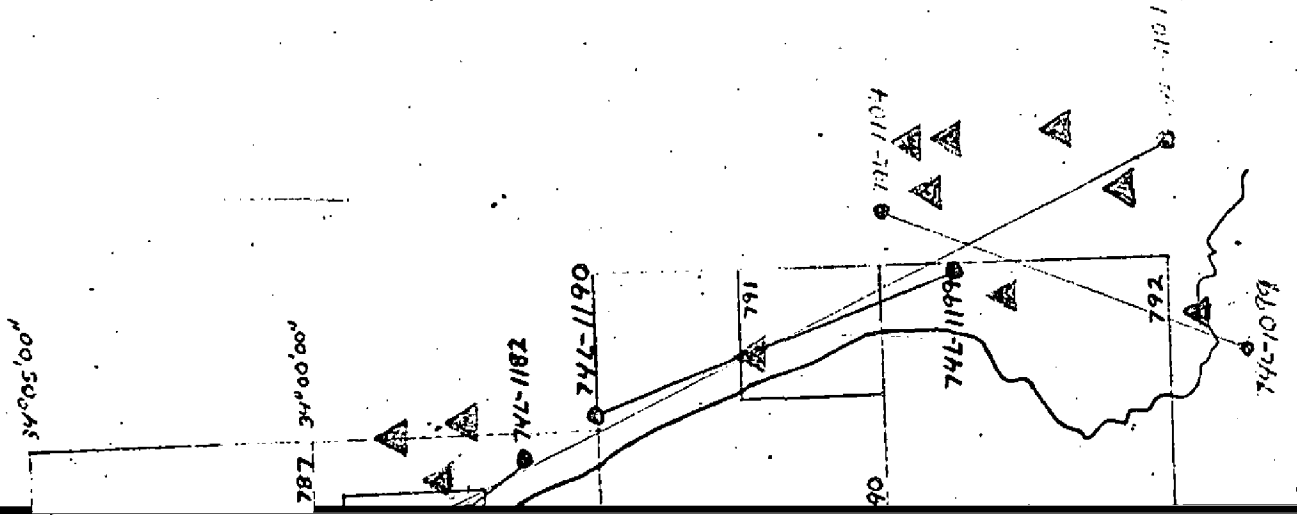

# JOB CM-7404

## POINT VICENTE TO PORT HUENEME, CALIFORNIA

● MHW - 1:30,000  
 ● MLLW - 1:30,000

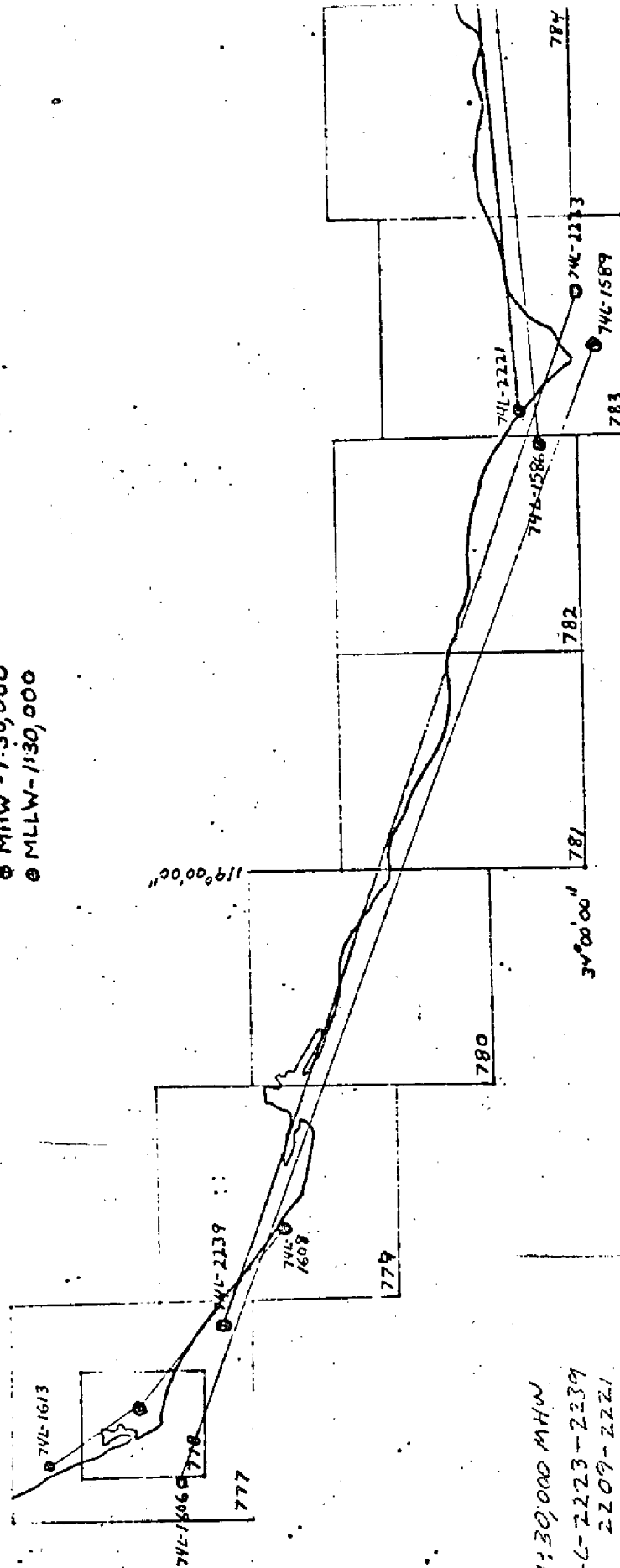

1:30,000 MHW  
 74-L-2223-2239  
 2209-2221  
 2194-2207  
 2187-2192

1:30,000  
 74-L-1608-1613  
 1584-1606  
 1572-1586  
 1547-1558  
 1540-1544

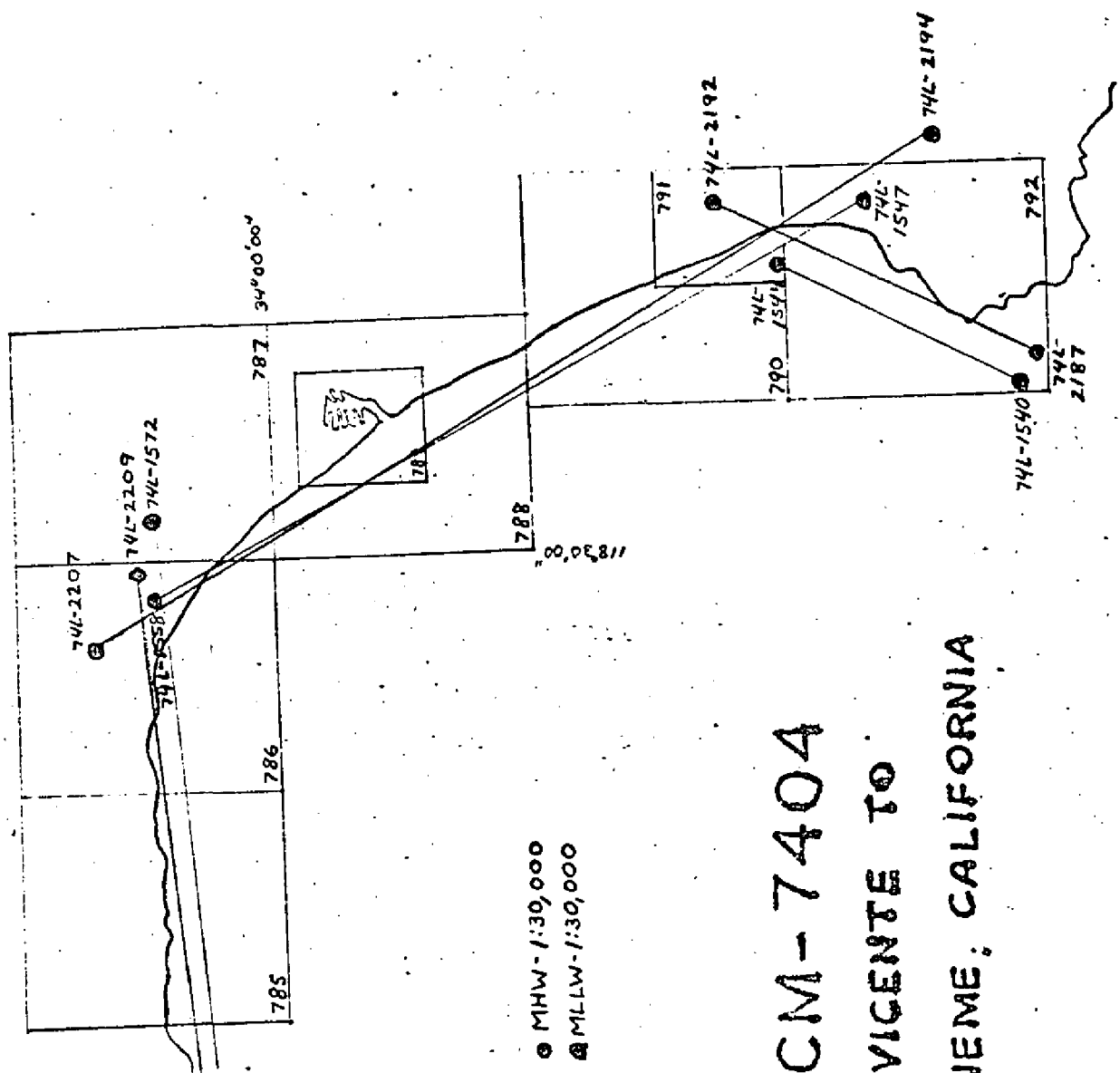

# JOB CM-7404 POINT VICENTE TO PORT HUENEME, CALIFORNIA

● MHW - 1:30,000  
 ■ MLLW - 1:30,000

E, CALIFORNIA

784

89







## COMPILATION REPORT

TP-00785

31. DELINEATION:

Delineation was by the Wild B-8 stereoplotter, using 1:30,000 color photography. Points were selected on the tide-coordinated photography to delineate the MHWL and MLLWL. Control was adequate.

32. CONTROL:

See the Photogrammetric Plot Report, dated Jan. 1975.

33. SUPPLEMENTAL DATA:

None.

34. CONTOURS AND DRAINAGE:

Contours are not applicable to the project. Drainage was delineated by office interpretation of the photographs.

35. SHORELINE AND ALONGSHORE DETAILS:

Alongshore details were delineated by office interpretation of the photographs.

36. OFFSHORE DETAILS:

None.

37. LANDMARKS AND AIDS:

None.

38. CONTROL FOR FUTURE SURVEYS:

None.

39. JUNCTIONS:

See the Form 76-36B, Item #5 concerning junctions.

40. HORIZONTAL AND VERTICAL ACCURACY:

No statement.

46. COMPARISON WITH EXISTING MAPS:

A comparison has been made with USGS Quadrangles Malibu Beach, California, dated 1950, scale 1:24,000 and Topanga, California, dated 1952, scale 1:24,000

47. COMPARISON WITH NAUTICAL CHARTS:

A comparison has been made with National Ocean Survey Chart 18740, 19th edition, dated September 28, 1974, scale 1:234,270.

ITEMS TO BE APPLIED TO NAUTICAL CHARTS IMMEDIATELY:

None.

ITEMS TO BE CARRIED FORWARD:

None.

Submitted by:

*Albert C. Rauck, Jr. For*  
Charles Parker  
Cartographic Aid  
4/28/75

Approved:

*Albert C. Rauck, Jr.*  
Albert C. Rauck, Jr.  
Chief, Coastal Mapping Section.

December 20, 1978

GEOGRAPHIC NAMES

FINAL NAME SHEET

CM-7404 (Point Vicente to Port Hueneme, California)

TP-00785

✓ Big Rock Beach	✓ Malibu Beach
✓ Carbon Beach	✓ Pacific Ocean
✓ Carbon Canyon	✓ Peña Canyon
✓ La Costa Beach	✓ Piedra Gorda Canyon
✓ Las Flores	✓ Santa Monica Bay
✓ Las Flores Canyon	✓ Tuna Canyon
✓ Las Tunas Beach	

Approved by:

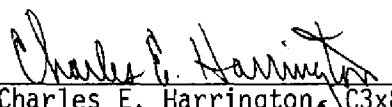
  
Charles E. Harrington, C3x8  
Chief Geographer

NOAA FORM 75-74  
(7-75)U.S. DEPARTMENT OF COMMERCE  
NOAA  
NATIONAL OCEAN SURVEY

## PHOTOGRAMMETRIC OFFICE REVIEW

TP - 00785

1. PROJECTION AND GRIDS FM	2. TITLE FM	3. MANUSCRIPT NUMBERS FM	4. MANUSCRIPT SIZE FM
CONTROL STATIONS			
5. HORIZONTAL CONTROL STATIONS OF THIRD-ORDER OR HIGHER ACCURACY FPM	6. RECOVERABLE HORIZONTAL STATIONS OF LESS THAN THIRD-ORDER ACCURACY (Topographic stations) NA		7. PHOTO HYDRO STATIONS NA
8. BENCH MARKS NA	9. PLOTTING OF SEXTANT FIXES NA	10. PHOTOGRAMMETRIC PLOT REPORT FPM	11. DETAIL POINTS FPM
ALONGSHORE AREAS (Nautical Chart Data)			
12. SHORELINE FPM	13. LOW-WATER LINE FPM	14. ROCKS, SHOALS, ETC. FPM	15. BRIDGES FPM
16. AIDS TO NAVIGATION FPM	17. LANDMARKS FPM	18. OTHER ALONGSHORE PHYSICAL FEATURES FM	19. OTHER ALONGSHORE CULTURAL FEATURES FPM
PHYSICAL FEATURES			
20. WATER FEATURES FPM	21. NATURAL GROUND COVER NA		22. PLANETABLE CONTOURS NA
23. STEREOSCOPIC INSTRUMENT CONTOURS NA	24. CONTOURS IN GENERAL NA	25. SPOT ELEVATIONS NA	26. OTHER PHYSICAL FEATURES FPM
CULTURAL FEATURES			
27. ROADS FPM	28. BUILDINGS FPM	29. RAILROADS FPM	30. OTHER CULTURAL FEATURES FPM
BOUNDARIES			
31. BOUNDARY LINES NA		32. PUBLIC LAND LINES NA	
MISCELLANEOUS			
33. GEOGRAPHIC NAMES FPM	34. JUNCTIONS FPM		35. LEGIBILITY OF THE MANUSCRIPT FPM
36. DISCREPANCY OVERLAY FPM	37. DESCRIPTIVE REPORT FPM	38. FIELD INSPECTION PHOTOGRAPHS NA	39. FORMS FPM
40. REVIEWER F. Margiotta 6/75		SUPERVISOR, REVIEW SECTION OR UNIT Albert C. Rauck, Jr.	
41. REMARKS (See attached sheet)			
FIELD COMPLETION ADDITIONS AND CORRECTIONS TO THE MANUSCRIPT			
42. Additions and corrections furnished by the field completion survey have been applied to the manuscript. The manuscript is now complete except as noted under item 43.			
COMPILER Frank Margiotta		SUPERVISOR Albert C. Rauck, Jr.	
Reviewed by: J. R. Minton 4/27/76			

## 43. REMARKS

See form 76-36C, field edit, items 3 and 8 for field

## FIELD EDIT REPORT

MAP TP-00785

MALIBU BEACH

OCTOBER 1975

Field edit of map TP-00785 was done by Lcdr Joseph A. Sowers and Ens Gregory P. Kosinski during October 1975. Field inspection of the area was done at various stages of the tide by land vehicle and skiff.

METHOD

Photographs and a copy of the field edit ozalid were examined in the field. The shore was sandy beach, with some areas of riprap and boulders. Kelp and rock foul areas required delineation. All rocks and kelp patches noted on the master field mylar were verified or disproved with height and time information annotated on the mylar. No additional rocks were found. All times were based on GMT.

ADEQUACY OF COMPILATION

Compilation of this map is generally good, with several kelp and foul areas mistaken for ledge. There has been no hydrography run in this area. Field inspection of this map is complete. Three submerged rocks in the area of Big Rock Beach were not found and are left to the hydrographer for investigation. *Probably in 1976 season.*

RECOMMENDATIONS

It is recommended that this map be revised in accordance with the notes on the ozalid and then be accepted as an advanced manuscript.

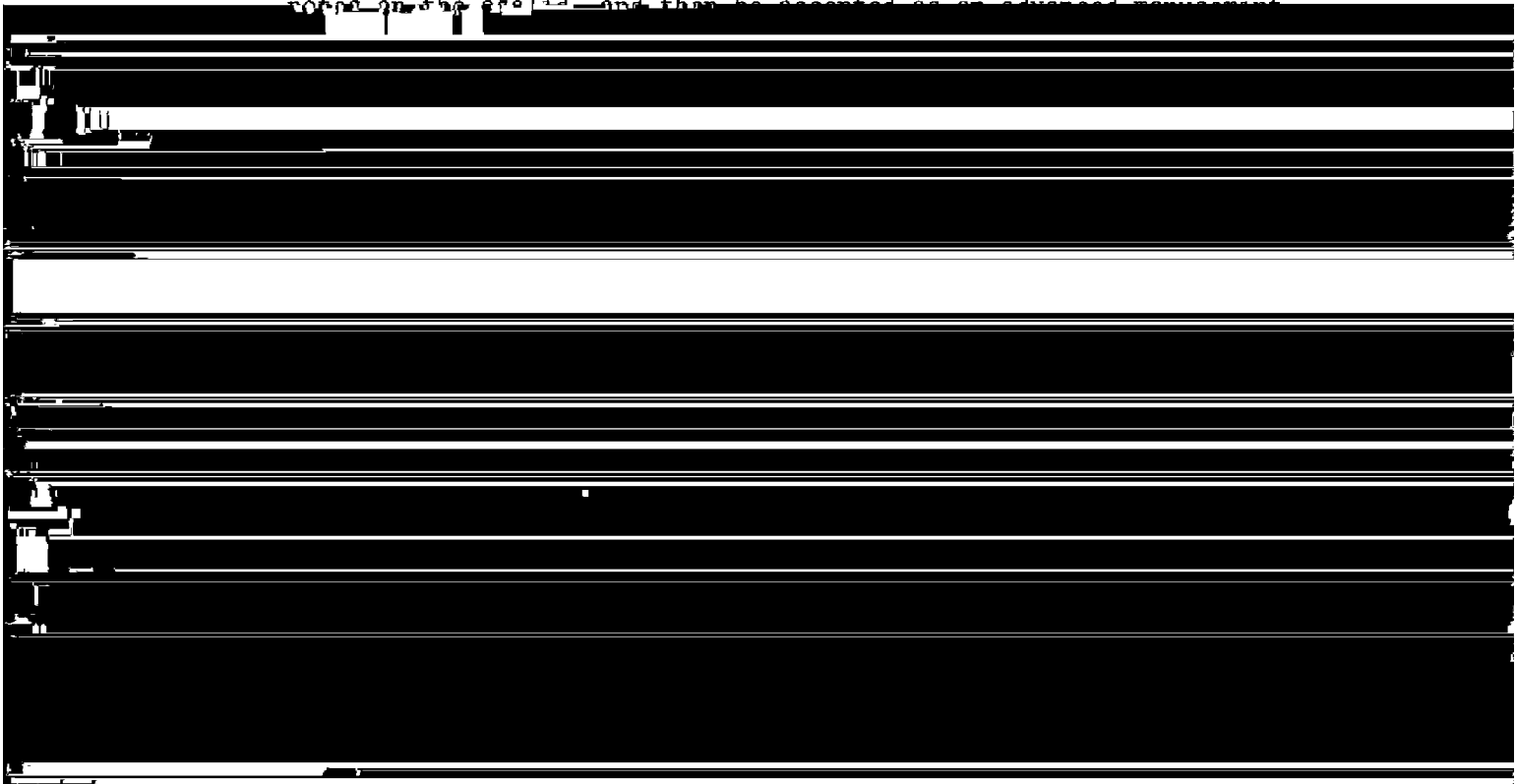

## REVIEW REPORT

TP-00785  
SHORELINE

February 6, 1979

61. GENERAL STATEMENT:

See Summary, page 6 of this Descriptive Report.

The field editor recommended the geographic name "Coal Creek" be added to the map at Carbon Canyon. This recommendation was complied with during field edit application. However, the Staff Geographer recommended the deletion of that name from the map. The name was deleted during final review.

The delineation of bluffs and the foul limit at the eastern limit of the map was revised during final review.

62. COMPARISON WITH REGISTERED TOPOGRAPHIC MAPS:

Not applicable.

63. COMPARISON WITH MAPS OF OTHER AGENCIES:

Not applicable.

64. COMPARISON WITH CONTEMPORARY HYDROGRAPHIC SURVEYS:

Comparison was made with a copy of Final Verified Smooth Sheets, H-9575 (FA-10-12-75) and H-9598 (FA-10-3-76).

The existence of several submerged rocks, delineated on the Class III Map, offshore from Big Rock Beach, was doubted by the field editor. As a result, they were deleted from the map during field edit application. Each of those rocks, however, appear on the smooth sheet with elevations below the datum plane. They do not appear on the final reviewed map.

65. COMPARISON WITH NAUTICAL CHARTS:

Comparison was made with Chart 18744, 1:40,000 scale, 22nd edition, dated May 6, 1978. Bluffs shown on the map do not appear on the chart.



66. ADEQUACY OF RESULTS AND FUTURE SURVEYS:

This map complies with the project instructions and meets the requirements for Bureau Standards and the National Standards of Map Accuracy.

Submitted by:

*A. L. Shands*

A. L. Shands  
Final Reviewer

Approved for forwarding:

*Albert C. Ranch Jr.*

Chief, Photogrammetric Branch, AMC

*JD*  
Approved:

*John D. Perraw Jr.*

Chief, Photogrammetric Branch

*James Allen*  
Chief, Coastal Mapping Division

PROJECT CM-7404 MATERIALS ON FILE

FEDERAL RECORDS CENTER

Control Station Identification Cards  
Field Edit Photographs  
Bridging Photographs  
Job Completion Report

BUREAU ARCHIVES

Registered Copy of Each Map  
Descriptive Report of Each Map

GEODESY

Geodetic Records

MARINE CHART DIVISION

Chart Maintenance Print for Each Map  
Forms 76-40

OFFICE OF GEOGRAPHER

Geographic Names Standards

REPRODUCTION DIVISION

Film Copy of Each Map

