

ORIGINAL

TP-00751

369
286 JON 1973
IT

TP-00751

NOAA FORM 76-35

U.S. DEPARTMENT OF COMMERCE
NATIONAL OCEANIC AND ATMOSPHERIC ADMINISTRATION
NATIONAL OCEAN SURVEY

DESCRIPTIVE REPORT

Type of Survey .. Chart Compilation ..
Job No. .. CM-7301 .. Map No. TP-00751 ..
Classification No. III Edition No. .. 1 ..

LOCALITY

State New York
General Locality Richmond County
Locality .. Annadale Beach to Midland Beach ..

1974 TO 1975

REGISTRY IN ARCHIVES

DATE

NOAA FORM 76-36A (3-72)		U. S. DEPARTMENT OF COMMERCE NATIONAL OCEANIC AND ATMOSPHERIC ADMIN.		TYPE OF SURVEY <input checked="" type="checkbox"/> ORIGINAL <input type="checkbox"/> RESURVEY <input type="checkbox"/> REVISED		SURVEY TP. 00751 MAP EDITION NO. (1) MAP CLASS III JOB CM-7301	
DESCRIPTIVE REPORT - DATA RECORD				LAST PRECEDING MAP EDITION			
				TYPE OF SURVEY <input type="checkbox"/> ORIGINAL <input type="checkbox"/> RESURVEY <input type="checkbox"/> REVISED		JOB PH. MAP CLASS SURVEY DATES: 19__ TO 19__	
PHOTOGRAMMETRIC OFFICE Coastal Mapping Division Rockville, Maryland OFFICER-IN-CHARGE Commander James Collins							
I. INSTRUCTIONS DATED							
1. OFFICE				2. FIELD			
Instructions-AEROTRIANGULATION-3/27/75 Instructions-OFFICE-8/7/75				Instructions-FIELD-1/23/74 Instructions-FIELD-Amendment I-2/27/74 Instructions-FIELD-Amendment II-8/12/74 Instructions-FIELD-Supplement I-4/16/75 Instructions-FIELD-Supplement II-10/6/75			
II. DATUMS							
1. HORIZONTAL: <input checked="" type="checkbox"/> 1927 NORTH AMERICAN				OTHER (Specify)			
2. VERTICAL: <input checked="" type="checkbox"/> MEAN HIGH-WATER <input checked="" type="checkbox"/> MEAN LOW-WATER <input type="checkbox"/> MEAN LOWER LOW-WATER <input type="checkbox"/> MEAN SEA LEVEL				OTHER (Specify) National Geodetic Vertical Datum of 1929			
3. MAP PROJECTION Transverse Mercator				4. GRID(S) STATE New York ZONE East			
5. SCALE 1:10,000				STATE ZONE			
III. HISTORY OF OFFICE OPERATIONS							
OPERATIONS				NAME		DATE	
1. AEROTRIANGULATION BY METHOD: Analytic LANDMARKS AND AIDS BY				I. Raborn		8/75	
				N/A			
2. CONTROL AND BRIDGE POINTS PLOTTED BY METHOD: Coradomat CHECKED BY				S. Solbeck		9/75	
				N/A			
3. STEREOSCOPIC INSTRUMENT PLANIMETRY BY COMPILATION CHECKED BY				K. Baker		12/19/75	
INSTRUMENT: Wild B-8				G. Fromm		12/19/75	
SCALE: 1:15,000				N/A			
				N/A			
4. MANUSCRIPT DELINEATION PLANIMETRY BY				K. Baker		1/5/76	
				G. Fromm		1/20/76	
METHOD: Smooth Drafting				N/A			
				N/A			
SCALE: 1:10,000 HYDRO SUPPORT DATA BY				N/A			
				N/A			
5. OFFICE INSPECTION PRIOR TO FIELD EDIT BY				G. Fromm		10/14/76	
6. APPLICATION OF FIELD EDIT DATA BY				N/A			
				N/A			
7. COMPILATION SECTION REVIEW BY				G. Fromm		10/14/76	
8. FINAL REVIEW BY				E. L. Rolle		Jan. 1978	
9. DATA FORWARDED TO PHOTOGRAMMETRIC BRANCH BY				N/A			
10. DATA EXAMINED IN PHOTOGRAMMETRIC BRANCH BY				E. L. Rolle		Jan. 1978	
11. MAP REGISTERED - COASTAL SURVEY SECTION BY				R.T. Carter		May 1978	

TP-00751
COMPILATION SOURCES

1. COMPILATION PHOTOGRAPHY

CAMERA(S) RC-10(B) RC-8(E) Focal Lengths = 152.7mm		TYPES OF PHOTOGRAPHY LEGEND		TIME REFERENCE	
TIDE STAGE REFERENCE		(C) COLOR (P) PANCHROMATIC (I) INFRARED B&W		ZONE Eastern MERIDIAN 75th	<input checked="" type="checkbox"/> STANDARD <input type="checkbox"/> DAYLIGHT
<input checked="" type="checkbox"/> PREDICTED TIDES <input type="checkbox"/> REFERENCE STATION RECORDS <input checked="" type="checkbox"/> TIDE CONTROLLED PHOTOGRAPHY					
NUMBER AND TYPE	DATE	TIME	SCALE	STAGE OF TIDE	
74E(C) 7189-7193	10/19/74	1317-1324	1:30,000	*-1.77 Ft. MHW	
74E(C) 7132-7133	10/19/74	1215-1222	1:30,000		
75B5952R-5955R (I)	10/3/75	1142-1148	1:30,000	See following page for tide information.	

REMARKS *Computation from Predicted Tide Tables.
All the above photography was ratioed to 1:10,000.

2. SOURCE OF MEAN HIGH-WATER LINE:

The source of the mean high water line ^{is} was the ~~natural color~~ photography listed under Item I. (Compilation photography) See paragraph 35 of the Compilation Report.

3. SOURCE OF MEAN LOW-WATER OR MEAN LOWER LOW-WATER LINE:

The source of the mean low water line was ratioed prints of the black-and-white, tide-coordinated infrared photography listed under Item I.

4. CONTEMPORARY HYDROGRAPHIC SURVEYS (List only those surveys that are sources for photogrammetric survey information.)

SURVEY NUMBER	DATE(S)	SURVEY COPY USED	SURVEY NUMBER	DATE(S)	SURVEY COPY USED

5. FINAL JUNCTIONS

NORTH	EAST	SOUTH	WEST
TP-00743	TP-007501	TP-00757	TP-007570
REMARKS			

TIDE - COORDINATED PHOTOGRAPHY

TP - 00751

LOCATION AND PHOTOGRAPHY	TIDE STATIONS (In operation at time of photography)	STAGE OF TIDE in feet	MEAN RANGE in feet
75B5952R-5955R (Lower Bay)	SANDY HOOK (Reference Station)		4.6
	Great Kills Harbor (Sub.Sta.)	-0.59 MLW	4.7
	New Dorp Beach (Sub.Sta.)	-0.66 MLW	4.9
<p>NOTE: The reference station(s) ONLY were observed at time of photography.</p>			

REMARKS:

Water penetration is apparent on the infrared photography. Refer to paragraph 35 of Compilation Report bound with this ~~job~~ Descriptive Report.

NOAA FORM 76-36C
(3-72)U. S. DEPARTMENT OF COMMERCE
NATIONAL OCEANIC AND ATMOSPHERIC ADMINISTRATION
NATIONAL OCEAN SURVEY

TP-00751

HISTORY OF FIELD OPERATIONS

I. ☒ FIELD ~~INSPECTION~~ OPERATION☐ FIELD EDIT OPERATION

OPERATION	NAME	DATE
1. CHIEF OF FIELD PARTY	R. S. Tibbetts	8/74
2. HORIZONTAL CONTROL	RECOVERED BY N/A ESTABLISHED BY N/A PRE-MARKED OR IDENTIFIED BY N/A	
3. VERTICAL CONTROL	RECOVERED BY N/A ESTABLISHED BY N/A PRE-MARKED OR IDENTIFIED BY N/A	
4. LANDMARKS AND AIDS TO NAVIGATION	RECOVERED (Triangulation Stations) BY N/A LOCATED (Field Methods) BY N/A IDENTIFIED BY N/A	
5. GEOGRAPHIC NAMES INVESTIGATION	TYPE OF INVESTIGATION <input type="checkbox"/> COMPLETE <input type="checkbox"/> SPECIFIC NAMES ONLY <input checked="" type="checkbox"/> NO INVESTIGATION	
6. PHOTO INSPECTION	CLARIFICATION OF DETAILS BY N/A	
7. BOUNDARIES AND LIMITS	SURVEYED OR IDENTIFIED BY N/A	

II. SOURCE DATA

1. HORIZONTAL CONTROL IDENTIFIED

None

2. VERTICAL CONTROL IDENTIFIED

None

PHOTO NUMBER	STATION NAME	PHOTO NUMBER	STATION DESIGNATION

3. PHOTO NUMBERS (Clarification of details)

4. LANDMARKS AND AIDS TO NAVIGATION IDENTIFIED

None

PHOTO NUMBER	OBJECT NAME	PHOTO NUMBER	OBJECT NAME

5. GEOGRAPHIC NAMES: ☐ REPORT ☒ NONE6. BOUNDARY AND LIMITS: ☐ REPORT ☒ NONE

7. SUPPLEMENTAL MAPS AND PLANS

None

8. OTHER FIELD RECORDS (Sketch books, etc. DO NOT list data submitted to the Geodesy Division)

None

NOAA FORM 76-36C
(3-72)

NOAA FORM 76-36D
(3-72)U. S. DEPARTMENT OF COMMERCE
NATIONAL OCEANIC AND ATMOSPHERIC ADMINISTRATION

RECORD OF SURVEY USE

TP-00751

I. MANUSCRIPT COPIES

COMPILATION STAGES			DATE MANUSCRIPT FORWARDED	
DATA COMPILED	DATE	REMARKS	MARINE CHARTS	HYDRO SUPPORT
Compilation Complete pending field edit	10/14/76	Class III map Field Edit postponed	10/19/76	
Final review prior to registration.	Jan. 1978	Class III Map.	May 1978	

II. LANDMARKS AND AIDS TO NAVIGATION

1. REPORTS TO MARINE CHART DIVISION, NAUTICAL DATA BRANCH

NUMBER	CHART LETTER NUMBER ASSIGNED	DATE FORWARDED	REMARKS
3		Oct. 1977	Digitized Forms 76-40 were submitted as a final report. The computer cards for these landmarks and aids are on file in the CND Special Projects Section, and will be destroyed 5 years after the date of Final Review.

2. ☐ REPORT TO MARINE CHART DIVISION, COAST PILOT BRANCH. DATE FORWARDED: _____3. ☐ REPORT TO AERONAUTICAL CHART DIVISION, AERONAUTICAL DATA SECTION. DATE FORWARDED: _____

III. FEDERAL RECORDS CENTER DATA

1. ☒ BRIDGING PHOTOGRAPHS; ☒ DUPLICATE BRIDGING REPORT; ☒ COMPUTER READOUTS.
 2. ☐ CONTROL STATION IDENTIFICATION CARDS; ☐ FORM NOS 567 SUBMITTED BY FIELD PARTIES.
 3. ☐ SOURCE DATA (except for Geographic Names Report) AS LISTED IN SECTION II, NOAA FORM 76-36C.
 ACCOUNT FOR EXCEPTIONS:

4. ☐ DATA TO FEDERAL RECORDS CENTER. DATE FORWARDED: _____

IV. SURVEY EDITIONS (This section shall be completed each time a new map edition is registered)

SECOND EDITION	SURVEY NUMBER TP - _____ (2)	JOB NUMBER PH - _____	TYPE OF SURVEY <input type="checkbox"/> REVISED <input type="checkbox"/> RESURVEY MAP CLASS <input type="checkbox"/> II. <input type="checkbox"/> III. <input type="checkbox"/> IV. <input type="checkbox"/> V. <input type="checkbox"/> FINAL
	DATE OF PHOTOGRAPHY	DATE OF FIELD EDIT	
THIRD EDITION	SURVEY NUMBER TP - _____ (3)	JOB NUMBER PH - _____	TYPE OF SURVEY <input type="checkbox"/> REVISED <input type="checkbox"/> RESURVEY MAP CLASS <input type="checkbox"/> II. <input type="checkbox"/> III. <input type="checkbox"/> IV. <input type="checkbox"/> V. <input type="checkbox"/> FINAL
	DATE OF PHOTOGRAPHY	DATE OF FIELD EDIT	
FOURTH EDITION	SURVEY NUMBER TP - _____ (4)	JOB NUMBER PH - _____	TYPE OF SURVEY <input type="checkbox"/> REVISED <input type="checkbox"/> RESURVEY MAP CLASS <input type="checkbox"/> II. <input type="checkbox"/> III. <input type="checkbox"/> IV. <input type="checkbox"/> V. <input type="checkbox"/> FINAL
	DATE OF PHOTOGRAPHY	DATE OF FIELD EDIT	

NOAA FORM 76-36D

☆ U.S. Government Printing Office: 1975 - 665-661/1108, Region No. 6

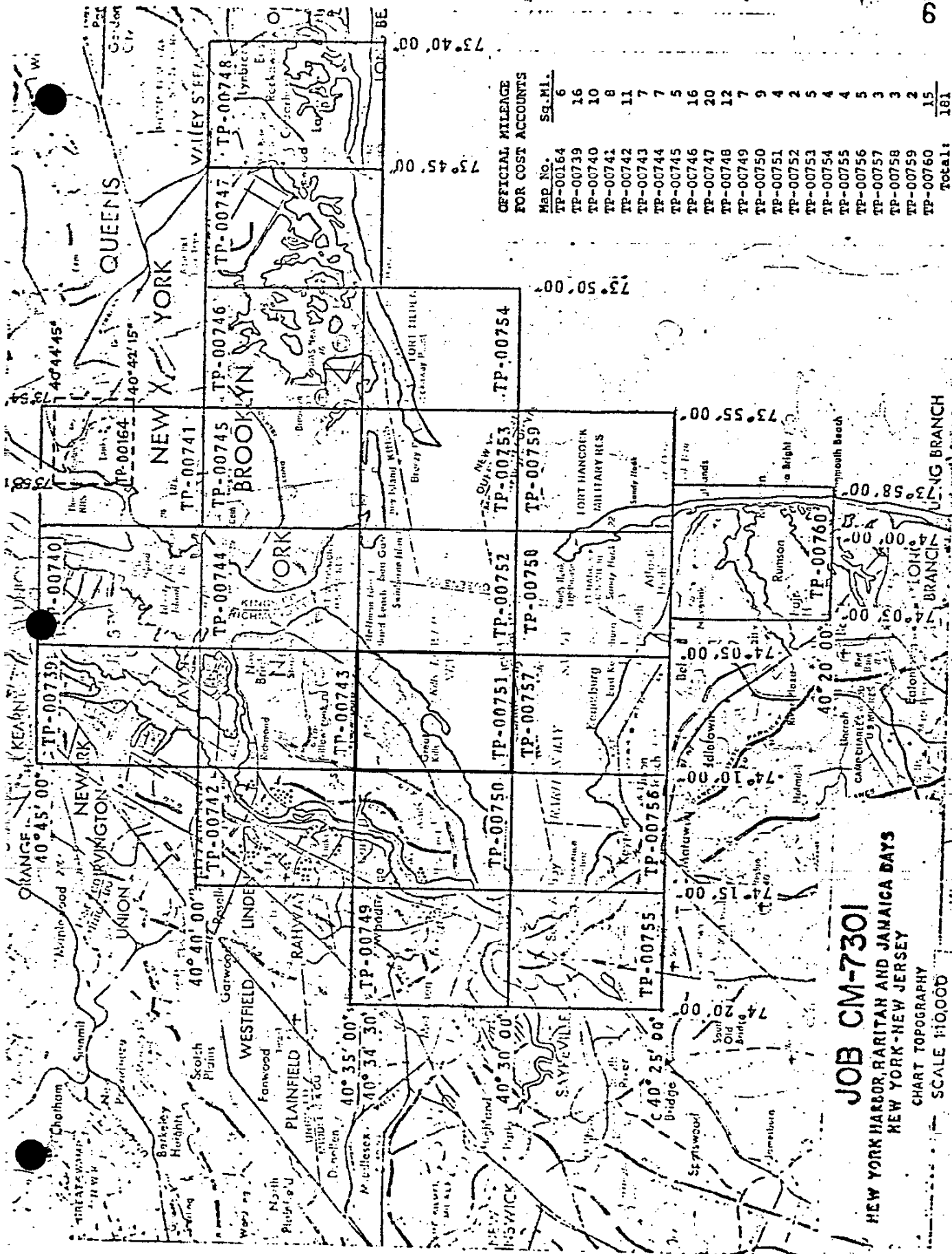

JOB CM-7301

**NEW YORK HARBOR, RARITAN AND JAMAICA BAYS
NEW YORK-NEW JERSEY**

CHART TOPOGRAPHY

SCALE 1:10,000

and 1:5,000

LONG BRANCH

74° 00'

OFFICIAL MILEAGE FOR COST ACCOUNTS

Map No.	Sq. MI.
TP-00164	6
TP-00739	16
TP-00740	10
TP-00741	8
TP-00742	11
TP-00743	7
TP-00744	7
TP-00745	5
TP-00746	16
TP-00747	20
TP-00748	12
TP-00749	7
TP-00750	9
TP-00751	4
TP-00752	2
TP-00753	5
TP-00754	4
TP-00755	4
TP-00756	5
TP-00757	3
TP-00758	3
TP-00759	2
TP-00760	15
Total:	181

DIAGRAM REVISED 2-5-75 (1:5,000 map added)

SUMMARY TO ACCOMPANY DESCRIPTIVE REPORTS
TP-00739 through TP-00760 and TP-00164

This map is one of twenty-three chart compilation maps that comprise Job CM-7301. Maps TP-00739 through TP-00760 were compiled at 1:10,000 scale and map TP-00164 was compiled at 1:5,000 scale.

The purpose of this job is to provide chart compilation for use in the maintenance and reconstruction of published nautical charts covering the project area.

The project area includes New York Harbor, Raritan Bay, and Jamaica Bay in the states of New Jersey and New York.

Field operations, which began in September 1974, generally consisted of the premarking of control and flying the needed aerial photography.

Aerotriangulation photography was furnished at 1:60,000 scale from natural color film taken in 1974 with the RC-10(C) camera. Color compilation photography was taken in 1974 at 1:30,000 scale and in 1975 at 1:15,000 scale, using the RC-8(E) and RC-10(B) cameras. Supplemental black-and-white infrared, tide-coordinated photography was flown in 1975 at 1:30,000 scale using the RC-10(B) camera.

Five strips of the 1:60,000 scale color photography were bridged using analytic aerotriangulation methods. Thirteen strips of the 1:30,000 scale color compilation photography and two strips of the 1:15,000 scale color compilation photography were also bridged by analytic aerotriangulation procedures.

Compilation photography was the 1:15,000 and 1:30,000 scale color photography and the 1:30,000 scale supplemental infrared photography. The maps were compiled on the Wild B-8 stereoplotter using the natural color photography. Ratioed prints of the black-and-white infrared photography were used graphically to delineate the approximate mean low water line and to supplement the B-8 instrument compilation.

All map line work is smooth compilation drafting.

Field edit data was prepared for each of the twenty-three maps. Field edit was postponed in 1977 after this preparation of data was completed.

Final review of the maps was done by the Quality Control Group of the Photogrammetric Branch. All maps were registered as Class III maps.

A Chart Maintenance Print for each map was forwarded to the Nautical Data Section of the Marine Chart Division.

The following items are registered in the National Ocean Survey Archives:

1. A plastic copy of each map
2. A Descriptive Report for each map

Two 20 cm x 30 cm negatives of each map are on file in the Photo Map and Imagery Information Section of the Photographic Operations Branch.

FIELD INSPECTION

There was no field inspection prior to compilation. Field work accomplished was limited to the recovery and identification of the horizontal control necessary for aerotriangulation.

21. Area Covered

The area covered by this report pertains to the shorelines of New York Harbor, Raritan and Jamaica Bays, New York-New Jersey. This area is covered by twenty-two 1:10,000 scale sheets, TP-00739 thru TP-00760 and one 1:5,000 sheet, TP-00164. The 5,000 scale sheet (TP-00164) was not plotted at this time because of the lack of low altitude photo coverage.

22. Method

Five strips of 1:60,000 scale color photography were bridged by analytic aerotriangulation methods. The strips were controlled by field identified control paneled in 1974 with office identified control floated as checks. Thirteen strips of 1:30,000 scale color photography were also bridged by analytic aerotriangulation methods. These strips were controlled by field identified control and with common points dropped from the 1:60,000 scale photography. Normally the 1:30,000 scale strips would not be bridged, but, due to the poor definition of photography, this had to be done in order to meet the National Map Accuracy Standards. Ties were made between all bridging strips. Points were located on the 1:30,000 scale photography to determine the ratio scale. Ratios were ordered for the 1:10,000 scale sheets. Data for ruling projections were furnished to the Coradomat to be plotted in the New York East state plane coordinate system. The grids were plotted in zones as indicated per instructions in a letter from the Chief, Coastal Mapping Division, dated March 27, 1975.

23. Adequacy of Control

The control was adequate.

24. Supplemental Data

USGS Quadrangles were used to provide vertical control for the adjustment.

25. Photography

The photography was adequate as to coverage and overlap except for the 1:5,000 scale sheet, TP-00164. This photography has not been taken as of this report. Definition of the photography at all scales was very poor due to haze at time of photography.

Respectfully submitted,

Ivey O. Raborn
Ivey O. Raborn

Approved and forwarded:

John D. Perrow, Jr.
John D. Perrow, Jr.

Chief, Aerotriangulation Section

JOE CM-7301
NEW YORK HARBOUR, RARITAN & INMANA BAYS
NEW YORK - NEW JERSEY
1:10,000 and 1:5,000 SCALE
7-75

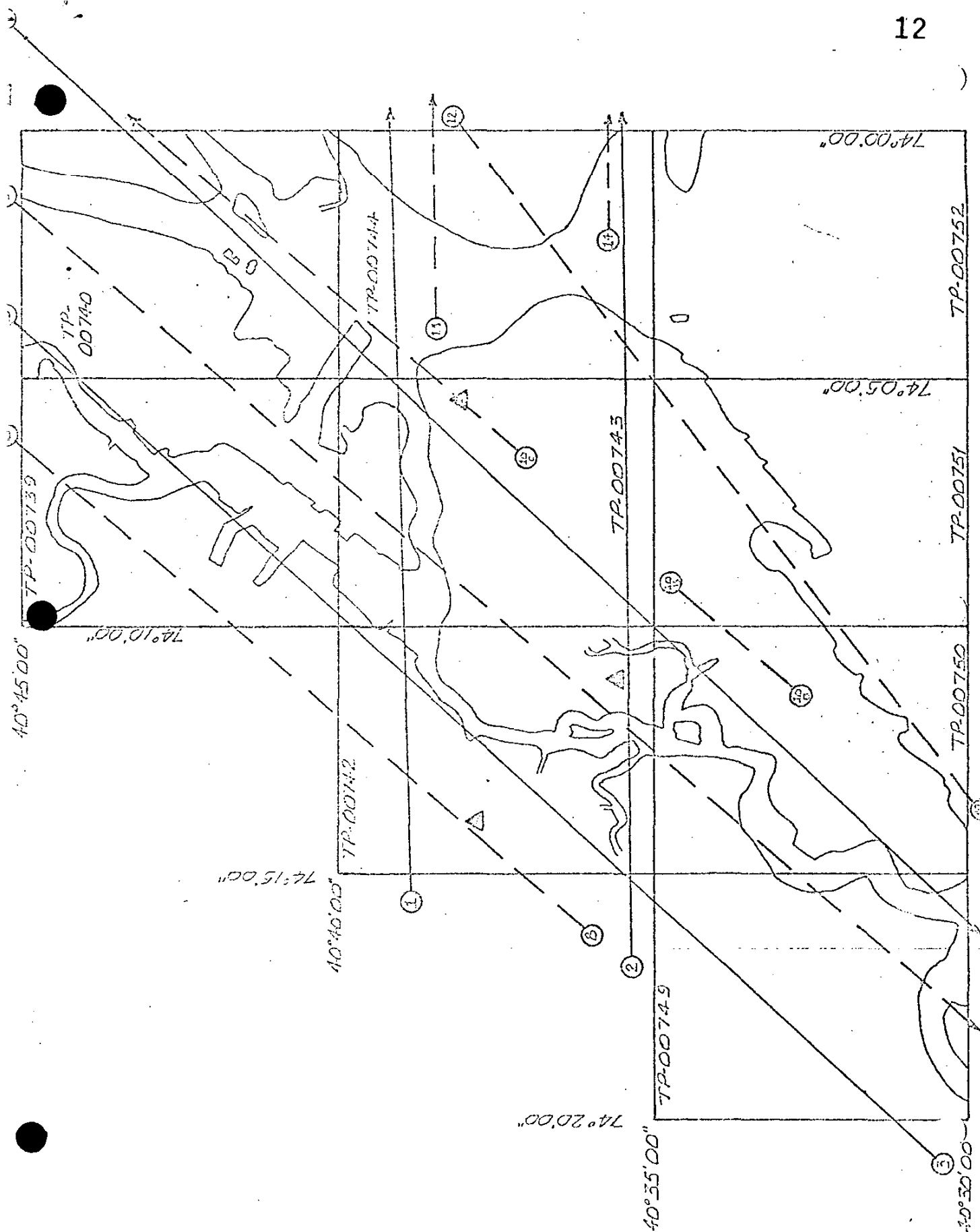

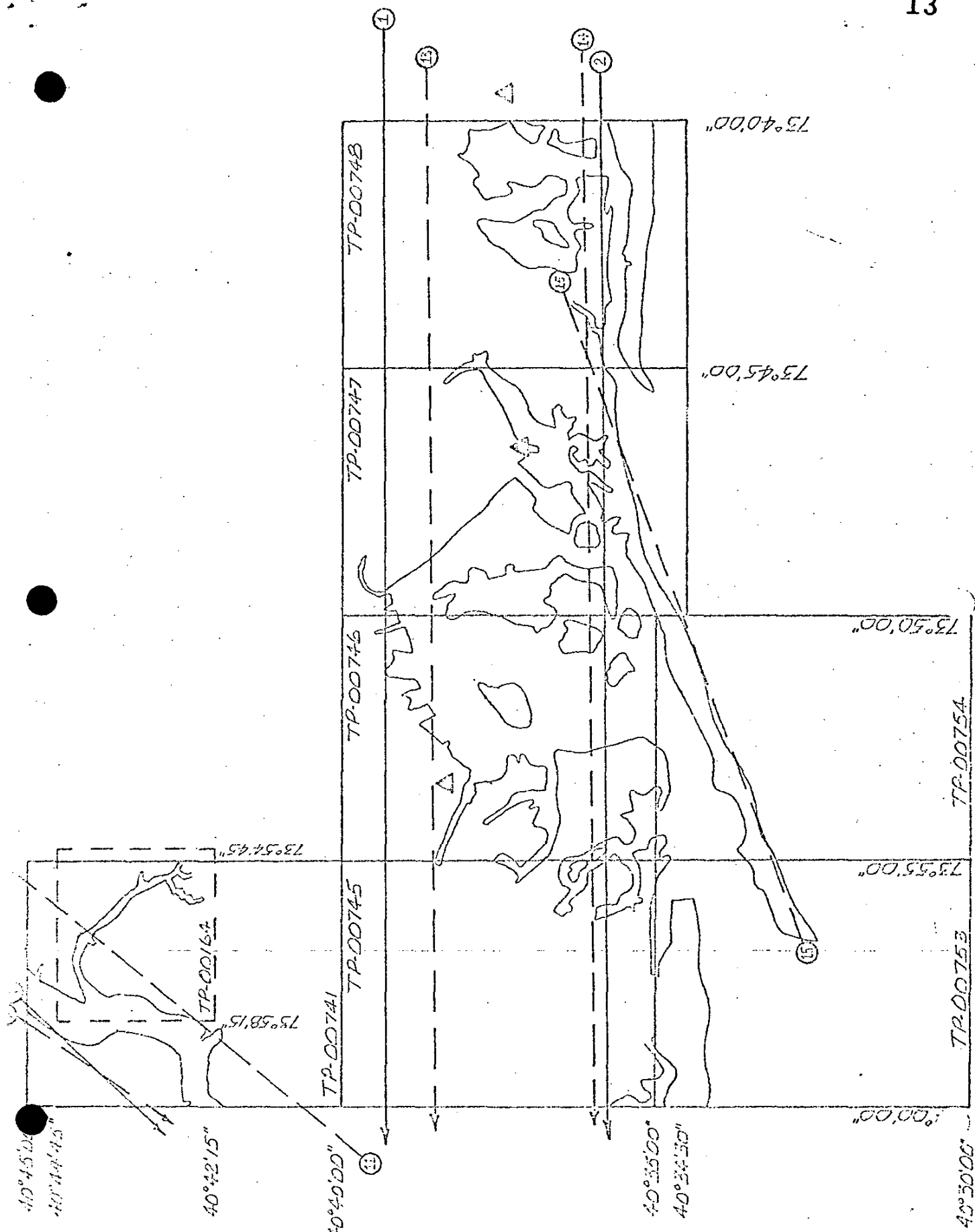

Strip No.	Scale	Photo Nos.
1	60,000	74C(C)864-874
2	"	851-861
3	"	74C(C)892-902
4	"	877-887
5	"	1202-1207
6	30,000	74E(C)6963-6970
No strip numbered 7		
8	30,000	74E(C)7145-7154
9	"	7083-7099
10A	"	7125-7127
10B	"	7131-7133
10C	"	7135-7143
11	"	7076-7082
12	"	7186-7196
13	"	7056-7069
14	"	7040-7052
15	"	7172-7179
16	"	7162-7170
17	"	7197-7202

DESCRIPTIVE REPORT CONTROL RECORD

MAP NO.	STATION NAME	JOB NO.	SOURCE OF INFORMATION (Index)	AEROTRIANGULATION POINT NUMBER	GEODEIC DATUM		ORIGINATING ACTIVITY	
					COORDINATES IN FEET STATE _____ ZONE _____	GEOGRAPHIC POSITION φ LATITUDE _____ λ LONGITUDE _____	REMARKS	
TP-00751	STATEN ISLAND LIGHTHOUSE 1917	CM-7301	NY Vol II G.P. P.60	882110	X=	φ 40-34-33.489		
					Y=	λ 74-08-29.977		
	GREAT KILLS LIGHT 1926	✓ NY Vol II G.P. P.25		78	X=	φ 40-31-17.579		
					Y=	λ 74-07-55.491		
	OLD OACHARD LIGHTHOUSE 1900	NY Vol II G.P. P.206		79	X=	φ 40-30-40.892		
					Y=	λ 74-05-56.860		
					X=	φ		
					Y=	λ		
					X=	φ		
					Y=	λ		
					X=	φ		
					Y=	λ		
					X=	φ		
					Y=	λ		
					X=	φ		
					Y=	λ		
					X=	φ		
					Y=	λ		
					X=	φ		
					Y=	λ		
COMPUTED BY	N/A				COMPUTATION CHECKED BY	N/A	DATE	
LISTED BY					LISTING CHECKED BY	G. Fromm	DATE 1-20-76	
HAND PLOTTING BY	N/A				HAND PLOTTING CHECKED BY	N/A	DATE	

TP-00751
Compilation Report

31. Delineation

This map was compiled on the Wild B-8 stereoplotter from 1:30,000 scale natural color photography. Graphic compilation from ratioed prints of the black-and-white, tide-coordinated infrared photography was used to depict the mean low water line and to update the instrument compilation. Refer to paragraph 35.

32. Control

Refer to the Photogrammetric Plot Report bound with this Descriptive Report.

The identification, density, and placement of horizontal and vertical control was adequate.

33. Supplemental Data

None

34. Contours and Drainage

All drainage is from office interpretation of the color photography.

35. Shoreline and Alongshore Details

The MHW line was compiled from office interpretation of the 1974 color photography. An evident change in the shoreline from the color photography and the 1975 infrared photography was noted between longitudes 74°06'45" and 74°07'00". Graphic compilation by office interpretation of infrared photography was used to update the MHW line in this area.

Alongshore and foreshore features were delineated by office interpretation of the color photography and updated by graphic compilation from the infrared photography.

- * The MLWL was depicted graphically from the black-and-white, tide-coordinated infrared photography. Water penetration is apparent on the infrared photography. Therefore, portions of the foreshore areas depicted on this map may be covered a slight amount at MLW. This also applies to those shoal, or portions of, depicted with the MLW line symbol.

There was no preliminary field inspection of the shoreline.

- * Refer to REVIEW REPORT, item 67.

36. Offshore Details

No unusual problems were encountered in compiling details offshore.

37. Landmarks and Aids

Positions of landmarks and nonfloating aids will be verified or located during field edit.

Refer to the 76-40 forms prepared for those landmarks and aids identifiable on the compilation photography.

38. Control for Future Surveys

No form 524 submitted.

39. Junctions

Refer to form 76-36B, item #5, submitted with this Descriptive Report.

40. Horizontal and Vertical Accuracy

This map complies with the National Map Accuracy Standards.

41. thru 45. Inapplicable.

46. Comparison with Existing Maps

A comparison has been made with the following USGS quadrangles:

Arthur Kill, N.Y.-N.J., scale 1:24,000, 1966 Edition.
The Narrows, N.Y.-N.J., scale 1:24,000, 1966 Edition

No significant changes were noted.

47. Comparison with Nautical Charts

A comparison has been made with the following nautical charts:

12327(formerly 369), scale 1:40,000, 64th Edition, dated July 23, 1974.
12328(formerly 369-SC), scale 1:40,000, 12th Edition, dated Feb. 1, 1975.
12331(formerly 286), scale 1:15,000, 20th Edition, dated March 8, 1975.

Items to be applied to Nautical Charts immediately - None.

Items to be carried forward - None.

Submitted by:

Karin Baker
Karin Baker

Approved and Forwarded:

George M. Baker

COMPILATION OFFICE CHECK LIST

CLASS III MANUSCRIPT

TP - 00751

1. Shoreline and Alongshore Features / 2. Projections /
3. Grids / 4. Title Block / 5. Horizontal Control /
6. Landmarks and Aids to Navigation / 7. NOAA
Form 76-36 / 8. Compilation Report / 9. Compilation
Methods and Procedures / 10. Junctions / 11. Clarity
of Manuscript / 12. Discrepancy Print /

Reviewer G. Tamm

14 Oct 76

Supervisor James M. Bane



February 10, 1978

TO: Chief, Photogrammetric Branch

FROM: James Collins (signed) James Collins
Chief, Coastal Mapping Division

SUBJECT: Registration of Job CM-7301, New York Harbor, Raritan
and Jamaica Bays, New York - New Jersey

All manuscripts completed on the subject job shall be registered
as Class III maps.

Field edit data developed to update these maps during 1978 and
subsequent field seasons shall be furnished to the Marine Chart
Division for blueprints.

cc: C3442
C3421
C3424



REVIEW REPORT
TP- 00751

Chart Compilation
January 1978

61. General Statement

See Summary, which is pages 7 and 8 of this Descriptive Report. The map was reviewed in its Class III Map (field edit postponed) stage by the Quality Control Group.

62. Comparison with Topographic Surveys - None

63. Comparison with Maps of Other Agencies

Refer to item 46 in the Compilation Report bound with this Descriptive Report.

64. Comparison with Contemporary Hydrographic Surveys

None

65. Comparison with Nautical Charts

Refer to item 47 in the Compilation Report bound with this Descriptive Report.

66. Adequacy of Results and Future Surveys

This map meets the National Standards of Map Accuracy and complies with compilation instructions and Bureau standards.

67. The Mean Low Water Line

Because water penetration is apparent on the ratioed tide-coordinated infrared photography, the outermost photographic image of land, along the water-land interface line, was delineated as the approximate mean low water line. This approach was taken to add an element of boating safety for users of the NOS nautical charts, reconstructed with details taken from this map. Refer to item 35 in the Compilation Report bound with this Descriptive Report.

Submitted by:

Edward L. Rolle

Approved and Forwarded:

John D. Gervaw Jr.
Chief, Photogrammetric Branch

John L. Rolle
Chief, Coastal Mapping Division

GEOGRAPHIC NAMES

FINAL NAME SHEET

CM-7301 (N.Y. Hbr., Raritan & Jamaica Bays, N.Y., N.J.)

TP-00751

Annadale Beach

Crookes Point

Great Kills

Great Kills Harbor

Great Kills Park

Lower Bay

Midland Beach

Midland Beach (locality)

New Dorp Beach

New Dorp Beach (locality)

Oakwood Beach

Oakwood Beach (locality)

Raritan Bay

Richmond Creek

Staten Island

Approved by:

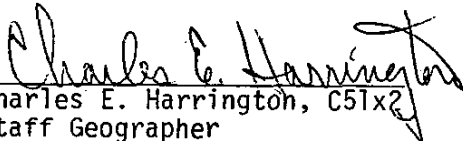
Charles E. Harrington, C51x2
Staff Geographer

* SVY TP-00751 * * RPT UNIT CMD ROCKVILLE, MD. * PAGE 1 OF 3 *
* JOB CM-7301 * NONFLOATING AIDS FOR CHARTS * STATE NEW YORK *
* PRJ N Y HARBOR * TO BE REVISED * LOCALITY RARITAN BAY * ORIGINATING ACTIVITY *
* DTM NA 1927 * * DATE 08/12/77 * COMPILATION *

* THE FOLLOWING OBJECTS HAVE NOT BEEN INSPECTED FROM SEAWARD TO DETERMINE THEIR VALUE AS LANDMARKS *

* CHARTING*	* DESCRIPTION *	* POSITION *	* CMD *	* METHOD AND DATE *	* CHARTS *
* NAME *	* RECORD REASON FOR DELETION *	* LATITUDE DM *	* ALTEK* *	* OF LOCATION *	* AFFECTED*
* PUT TRIANGULATION NAMES IN () *	* LONGITUDE DP *	* DGTZD* *	* OFFICE *	* FIELD *	

* NEW YORK HARBOR
* AMBROSE CHANNEL

* LIGHT *	(STATEN ISLAND LTHOUSE 1917)	* 40 34 33.49	1033.0	NOT *74E(C)7133*	* 12327 *
* * *	STATEN ISLAND (RANGE REAR) LT	* 74 08 29.98	705.1	DGTZD* 10/19/74 *	* 12328 *

* NEW YORK HARBOR
* SWASH CHANNEL

* -RANGE *		* 00 00 00.00	0.0	NOT *UNVERIFIED*	* 12327 *
* F LT *		* 00 00 00.00	0.0	DGTZD*	* 12328 *

* -RANGE *	(STATEN ISLAND	* 40 34 33.49	1033.0	NOT *74E(C)7133*	* 12327 *
* R LT *	LIGHTHOUSE 1917)	* 74 08 29.98	705.1	DGTZD* 10/19/74 *	* 12328 *

* NEW YORK HARBOR
* OLD ORCHARD SHOAL

* -LIGHT *	(OLD ORCHARD LIGHTHOUSE 1900)	* 40 30 43.89	1353.8	NOT *UNVERIFIED*	NO PHOTO * 12327 *
* * *		* 74 05 56.86	1338.7	DGTZD*	* COVERAGE * 12328 *
					12330 *

22

* TYPE OF ACTION *	* NAMES OF RESPONSIBLE PERSONNEL *	* ORIGINATOR *
* POSITIONS DETERMINED *	* NO FIELD EDIT-CLASS III MAP *	* FIELD REPRESENTATIVE *
* AND/OR VERIFIED BY *	* K. BAKER *	* OFFICE COMPILER *
* FIELD AND OFFICE *	* NOT DIGITIZED *	* DIGITIZER *
* ACTIVITIES *	* G. FROMM *	* DATA PROCESSER *

76-40
LISTING

PHOTOGRAMMETRIC BRANCH
COASTAL MAPPING DIVISION

NATIONAL OCEAN SURVEY NOAA
DEPARTMENT OF COMMERCE USA

DATATAB
VERSION
770818

* SVY TP-00751 * * RPT UNIT CMD ROCKVILLE, MD. * PAGE 2 OF 3 *
* JOB CM-7301 * NONFLOATING AIDS FOR CHARTS * STATE NEW YORK *
* PRJ N Y HARBOR * TO BE REVISED * LOCALITY RARITAN BAY * ORIGINATING ACTIVITY *
* DTM NA 1927 * * DATE 08/12/77 * COMPILATION *

* THE FOLLOWING OBJECTS HAVE NOT BEEN INSPECTED FROM SEAWARD TO DETERMINE THEIR VALUE AS LANDMARKS *

* CHARTING*	* DESCRIPTION *	* POSITION *	* CMD *	* METHOD AND DATE *	* CHARTS *
* NAME *	* PUT TRIANGULATION NAMES IN () *	* LATITUDE DM LONGITUDE DP *	* ALTEK* DGTZD* *	* OF LOCATION OFFICE * FIELD *	* AFFECTED*

* NEW YORK HARBOR					
* GREAT KILLS HARBOR					

* LIGHT	* (GREAT KILLS LIGHT 1926)	* 40 31 17.58 542.3	* NOT *74E(C)7192*		* 12331 *
		* 74 07 55.49 1306.2	* DGTZD* 10/19/74 *		* 12327 *

* RANGE	* ENTRANCE RANGE FRONT LIGHT	* 40 32 06.65 205.1	* *74E(C)7192*		* 12331 *
* F LT		* 74 08 33.75 794.3	* * 10/19/74 *		* 12327 *

* LIGHT	* ENTRANCE RANGE REAR LIGHT	* 00 00 00.00 0.0	* NOT *UNVERIFIED*		* 12331 *
		* 00 00 00.00 0.0	* DGTZD* *		* 12327 *

* NEW YORK HARBOR					
* RARITAN BAY					

* -LIGHT		* 00 00 00.00 0.0	* NOT *UNVERIFIED*	* NO PHOTO	
* 20		* 00 00 00.00 0.0	* DGTZD* *	* COVERAGE	

23

* TYPE OF ACTION *	* NAMES OF RESPONSIBLE PERSONNEL *	* ORIGINATOR *
* POSITIONS DETERMINED	* NO FIELD EDIT-CLASS III MAP	* FIELD REPRESENTATIVE
* AND/OR VERIFIED BY	* K. BAKER	* OFFICE COMPILER
* FIELD AND OFFICE	* L. HARROD	* DIGITIZER
* ACTIVITIES	* G. FROMM	* DATA PROCESSOR

* THE FOLLOWING OBJECTS HAVE NOT BEEN INSPECTED FROM SEAWARD TO DETERMINE THEIR VALUE AS LANDMARKS *

* DESCRIPTION *	* POSITION *	* CMD *	* METHOD AND DATE *	* * *
CHARTING RECORD REASON FOR DELETION *	LATITUDE DM	ALTEK*	OF LOCATION	* CHARTS *
* NAME * PUT TRIANGULATION NAMES IN () *	LONGITUDE DP	DGTZD*	OFFICE * FIELD	*AFFECTED*

* *	CHARTED LDMK(S) UNIDENTIFIABLE ON COMPILATION PHOTOGRAPHY.	* *	* *
* *	APPROXIMATE POSITION(S) SCALED FROM EXISTING CHART.	* *	* *

```

* FLAG- *          * 40 32 15.00 462.7 NOT *          * 12331 *
* POLE *          * 74 07 45.00 1059.0 DGTZD *          * 12327 *
-----
*          *          *          *          *          * 12328 *

```

1	2	3	4	5	6	7	8	9	10	11	12	13	14	15	16	17	18	19	20	21	22	23	24	25	26	27	28	29	30	31	32	33	34	35	36	37	38	39	40	41	42	43	44	45	46	47	48	49	50	51	52	53	54	55	56	57	58	59	60	61	62	63	64	65	66	67	68	69	70	71	72	73	74	75	76	77	78	79	80	81	82	83	84	85	86	87	88	89	90	91	92	93	94	95	96	97	98	99	100	101	102	103	104	105	106	107	108	109	110	111	112	113	114	115	116	117	118	119	120	121	122	123	124	125	126	127	128	129	130	131	132	133	134	135	136	137	138	139	140	141	142	143	144	145	146	147	148	149	150	151	152	153	154	155	156	157	158	159	160	161	162	163	164	165	166	167	168	169	170	171	172	173	174	175	176	177	178	179	180	181	182	183	184	185	186	187	188	189	190	191	192	193	194	195	196	197	198	199	200	201	202	203	204	205	206	207	208	209	210	211	212	213	214	215	216	217	218	219	220	221	222	223	224	225	226	227	228	229	230	231	232	233	234	235	236	237	238	239	240	241	242	243	244	245	246	247	248	249	250	251	252	253	254	255	256	257	258	259	260	261	262	263	264	265	266	267	268	269	270	271	272	273	274	275	276	277	278	279	280	281	282	283	284	285	286	287	288	289	290	291	292	293	294	295	296	297	298	299	300	301	302	303	304	305	306	307	308	309	310	311	312	313	314	315	316	317	318	319	320	321	322	323	324	325	326	327	328	329	330	331	332	333	334	335	336	337	338	339	340	341	342	343	344	345	346	347	348	349	350	351	352	353	354	355	356	357	358	359	360	361	362	363	364	365	366	367	368	369	370	371	372	373	374	375	376	377	378	379	380	381	382	383	384	385	386	387	388	389	390	391	392	393	394	395	396	397	398	399	400	401	402	403	404	405	406	407	408	409	410	411	412	413	414	415	416	417	418	419	420	421	422	423	424	425	426	427	428	429	430	431	432	433	434	435	436	437	438	439	440	441	442	443	444	445	446	447	448	449	450	451	452	453	454	455	456	457	458	459	460	461	462	463	464	465	466
---	---	---	---	---	---	---	---	---	----	----	----	----	----	----	----	----	----	----	----	----	----	----	----	----	----	----	----	----	----	----	----	----	----	----	----	----	----	----	----	----	----	----	----	----	----	----	----	----	----	----	----	----	----	----	----	----	----	----	----	----	----	----	----	----	----	----	----	----	----	----	----	----	----	----	----	----	----	----	----	----	----	----	----	----	----	----	----	----	----	----	----	----	----	----	----	----	----	----	-----	-----	-----	-----	-----	-----	-----	-----	-----	-----	-----	-----	-----	-----	-----	-----	-----	-----	-----	-----	-----	-----	-----	-----	-----	-----	-----	-----	-----	-----	-----	-----	-----	-----	-----	-----	-----	-----	-----	-----	-----	-----	-----	-----	-----	-----	-----	-----	-----	-----	-----	-----	-----	-----	-----	-----	-----	-----	-----	-----	-----	-----	-----	-----	-----	-----	-----	-----	-----	-----	-----	-----	-----	-----	-----	-----	-----	-----	-----	-----	-----	-----	-----	-----	-----	-----	-----	-----	-----	-----	-----	-----	-----	-----	-----	-----	-----	-----	-----	-----	-----	-----	-----	-----	-----	-----	-----	-----	-----	-----	-----	-----	-----	-----	-----	-----	-----	-----	-----	-----	-----	-----	-----	-----	-----	-----	-----	-----	-----	-----	-----	-----	-----	-----	-----	-----	-----	-----	-----	-----	-----	-----	-----	-----	-----	-----	-----	-----	-----	-----	-----	-----	-----	-----	-----	-----	-----	-----	-----	-----	-----	-----	-----	-----	-----	-----	-----	-----	-----	-----	-----	-----	-----	-----	-----	-----	-----	-----	-----	-----	-----	-----	-----	-----	-----	-----	-----	-----	-----	-----	-----	-----	-----	-----	-----	-----	-----	-----	-----	-----	-----	-----	-----	-----	-----	-----	-----	-----	-----	-----	-----	-----	-----	-----	-----	-----	-----	-----	-----	-----	-----	-----	-----	-----	-----	-----	-----	-----	-----	-----	-----	-----	-----	-----	-----	-----	-----	-----	-----	-----	-----	-----	-----	-----	-----	-----	-----	-----	-----	-----	-----	-----	-----	-----	-----	-----	-----	-----	-----	-----	-----	-----	-----	-----	-----	-----	-----	-----	-----	-----	-----	-----	-----	-----	-----	-----	-----	-----	-----	-----	-----	-----	-----	-----	-----	-----	-----	-----	-----	-----	-----	-----	-----	-----	-----	-----	-----	-----	-----	-----	-----	-----	-----	-----	-----	-----	-----	-----	-----	-----	-----	-----	-----	-----	-----	-----	-----	-----	-----	-----	-----	-----	-----	-----	-----	-----	-----	-----	-----	-----	-----	-----	-----	-----	-----	-----	-----	-----	-----	-----	-----	-----	-----	-----	-----	-----	-----	-----	-----	-----	-----	-----	-----	-----	-----	-----	-----	-----	-----	-----	-----	-----	-----	-----	-----	-----	-----

Figure 1 is a line graph showing the number of cases of COVID-19 in the United States from March 2020 to March 2021. The x-axis represents time in months, and the y-axis represents the number of cases. The graph shows a sharp increase in cases starting in March 2020, peaking in May 2020, and then declining. A dashed line indicates the trend, and a solid line shows the actual data. The data points are marked with asterisks.

✱	✱	✱	✱	✱	✱	✱	✱
✱	✱	✱	✱	✱	✱	✱	✱

t	n (alpha=0.0)	n (alpha=0.1)	n (alpha=0.2)	n (alpha=0.3)	n (alpha=0.4)
0	1	1	1	1	1
10	2.5	1.5	1.2	1.1	1.05
20	4.5	2.5	1.5	1.2	1.1
30	6.5	3.5	1.8	1.4	1.2
40	8.5	4.5	2.0	1.6	1.3
50	10.0	5.5	2.2	1.8	1.4
60	-	6.5	2.4	2.0	1.5
70	-	7.5	2.6	2.2	1.6
80	-	8.5	2.8	2.4	1.7
90	-	9.5	3.0	2.6	1.8
100	-	10.0	3.2	2.8	1.9

[illegible][illegible]

t	N (alpha=0.0)	N (alpha=0.1)	N (alpha=0.2)	N (alpha=0.3)	N (alpha=0.4)	N (alpha=0.5)
0	10	10	10	10	10	10
20	6.5	7.5	8.5	9.0	9.5	9.8
40	4.0	5.0	6.0	7.0	8.0	8.5
60	2.5	3.5	4.5	5.5	6.5	7.0
80	1.8	2.8	3.5	4.5	5.5	6.0
100	1.2	2.0	2.8	3.5	4.5	5.0

1	2	3	4	5	6	7	8	9	10	11	12	13	14	15	16	17	18	19	20	21	22	23	24	25	26	27	28	29	30	31	32	33	34	35	36	37	38	39	40	41	42	43	44	45	46	47	48	49	50	51	52	53	54	55	56	57	58	59	60	61	62	63	64	65	66	67	68	69	70	71	72	73	74	75	76	77	78	79	80	81	82	83	84	85	86	87	88	89	90	91	92	93	94	95	96	97	98	99	100	101	102	103	104	105	106	107	108	109	110	111	112	113	114	115	116	117	118	119	120	121	122	123	124	125	126	127	128	129	130	131	132	133	134	135	136	137	138	139	140	141	142	143	144	145	146	147	148	149	150	151	152	153	154	155	156	157	158	159	160	161	162	163	164	165	166	167	168	169	170	171	172	173	174	175	176	177	178	179	180	181	182	183	184	185	186	187	188	189	190	191	192	193	194	195	196	197	198	199	200	201	202	203	204	205	206	207	208	209	210	211	212	213	214	215	216	217	218	219	220	221	222	223	224	225	226	227	228	229	230	231	232	233	234	235	236	237	238	239	240	241	242	243	244	245	246	247	248	249	250	251	252	253	254	255	256	257	258	259	260	261	262	263	264	265	266	267	268	269	270	271	272	273	274	275	276	277	278	279	280	281	282	283	284	285	286	287	288	289	290	291	292	293	294	295	296	297	298	299	300	301	302	303	304	305	306	307	308	309	310	311	312	313	314	315	316	317	318	319	320	321	322	323	324	325	326	327	328	329	330	331	332	333	334	335	336	337	338	339	340	341	342	343	344	345	346	347	348	349	350	351	352	353	354	355	356	357	358	359	360	361	362	363	364	365	366	367	368	369	370	371	372	373	374	375	376	377	378	379	380	381	382	383	384	385	386	387	388	389	390	391	392	393	394	395	396	397	398	399	400	401	402	403	404	405	406	407	408	409	410	411	412	413	414	415	416	417	418	419	420	421	422	423	424	425	426	427	428	429	430	431	432	433	434	435	436	437	438	439	440	441	442	443	444	445	446	447	448	449	450	451	452	453	454	455	456	457	458	459	460	461	462	463	464	465	466
---	---	---	---	---	---	---	---	---	----	----	----	----	----	----	----	----	----	----	----	----	----	----	----	----	----	----	----	----	----	----	----	----	----	----	----	----	----	----	----	----	----	----	----	----	----	----	----	----	----	----	----	----	----	----	----	----	----	----	----	----	----	----	----	----	----	----	----	----	----	----	----	----	----	----	----	----	----	----	----	----	----	----	----	----	----	----	----	----	----	----	----	----	----	----	----	----	----	----	-----	-----	-----	-----	-----	-----	-----	-----	-----	-----	-----	-----	-----	-----	-----	-----	-----	-----	-----	-----	-----	-----	-----	-----	-----	-----	-----	-----	-----	-----	-----	-----	-----	-----	-----	-----	-----	-----	-----	-----	-----	-----	-----	-----	-----	-----	-----	-----	-----	-----	-----	-----	-----	-----	-----	-----	-----	-----	-----	-----	-----	-----	-----	-----	-----	-----	-----	-----	-----	-----	-----	-----	-----	-----	-----	-----	-----	-----	-----	-----	-----	-----	-----	-----	-----	-----	-----	-----	-----	-----	-----	-----	-----	-----	-----	-----	-----	-----	-----	-----	-----	-----	-----	-----	-----	-----	-----	-----	-----	-----	-----	-----	-----	-----	-----	-----	-----	-----	-----	-----	-----	-----	-----	-----	-----	-----	-----	-----	-----	-----	-----	-----	-----	-----	-----	-----	-----	-----	-----	-----	-----	-----	-----	-----	-----	-----	-----	-----	-----	-----	-----	-----	-----	-----	-----	-----	-----	-----	-----	-----	-----	-----	-----	-----	-----	-----	-----	-----	-----	-----	-----	-----	-----	-----	-----	-----	-----	-----	-----	-----	-----	-----	-----	-----	-----	-----	-----	-----	-----	-----	-----	-----	-----	-----	-----	-----	-----	-----	-----	-----	-----	-----	-----	-----	-----	-----	-----	-----	-----	-----	-----	-----	-----	-----	-----	-----	-----	-----	-----	-----	-----	-----	-----	-----	-----	-----	-----	-----	-----	-----	-----	-----	-----	-----	-----	-----	-----	-----	-----	-----	-----	-----	-----	-----	-----	-----	-----	-----	-----	-----	-----	-----	-----	-----	-----	-----	-----	-----	-----	-----	-----	-----	-----	-----	-----	-----	-----	-----	-----	-----	-----	-----	-----	-----	-----	-----	-----	-----	-----	-----	-----	-----	-----	-----	-----	-----	-----	-----	-----	-----	-----	-----	-----	-----	-----	-----	-----	-----	-----	-----	-----	-----	-----	-----	-----	-----	-----	-----	-----	-----	-----	-----	-----	-----	-----	-----	-----	-----	-----	-----	-----	-----	-----	-----	-----	-----	-----	-----	-----	-----	-----	-----	-----	-----	-----	-----	-----	-----	-----	-----	-----	-----	-----	-----	-----	-----	-----	-----	-----	-----	-----	-----	-----	-----	-----	-----	-----	-----	-----	-----	-----	-----	-----	-----	-----	-----	-----

24

.....

-----	*
* TYPE OF ACTION	NAMES OF RESPONSIBLE PERSONNEL ORIGINATOR *
(blank)	(blank)

✱	✱	✱	✱
✱	✱	✱	✱

```

* POSITIONS DETERMINED * NO FIELD EDIT-CLASS III MAP * FIELD REPRESENTATIVE *
* AND/OR VERIFIED BY * K. BAKER * OFFICE COMPILER *

```

* FIELD AND OFFICE	* NOT DIGITIZED	* DIGITIZER	* .
* ACTIVITIES	* G. FROMM	* DATA PROCESSER	* .

.....

TP-00751

National Archives Data

None

