

ORIGINAL

TP-00746

TP-00746

NOAA FORM 76-35	
U.S. DEPARTMENT OF COMMERCE NATIONAL OCEANIC AND ATMOSPHERIC ADMINISTRATION NATIONAL OCEAN SURVEY	
DESCRIPTIVE REPORT	
Type of Survey Chart Compilation	
Job No. ... CM-7301	Map No. TP-00746
Classification No. III	Edition No. ... 1
LOCALITY	
State New York	
General Locality ... Kings Co.-Queens Co... N.Y.	
Locality Jamaica Bay	
1974 TO 19 75	
REGISTRY IN ARCHIVES	
DATE	

10

NOAA FORM 76-36A (3-72)		U. S. DEPARTMENT OF COMMERCE NATIONAL OCEANIC AND ATMOSPHERIC ADMIN.		TYPE OF SURVEY		SURVEY TP. 00746	
DESCRIPTIVE REPORT - DATA RECORD				<input checked="" type="checkbox"/> ORIGINAL		MAP EDITION NO. 1	
				<input type="checkbox"/> RESURVEY		MAP CLASS III	
				<input type="checkbox"/> REVISED		JOB CM-7301	
PHOTOGRAMMETRIC OFFICE				LAST PRECEDING MAP EDITION			
Coastal Mapping Division (Rockville)				TYPE OF SURVEY		JOB PH-	
OFFICER-IN-CHARGE				<input type="checkbox"/> ORIGINAL		MAP CLASS	
Commander James Collins				<input type="checkbox"/> RESURVEY		SURVEY DATES:	
				<input type="checkbox"/> REVISED		19__ TO 19__	
I. INSTRUCTIONS DATED							
1. OFFICE				2. FIELD			
Instructions-AEROTRIANGULATION-3/27/75				Instructions-FIELD-1/23/74			
Instructions-OFFICE-8/7/75				Instructions-FIELD-Amendment I-2/27/74			
				Instructions-FIELD-Amendment II-8/12/74			
				Instructions-FIELD-Supplement I-4/16/75			
				Instructions-FIELD-Supplement II-10/6/75			
II. DATUMS							
1. HORIZONTAL:				OTHER (Specify)			
<input checked="" type="checkbox"/> 1927 NORTH AMERICAN							
2. VERTICAL:				OTHER (Specify)			
<input checked="" type="checkbox"/> MEAN HIGH-WATER				National Geodetic Vertical			
<input checked="" type="checkbox"/> MEAN LOW-WATER				Datum of 1929			
<input type="checkbox"/> MEAN LOWER LOW-WATER							
<input type="checkbox"/> MEAN SEA LEVEL							
3. MAP PROJECTION				4. GRID(S)			
Transverse Mercator				STATE		ZONE	
5. SCALE				New York		East	
1:10,000				STATE		ZONE	
III. HISTORY OF OFFICE OPERATIONS							
OPERATIONS				NAME		DATE	
1. AEROTRIANGULATION BY				I. Raborn		8/74	
METHOD: Analytic LANDMARKS AND AIDS BY				N/A			
2. CONTROL AND BRIDGE POINTS PLOTTED BY				S. Solbeck		2/9/76	
METHOD: Coradomat CHECKED BY				N/A			
3. STEREOSCOPIC INSTRUMENT PLANIMETRY BY				K. Baker		5/76	
COMPILATION CHECKED BY				G. Fromm		5/76	
INSTRUMENT: Wild B-8				CONTOURS BY		N/A	
SCALE: 1:15,000				CHECKED BY		N/A	
4. MANUSCRIPT DELINEATION PLANIMETRY BY				K. Baker		6/76	
METHOD: Smooth Drafting				CHECKED BY		G. Fromm	
SCALE: 1:10,000				CONTOURS BY		N/A	
HYDRO SUPPORT DATA BY				CHECKED BY		N/A	
5. OFFICE INSPECTION PRIOR TO FIELD EDIT BY				G. Fromm		10/14/76	
6. APPLICATION OF FIELD EDIT DATA BY				N/A			
CHECKED BY				G. Fromm N/A		10/14/76	
7. COMPILATION SECTION REVIEW BY				E. L. Rolle G. Fromm		10/14/76	
8. FINAL REVIEW BY				E. L. Rolle		Jan. 1978	
9. DATA FORWARDED TO PHOTOGRAMMETRIC BRANCH BY				N/A			
10. DATA EXAMINED IN PHOTOGRAMMETRIC BRANCH BY				E. L. Rolle		Jan. 1978	
11. MAP REGISTERED - COASTAL SURVEY SECTION BY				K. T. Carter		MAY 1978	

NOAA FORM 76-36B
(3-72)U. S. DEPARTMENT OF COMMERCE
NATIONAL OCEANIC AND ATMOSPHERIC ADMINISTRATION
NATIONAL OCEAN SURVEYTP-00746
COMPILATION SOURCES

1. COMPILATION PHOTOGRAPHY

CAMERA(S) RC-8(E) RC-10(B) Focal Lengths - 152.7mm		TYPES OF PHOTOGRAPHY LEGEND		TIME REFERENCE	
TIDE STAGE REFERENCE		(C) COLOR (P) PANCHROMATIC (I) INFRARED B&W		ZONE Eastern	<input checked="" type="checkbox"/> STANDARD
<input checked="" type="checkbox"/> PREDICTED TIDES <input type="checkbox"/> REFERENCE STATION RECORDS <input checked="" type="checkbox"/> TIDE CONTROLLED PHOTOGRAPHY				MERIDIAN 75th	<input type="checkbox"/> DAYLIGHT
NUMBER AND TYPE	DATE	TIME	SCALE	STAGE OF TIDE	
74E(C) 7043-7047	10/19/74	1111-1119	1:30,000	* +.36 Ft. MHW	
74E(C) 7061-7065 (I)	10/19/74	1125-1132	1:30,000	* +.24 Ft. MHW	
75B5986R-5989R	10/3/75	1221-1225	1:30,000	Refer to following page for tide data	
75B5944R-5948R (I)	10/3/75	1130-1135	1:30,000		

REMARKS

* Computation from Predicted Tide Table 3.
All of the above photography was ratioed to 1:10,000.

2. SOURCE OF MEAN HIGH-WATER LINE:

The source of the mean high water line ^{is} ~~was~~ the natural color photography listed under item I.

3. SOURCE OF MEAN LOW-WATER OR MEAN LOWER LOW-WATER LINE:

The source of the mean low water line was ratioed prints of the black-and-white, tide-coordinated infrared photography listed under item I.

4. CONTEMPORARY HYDROGRAPHIC SURVEYS (List only those surveys that are sources for photogrammetric survey information.)

SURVEY NUMBER	DATE(S)	SURVEY COPY USED	SURVEY NUMBER	DATE(S)	SURVEY COPY USED

5. FINAL JUNCTIONS

NORTH	EAST	SOUTH	WEST
No contemp. survey	TP-00747	TP-00754	TP-00745

REMARKS

NOAA FORM 76-36B(1)
(7-75)U. S. DEPARTMENT OF COMMERCE
NATIONAL OCEANIC AND ATMOSPHERIC ADMINISTRATION
NATIONAL OCEAN SURVEY

TIDE - COORDINATED PHOTOGRAPHY

TP - 00746

LOCATION AND PHOTOGRAPHY	TIDE STATIONS (In operation at time of photography)	STAGE OF TIDE in feet	MEAN RANGE in feet
	SANDY HOOK (Reference Station)		4.6
75B5986R-5989R (Mill Basin)	Mill Basin (Sub.Sta.)	-.65 MLW	5.2
Rockaway Inlet	Barren Island (Sub.Sta.)	-.59 MLW	5.0
75B5944R-5948R (Jamaica Bay)	Canarsie (Sub.Sta.)	-.56 MLW	5.2
<p>NOTE: The reference station(s) <u>ONLY</u> were in operation at the time of photography.</p>			

REMARKS:

Water penetration is apparent on the infrared photography. Refer to paragraph 35 of the Compilation Report bound with ~~job~~ this Descriptive Report.

TP-00746

HISTORY OF FIELD OPERATIONS

I. ☒ FIELD INSPECTION OPERATION☐ FIELD EDIT OPERATION

OPERATION	NAME	DATE
1. CHIEF OF FIELD PARTY	R.S. Tibbetts	8/74
2. HORIZONTAL CONTROL	RECOVERED BY R.S. Tibbetts	8/28/74
	ESTABLISHED BY N/A	
	PRE-MARKED OR IDENTIFIED BY R. S. Tibbetts	8/28/74
3. VERTICAL CONTROL	RECOVERED BY N/A	
	ESTABLISHED BY N/A	
	PRE-MARKED OR IDENTIFIED BY N/A	
4. LANDMARKS AND AIDS TO NAVIGATION	RECOVERED (Triangulation Stations) BY N/A	
	LOCATED (Field Methods) BY N/A	
	IDENTIFIED BY N/A	
5. GEOGRAPHIC NAMES INVESTIGATION	TYPE OF INVESTIGATION	
	<input type="checkbox"/> COMPLETE	
	<input type="checkbox"/> SPECIFIC NAMES ONLY	
	<input checked="" type="checkbox"/> NO INVESTIGATION	N/A
6. PHOTO INSPECTION	CLARIFICATION OF DETAILS BY	N/A
7. BOUNDARIES AND LIMITS	SURVEYED OR IDENTIFIED BY	N/A

II. SOURCE DATA

1. HORIZONTAL CONTROL IDENTIFIED

Premarked control

2. VERTICAL CONTROL IDENTIFIED

None

PHOTO NUMBER	STATION NAME	PHOTO NUMBER	STATION DESIGNATION
74-C(C) 868	Public School No. 115, 1931		
74-E(C) 6868			

3. PHOTO NUMBERS (Clarification of details)

4. LANDMARKS AND AIDS TO NAVIGATION IDENTIFIED

None

PHOTO NUMBER	OBJECT NAME	PHOTO NUMBER	OBJECT NAME

5. GEOGRAPHIC NAMES: ☐ REPORT ☒ NONE6. BOUNDARY AND LIMITS: ☐ REPORT ☒ NONE

7. SUPPLEMENTAL MAPS AND PLANS

None

8. OTHER FIELD RECORDS (Sketch books, etc. DO NOT list data submitted to the Geodesy Division)

1 C&GS form 152 (control station identification)

NOAA FORM 76-36D
(3-72)U. S. DEPARTMENT OF COMMERCE
NATIONAL OCEANIC AND ATMOSPHERIC ADMINISTRATION

RECORD OF SURVEY USE

TP-00746

I. MANUSCRIPT COPIES

COMPILATION STAGES			DATE MANUSCRIPT FORWARDED	
DATA COMPILED	DATE	REMARKS	MARINE CHARTS	HYDRO SUPPORT
Compilation complete pending field edit	10/14/76	Class III map Field edit postponed	10/19/76	
Final review prior to registration.	Jan. 1978	Class III Map.	May 1978	

II. LANDMARKS AND AIDS TO NAVIGATION

1. REPORTS TO MARINE CHART DIVISION, NAUTICAL DATA BRANCH

NUMBER	CHART LETTER NUMBER ASSIGNED	DATE FORWARDED	REMARKS
2		Oct. 1977	Digitized Forms 76-40 were submitted as a final report. The computer cards for these landmarks and aids are on file in the CMD Special Projects Section, and will be destroyed 5 years after the date of Final Review.

2. ☐ REPORT TO MARINE CHART DIVISION, COAST PILOT BRANCH. DATE FORWARDED: _____3. ☐ REPORT TO AERONAUTICAL CHART DIVISION, AERONAUTICAL DATA SECTION. DATE FORWARDED: _____

III. FEDERAL RECORDS CENTER DATA

1. ☒ BRIDGING PHOTOGRAPHS; ☒ DUPLICATE BRIDGING REPORT; ☒ COMPUTER READOUTS.
 2. ☒ CONTROL STATION IDENTIFICATION CARDS; ☐ FORM NOS 567 SUBMITTED BY FIELD PARTIES.
 3. ☐ SOURCE DATA (except for Geographic Names Report) AS LISTED IN SECTION II, NOAA FORM 76-36C.
 ACCOUNT FOR EXCEPTIONS:

4. ☐ DATA TO FEDERAL RECORDS CENTER. DATE FORWARDED: _____

IV. SURVEY EDITIONS (This section shall be completed each time a new map edition is registered)

SECOND EDITION	SURVEY NUMBER TP - _____ (2)	JOB NUMBER PH - _____	TYPE OF SURVEY <input type="checkbox"/> REVISED <input type="checkbox"/> RESURVEY MAP CLASS <input type="checkbox"/> II. <input type="checkbox"/> III. <input type="checkbox"/> IV. <input type="checkbox"/> V. <input type="checkbox"/> FINAL
	DATE OF PHOTOGRAPHY	DATE OF FIELD EDIT	
THIRD EDITION	SURVEY NUMBER TP - _____ (3)	JOB NUMBER PH - _____	TYPE OF SURVEY <input type="checkbox"/> REVISED <input type="checkbox"/> RESURVEY MAP CLASS <input type="checkbox"/> II. <input type="checkbox"/> III. <input type="checkbox"/> IV. <input type="checkbox"/> V. <input type="checkbox"/> FINAL
	DATE OF PHOTOGRAPHY	DATE OF FIELD EDIT	
FOURTH EDITION	SURVEY NUMBER TP - _____ (4)	JOB NUMBER PH - _____	TYPE OF SURVEY <input type="checkbox"/> REVISED <input type="checkbox"/> RESURVEY MAP CLASS <input type="checkbox"/> II. <input type="checkbox"/> III. <input type="checkbox"/> IV. <input type="checkbox"/> V. <input type="checkbox"/> FINAL
	DATE OF PHOTOGRAPHY	DATE OF FIELD EDIT	

NOAA FORM 76-36D

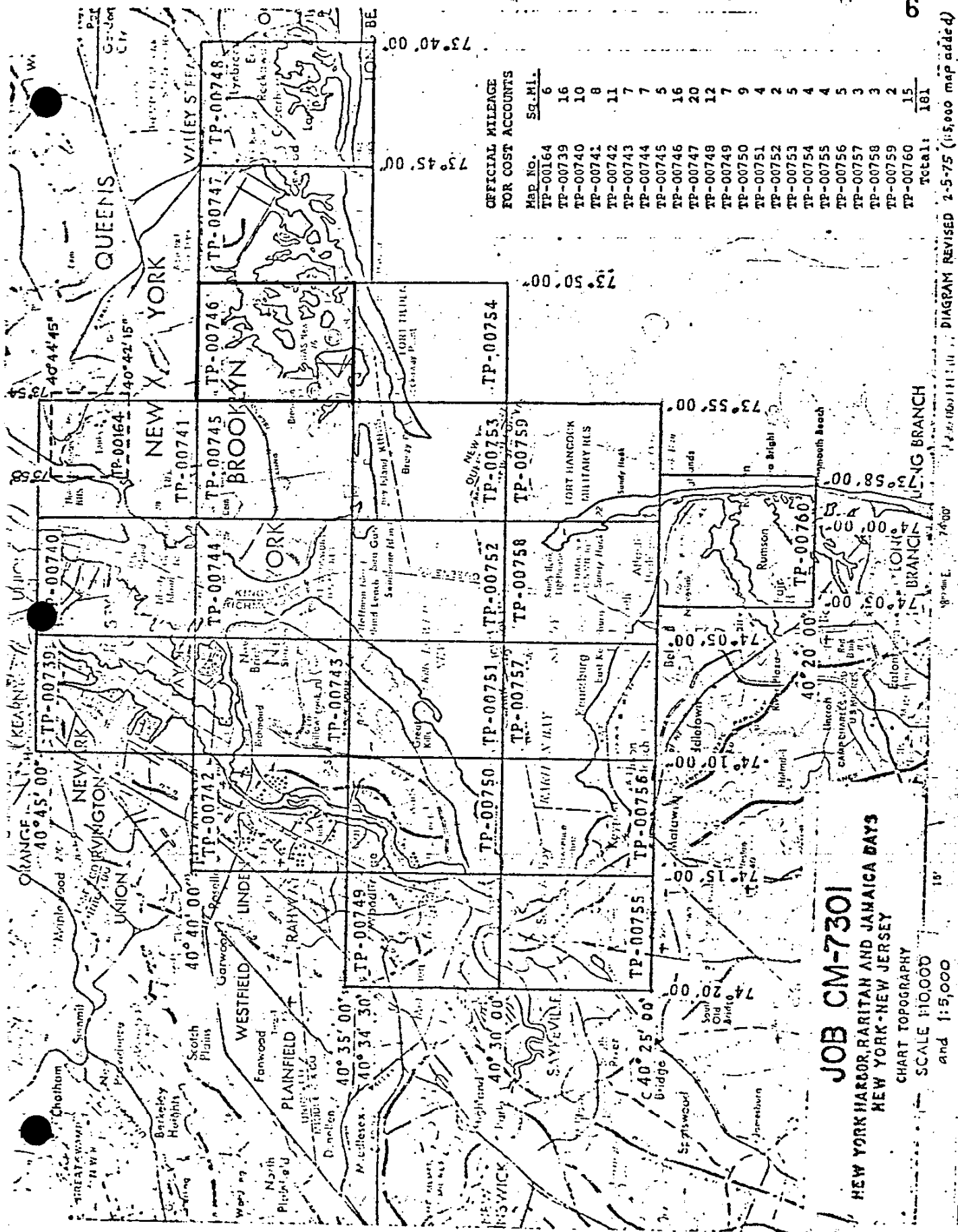

JOB CM-7301
NEW YORK HARBOR, RARITAN AND JAMAICA BAYS
NEW YORK-NEW JERSEY
 CHART TOPOGRAPHY
 SCALE 1:10,000
 and 1:5,000

OFFICIAL MILEAGE
FOR COST ACCOUNTS

Map No.	Sq. MI.
TP-00164	6
TP-00739	16
TP-00740	10
TP-00741	8
TP-00742	11
TP-00743	7
TP-00744	7
TP-00745	5
TP-00746	16
TP-00747	20
TP-00748	12
TP-00749	7
TP-00750	9
TP-00751	4
TP-00752	2
TP-00753	5
TP-00754	4
TP-00755	4
TP-00756	5
TP-00757	3
TP-00758	3
TP-00759	2
TP-00760	15
Total:	181

SUMMARY TO ACCOMPANY DESCRIPTIVE REPORTS
TP-00739 through TP-00760 and TP-00164

This map is one of twenty-three chart compilation maps that comprise Job CM-7301. Maps TP-00739 through TP-00760 were compiled at 1:10,000 scale and map TP-00164 was compiled at 1:5,000 scale.

The purpose of this job is to provide chart compilation for use in the maintenance and reconstruction of published nautical charts covering the project area.

The project area includes New York Harbor, Raritan Bay, and Jamaica Bay in the states of New Jersey and New York.

Field operations, which began in September 1974, generally consisted of the premarking of control and flying the needed aerial photography.

Aerotriangulation photography was furnished at 1:60,000 scale from natural color film taken in 1974 with the RC-10(C) camera. Color compilation photography was taken in 1974 at 1:30,000 scale and in 1975 at 1:15,000 scale, using the RC-8(E) and RC-10(B) cameras. Supplemental black-and-white infrared, tide-coordinated photography was flown in 1975 at 1:30,000 scale using the RC-10(B) camera.

Five strips of the 1:60,000 scale color photography were bridged using analytic aerotriangulation methods. Thirteen strips of the 1:30,000 scale color compilation photography and two strips of the 1:15,000 scale color compilation photography were also bridged by analytic aerotriangulation procedures.

Compilation photography was the 1:15,000 and 1:30,000 scale color photography and the 1:30,000 scale supplemental infrared photography. The maps were compiled on the Wild B-8 stereoplotter using the natural color photography. Ratioed prints of the black-and-white infrared photography were used graphically to delineate the approximate mean low water line and to supplement the B-8 instrument compilation.

All map line work is smooth compilation drafting.

Field edit data was prepared for each of the twenty-three maps. Field edit was postponed in 1977 after this preparation of data was completed.

Final review of the maps was done by the Quality Control Group of the Photogrammetric Branch. All maps were registered as Class III maps.

A Chart Maintenance Print for each map was forwarded to the Nautical Data Section of the Marine Chart Division.

The following items are registered in the National Ocean Survey Archives:

1. A plastic copy of each map
2. A Descriptive Report for each map

Two 20 cm x 30 cm negatives of each map are on file in the Photo Map and Imagery Information Section of the Photographic Operations Branch.

FIELD INSPECTION

There was no field inspection prior to compilation. Field work accomplished was limited to the recovery and identification of the horizontal control necessary for aerotriangulation.

21. Area Covered

The area covered by this report pertains to the shorelines of New York Harbor, Raritan and Jamaica Bays, New York-New Jersey. This area is covered by twenty-two 1:10,000 scale sheets, TP-00735 thru TP-00760 and one 1:5,000 sheet, TP-00164. The 1:5,000 scale sheet (TP-00164) was not plotted at this time because of the lack of low altitude photo coverage.

22. Method

Five strips of 1:60,000 scale color photography were bridged by analytic aerotriangulation methods. The strips were controlled by field identified control paneled in 1974 with office identified control floated as checks. Thirteen strips of 1:30,000 scale color photography were also bridged by analytic aerotriangulation methods. These strips were controlled by field identified control and with common points dropped from the 1:60,000 scale photography. Normally the 1:30,000 scale strips would not be bridged, but, due to the poor definition of photography, this had to be done in order to meet the National Map Accuracy Standards. Ties were made between all bridging strips. Points were located on the 1:30,000 scale photography to determine the ratio scale. Ratios were ordered for the 1:10,000 scale sheets. Data for ruling projections were furnished to the Coradomat to be plotted in the New York East state plane coordinate system. The grids were plotted in zones as indicated per instructions in a letter from the Chief, Coastal Mapping Division, dated March 27, 1975.

23. Adequacy of Control

The control was adequate.

24. Supplemental Data

USGS Quadrangles were used to provide vertical control for the adjustment.

25. Photography

The photography was adequate as to coverage and overlap except for the 1:5,000 scale sheet, TP-00164. This photography has not been taken as of this report. Definition of the photography at all scales was very poor due to haze at time of photography.

Respectfully submitted,

Ivan O. Raborn
Ivan O. Raborn

Approved and forwarded:

John D. Perrow, Jr.
John D. Perrow, Jr.
Chief, Aerotriangulation Section

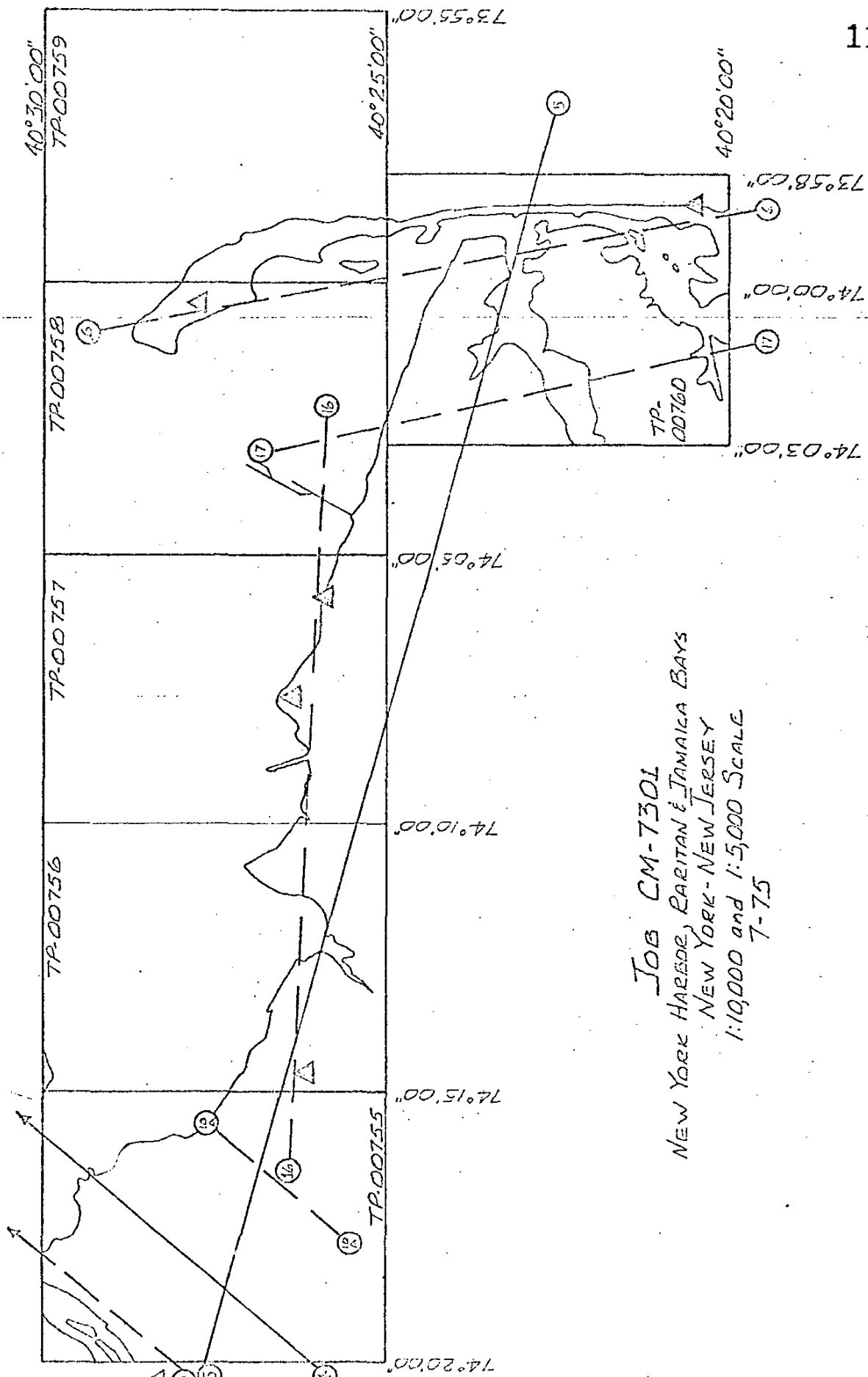

JOB CM-7301
 NEW YORK HARBOR, RARITAN & JAMAICA BAYS
 NEW YORK-NEW JERSEY
 1:10,000 and 1:5,000 SCALE
 7-75

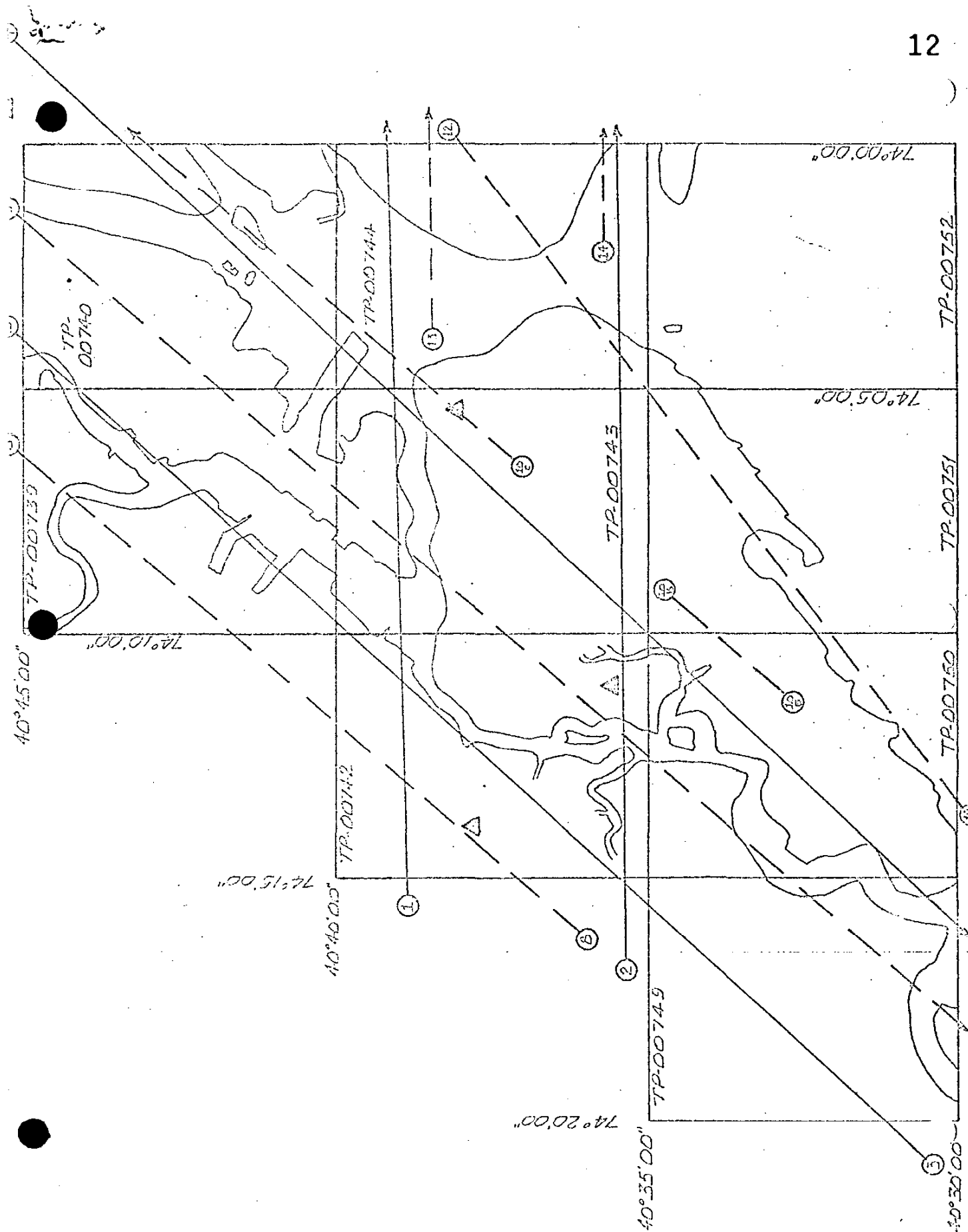

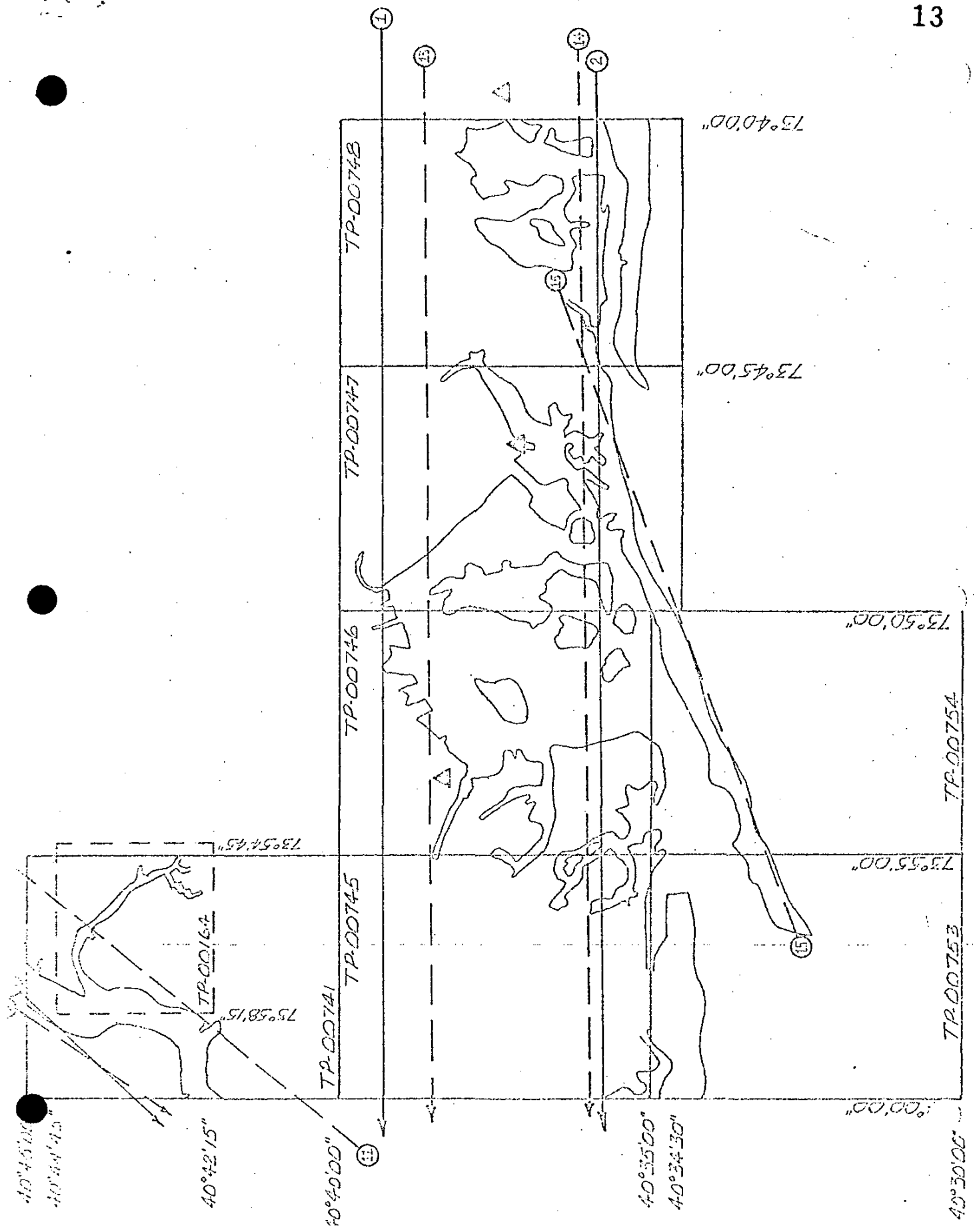

Strip No.	Scale	Photo Nos.
1	50,000	74C(C)864-874
2	"	851-861
3	"	74C(C)892-902
4	"	877-887
5	"	1202-1207
6	30,000	74E(C)6963-6970
No strip numbered 7		
8	30,000	74E(C)7145-7154
9	"	7083-7099
10A	"	7125-7127
10B	"	7131-7133
10C	"	7135-7143
11	"	7076-7082
12	"	7186-7196
13	"	7056-7069
14	"	7040-7052
15	"	7172-7179
16	"	7162-7170
17	"	7197-7202

DESCRIPTIVE REPORT CONTROL RECORD

U.S. DEPARTMENT OF COMMERCE
NATIONAL OCEANIC AND ATMOSPHERIC ADMINISTRATION

MAP NO.	JOB NO.	GEODETIC DATUM	ORIGINATING ACTIVITY		
TP-00746	CM-7301	N.A. 1927	Coastal Mapping Div., Rockville-Md.		
STATION NAME	SOURCE OF INFORMATION (Index)	AEROTRI-ANGULATION POINT NUMBER	COORDINATES IN FEET STATE NEW YORK ZONE EAST	GEOGRAPHIC POSITION φ LATITUDE λ LONGITUDE	REMARKS
BROOKLYN ASH ENGINEER CHY 1931	NY VOL II	35	X=	φ 40-39-12-039	
	CR. P. 87		Y=	λ 73-53-25-103	
PUBLIC SCHOOL #115 1931	NY VOL II	868100	X=	φ 40-38-04-626	Not plotted on manuscript
	CR-P. 4		Y=	λ 73-53-52-488	
			X=	φ	
			Y=	λ	
			X=	φ	
			Y=	λ	
			X=	φ	
			Y=	λ	
			X=	φ	
			Y=	λ	
			X=	φ	
			Y=	λ	
			X=	φ	
			Y=	λ	
			X=	φ	
			Y=	λ	
			X=	φ	
			Y=	λ	
			X=	φ	
			Y=	λ	
COMPUTED BY	N/A	DATE	COMPUTATION CHECKED BY	N/A	DATE
LISTED BY	G. F. FROMM	DATE 11/10/75	LISTING CHECKED BY	G. F. FROMM	DATE NOV 10 1975
HAND PLOTTING BY	N/A	DATE	HAND PLOTTING CHECKED BY	N/A	DATE

TP-00746
Compilation Report

31. Delineation

This map was compiled on the Wild B-8 stereoplotter from 1:30,000 scale natural color photography. Graphic compilation from ratioed prints of the black-and-white, tide-coordinated infrared photography was used to depict the mean low water line and to update the instrument compilation. Refer to paragraph 35.

32. Control

Refer to the Photogrammetric Plot Report bound with this Descriptive Report.

The identification, density, and placement of horizontal and vertical control was adequate.

33. Supplemental Data

None

34. Contours and Drainage

All drainage is from office interpretation of the color photography.

35. Shoreline and Alongshore Details

The MHW line was compiled^d from office interpretation of the color photography.

Alongshore and foreshore features were delineated by office interpretation of the color photography and updated by graphic compilation from the 1975 infrared photography.

* The MLWL was depicted graphically from the black-and-white, tide-coordinated infrared photography. Water penetration is apparent on the infrared photography. Therefore, portions of the foreshore areas depicted on this map may be covered a slight amount at MLW. This also applies to those shoal, or portions of, depicted with the MLW line symbol.

There was no preliminary field inspection of the shoreline.

36. Offshore Details

No unusual problems were encountered in compiling details offshore.

* Refer to REVIEW REPORT, item 67.

37. Landmarks and Aids

Positions of landmarks and nonfloating aids will be verified or located during field edit.

Refer to the 76-40 forms prepared for those landmarks and aids identifiable on the compilation photography.

38. Control for Future Surveys

No form 524 submitted.

39. Junctions

Refer to form 76-36B, item #5, submitted with this Descriptive Report.

40. Horizontal and Vertical Accuracy

This map complies with the National Map Accuracy Standards.

41. thru 45. Inapplicable.

46. Comparison with Existing Maps

A comparison has been made with the following USGS quadrangles:

Coney Island, N.Y.-N.J., Scale 1:24,000, 1966 Edition.
Far Rockaway, N.Y., Scale 1:24,000, 1969 Edition.
Brooklyn, N.Y., Scale 1:24,000, 1967 Edition.
Jamaica, N.Y., Scale 1:24,000, 1966 Edition.

No significant changes were noted.

47. Comparison with Nautical Charts

A comparison has been made with the following nautical charts:

542, Scale 1:20,000, 40th Edition, dated December 15, 1973.
12327 (formerly 369), scale 1:40,000, 64th Edition, dated July 13, 1974.
12328 (formerly 369-SC), scale 1:40,000, 12th Edition, dated February 1, 1975.

Items to be applied to Nautical Charts immediately - None.

Items to be carried forward - None.

Submitted by:

Karin Baker

Karin Baker

Approved and Forwarded:

George W. Baker

COMPILATION OFFICE CHECK LIST

CLASS III MANUSCRIPT

TP - 00746

1. Shoreline and Alongshore Features / 2. Projections /
3. Grids / 4. Title Block / 5. Horizontal Control /
6. Landmarks and Aids to Navigation / 7. NOAA
Form 76-36 / 8. Compilation Report / 9. Compilation
Methods and Procedures / 10. Junctions / 11. Clarity
of Manuscript / 12. Discrepancy Print /

Reviewer
14 Oct 76Supervisor



February 10, 1978

TO: Chief, Photogrammetric Branch

FROM: James Collins (signed) James Collins
Chief, Coastal Mapping Division

SUBJECT: Registration of Job CM-7301, New York Harbor, Raritan
and Jamaica Bays, New York - New Jersey

All manuscripts completed on the subject job shall be registered
as Class III maps.

Field edit data developed to update these maps during 1978 and
subsequent field seasons shall be furnished to the Marine Chart
Division for blueprints.

cc: C3442
C3421
C3424



REVIEW REPORT
TP-00746

Chart Compilation
January 1978

61. General Statement

See Summary, which is pages 7 and 8 of this Descriptive Report. The map was reviewed in its Class III Map (field edit postponed) stage by the Quality Control Group.

62. Comparison with Topographic Surveys - None

63. Comparison with Maps of Other Agencies

Refer to item 46 in the Compilation Report bound with this Descriptive Report.

64. Comparison with Contemporary Hydrographic Surveys

None

65. Comparison with Nautical Charts

Refer to item 47 in the Compilation Report bound with this Descriptive Report.

66. Adequacy of Results and Future Surveys

This map meets the National Standards of Map Accuracy and complies with compilation instructions and Bureau standards.

67. The Mean Low Water Line

Because water penetration is apparent on the ratioed tide-coordinated infrared photography, the outermost photographic image of land, along the water-land interface line, was delineated as the approximate mean low water line. This approach was taken to add an element of boating safety for users of the NOS nautical charts, reconstructed with details taken from this map. Refer to item 35 in the Compilation Report bound with this Descriptive Report.

Submitted by:

Edward L. Rolle

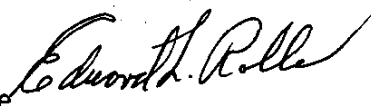

Approved and Forwarded:



Chief, Photogrammetric Branch

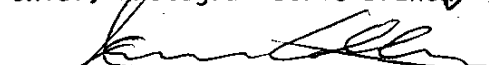

Chief, Coastal Mapping Division

March 24, 1977

GEOGRAPHIC NAMES

FINAL NAME SHEET

CM-7301 (N.Y. Hbr., Raritan & Jamaica Bays, N.Y., N.J.)

TP-00746

Barren Island	Duck Point	Mill Creek
Bergen Beach (locality)	Duck Point Marshes	Nestepol Marsh
Big Egg Marsh	East Mill Basin	Old Mill Creek
Big Fishkill Channel	Elders Point Marsh	Paerdegat Basin
Black Bank Marsh	Fishkill Hassocks	Pumpkin Patch Channel
Black Wall Channel	Floyd Bennett Field	Pumpkin Patch Marsh
Black Wall Marsh	Fresh Creek	Ralph Creek
Canarsie	Hendrix Creek	Ruffle Bar
Canarsie Beach	Horse Channel	Shellbank Basin
Canarsie Pol	Howard Beach (locality)	Spring Creek
Christianpol Marsh	Island Channel	Stony Creek Marsh
Deep Creek	Jamaica Bay	Stony Point
	Little Egg Marsh	Yellow Bar Hassock
	Mill Basin	

Approved by:

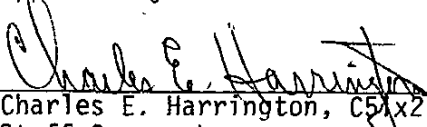
Charles E. Harrington, C51x2
Staff Geographer

76-40
LISTING

PHOTOGRAMMETRIC BRANCH
COASTAL MAPPING DIVISION

ATIONAL OCEAN SURVEY NOAA
DEPARTMENT OF COMMERCE USA

DATATAB
ERSION
770818

* SVY TP-00746 * * RPT UNIT CMD ROCKVILLE, MD. * PAGE 1 OF 2 *
* JOB CM-7301 * NONFLOATING AIDS FOR CHARTS * STATE NEW YORK *
* PRJ N Y HARBOR * TO BE REVISED * LOCALITY JAMAICA BAY * ORIGINATING ACTIVITY *
* DTM NA 1927 * * DATE 09/08/77 * COMPILATION *

* THE FOLLOWING OBJECTS HAVE NOT BEEN INSPECTED FROM SEAWARD TO DETERMINE THEIR VALUE AS LANDMARKS *

DESCRIPTION	POSITION	CMD	METHOD AND DATE	CHARTS
RECORD REASON FOR DELETION	LATITUDE DM	ALTEK	OF LOCATION	
NAME PUT TRIANGULATION NAMES IN ()	LONGITUDE DP	DGTZD	OFFICE FIELD	AFFECTED

JAMAICA BAY				
BEACH CHANNEL				

-LT 7	40 35 06.08	187.5	*74E(C)7045*	542
	73 50 14.70	345.7	* 10/19/74 *	

JAMAICA BAY				
ISLAND CHANNEL				

-RGE	40 36 22.79	703.0	*74E(C)7045*	542
F LT	73 52 47.81	1124.0	* 10/19/74 *	

-RGE	40 36 39.88	1230.1	*74E(C)7045*	542
R LT	73 52 52.90	1243.6	* 10/19/74 *	

TYPE OF ACTION	NAMES OF RESPONSIBLE PERSONNEL	ORIGINATOR
POSITIONS DETERMINED	NO FIELD EDIT-CLASS III MAP	FIELD REPRESENTATIVE
AND/OR VERIFIED BY	K. BAKER	OFFICE COMPILER
FIELD AND OFFICE	L. HARROD	DIGITIZER
ACTIVITIES	G. FROMM	DATA PROCESSER

* SVY TP-00746 * * RPT UNIT CMD ROCKVILLE, MD. * PAGE 2 OF 2 *
* JOB CM-7301 * LANDMARKS FOR CHARTS * STATE NEW YORK *
* PRJ N Y HARBOR * TO BE REVISED * LOCALITY JAMAICA BAY * ORIGINATING ACTIVITY *
* DTM NA 1927 * DATE 09/08/77 * COMPILATION *

* THE FOLLOWING OBJECTS HAVE NOT BEEN INSPECTED FROM SEAWARD TO DETERMINE THEIR VALUE AS LANDMARKS *

CHARTING*	DESCRIPTION	LATITUDE	DM	CMD	METHOD AND DATE	CHARTS
NAME	RECORD REASON FOR DELETION	LONGITUDE	DP	ALTEK	OF LOCATION	AFFECTED
	PUT TRIANGULATION NAMES IN ()			DGTZD	OFFICE	FIELD

CHY		40 38 05.57	171.8	*74E(C)7063*		542
		73 53 53.62	1260.1	* 10/19/74 *		

TALL	(BROWNSVILLE BROOKLYN ASA	40 39 12.04	371.4	NOT *74E(C)7063*		542
STACK	INCINERATOR CHY 1931)	73 53 25.10	589.7	DGTZD* 10/19/74 *		

* CHARTED LDMK(S) NOT VISIBLE ON COMPILATION PHOTOS AND APPEAR
* DESTROYED. APPROX. POSITION(S) SCALED FROM EXISTING CHART. *

TALL		40 36 48.00	1480.6	NOT *		542
CHY		73 54 50.00	1175.4	DGTZD*		

		47.72				
		49.46				

						23
--	--	--	--	--	--	----

TYPE OF ACTION	NAMES OF RESPONSIBLE PERSONNEL	ORIGINATOR
POSITIONS DETERMINED	NO FIELD EDIT-CLASS III MAP	FIELD REPRESENTATIVE
AND/OR VERIFIED BY	K. BAKER	OFFICE COMPILER
FIELD AND OFFICE	L. HARROD	DIGITIZER
ACTIVITIES	G. FROMM	DATA PROCESSOR

TP-0046

National Archives Data

One C&GS Form 152 (Control Station Identification)

Photography: 74-C(C) 868 & 74-E(C) 6868

RECORD OF APPLICATION TO CHARTS

FILE WITH DESCRIPTIVE REPORT OF SURVEY NO.

TP - 00746

INSTRUCTIONS

A basic hydrographic or topographic survey supersedes all information of like nature on the uncorrected chart.

1. Letter all information.
2. In "Remarks" column cross out words that do not apply.
3. Give reasons for deviations, if any, from recommendations made under "Comparison with Charts" in the Review.

[illegible]