

TP-00701

TP-00701

NOAA FORM 76-35 U.S. DEPARTMENT OF COMMERCE NATIONAL OCEANIC AND ATMOSPHERIC ADMINISTRATION NATIONAL OCEAN SURVEY <h2 style="text-align: center;">DESCRIPTIVE REPORT</h2>	
Shoreline <i>Type of Survey</i>	
<i>Job No.</i> CM-7219	<i>Map No.</i> TP-00701
<i>Classification No.</i>	<i>Edition No.</i> 1
Field Edited Map	
<h3>LOCALITY</h3>	
<i>State</i> North Carolina	
<i>General Locality</i> Cape Fear to Cape Lookout	
<i>Locality</i> Masonboro Inlet	
<hr/> 19 72 TO 19 74 <hr/>	
<h3>REGISTRY IN ARCHIVES</h3>	
<i>DATE</i>	

TP-00701
COMPILATION SOURCES

1. COMPILATION PHOTOGRAPHY

CAMERA(S) Wild RC-8 "E", RC-10 "C"		TYPES OF PHOTOGRAPHY LEGEND		TIME REFERENCE	
TIDE STAGE REFERENCE CHARLESTON		(C) COLOR X	ZONE Eastern	MERIDIAN 75th	<input checked="" type="checkbox"/> STANDARD
<input checked="" type="checkbox"/> PREDICTED TIDES Masonboro Inlet		(P) PANCHROMATIC			<input type="checkbox"/> DAYLIGHT
<input type="checkbox"/> REFERENCE STATION RECORDS		(I) INFRARED X			
<input checked="" type="checkbox"/> TIDE CONTROLLED PHOTOGRAPHY					

NUMBER AND TYPE	DATE	TIME	SCALE	STAGE OF TIDE
* 72E(C)6725 - 6727	20 OCT 72	13:45	1:40,000	1.2 ft. above MLW
** 73C(C)(I)4461 - 4963	18 OCT 73	13:47	1:60,000	+0.2 ft. of MHW
** 73C(C)(I)6133 - 6135	11 NOV 73	14:00	1:60,000	+0.2 ft. of MLW

REMARKS
*Bridging and compilation photography
**Tide coordinated photos at MHW and MLW, based on predicted tides.

2. SOURCE OF MEAN HIGH-WATER LINE:

The mean high water line was compiled from office interpretation of the 1972 color photography listed under 1. above and updated graphically by use of the 1973 tide coordinated infrared photographs taken at MHW when they became available.

3. SOURCE OF MEAN LOW-WATER OR MEAN LOWER LOW-WATER LINE:

The mean low water line was compiled graphically from office interpretation of the tide coordinated infrared photographs listed in 1. above.

4. CONTEMPORARY HYDROGRAPHIC SURVEYS (List only those surveys that are sources for photogrammetric survey information.)

SURVEY NUMBER	DATE(S)	SURVEY COPY USED	SURVEY NUMBER	DATE(S)	SURVEY COPY USED

5. FINAL JUNCTIONS

NORTH TP-00699	EAST No Contemporary Survey	SOUTH TP-00703	WEST CM-7218 TP-00673
-------------------	-----------------------------------	-------------------	-----------------------------

REMARKS

TP-00701
HISTORY OF FIELD OPERATIONS

I. FIELD INSPECTION OPERATION FIELD EDIT OPERATION.

OPERATION	NAME	DATE
1. CHIEF OF FIELD PARTY	R.S. Tibbetts	Oct. 1972
2. HORIZONTAL CONTROL	RECOVERED BY ESTABLISHED BY	R.E. Kesselring None
	PRE-MARKED OR IDENTIFIED BY	R.E. Kesselring
	RECOVERED BY	NA
3. VERTICAL CONTROL	ESTABLISHED BY	NA
	PRE-MARKED OR IDENTIFIED BY	NA
	RECOVERED (Triangulation Stations) BY	NA
4. LANDMARKS AND AIDS TO NAVIGATION	LOCATED (Field Methods) BY	NA
	IDENTIFIED BY	NA
	TYPE OF INVESTIGATION	
5. GEOGRAPHIC NAMES INVESTIGATION	<input type="checkbox"/> COMPLETE BY	
	<input type="checkbox"/> SPECIFIC NAMES ONLY	
	<input checked="" type="checkbox"/> NO INVESTIGATION	
6. PHOTO INSPECTION	CLARIFICATION OF DETAILS BY	NA
7. BOUNDARIES AND LIMITS	SURVEYED OR IDENTIFIED BY	NA

II. SOURCE DATA

1. HORIZONTAL CONTROL IDENTIFIED	2. VERTICAL CONTROL IDENTIFIED NA
----------------------------------	--------------------------------------

PHOTO NUMBER	STATION NAME	PHOTO NUMBER	STATION DESIGNATION
72E(C)6727	MASON, 1918		

3. PHOTO NUMBERS (Clarification of details)
None

4. LANDMARKS AND AIDS TO NAVIGATION IDENTIFIED
None

PHOTO NUMBER	OBJECT NAME	PHOTO NUMBER	OBJECT NAME

5. GEOGRAPHIC NAMES: REPORT NONE

6. BOUNDARY AND LIMITS: REPORT NONE

7. SUPPLEMENTAL MAPS AND PLANS
None

8. OTHER FIELD RECORDS (Sketch books, etc. DO NOT list data submitted to the Geodesy Division)

1 Form 152 Control Station Identification

HISTORY OF FIELD OPERATIONS.

I. FIELD INSPECTION OPERATION FIELD EDIT OPERATION.

OPERATION	NAME	DATE
1. CHIEF OF FIELD PARTY	P.B. Walbolt	July, 1974
2. HORIZONTAL CONTROL	RECOVERED BY	NA
	ESTABLISHED BY	NA
	PRE-MARKED OR IDENTIFIED BY	NA
3. VERTICAL CONTROL	RECOVERED BY	NA
	ESTABLISHED BY	NA
	PRE-MARKED OR IDENTIFIED BY	NA
4. LANDMARKS AND AIDS TO NAVIGATION	RECOVERED (<i>Triangulation Stations</i>) BY	P.B. Walbolt
	LOCATED (<i>Field Methods</i>) BY	NA
	IDENTIFIED BY	NA
5. GEOGRAPHIC NAMES INVESTIGATION	TYPE OF INVESTIGATION <input type="checkbox"/> COMPLETE <input type="checkbox"/> SPECIFIC NAMES ONLY <input checked="" type="checkbox"/> NO INVESTIGATION	BY
6. PHOTO INSPECTION	CLARIFICATION OF DETAILS BY	P.B. Walbolt
7. BOUNDARIES AND LIMITS	SURVEYED OR IDENTIFIED BY	NA

II. SOURCE DATA

1. HORIZONTAL CONTROL IDENTIFIED None	2. VERTICAL CONTROL IDENTIFIED NA
--	--------------------------------------

PHOTO NUMBER	STATION NAME	PHOTO NUMBER	STATION DESIGNATION

3. PHOTO NUMBERS (*Clarification of details*)

73C(CI) 6133

4. LANDMARKS AND AIDS TO NAVIGATION ~~RECORDED~~ Verified

Data for objects verified are listed under 8. below

PHOTO NUMBER	OBJECT NAME	PHOTO NUMBER	OBJECT NAME
	WRIGHTSVILLE BEACH NORTH MUNICIPAL WATER TANK, 1962		
	WRIGHTSVILLE BEACH SOUTH MUNICIPAL WATER TANK, 1962		

5. GEOGRAPHIC NAMES: REPORT NONE6. BOUNDARY AND LIMITS: REPORT NONE

7. SUPPLEMENTAL MAPS AND PLANS

None

8. OTHER FIELD RECORDS (*Sketch books, etc. DO NOT list data submitted to the Geodesy Division*)

- 1 Field Edit Report.
- 1 Field Edit Ozalid
- 1 Form 76-40 Landmarks for Charts

TP-00701
RECORD OF SURVEY USE

I. MANUSCRIPT COPIES

COMPILATION STAGES			DATE MANUSCRIPT FORWARDED	
DATA COMPILED	DATE	REMARKS	MARINE CHARTS	HYDRO SUPPORT
Compilation complete pending field edit	Apr. 1973	Class III Manuscript Superseded	None	5/8/73
Field Edit Applied Compilation complete	Jan. 1975	Class I Manuscript Superseded	6/3/75	
Final Review	May, 1976			

II. LANDMARKS AND AIDS TO NAVIGATION

1. REPORTS TO MARINE CHART DIVISION, NAUTICAL DATA BRANCH

NUMBER	CHART LETTER NUMBER ASSIGNED	DATE FORWARDED	REMARKS
2	None	3/17/75	Landmarks to be charted

2. REPORT TO MARINE CHART DIVISION, COAST PILOT BRANCH. DATE FORWARDED: 3/17/75
3. REPORT TO AERONAUTICAL CHART DIVISION, AERONAUTICAL DATA SECTION. DATE FORWARDED: _____

III. FEDERAL RECORDS CENTER DATA

1. BRIDGING PHOTOGRAPHS; DUPLICATE BRIDGING REPORT; COMPUTER READOUTS.
2. CONTROL STATION IDENTIFICATION CARDS; FORM NOS ~~76-40~~ ⁷⁶⁻⁴⁰ SUBMITTED BY FIELD PARTIES.
3. SOURCE DATA (except for Geographic Names Report) AS LISTED IN SECTION II, NOAA FORM 76-36C.
ACCOUNT FOR EXCEPTIONS:
4. DATA TO FEDERAL RECORDS CENTER. DATE FORWARDED: _____

IV. SURVEY EDITIONS (This section shall be completed each time a new map edition is registered)

SECOND EDITION	SURVEY NUMBER	JOB NUMBER	TYPE OF SURVEY	
	TP - _____ (2)	PH - _____	<input type="checkbox"/> REVISED	<input type="checkbox"/> RESURVEY
	DATE OF PHOTOGRAPHY	DATE OF FIELD EDIT	MAP CLASS	
			<input type="checkbox"/> II.	<input type="checkbox"/> III. <input type="checkbox"/> IV. <input type="checkbox"/> V. <input type="checkbox"/> FINAL
THIRD EDITION	SURVEY NUMBER	JOB NUMBER	TYPE OF SURVEY	
	TP - _____ (3)	PH - _____	<input type="checkbox"/> REVISED	<input type="checkbox"/> RESURVEY
	DATE OF PHOTOGRAPHY	DATE OF FIELD EDIT	MAP CLASS	
			<input type="checkbox"/> II.	<input type="checkbox"/> III. <input type="checkbox"/> IV. <input type="checkbox"/> V. <input type="checkbox"/> FINAL
FOURTH EDITION	SURVEY NUMBER	JOB NUMBER	TYPE OF SURVEY	
	TP - _____ (4)	PH - _____	<input type="checkbox"/> REVISED	<input type="checkbox"/> RESURVEY
	DATE OF PHOTOGRAPHY	DATE OF FIELD EDIT	MAP CLASS	
			<input type="checkbox"/> II.	<input type="checkbox"/> III. <input type="checkbox"/> IV. <input type="checkbox"/> V. <input type="checkbox"/> FINAL

WA
W

JOINS JOB CM-7305

ASTAL

Official Mileage for Cost Account:

Sheet No.	Sq. Miles
TP-00684	2
TP-00685	4
TP-00686	4
TP-00687	4
TP-00688	4
TP-00689	4
TP-00692	1
TP-00693	1
TP-00694	3
TP-00696	1
TP-00697	1
TP-00698	3
TP-00699	1
TP-00700	4
TP-00701	4
TP-00702	4
TP-00703	4
TP-00704	4
TP-00705	2

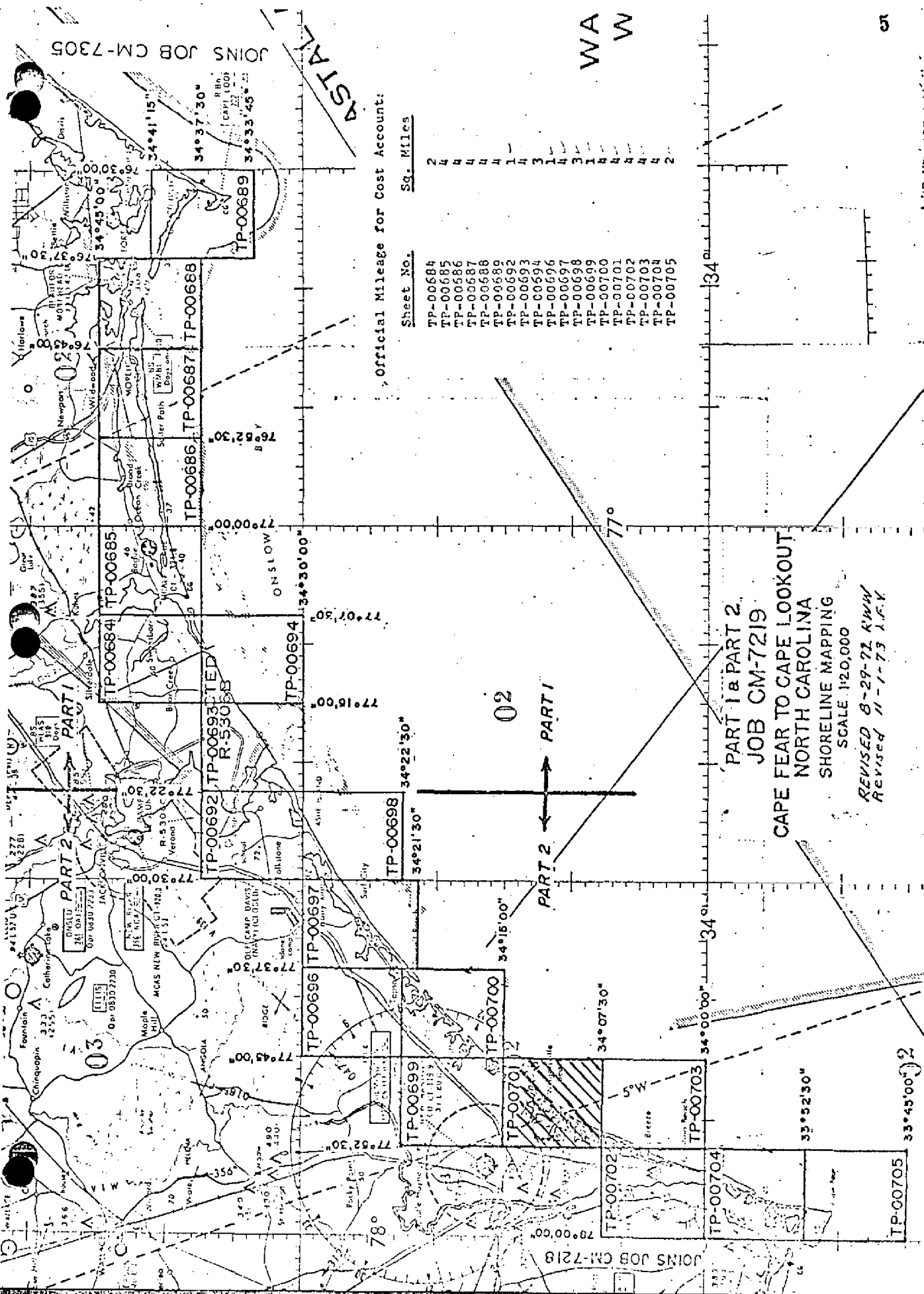

PART 1 & PART 2
 JOB CM-7219
 CAPE FEAR TO CAPE LOOKOUT
 NORTH CAROLINA
 SHORELINE MAPPING
 SCALE 1:20,000
 REVISED 8-29-72 K/W/W
 REVISED 11-1-73 J.G.V.

JOINS JOB CM-7218

33°45'00" 2

SUMMARY TO ACCOMPANY

DESCRIPTIVE REPORTS TP-00692 and TP-00697 through TP-00705

Project CM-7219 is one of several projects that comprise the Southern Coastal Plains Expedition (SCOPE). It is a 1:20,000 scale shoreline mapping project which contains eighteen maps. Except for Map TP-00705, the maps referred to in this summary are not standard shoreline surveys because compilation was limited to the ocean shoreline only, per Instructions - OFFICE - Job CM-7219, Part II, Cape Fear to Cape Lookout, North Carolina, Shoreline Mapping, dated 4/4/73, Items 4.03 and 4.04. The entire area of TP-00705 was mapped; it was copied from a reduction of 1:10,000 scale Map TP-00683 (Job CM-7218) which covers the same area.

This summary is for Part II of the project. It covers the area between New River Inlet and Cape Fear.

Field work prior to compilation consisted of recovery and premarking horizontal control required for bridging and the obtaining of beach profiles. These profiles were not made within the time limit specified in instructions dated September 28, 1972 and were too widely spaced. Therefore, they were considered of no value and were not used as a source for mean high or mean low water lines.

Bridging was done in the Rockville Office in March 1973 using the Zeiss C-8 stereoplanigraph with 1:40,000 scale photography dated October 20, 1972. See Photogrammetric Plot Report following this summary.

Compilation was done at the Atlantic Marine Center in April and May 1973, using the 1972 bridging photography for compilation of interior details and initial compilation of the mean high water line. Later, at the time field edit was applied and the tide coordinated infrared photography (based on predicted tides) was available, the mean high water line was corrected where necessary, to agree with the photographs taken at MHW and the mean low water line was delineated graphically from the MLW photographs.

Field edit was done in May and July 1974, except for the area covered by TP-00705, which was edited in August 1973.

Final review was done at the Atlantic Marine Center in March through June 1976.

The original manuscripts were stabilene sheets $7\frac{1}{2}$ minutes in latitude by $7\frac{1}{2}$ minutes in longitude.

A cronaflex positive copy and a negative of each final reviewed map were forwarded for record and registry.

Photogrammetric Plot Report
Job CM-7219
Cape Fear - Cape Lookout, North Carolina
Part II
March 21, 1973

21. Area Covered

The area covered in this report extends along the North Carolina shoreline from Cape Fear to the vicinity of New River Inlet. Included in this area are 11 T-sheets: TP-00692; TP-00696 thru TP-00705; all are at 1:20,000 scale.

22. Method

Two strips of 1:40,000 color photography were bridged on the Zeiss C-8 stereoplanigraph and adjusted by the IBM computer. The two strips were used to obtain pass point positions for the models and to determine the scale ratio for strips #4, #5, and #6.

Compilation points were positioned on strip #5 to set photos 72E(c) 6756 thru 6760.

Strip #1 (72E(c) 6722 thru 6739) was adjusted on four field identified triangulation stations with five office identified stations as checks.

Strip #2 (72E(c) 6706 thru 6720) was adjusted on five triangulation stations, three tie points and three triangulation stations were used as checks. All horizontal tie points were averaged. T-sheets were ruled on North Carolina plane coordinates and plotted on the Coradomat.

23. Adequacy of Control

Horizontal control complied with project instruction and held within the National Map Accuracy Standard.

24. Supplemental Data

All vertical control needed for adjustment was taken from USGS quadrangles and are approximate mean sea level. The vertical points obtained by bridging are not necessarily true values.

25. Photography

Photography was adequate as to overlap, definition, and coverage.

Respectfully submitted

James E. Schad
James E. Schad

Approved by:

John D. Perrow, Jr.

John D. Perrow, Jr.
Chief, Aerotriangulation Section

NOAA FORM 76-36A (3-72) U. S. DEPARTMENT OF COMMERCE NATIONAL OCEANIC AND ATMOSPHERIC ADMIN. <h3 style="text-align: center;">DESCRIPTIVE REPORT - DATA RECORD</h3>		TYPE OF SURVEY <input checked="" type="checkbox"/> ORIGINAL <input type="checkbox"/> RESURVEY <input type="checkbox"/> REVISED	SURVEY TP. <u>00701</u> MAP EDITION NO. (1) MAP CLASS <u>Final(F.E.)</u> JOB XPH <u>CM-7219</u>
PHOTOGRAMMETRIC OFFICE Coastal Mapping Division, Norfolk, VA OFFICER-IN-CHARGE Jeffrey G. Carlen, CDR.		LAST PRECEDING MAP EDITION TYPE OF SURVEY <input type="checkbox"/> ORIGINAL <input type="checkbox"/> RESURVEY <input type="checkbox"/> REVISED JOB PH. _____ MAP CLASS _____ SURVEY DATES: 19__ TO 19__	
I. INSTRUCTIONS DATED			
1. OFFICE		2. FIELD	
Dec. 4, 1972 Aerotriangulation Apr. 4, 1973 Compilation Apr. 6, 1973 Amend. I	Sept. 15, 1972 Sept. 28, 1972 Amend. I Sept. 21, 1973		
II. DATUMS			
1. HORIZONTAL: <input checked="" type="checkbox"/> 1927 NORTH AMERICAN		OTHER (Specify)	
2. VERTICAL: <input checked="" type="checkbox"/> MEAN HIGH-WATER <input checked="" type="checkbox"/> MEAN LOW-WATER <input type="checkbox"/> MEAN LOWER LOW-WATER <input type="checkbox"/> MEAN SEA LEVEL		OTHER (Specify)	
3. MAP PROJECTION <p style="text-align: center;">Polyconic</p>		4. GRID(S) STATE ZONE North Carolina	
5. SCALE <p style="text-align: center;">1:20,000</p>		STATE ZONE	
III. HISTORY OF OFFICE OPERATIONS			
OPERATIONS		NAME	DATE
1. AEROTRIANGULATION BY METHOD: Stereoplanigraph LANDMARKS AND AIDS BY		J.E. Schad	Mar. 21/73
2. CONTROL AND BRIDGE POINTS PLOTTED BY METHOD: Calcomp. CHECKED BY		D. Phillips	Mar. 21/73
3. STEREOSCOPIC INSTRUMENT PLANIMETRY BY COMPILATION CHECKED BY INSTRUMENT: Wild B-8 CONTOURS BY SCALE: 1:20,000 CHECKED BY		Frank Margiotta L.O. Neterer NA NA	Apr., 1973 Apr., 1973
4. MANUSCRIPT DELINEATION PLANIMETRY BY Wild B-8 and Graphic CHECKED BY METHOD: Smooth drafting CONTOURS BY SCALE: 1:20,000 HYDRO SUPPORT DATA BY CHECKED BY		W.C. Gilbert A.C. Rauck, Jr. NA NA NA NA	Apr., 1973 Apr., 1973
5. OFFICE INSPECTION PRIOR TO FIELD EDIT BY		A.C. Rauck, Jr.	Apr., 1973
6. APPLICATION OF FIELD EDIT DATA BY		R.R. White	Jan., 1975
7. COMPILATION SECTION REVIEW BY		A.L. Shands	Jan., 1975
8. FINAL REVIEW BY		C.H. Bishop	May, 1976
9. DATA FORWARDED TO PHOTOGRAMMETRIC BRANCH BY			
10. DATA EXAMINED IN PHOTOGRAMMETRIC BRANCH BY			
11. MAP REGISTERED - COASTAL SURVEY SECTION BY		R.T. CATDR	ADG 1976

Notes to Compiler
 Job CM-7219
 Cape Fear - Cape Lookout, North Carolina

The shoreline area from the vicinity of Mason Inlet to New Topsoil Inlet (TP-00700) must be compiled from strip #5 (72E(c)6756 thru 6760) either by setting the models or by graphic methods. In order to control this area, "900" series points were determined from bridging strip #2.

Beach cross section points, which were field identified on black/white contact print, have been horizontally positioned from bridging strips #1 and #2 and are identified with "400" series numbers.

Strip # 1	Photo number	Field number
	25401	01-02 (68E 3232)
	25400	03-03 (68E 3232)
	26400	01-01 (68E 3419)
	31400	02-01 (68E 3428)
Strip #2	10400	00-01 (68E 3244)
	14400	97-01 (68E 3249)
	16400	97-02 (68E 3252)
	18400	98-02 (68E 3270)
	19400	98-01 (68E 3272)

Rather of strips 4, 5, and 6 were ordered
JSP

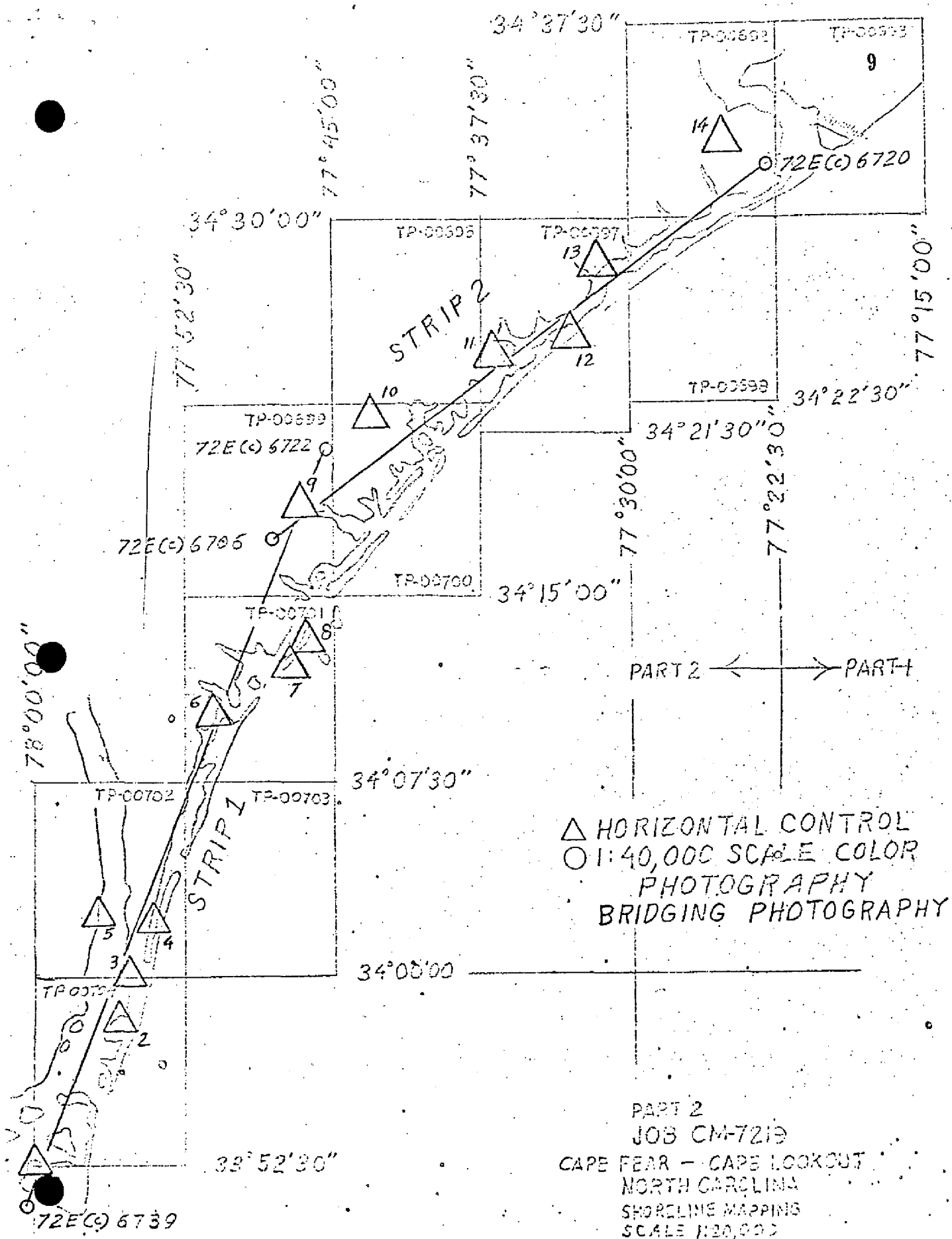

△ HORIZONTAL CONTROL
 ○ 1:40,000 SCALE COLOR
 PHOTOGRAPHY
 BRIDGING PHOTOGRAPHY

PART 2
 JOB CM-7219
 CAPE FEAR - CAPE LOOKOUT
 NORTH CAROLINA
 SHORELINE MAPPING
 SCALE 1:20,000

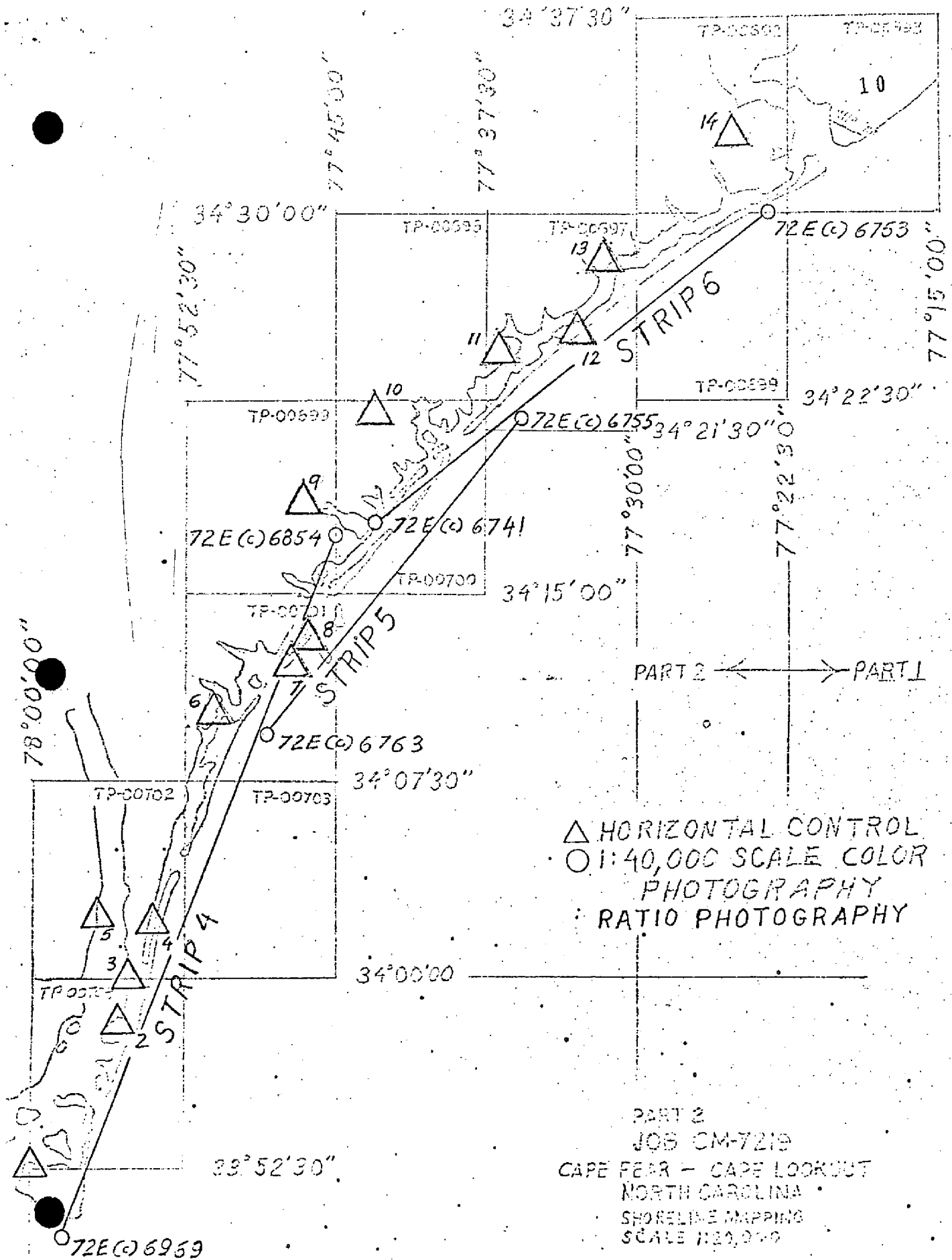

JOB CM-7219

KEY TO HORIZONTAL CONTROL
USE FOR BRIDGING.

1. BALD HEAD LIGHTHOUSE, 1851
2. FEDERAL POINT, 1913
3. KURE BEACH W.T., 1913
4. CAROLINA BEACH MUN. W.T., 1968
5. RUINS, 1917
6. MASON, 1918
7. WRIGHTS VILLE BEACH SOUTH MUN. W.T., 1962
8. WRIGHTS VILLE BEACH NORTH MUN. W.T., 1962
9. KIRKLAND, 1932
10. HAMPSTEAD 2, 1947
11. ATKINSON, 1914
12. SEARS LANDING, TANK 1943
13. BETHEA, 1932
14. GRANT, 1932

DESCRIPTIVE REPORT CONTROL RECORD

MAP NO.	STATION NAME	JOB NO.	GEODETTIC DATUM		AEROTRI- ANGULATION POINT NUMBER	SOURCE OF INFORMATION (Index)	COORDINATES IN FEET		GEOGRAPHIC POSITION		ORIGINATING ACTIVITY		REMARKS
			STATE	ZONE			North Carolina	North Carolina	φ	λ	φ	λ	
TP-00701		CM-7219	N.A.	1927									
JUDY, 1962		Vol. III P. 2855	x=				φ 34 08	λ 59 75902				1841.2	(07.2)
WRIGHTSVILLE BEACH, SOUTH MUNICIPAL WATER TANK, 1962		Vol. III P. 2876	y=				λ 77 50	15.45114				395.8	(1141.3)
WRIGHTSVILLE BEACH, NORTH MUNICIPAL WATER TANK, 1962		Vol. III P. 2877	x=				φ 34 12	02.00053				61.6	(1787.1)
			y=				λ 77 48	05.58495				143.0	(1393.2)
PIER, 1962		Vol. III P. 2856	x=				φ 34 13	08.68501				267.6	(1581.1)
			y=				λ 77 47	18.18922				465.6	(1070.2)
MASON, 1918		Vol. III P. 2957	x=				φ 34 12	51.07425				1573.7	(275.0)
			y=				λ 77 47	24.10732				617.1	(918.9)
			x=				φ 34 10	29.03297				894.6	(954.1)
			y=				λ 77 50	45.94331				1176.7	(360.0)
			x=				φ						
			y=				λ						
			x=				φ						
			y=				λ						
			x=				φ						
			y=				λ						
			x=				φ						
			y=				λ						
COMPUTED BY	A.C. Rauck, Jr.		COMPUTATION CHECKED BY		DATE		W.C. Gilbert					DATE	4/23/73
LISTED BY			LISTING CHECKED BY		DATE							DATE	
HAND PLOTTING BY			HAND PLOTTING CHECKED BY		DATE							DATE	

COMPILATION REPORT

TP-00701

31. DELINEATION

This map was not delineated as a standard shoreline survey. See Summary, page 6 of this Descriptive Report.

Delineation was by the Wild B-8 stereoplotter, using the 1:40,000 scale color photography taken on October 20, 1972 (Bridging photography). Only the outer coast was mapped, per Instructions - OFFICE - dated April 4, 1973, Par. 4.03.

32. CONTROL

See Photogrammetric Plot Report, dated: March 21, 1973.

33. SUPPLEMENTAL DATA

None

34. CONTOURS AND DRAINAGE

Contours are inapplicable. Drainage was delineated from office interpretation of the photographs.

35. SHORELINE AND ALONGSHORE DETAILS

The mean high water line and alongshore details were delineated from office interpretation of the photographs dated October 20, 1972.

36. OFFSHORE DETAILS

None

37. LANDMARKS AND AIDS

Preliminary Forms 76-40, Nonfloating Aids or Landmarks for Charts, were prepared by the Compilation Office and forwarded to the Field Editor and/or the Hydrographer for verification, location, or deletion.

38. CONTROL FOR FUTURE SURVEYS

None

39. JUNCTIONS

See Form 76-36b, Item #5, of the Descriptive Report.

40. HORIZONTAL AND VERTICAL ACCURACY

No statement

46. COMPARISON WITH EXISTING MAPS

A comparison was made with the following Army Map Service
 Quadrangle: WILMINGTON, NORTH CAROLINA, scale 1:62,500, dated
 1948.

47. COMPARISON WITH NAUTICAL CHARTS

A comparison was made with the following National Ocean
 Survey Chart: 833-SC, 10th edition, dated March 1973, scale
 1:40,000.

ITEMS TO BE APPLIED TO NAUTICAL CHARTS IMMEDIATELY

None

ITEMS TO BE CARRIED FORWARD

None

Submitted by:

Albert C. Rauck, Jr. For:
 W.C. Gilbert
 Carto. Aid, April, 1973

Approved:

Albert C. Rauck, Jr.
 Albert C. Rauck, Jr.
 Chief, Coastal Mapping Section, AMC

ADDENDUM TO THE COMPILATION REPORT

TP-00701

FIELD EDIT

Field edit of this map is complete.

At the time of field edit application, the mean high water line compiled from the 1972 color photographs was verified by comparison with the tide coordinated* high water photography listed on Form 76-36b 1. and corrected if necessary. The mean low water line was delineated graphically, using the tide coordinated* low water photography listed on Form 76-36b 1.

*Based on predicted tides.

Charles H. Bishop

Charles H. Bishop
Final Reviewer

28 May 1976

16 Oct. 1975

GEOGRAPHIC NAMES

FINAL NAME SHEET

CM-7219 (Cape Fear to Cape Lookout, N.C.)

TP-00701

Atlantic Ocean

Figure Eight Island

Masonboro Inlet

Mason Inlet

Onslow Bay

Wrightsville Beach

Approved by

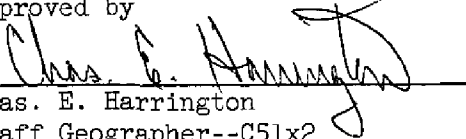
Chas. E. Harrington
Staff Geographer--C51x2

NOAA FORM 75-74 (7-75)		U.S. DEPARTMENT OF COMMERCE NOAA NATIONAL OCEAN SURVEY	
PHOTOGRAMMETRIC OFFICE REVIEW TP - 00701			
1. PROJECTION AND GRIDS ACR	2. TITLE ACR	3. MANUSCRIPT NUMBERS ACR	4. MANUSCRIPT SIZE ACR
CONTROL STATIONS			
5. HORIZONTAL CONTROL STATIONS OF THIRD-ORDER OR HIGHER ACCURACY ACR	6. RECOVERABLE HORIZONTAL STATIONS OF LESS THAN THIRD-ORDER ACCURACY (Topographic stations) NA		7. PHOTO HYDRO STATIONS NA
8. BENCH MARKS NA	9. PLOTTING OF SEXTANT FIXES	10. PHOTOGRAMMETRIC PLOT REPORT ACR	11. DETAIL POINTS ACR
ALONGSHORE AREAS (Nautical Chart Data)			
12. SHORELINE ACR	13. LOW-WATER LINE ACR	14. ROCKS, SHOALS, ETC. ACR	15. BRIDGES ACR
16. AIDS TO NAVIGATION	17. LANDMARKS	18. OTHER ALONGSHORE PHYSICAL FEATURES ACR	19. OTHER ALONGSHORE CULTURAL FEATURES ACR
PHYSICAL FEATURES			
20. WATER FEATURES ACR	21. NATURAL GROUND COVER NA		22. PLANETABLE CONTOURS NA
23. STEREOSCOPIC INSTRUMENT CONTOURS NA	24. CONTOURS IN GENERAL NA	25. SPOT ELEVATIONS NA	26. OTHER PHYSICAL FEATURES ACR
CULTURAL FEATURES			
27. ROADS ACR	28. BUILDINGS ACR	29. RAILROADS ACR	30. OTHER CULTURAL FEATURES ACR
BOUNDARIES			
31. BOUNDARY LINES NA		32. PUBLIC LAND LINES NA	
MISCELLANEOUS			
33. GEOGRAPHIC NAMES ACR		34. JUNCTIONS ACR	35. LEGIBILITY OF THE MANUSCRIPT ACR
36. DISCREPANCY OVERLAY ACR	37. DESCRIPTIVE REPORT	38. FIELD INSPECTION PHOTOGRAPHS NA	39. FORMS ACR
40. REVIEWER <i>Albert C. Rauck, Jr.</i>		SUPERVISOR, REVIEW SECTION OR UNIT <i>Albert C. Rauck, Jr.</i> Albert C. Rauck, Jr.	
41. REMARKS (See attached sheet)			
FIELD COMPLETION ADDITIONS AND CORRECTIONS TO THE MANUSCRIPT			
42. Additions and corrections furnished by the field completion survey have been applied to the manuscript. The manuscript is now complete except as noted under item 43.			
COMPILER Richard R. White <i>RR White</i> 1/1975		SUPERVISOR <i>Albert C. Rauck, Jr.</i> Albert C. Rauck, Jr.	
Reviewed: A.L. Shands 1/1975			
43. REMARKS <i>ad. Sta</i> Field edit applied from: The field edit ozalid and field Photo 730(C)6133(I)			

FIELD EDIT FOR SHEET TP-00701
MASONBORO INLET; Job CM-7210, part 2

51. METHODS

This manuscript was inspected by truck, by walking the beach, and by boat. As per Paragraph 2 of Letter C344 dated 28 May 1974, it was determined that no extensive changes have occurred.

52. ACCURACY OF COMPILATION

The accuracy is good.

54. RECOMMENDATIONS

The note "Area Subject to Frequent Change" should be applied to both inlets. The geographic name "Figure Eight Island" should be placed on the northeast portion of the map as indicated; "Masonboro Island" should be as shown on the southwest portion. The breakwater at Masonboro Inlet extends farther inland, as shown on photo # 6133. A portion of one road is deleted. Two Nautical Landmarks should be charted. The geographic name "Carolina Beach" should be deleted from this map.

Philip B. Walbolt

Philip B. Walbolt
Chief, Photo Party 63

REVIEW REPORT TP-00701

SHORELINE

May 28, 1976

61. GENERAL STATEMENT:

See Summary, which is page 6 of this Descriptive Report.

A comparison print showing differences noted in Par. 63 and 65 is bound with the original of this report.

62. COMPARISON WITH REGISTERED TOPOGRAPHIC SURVEYS:

There are no registered topographic surveys of the area later than 1933. No comparison was made.

In the area mapped, TP-00701 supersedes prior registered surveys for nautical chart construction purposes.

63. COMPARISON WITH MAPS OF OTHER AGENCIES:

A comparison was made with Army Map Service Quadrangle WILMINGTON, NORTH CAROLINA, 1:62,500 scale, AMS 3, 1948. Significant differences are shown in brown on the comparison print.

64. COMPARISON WITH CONTEMPORARY HYDROGRAPHIC SURVEYS:

A comparison was made with a copy of the verified smooth sheet for Survey H-9396 (PE-40-2-74). The only area compared was the 1:10,000 scale insert that covers Masonboro Inlet, an area that is subject to frequent change. The hydrography indicates that the shoal that was indicated on the photogrammetric manuscript shifted between the time of photography and the time of the hydrographic survey, thus making the limit lines of this feature on Map TP-00701 obsolete. They were removed from the manuscript during Final Review. No shoreline changes were made.

65. COMPARISON WITH NAUTICAL CHARTS:

A comparison was made with Chart 11541, scale 1:40,000, 12th edition, dated March 1975. Significant differences are shown in red on the comparison print.

66. ADEQUACY OF RESULTS AND FUTURE SURVEYS:

This map complies with Instructions - OFFICE - Job CM-7219, Part II, Cape Fear to Cape Lookout, North Carolina, Shoreline Mapping, and meets requirements for Bureau Standards and the National Standards of Map Accuracy.

Submitted:

Charles H. Bishop

Charles H. Bishop
Cartographer
28 May 1976

Approved for forwarding:

Joseph W. Vonasek

Joseph W. Vonasek
Chief, Photogrammetric Branch, AMC

Approved: *S. G. Blankenbush*

For A. K. Heywood

Chief, Photogrammetric Branch

Nathan S. ...

Chief, Coastal Mapping Division

X=2,370,000FT.

47'

77°46'

34°15'00"

Figure Island Eight

Mason Inlet

Area subject to frequent change

Breakers

14'

COMPARISON PRINT

Red = Chart 11541

Brown = AMS Quad

None of the charted piers were visible on photos or in existence at the time of field edit.

WRIGHTSVILLE BEACH
NORTH MUNICIPAL WATER
TANK 1962
Ht=140 (145) Ft

PIER 1962

No charted pier at this position

13'

TP-00701
1:20,000

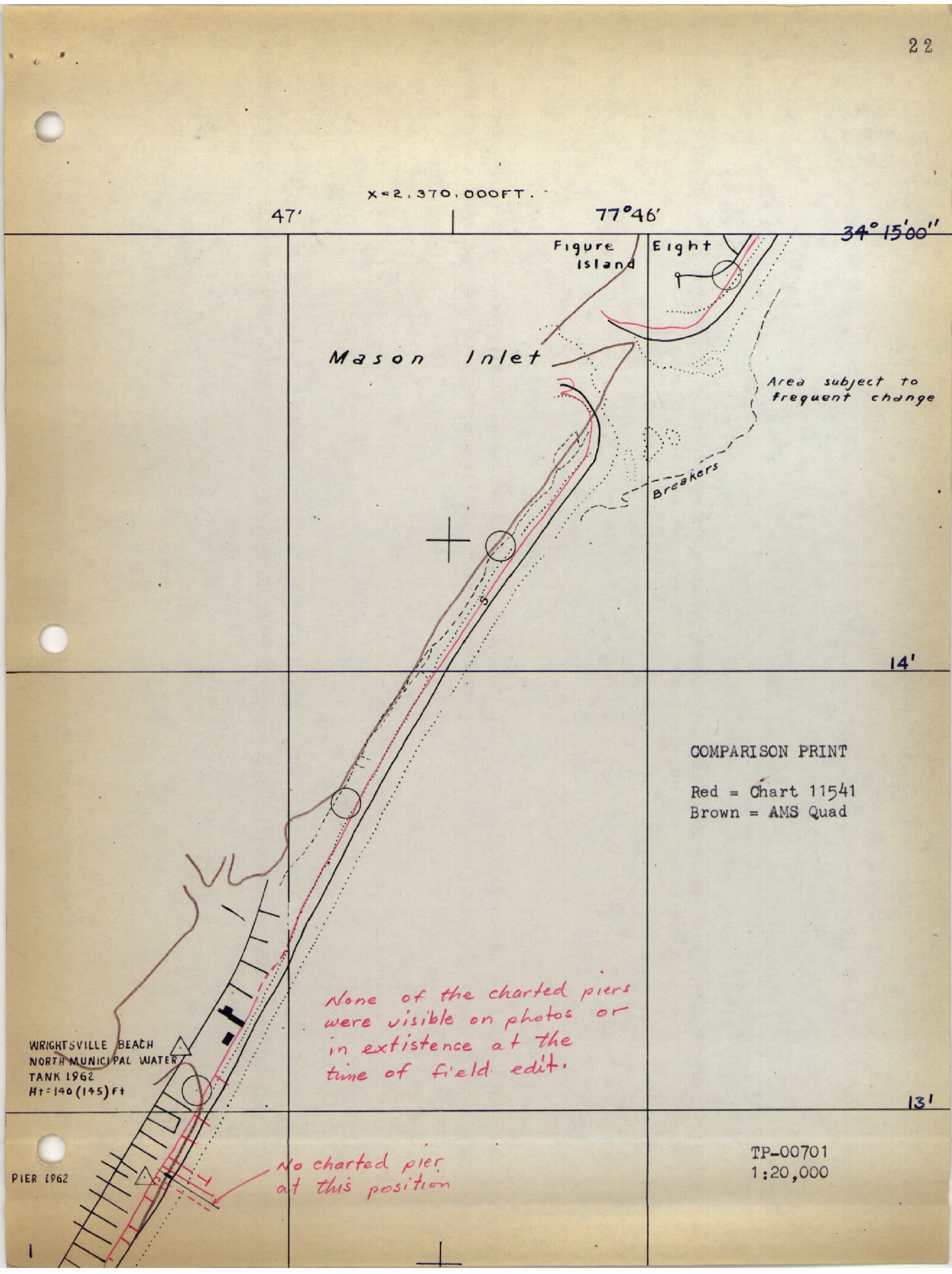

77°49'

48'

W R
B E

23

WRIGHTSVILLE BEACH
SOUTH MUNICIPAL WATER
TANK 1962
Ht = 143 (140) Ft

12'

Pier charted longer
than pier on photo.
Other piers or groins
not visible on photos
or in existence at
time of field edit.

Masonboro Inlet

Area subject to
frequent change

Jetty and
Breakwater

COMPARISON PRINT

Red = Chart 11541
Brown = AMS Quad

NOTE:

"The photogrammetric location and delineation
offshore from the mean high-water line on
may not be complete or final. The con-
reviewed hydrographic survey of the area w
should be consulted for the final delin-

34° 10' 00"

TP-00701
1:20,000



Wreck neither visible on photos or found by field editor.

JUDY 1962

09'

08'

COMPARISON PRINT

Red = Chart 11541
Brown = AMS Quad

34° 07' 30"

51'

x = 2.350.000 FT.

77° 50'



NOTE: Unlabeled circles are photogrammetric plot points; not map features

LEGEND

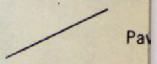

TP-00701
1:20,000

