

TP-00699



TP-00699

| | |
|---|-------------------------|
| NOAA FORM 76-35 | |
| U.S. DEPARTMENT OF COMMERCE NATIONAL OCEANIC AND ATMOSPHERIC ADMINISTRATION NATIONAL OCEAN SURVEY | |
| DESCRIPTIVE REPORT | |
| Shoreline | |
| Type of Survey | |
| Job No. CM-7219 | Map No. TP-00699 |
| Classification No. | Edition No. . . 1 |
| Field Edited Map | |
| LOCALITY | |
| State .. North Carolina | |
| General Locality .. Cape Fear to Cape Lookout | |
| Locality .. Page Creek | |
| | |
| <hr/> 1972 TO 1974 <hr/> | |
| REGISTRY IN ARCHIVES | |
| DATE | |

| | | | |
|--|--|---|---|
| NOAA FORM 76-36A (3-72) U. S. DEPARTMENT OF COMMERCE NATIONAL OCEANIC AND ATMOSPHERIC ADMIN. <h3 style="text-align: center;">DESCRIPTIVE REPORT - DATA RECORD</h3> | | TYPE OF SURVEY <input checked="" type="checkbox"/> ORIGINAL <input type="checkbox"/> RESURVEY <input type="checkbox"/> REVISED | SURVEY TP. <u>00699</u> MAP EDITION NO. <u>(1)</u> MAP CLASS <u>Final (F.E.)</u> JOB <u>XPX</u> <u>CM-7219</u> |
| PHOTOGRAMMETRIC OFFICE Coastal Mapping Division, Norfolk, VA OFFICER-IN-CHARGE Jeffrey G. Carlen, CDR. | | LAST PRECEDING MAP EDITION TYPE OF SURVEY <input type="checkbox"/> ORIGINAL <input type="checkbox"/> RESURVEY <input type="checkbox"/> REVISED JOB PH. _____ MAP CLASS _____ SURVEY DATES: 19__ TO 19__ | |
| I. INSTRUCTIONS DATED | | | |
| 1. OFFICE | | 2. FIELD | |
| Dec. 4, 1972 Aerotriangulation Apr. 4, 1973 Compilation Apr. 4, 1973 Amend. I | Sept. 15, 1972 Sept. 28, 1972 Amend. I Sept. 21, 1973 | | |
| II. DATUMS | | | |
| 1. HORIZONTAL: <input checked="" type="checkbox"/> 1927 NORTH AMERICAN | | OTHER (Specify) | |
| 2. VERTICAL: <input checked="" type="checkbox"/> MEAN HIGH-WATER <input checked="" type="checkbox"/> MEAN LOW-WATER <input type="checkbox"/> MEAN LOWER LOW-WATER <input type="checkbox"/> MEAN SEA LEVEL | | OTHER (Specify) | |
| 3. MAP PROJECTION Polyconic | | 4. GRID(S) STATE ZONE North Carolina | |
| 5. SCALE 1:20,000 | | STATE ZONE | |
| III. HISTORY OF OFFICE OPERATIONS | | | |
| OPERATIONS | | NAME | DATE |
| 1. AEROTRIANGULATION BY METHOD: Stereoplanigraph LANDMARKS AND AIDS BY | | J.E. Schad | Mar. 21/73 |
| 2. CONTROL AND BRIDGE POINTS PLOTTED BY METHOD: Calcomp. CHECKED BY | | D. Phillips | Mar. 21/73 |
| 3. STEREOSCOPIIC INSTRUMENT PLANIMETRY BY COMPILATION CHECKED BY INSTRUMENT: Wild B-8 CONTOURS BY SCALE: 1:20,000 CHECKED BY | | Frank Margiotta L.O. Neterer NA NA | Apr., 1973 Apr., 1973 |
| 4. MANUSCRIPT DELINEATION PLANIMETRY BY CHECKED BY METHOD: Wild B-8 and graphic CONTOURS BY CHECKED BY SCALE: 1:20,000 HYDRO SUPPORT DATA BY CHECKED BY | | L.B. Foltz A.C. Rauck, Jr. NA NA NA NA | Apr., 1973 Apr., 1973 |
| 5. OFFICE INSPECTION PRIOR TO FIELD EDIT BY | | A.C. Rauck, Jr. | Apr., 1973 |
| 6. APPLICATION OF FIELD EDIT DATA BY | | R.B. White | Jan., 1975 |
| 7. COMPILATION SECTION REVIEW BY | | A.L. Shands | Jan., 1975 |
| 8. FINAL REVIEW BY | | A.L. Shands | Jan., 1975 |
| 9. DATA FORWARDED TO PHOTOGRAMMETRIC BRANCH BY | | C.H. Bishop | May, 1976 |
| 10. DATA EXAMINED IN PHOTOGRAMMETRIC BRANCH BY | | | |
| 11. MAP REGISTERED - COASTAL SURVEY SECTION BY | | R.T. CATDR | ADG 1976 |

| NOAA FORM 76-36B (3-72) | | U. S. DEPARTMENT OF COMMERCE NATIONAL OCEANIC AND ATMOSPHERIC ADMINISTRATION NATIONAL OCEAN SURVEY | | | |
|--|------------------|--|-----------------------------|-------------------|--|
| TP-00699 COMPILATION SOURCES | | | | | |
| 1. COMPILATION PHOTOGRAPHY | | | | | |
| CAMERA(S) Wild RC-8 "E", RC-10 "C" | | TYPES OF PHOTOGRAPHY LEGEND | | TIME REFERENCE | |
| TIDE STAGE REFERENCE CHARLESTON | | (C) COLOR X (P) PANCHROMATIC (I) INFRARED X | | ZONE Eastern | <input checked="" type="checkbox"/> STANDARD |
| <input checked="" type="checkbox"/> PREDICTED TIDES Masonboro Inlet <input type="checkbox"/> REFERENCE STATION RECORDS <input checked="" type="checkbox"/> TIDE CONTROLLED PHOTOGRAPHY | | | | MERIDIAN 75th | <input type="checkbox"/> DAYLIGHT |
| NUMBER AND TYPE | DATE | TIME | SCALE | STAGE OF TIDE | |
| * 72E(C)6723 - 6725 | 20 OCT 72 | 13:45 | 1:40,000 | 1.2 ft. above MLW | |
| ** 73C(C)(I)4963 - 4964 | 18 OCT 73 | 13:47 | 1:60,000 | +0.2 ft. of MHW | |
| ** 73C(C)(I)6135 - 6136 | 11 NOV 73 | 14:00 | 1:60,000 | +0.2 ft. of MLW | |
| REMARKS *Bridge and compilation photos. **Tide coordinated photos at MHW and MLW. | | | | | |
| 2. SOURCE OF MEAN HIGH-WATER LINE: The mean high water line was compiled from office interpretation of the 1972 color photography listed under 1. above and updated graphically by use of the 1973 tide coordinated infrared photographs taken at MHW when they became available. | | | | | |
| 3. SOURCE OF MEAN LOW-WATER OR MEAN LOWER LOW-WATER LINE: The mean low water line was compiled graphically from office interpretation of the tide coordinated infrared photographs listed in 1. above. | | | | | |
| 4. CONTEMPORARY HYDROGRAPHIC SURVEYS (List only those surveys that are sources for photogrammetric survey information.) | | | | | |
| SURVEY NUMBER | DATE(S) | SURVEY COPY USED | SURVEY NUMBER | DATE(S) | SURVEY COPY USED |
| | | | | | |
| 5. FINAL JUNCTIONS | | | | | |
| NORTH No contemporary Survey | EAST TP-00700 | SOUTH TP-00701 | WEST CM-7218 TP-00670 | | |
| REMARKS | | | | | |

NOAA FORM 76-36C
(3-72)

TP-00699

U. S. DEPARTMENT OF COMMERCE
NATIONAL OCEANIC AND ATMOSPHERIC ADMINISTRATION
NATIONAL OCEAN SURVEY

HISTORY OF FIELD OPERATIONS

I. FIELD INSPECTION OPERATION FIELD EDIT OPERATION

| OPERATION | NAME | DATE |
|--|---|-----------------|
| 1. CHIEF OF FIELD PARTY | R.S. Tibbetts | Oct., 1972 |
| 2. HORIZONTAL CONTROL | RECOVERED BY | R.E. Kesselring |
| | ESTABLISHED BY | None |
| | PRE-MARKED OR IDENTIFIED BY | R.E. Kesselring |
| 3. VERTICAL CONTROL | RECOVERED BY | NA |
| | ESTABLISHED BY | NA |
| | PRE-MARKED OR IDENTIFIED BY | NA |
| 4. LANDMARKS AND AIDS TO NAVIGATION | RECOVERED (<i>Triangulation Stations</i>) BY | NA |
| | LOCATED (<i>Field Methods</i>) BY | NA |
| | IDENTIFIED BY | NA |
| 5. GEOGRAPHIC NAMES INVESTIGATION | TYPE OF INVESTIGATION | |
| | <input type="checkbox"/> COMPLETE BY | |
| | <input type="checkbox"/> SPECIFIC NAMES ONLY BY | |
| <input checked="" type="checkbox"/> NO INVESTIGATION | | |
| 6. PHOTO INSPECTION | CLARIFICATION OF DETAILS BY | None |
| 7. BOUNDARIES AND LIMITS | SURVEYED OR IDENTIFIED BY | NA |

II. SOURCE DATA

| 1. HORIZONTAL CONTROL IDENTIFIED | | 2. VERTICAL CONTROL IDENTIFIED | |
|----------------------------------|----------------|--------------------------------|---------------------|
| | | NA | |
| PHOTO NUMBER | STATION NAME | PHOTO NUMBER | STATION DESIGNATION |
| 72E(C)6723 | KIRKLAND, 1932 | | |

3. PHOTO NUMBERS (*Clarification of details*)

None

4. LANDMARKS AND AIDS TO NAVIGATION IDENTIFIED

None

| PHOTO NUMBER | OBJECT NAME | PHOTO NUMBER | OBJECT NAME |
|--------------|-------------|--------------|-------------|
| | | | |

5. GEOGRAPHIC NAMES: REPORT NONE6. BOUNDARY AND LIMITS: REPORT NONE

7. SUPPLEMENTAL MAPS AND PLANS

None

8. OTHER FIELD RECORDS (*Sketch books, etc. DO NOT list data submitted to the Geodesy Division*)

- 1 Form 152 Control Station Identification Card
- 2 Pages MA-100 Tellurometer Observations

TP-00699

HISTORY OF FIELD OPERATIONS

| I. <input type="checkbox"/> FIELD INSPECTION OPERATION | | <input checked="" type="checkbox"/> FIELD EDIT OPERATION | |
|---|---|--|---------------------|
| OPERATION | NAME | DATE | |
| 1. CHIEF OF FIELD PARTY | Philip B. Walbolt | July, 1974 | |
| 2. HORIZONTAL CONTROL | RECOVERED BY ESTABLISHED BY PRE-MARKED OR IDENTIFIED BY | Philip B. Walbolt | July, 1974 |
| | | NA | |
| | | NA | |
| 3. VERTICAL CONTROL | RECOVERED BY ESTABLISHED BY PRE-MARKED OR IDENTIFIED BY | NA | |
| | | NA | |
| | | NA | |
| 4. LANDMARKS AND AIDS TO NAVIGATION | RECOVERED (<i>Triangulation Stations</i>) BY LOCATED (<i>Field Methods</i>) BY IDENTIFIED BY | None | |
| | | None | |
| | | None | |
| 5. GEOGRAPHIC NAMES INVESTIGATION | TYPE OF INVESTIGATION <input type="checkbox"/> COMPLETE BY <input type="checkbox"/> SPECIFIC NAMES ONLY <input checked="" type="checkbox"/> NO INVESTIGATION | | |
| 6. PHOTO INSPECTION | CLARIFICATION OF DETAILS BY | None | |
| 7. BOUNDARIES AND LIMITS | SURVEYED OR IDENTIFIED BY | NA | |
| II. SOURCE DATA | | | |
| 1. HORIZONTAL CONTROL IDENTIFIED | | 2. VERTICAL CONTROL IDENTIFIED | |
| None | | NA | |
| PHOTO NUMBER | STATION NAME | PHOTO NUMBER | STATION DESIGNATION |
| | | | |
| 3. PHOTO NUMBERS (<i>Clarification of details</i>) | | | |
| None | | | |
| 4. LANDMARKS AND AIDS TO NAVIGATION IDENTIFIED | | | |
| None | | | |
| PHOTO NUMBER | OBJECT NAME | PHOTO NUMBER | OBJECT NAME |
| | | | |
| 5. GEOGRAPHIC NAMES: <input type="checkbox"/> REPORT <input checked="" type="checkbox"/> NONE | | 6. BOUNDARY AND LIMITS: <input type="checkbox"/> REPORT <input checked="" type="checkbox"/> NONE | |
| 7. SUPPLEMENTAL MAPS AND PLANS | | | |
| None | | | |
| 8. OTHER FIELD RECORDS (<i>Sketch books, etc. DO NOT list data submitted to the Geodesy Division</i>) | | | |
| Field Edit Report Field Edit Ozalid | | | |

RECORD OF SURVEY USE

I. MANUSCRIPT COPIES

| COMPILATION STAGES | | | DATE MANUSCRIPT FORWARDED | |
|--|------------|------------------------------------|---------------------------|---------------|
| DATA COMPILED | DATE | REMARKS | MARINE CHARTS | HYDRO SUPPORT |
| Compilation complete pending field edit | Apr., 1973 | Class III Manuscript Superseded | None | 5/8/73 |
| Field edit applied Compilation complete | Jan., 1975 | Class I Manuscript Superseded | 6/3/75 | |
| Final Review | May, 1976 | | | |
| | | | | |

II. LANDMARKS AND AIDS TO NAVIGATION None

1. REPORTS TO MARINE CHART DIVISION, NAUTICAL DATA BRANCH

| NUMBER | CHART LETTER NUMBER ASSIGNED | DATE FORWARDED | REMARKS |
|--------|---------------------------------|-------------------|---------|
| | | | |
| | | | |
| | | | |
| | | | |
| | | | |
| | | | |
| | | | |
| | | | |

2. REPORT TO MARINE CHART DIVISION, COAST PILOT BRANCH. DATE FORWARDED: _____
3. REPORT TO AERONAUTICAL CHART DIVISION, AERONAUTICAL DATA SECTION. DATE FORWARDED: _____

III. FEDERAL RECORDS CENTER DATA

1. BRIDGING PHOTOGRAPHS; DUPLICATE BRIDGING REPORT; COMPUTER READOUTS.
2. CONTROL STATION IDENTIFICATION CARDS; FORM NOS 567 SUBMITTED BY FIELD PARTIES.
3. SOURCE DATA (except for Geographic Names Report) AS LISTED IN SECTION II, NOAA FORM 76-36C.
ACCOUNT FOR EXCEPTIONS:
4. DATA TO FEDERAL RECORDS CENTER. DATE FORWARDED: _____

IV. SURVEY EDITIONS (This section shall be completed each time a new map edition is registered)

| | | | |
|-------------------|---------------------------------|--------------------------|---|
| SECOND EDITION | SURVEY NUMBER TP - _____ (2) | JOB NUMBER PH - _____ | TYPE OF SURVEY <input type="checkbox"/> REVISED <input type="checkbox"/> RESURVEY |
| | DATE OF PHOTOGRAPHY | DATE OF FIELD EDIT | MAP CLASS <input type="checkbox"/> II. <input type="checkbox"/> III. <input type="checkbox"/> IV. <input type="checkbox"/> V. <input type="checkbox"/> FINAL |
| THIRD EDITION | SURVEY NUMBER TP - _____ (3) | JOB NUMBER PH - _____ | TYPE OF SURVEY <input type="checkbox"/> REVISED <input type="checkbox"/> RESURVEY |
| | DATE OF PHOTOGRAPHY | DATE OF FIELD EDIT | MAP CLASS <input type="checkbox"/> II. <input type="checkbox"/> III. <input type="checkbox"/> IV. <input type="checkbox"/> V. <input type="checkbox"/> FINAL |
| FOURTH EDITION | SURVEY NUMBER TP - _____ (4) | JOB NUMBER PH - _____ | TYPE OF SURVEY <input type="checkbox"/> REVISED <input type="checkbox"/> RESURVEY |
| | DATE OF PHOTOGRAPHY | DATE OF FIELD EDIT | MAP CLASS <input type="checkbox"/> II. <input type="checkbox"/> III. <input type="checkbox"/> IV. <input type="checkbox"/> V. <input type="checkbox"/> FINAL |

JOINS JOB CM-7305

ASTAL

WA
W

Official Mileage for Cost Account:

| Sheet No. | Sq. Miles |
|-----------|-----------|
| TP-00684 | 2 |
| TP-00685 | 4 |
| TP-00686 | 4 |
| TP-00687 | 4 |
| TP-00688 | 4 |
| TP-00689 | 4 |
| TP-00692 | 1 |
| TP-00693 | 1 |
| TP-00694 | 3 |
| TP-00696 | 1 |
| TP-00697 | 4 |
| TP-00698 | 3 |
| TP-00699 | 1 |
| TP-00700 | 1 |
| TP-00701 | 4 |
| TP-00702 | 4 |
| TP-00703 | 4 |
| TP-00704 | 4 |
| TP-00705 | 2 |

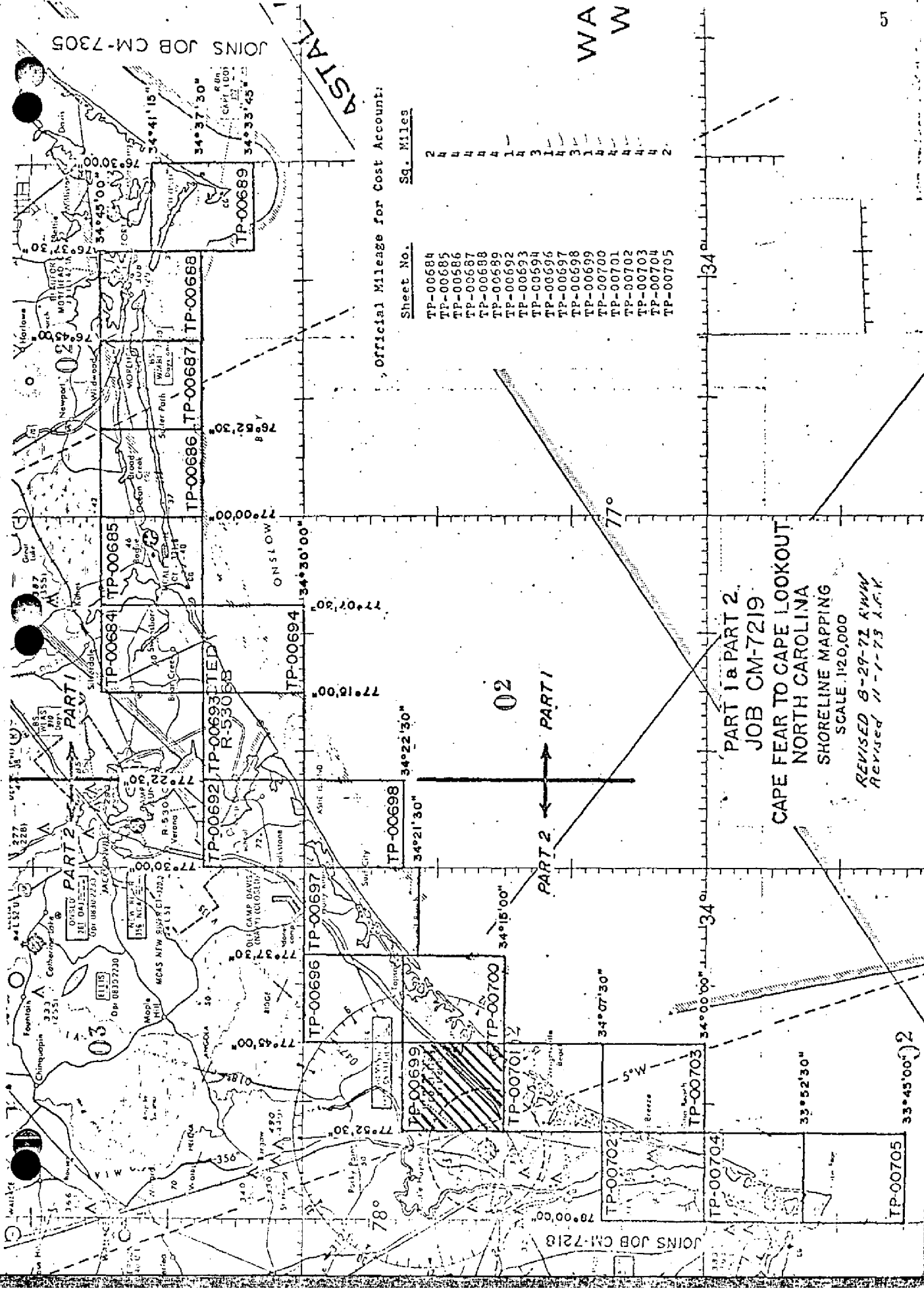

PART 1 & PART 2
 JOB CM-7219
 CAPE FEAR TO CAPE LOOKOUT
 NORTH CAROLINA
 SHORELINE MAPPING
 SCALE 1:20,000
 REVISED 8-29-73 KWW
 REVISED 11-1-73 A.G.K.

JOINS JOB CM-7218

33° 45' 00" 2

SUMMARY TO ACCOMPANY

DESCRIPTIVE REPORTS TP-00692 and TP-00697 through TP-00705

Project CM-7219 is one of several projects that comprise the Southern Coastal Plains Expedition (SCOPE). It is a 1:20,000 scale shoreline mapping project which contains eighteen maps. Except for Map TP-00705, the maps referred to in this summary are not standard shoreline surveys because compilation was limited to the ocean shoreline only, per Instructions - OFFICE - Job CM-7219, Part II, Cape Fear to Cape Lockout, North Carolina, Shoreline Mapping, dated 4/4/73, Items 4.03 and 4.04. The entire area of TP-00705 was mapped; it was copied from a reduction of 1:10,000 scale Map TP-00683 (Job CM-7218) which covers the same area.

This summary is for Part II of the project. It covers the area between New River Inlet and Cape Fear.

Field work prior to compilation consisted of recovery and premarking horizontal control required for bridging and the obtaining of beach profiles. These profiles were not made within the time limit specified in instructions dated September 28, 1972 and were too widely spaced. Therefore, they were considered of no value and were not used as a source for mean high or mean low water lines.

Bridging was done in the Rockville Office in March 1973 using the Zeiss C-8 stereoplanigraph with 1:40,000 scale photography dated October 20, 1972. See Photogrammetric Plot Report following this summary.

Compilation was done at the Atlantic Marine Center in April and May 1973, using the 1972 bridging photography for compilation of interior details and initial compilation of the mean high water line. Later, at the time field edit was applied and the tide coordinated infrared photography (based on predicted tides) was available, the mean high water line was corrected where necessary, to agree with the photographs taken at MHW and the mean low water line was delineated graphically from the MLW photographs.

Field edit was done in May and July 1974, except for the area covered by TP-00705, which was edited in August 1973.

Final review was done at the Atlantic Marine Center in March through June 1976.

The original manuscripts were stabilene sheets $7\frac{1}{2}$ minutes in latitude by $7\frac{1}{2}$ minutes in longitude.

A cronaflex positive copy and a negative of each final reviewed map were forwarded for record and registry.

Photogrammetric Plot Report

Job CM-7219

Cape Fear - Cape Lookout, North Carolina

Part II

March 21, 1973

21. Area Covered

The area covered in this report extends along the North Carolina shoreline from Cape Fear to the vicinity of New River Inlet. Included in this area are 11 T-sheets: TP-00692; TP-00696 thru TP-00705; all are at 1:20,000 scale.

22. Method

Two strips of 1:40,000 color photography were bridged on the Zeiss C-8 stereoplanigraph and adjusted by the IBM computer. The two strips were used to obtain pass point positions for the models and to determine the scale ratio for strips #4, #5, and #6.

Compilation points were positioned on strip #5 to set photos 72E(c) 6756 thru 6760.

Strip #1 (72E(c) 6722 thru 6739) was adjusted on four field identified triangulation stations with five office identified stations as checks.

Strip #2 (72E(c) 6706 thru 6720) was adjusted on five triangulation stations, three tie points and three triangulation stations were used as checks. All horizontal tie points were averaged. T-sheets were ruled on North Carolina plane coordinates and plotted on the Coradomat.

23. Adequacy of Control

Horizontal control complied with project instruction and held within the National Map Accuracy Standard.

24. Supplemental Data

All vertical control needed for adjustment was taken from USGS quadrangles and are approximate mean sea level. The vertical points obtained by bridging are not necessarily true values.

25. Photography

Photography was adequate as to overlap, definition, and coverage.

Respectfully submitted

James E. Schad
James E. Schad

Approved by:

John D. Perrow, Jr.
John D. Perrow, Jr.

Chief, Aerotriangulation Section

Notes to Compiler
Job CM-7219
Cape Fear - Cape Lookout, North Carolina

The shoreline area from the vicinity of Mason Inlet to New Topsoil Inlet (TP-00700) must be compiled from strip #5 (72E(c)6756 thru 6760) either by setting the models or by graphic methods. In order to control this area, "900" series points were determined from bridging strip #2.

Beach cross section points, which were field identified on black/white contact print, have been horizontally positioned from bridging strips #1 and #2 and are identified with "400" series numbers.

| Strip # 1 | Photo number | Field number |
|-----------|--------------|------------------|
| | 25401 | 01-02 (68E 3232) |
| | 25400 | 03-03 (68E 3232) |
| | 26400 | 01-01 (68E 3419) |
| | 31400 | 02-01 (68E 3428) |
| Strip #2 | 10400 | 00-01 (68E 3244) |
| | 14400 | 97-01 (68E 3249) |
| | 16400 | 97-02 (68E 3252) |
| | 18400 | 98-02 (68E 3270) |
| | 19400 | 98-01 (68E 3272) |

Rather of strips 4, 5, and 6 were ordered
JSP

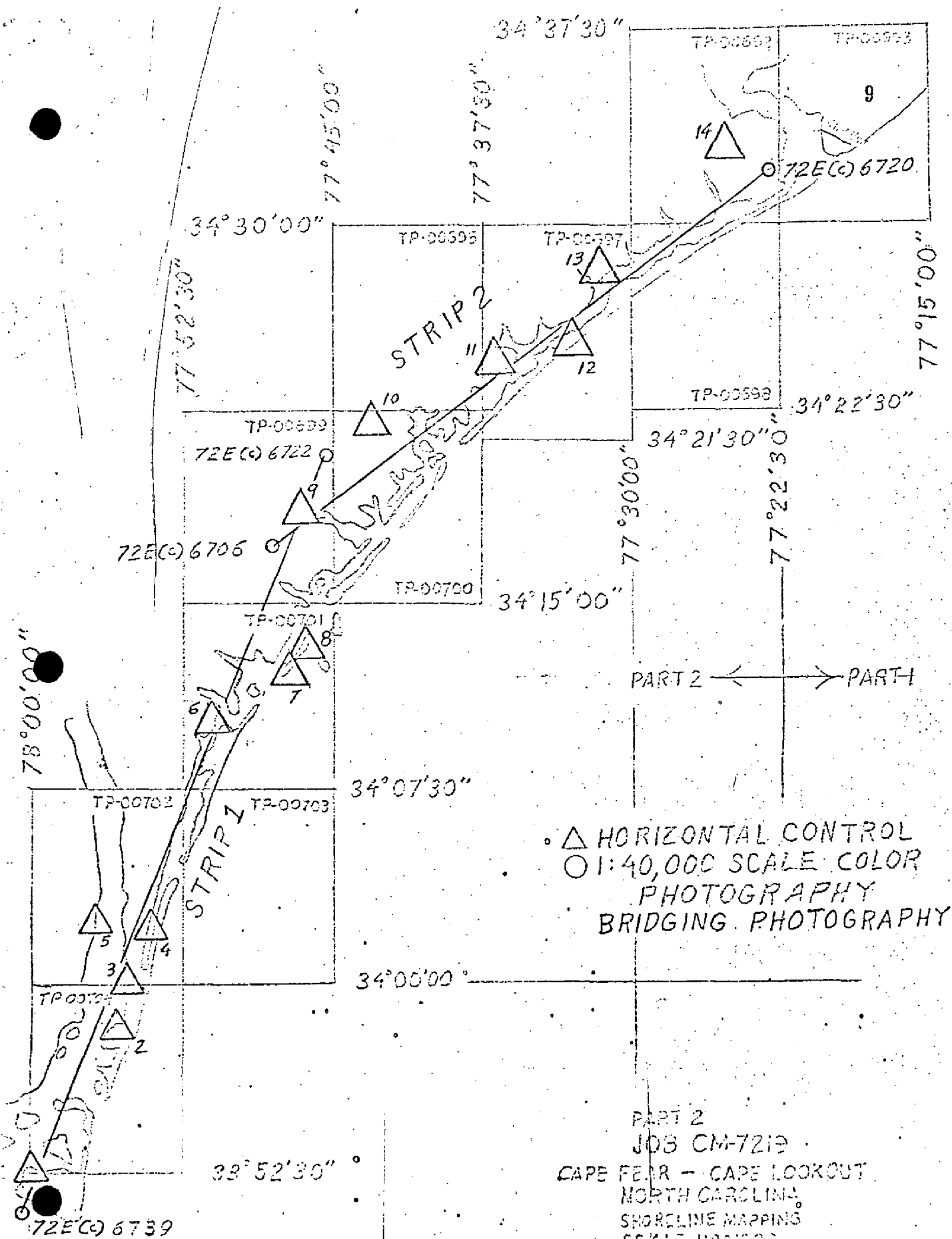

◻ HORIZONTAL CONTROL
 ○ 1:40,000 SCALE COLOR PHOTOGRAPHY
 BRIDGING PHOTOGRAPHY

PART 2
 JOB CM-7219
 CAPE FEAR - CAPE LOOKOUT
 NORTH CAROLINA
 SHORELINE MAPPING
 SCALE 1:250,000

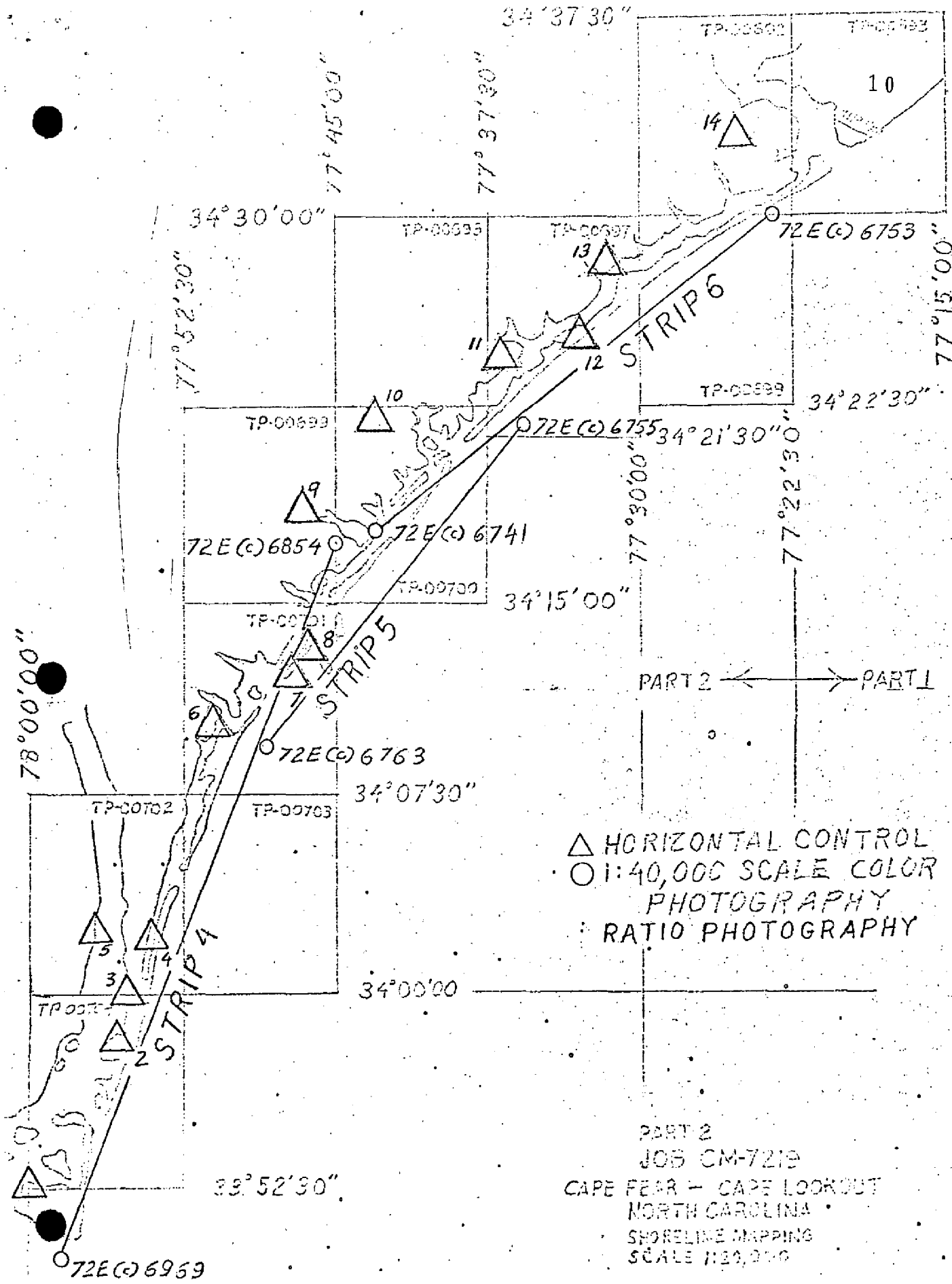

JOB CM-7219

KEY TO HORIZONTAL CONTROL
USE FOR BRIDGING.

1. BALD HEAD LIGHTHOUSE, 1851
2. FEDERAL POINT, 1913
3. KURE BEACH W.T., 1913
4. CAROLINA BEACH MUN. W.T., 1968
5. RUINS, 1917
6. MASON, 1918
7. WRIGHTSVILLE BEACH SOUTH MUN. W.T., 1962
8. WRIGHTSVILLE BEACH NORTH MUN. W.T., 1962
9. KIRKLAND, 1932
10. HAMPSTEAD 2, 1947
11. ATKINSON, 1914
12. SEARS LANDING, TANK 1943
13. BETHEA, 1932
14. GRANT, 1932

DESCRIPTIVE REPORT CONTROL RECORD

| MAP NO. | | JOB NO. | | GEODETTIC DATUM | | ORIGINATING ACTIVITY | | REMARKS | |
|------------------|----------------------------------|---|---------------------|--------------------------|---------------------|------------------------------|----------|---------|----------|
| TP-00699 | | CM-7219 | | N.A. 1927 | | Coastal Mapping Section, AMC | | | |
| STATION NAME | SOURCE OF INFORMATION (Index) | AEROTRI- ANGULATION POINT NUMBER | COORDINATES IN FEET | | GEOGRAPHIC POSITION | | Forward | Back | |
| | | | STATE | ZONE | ϕ | λ | | | |
| BARRACKS, 1962 | Vol. III P. 2863 | | X= | | ϕ 34 | 15 | 45.11659 | 1390.1 | (458.6) |
| | | | Y= | | λ 77 | 45 | 07.05494 | 180.5 | (1354.6) |
| KIRKLAND, 1932 | Vol. III Pg. 701 | | X= | | ϕ 34 | 18 | 35.01807 | 1079.0 | (769.7) |
| | | | Y= | | λ 77 | 46 | 42.29955 | 1081.6 | (452.6) |
| | | | X= | | ϕ | | | | |
| | | | Y= | | λ | | | | |
| | | | X= | | ϕ | | | | |
| | | | Y= | | λ | | | | |
| | | | X= | | ϕ | | | | |
| | | | Y= | | λ | | | | |
| | | | X= | | ϕ | | | | |
| | | | Y= | | λ | | | | |
| | | | X= | | ϕ | | | | |
| | | | Y= | | λ | | | | |
| | | | X= | | ϕ | | | | |
| | | | Y= | | λ | | | | |
| | | | X= | | ϕ | | | | |
| | | | Y= | | λ | | | | |
| | | | X= | | ϕ | | | | |
| | | | Y= | | λ | | | | |
| | | | X= | | ϕ | | | | |
| | | | Y= | | λ | | | | |
| COMPUTED BY | A.C. Rauck, Jr. | DATE | 3/29/73 | COMPUTATION CHECKED BY | L.B. Foltz | | DATE | 4/26/73 | |
| LISTED BY | | DATE | | LISTING CHECKED BY | | | DATE | | |
| HAND PLOTTING BY | | DATE | | HAND PLOTTING CHECKED BY | | | DATE | | |

COMPILATION REPORT

TP-00699

31. DELINEATION

This map was not delineated a standard shoreline survey. See Summary, page 6 of this Descriptive Report.

Delineation was by the Wild B-8 stereoplotter, using the 1:40,000 scale color photography taken on October 20, 1972 (Bridging photography). Only the outer coast was mapped, per Instructions - OFFICE - dated April 4, 1973, Par. 4.03.

32. CONTROL

See Photogrammetric Plot Report, dated: March 21, 1973.

33. SUPPLEMENTAL DATA

None

34. CONTOURS AND DRAINAGE

Contours are inapplicable. No drainage was delineated.

35. SHORELINE AND ALONGSHORE DETAILS

The mean high water line and alongshore details were delineated from office interpretation of the photographs.

36. OFFSHORE DETAILS

None

37. LANDMARKS AND AIDS

Preliminary Forms 76-40, Nonfloating Aids or Landmarks for Charts were prepared by the Compilation Office and forwarded to the Field Editor and/or the Hydrographer for verification, location, or deletion.

38. CONTROL FOR FUTURE SURVEYS:

None

39. JUNCTIONS

See Form 76-36b, Items#5, of the Descriptive Report.

40. HORIZONTAL AND VERTICAL ACCURACY

No statement

46. COMPARISON WITH EXISTING MAPS

A comparison was made with the following Army Map Service quadrangle: ROCKY POINT, NORTH CAROLINA, scale 1:62,500, 1st. edition, AMS 2, dated 1946.

47. COMPARISON WITH NAUTICAL CHARTS

A comparison was made with the following National Ocean Survey chart: C&GS 1235, scale 1:80,000, 9th edition, dated May 1, 1971; 833-SC, scale 1:40,000 scale, 10th edition, dated February 24, 1973.

ITEMS TO BE APPLIED TO NAUTICAL CHARTS IMMEDIATELY

None

ITEMS TO BE CARRIED FORWARD

None

Submitted by:

Albert C. Rauck, Jr. For

L.B. Foltz

Cartographic Aid, April, 1973

Approved:

Albert C. Rauck, Jr.

Albert C. Rauck, Jr.

Chief, Coastal Mapping Section, AMC

ADDENDUM TO THE COMPILATION REPORT

TP-00699

FIELD EDIT

Field edit of this map is complete.

After original compilation, tide coordinated photography was flown at mean high and mean low water. When field edit was applied, the mean high water line was verified by comparison with the high water photographs and the mean low water line was added from office interpretation of that line on the low water photographs.

Charles H. Bishop

Charles H. Bishop
Final Reviewer
May 24, 1976

16 Oct. 1975

GEOGRAPHIC NAMES

FINAL NAME SHEET

CM-7219 (Cape Fear to Cape Lookout, N.C.)

TP-00699

Atlantic Ocean

Figure Eight Island

Onslow Bay

Approved by

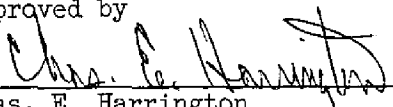
Chas. E. Harrington
Staff Geographer--C51x2

| NOAA FORM 75-74 (2-74) | | U.S. DEPARTMENT OF COMMERCE NOAA NATIONAL OCEAN SURVEY | |
|---|--|---|---|
| PHOTOGRAMMETRIC OFFICE REVIEW | | | |
| TP-00699 | | | |
| 1. PROJECTION AND GRIDS ACR | 2. TITLE ACR | 3. MANUSCRIPT NUMBERS ACR | 4. MANUSCRIPT SIZE ACR |
| CONTROL STATIONS | | | |
| 5. HORIZONTAL CONTROL STATIONS OF THIRD-ORDER OR HIGHER ACCURACY ACR | 6. RECOVERABLE HORIZONTAL STATIONS OF LESS THAN THIRD-ORDER ACCURACY (Topographic stations) NA | 7. PHOTO HYDRO STATIONS NA | |
| 8. BENCH MARKS NA | 9. PLOTTING OF SEXTANT FIXES | 10. PHOTOGRAMMETRIC PLOT REPORT ACR | 11. DETAIL POINTS ACR |
| ALONGSHORE AREAS (Nautical Chart Data) | | | |
| 12. SHORELINE ACR | 13. LOW-WATER LINE ACR | 14. ROCKS, SHOALS, ETC. ACR | 15. BRIDGES ACR |
| 16. AIDS TO NAVIGATION ACR | 17. LANDMARKS ACR | 18. OTHER ALONGSHORE PHYSICAL FEATURES ACR | 19. OTHER ALONGSHORE CULTURAL FEATURES ACR |
| PHYSICAL FEATURES | | | |
| 20. WATER FEATURES ACR | 21. NATURAL GROUND COVER NA | | 22. PLANETABLE CONTOURS NA |
| 23. STEREOSCOPIC INSTRUMENT CONTOURS NA | 24. CONTOURS IN GENERAL NA | 25. SPOT ELEVATIONS NA | 26. OTHER PHYSICAL FEATURES ACR |
| CULTURAL FEATURES | | | |
| 27. ROADS ACR | 28. BUILDINGS ACR | 29. RAILROADS ACR | 30. OTHER CULTURAL FEATURES ACR |
| BOUNDARIES | | | |
| 31. BOUNDARY LINES NA | | 32. PUBLIC LAND LINES NA | |
| MISCELLANEOUS | | | |
| 33. GEOGRAPHIC NAMES ACR | 34. JUNCTIONS ACR | | 35. LEGIBILITY OF THE MANUSCRIPT ACR |
| 36. DISCREPANCY OVERLAY ACR | 37. DESCRIPTIVE REPORT ACR | 38. FIELD INSPECTION PHOTOGRAPHS NA | 39. FORMS ACR |
| 40. REVIEWER A. C. Rauck, Jr. <i>4/27/73</i> <i>Albert C. Rauck, Jr.</i> | | SUPERVISOR, REVIEW SECTION OR UNIT <i>Albert C. Rauck, Jr.</i> Albert C. Rauck, Jr. | |
| 41. REMARKS (See attached sheet) | | | |
| FIELD COMPLETION ADDITIONS AND CORRECTIONS TO THE MANUSCRIPT | | | |
| 42. Additions and corrections furnished by the field completion survey have been applied to the manuscript. The manuscript is now complete except as noted under item 43. | | | |
| COMPILER Richard R. White <i>RR White</i> Jan., 1975 | | SUPERVISOR <i>Albert C. Rauck, Jr.</i> Albert C. Rauck, Jr. | |
| Reviewed by: A. L. Shands Jan., 1975 | | | |
| 43. REMARKS <i>o.zalid</i> Field edit was applied from the field edit ozalid. | | | |

FIELD EDIT FOR SHEET TP-00699
Page creek; Job CM-7219, part 2

51. METHODS

This manuscript was inspected by truck, by walking the beach,
and by boat.

52. ACCURACY OF COMPILATION

The accuracy is good.

54. RECOMMENDATIONS

None.

Philip B. Walbolt

Philip B. Walbolt
Chief, Photo Party 63

REVIEW REPORT TP-00699

SHORELINE

May 24, 1976

61. GENERAL STATEMENT:

See Summary, which is page 6 of this Descriptive Report.

A comparison print showing differences noted in Par. 63 and 65 is bound with the original of this report.

62. COMPARISON WITH REGISTERED TOPOGRAPHIC SURVEYS:

No registered topographic surveys later than 1933 were available. No comparison was made.

In the area mapped, TP-00699 supersedes prior registered surveys for nautical chart construction purposes.

63. COMPARISON WITH MAPS OF OTHER AGENCIES:

A comparison was made with Army Map Service quadrangle ROCKY POINT, NORTH CAROLINA, 1:62,500 scale, First Edition AMS 2, 1946. Significant differences are shown on the comparison print in brown.

64. COMPARISON WITH CONTEMPORARY HYDROGRAPHIC SURVEYS:

No contemporary hydrographic surveys were available for comparison.

65. COMPARISON WITH NAUTICAL CHARTS:

A comparison was made with Chart 11541, 1:40,000 scale, 12th edition, dated March 1975. Significant differences are shown in red on the comparison print.

66. ADEQUACY OF RESULTS AND FUTURE SURVEYS:

This map complies with Instructions - OFFICE - Job CM-7219, Part II, Cape Fear to Cape Lookout, North Carolina, Shoreline Mapping, and meets requirements for Bureau Standards and the National Standards of Map Accuracy.

Submitted:

Charles H. Bishop

Charles H. Bishop
Cartographer
May 24, 1976

Approved for forwarding:

Joseph W. Vonasek

Joseph W. Vonasek
Chief, Photogrammetric Branch, AMC

Approved: *D. G. Blankinbake*
for A. K. Heywood

Chief, Photogrammetric Branch

Walter D. ...

Chief, Coastal Mapping Division

COMPARISON PRINT

Brown = AMS quadrangle
Red = Chart 11541

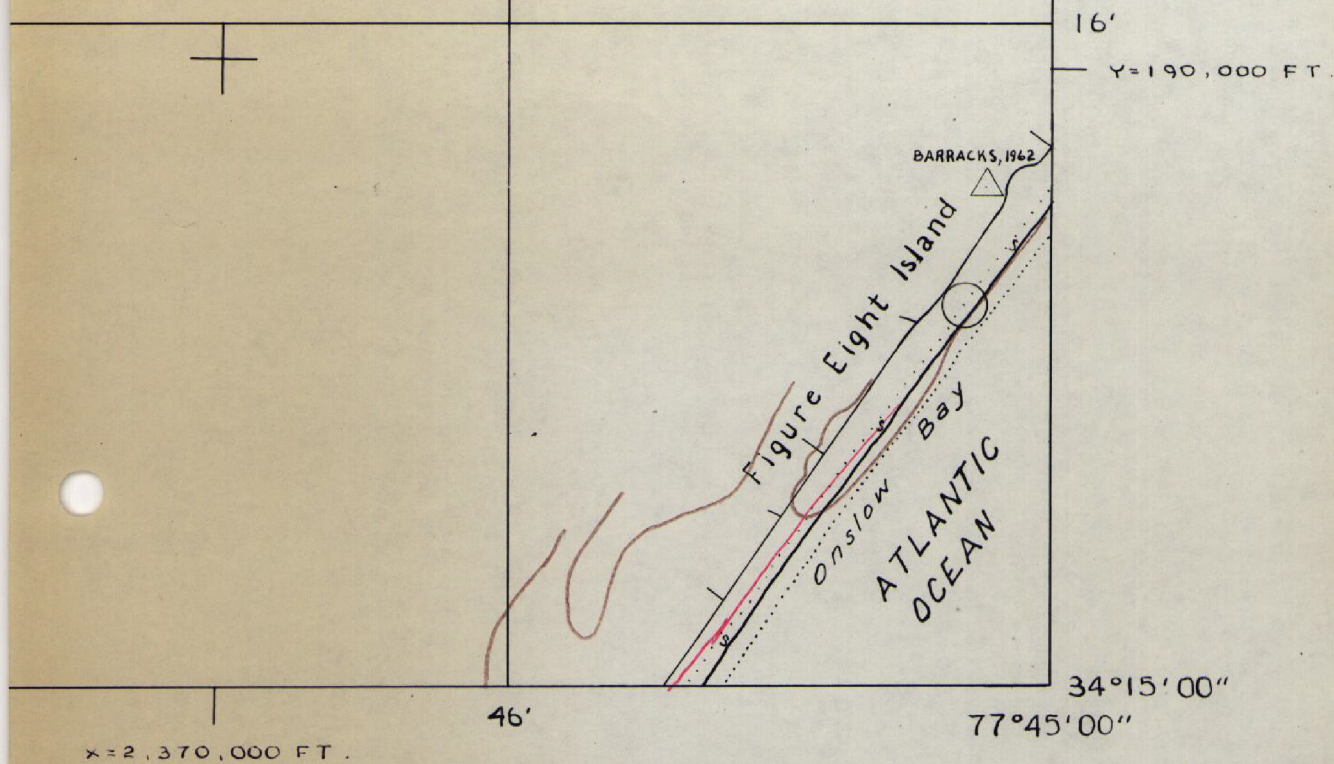

higher accuracy

water.
topographs

NATIONAL OCEAN SURVEY
SHORELINE MANUSCRIPT
TP-00699
NORTH CAROLINA
CAPE FEAR TO CAPE LOOKOUT
PAGES CREEK
SCALE 1:20,000
(1 inch=1666.67 ft.)
CONTROL DATA

Polyconic projection: 1927 North American Datum
10,000 foot grid based on North Carolina
Plane coordinate system
Datum plane: Mean High Water

TP-00699

