

TP-00697



TP-00697

NOAA FORM 76-35 U.S. DEPARTMENT OF COMMERCE NATIONAL OCEANIC AND ATMOSPHERIC ADMINISTRATION NATIONAL OCEAN SURVEY <h2 style="text-align: center;">DESCRIPTIVE REPORT</h2>	
<i>Type of Survey</i> Shoreline	
<i>Job No.</i> CM-7219	<i>Map No.</i> TP-00697
<i>Classification No.</i>	<i>Edition No.</i> 1
Field Edited Map	
<h3>LOCALITY</h3>	
<i>State</i> North Carolina	
<i>General Locality</i> Cape Fear to Cape Lookout	
<i>Locality</i> Topsail Beach	
<hr/> 19 72 TO 19 74 <hr/>	
<h3>REGISTRY IN ARCHIVES</h3>	
<i>DATE</i>	

NOAA FORM 76-36A (3-72) U. S. DEPARTMENT OF COMMERCE NATIONAL OCEANIC AND ATMOSPHERIC ADMIN.		TYPE OF SURVEY <input checked="" type="checkbox"/> ORIGINAL <input type="checkbox"/> RESURVEY <input type="checkbox"/> REVISED	SURVEY TP. <u>00697</u> MAP EDITION NO. <u>1</u> MAP CLASS <u>Final(F.E.)</u> JOB XBR <u>CM-7219</u>
DESCRIPTIVE REPORT - DATA RECORD			
PHOTOGRAMMETRIC OFFICE Coastal Mapping Division, Norfolk, VA		LAST PRECEDING MAP EDITION	
OFFICER-IN-CHARGE Jeffrey G. Carlen, Cdr.		TYPE OF SURVEY <input type="checkbox"/> ORIGINAL <input type="checkbox"/> RESURVEY <input type="checkbox"/> REVISED	JOB PH. _____ MAP CLASS _____ SURVEY DATES: 19__ TO 19__
I. INSTRUCTIONS DATED			
1. OFFICE		2. FIELD	
Dec. 4, 1972 Aerotriangulation Apr. 4, 1973 Compilation Apr. 6, 1973 Amend. I		Sept. 15, 1972 Sept. 21, 1973	
II. DATUMS			
1. HORIZONTAL: <input checked="" type="checkbox"/> 1927 NORTH AMERICAN		OTHER (Specify)	
2. VERTICAL: <input checked="" type="checkbox"/> MEAN HIGH-WATER <input checked="" type="checkbox"/> MEAN LOW-WATER <input type="checkbox"/> MEAN LOWER LOW-WATER <input type="checkbox"/> MEAN SEA LEVEL		OTHER (Specify)	
3. MAP PROJECTION Polyconic		4. GRID(S) STATE ZONE North Carolina	
5. SCALE 1:20,000		STATE ZONE	
III. HISTORY OF OFFICE OPERATIONS			
OPERATIONS		NAME	DATE
1. AEROTRIANGULATION BY J.E. Schad			Mar. 21/73
METHOD: Stereoplanigraph LANDMARKS AND AIDS BY			
2. CONTROL AND BRIDGE POINTS PLOTTED BY D. Phillips			Mar. 21/73
METHOD: Calcomp. CHECKED BY			
3. STEREOSCOPIC INSTRUMENT PLANIMETRY BY Frank Margiotta			Apr. 1973
COMPILATION CHECKED BY L.O. Neterer			Apr. 1973
INSTRUMENT: Wild B-8		CONTOURS BY NA	
SCALE: 1:20,000		CHECKED BY NA	
4. MANUSCRIPT DELINEATION PLANIMETRY BY L.B. Foltz			May, 1973
Wild B-8 and graphic CHECKED BY Frank Margiotta			May, 1973
METHOD: Smooth drafted		CONTOURS BY NA	
		CHECKED BY NA	
		HYDRO SUPPORT DATA BY NA	
SCALE: 1:20,000		CHECKED BY NA	
5. OFFICE INSPECTION PRIOR TO FIELD EDIT BY Frank Margiotta			May, 1973
6. APPLICATION OF FIELD EDIT DATA BY C. Blood			Oct. 1974
CHECKED BY R.R. White			Jan. 1975
7. COMPILATION SECTION REVIEW BY R.R. White			Jan. 1975
8. FINAL REVIEW BY C.H. Bishop			Apr. 1976
9. DATA FORWARDED TO PHOTOGRAMMETRIC BRANCH BY			
10. DATA EXAMINED IN PHOTOGRAMMETRIC BRANCH BY			
11. MAP REGISTERED - COASTAL SURVEY SECTION BY R.T. CATDR			AUG 1976

ESSA FORM 76-36b
(2-70)U.S. DEPARTMENT OF COMMERCE
ENVIRONMENTAL SCIENCE SERVICES ADMINISTRATION
COAST AND GEODETIC SURVEYTP-00697
COMPILATION SOURCES

1. COMPILATION PHOTOGRAPHY

CAMERA(S) Wild RC-8 "E", RC-10 "C"		TYPES OF PHOTOGRAPHY LEGEND		TIME REFERENCE	
TIDE STAGE REFERENCE HAMPTON ROADS New Topsail Inlet		<input checked="" type="checkbox"/> (C) COLOR <input type="checkbox"/> (P) PANCHROMATIC <input checked="" type="checkbox"/> (I) INFRARED	ZONE Eastern		<input checked="" type="checkbox"/> STANDARD
<input checked="" type="checkbox"/> PREDICTED TIDES <input type="checkbox"/> REFERENCE STATION RECORDS <input checked="" type="checkbox"/> TIDE CONTROLLED PHOTOGRAPHY			MERIDIAN 75th		<input type="checkbox"/> DAYLIGHT
NUMBER AND TYPE	DATE	TIME	SCALE	STAGE OF TIDE	
*72 E (C) 6745-6748	20 Oct 72	14:20	1:40,000	1.2 ft above MLW	
**73 C (CI) 6147-6149	11 Nov 73	14:15	1:60,000	±0.2 ft of MLW	
**73 C (CI) 4795-4797	15 Oct 73	11:25	1:60,000	±0.2 ft of MHW	

REMARKS

*Bridge and compilation photos.
 **Tide coordinated photos at MHW and MLW, based on predicted tides.

2. SOURCE OF MEAN HIGH-WATER LINE:

The mean high water line was compiled from office interpretation of the 1972 photography listed under 1 above and verified or corrected graphically by use of the 1973 tide coordinated*photographs when they became available.

*Based on predicted tides.

3. SOURCE OF MEAN LOW-WATER OR MEAN LOWER LOW-WATER LINE:

The mean low water line was compiled graphically from office interpretation of the tide coordinated*infrared photographs listed under 1. above.

*Based on predicted tides.

4. CONTEMPORARY HYDROGRAPHIC SURVEYS (List only those surveys that are sources for photogrammetric survey information.)

SURVEY NUMBER	DATE(S)	SURVEY COPY USED	SURVEY NUMBER	DATE(S)	SURVEY COPY USED

5. FINAL JUNCTIONS

NORTH	EAST	SOUTH	WEST
No contemporary survey	TP-00698	No contemporary Survey	TP-00700

REMARKS

TP-00697
HISTORY OF FIELD OPERATIONS.

I. FIELD INSPECTION OPERATION FIELD EDIT OPERATION.

OPERATION	NAME	DATE
1. CHIEF OF FIELD PARTY	R.S. Tibbetts	Oct. 1973
2. HORIZONTAL CONTROL	RECOVERED BY ESTABLISHED BY	R.E. Kesselring Oct. 1973
	PRE-MARKED OR IDENTIFIED BY	NA
	RECOVERED BY ESTABLISHED BY PRE-MARKED OR IDENTIFIED BY	R.E. Kesselring Oct. 1973 NA NA NA
3. VERTICAL CONTROL	RECOVERED (Triangulation Stations) BY LOCATED (Field Methods) BY IDENTIFIED BY	NA NA NA
4. LANDMARKS AND AIDS TO NAVIGATION	TYPE OF INVESTIGATION	
5. GEOGRAPHIC NAMES INVESTIGATION	<input type="checkbox"/> COMPLETE	
	<input type="checkbox"/> SPECIFIC NAMES ONLY	
	<input checked="" type="checkbox"/> NO INVESTIGATION	
6. PHOTO INSPECTION	CLARIFICATION OF DETAILS BY	NA
7. BOUNDARIES AND LIMITS	SURVEYED OR IDENTIFIED BY	NA

II. SOURCE DATA

1. HORIZONTAL CONTROL IDENTIFIED Pre-marked		2. VERTICAL CONTROL IDENTIFIED	
PHOTO NUMBER	STATION NAME	PHOTO NUMBER	STATION DESIGNATION
	BETHEA, 1932 ATKINSON, 1914		

3. PHOTO NUMBERS (Clarification of details)
NA

4. LANDMARKS AND AIDS TO NAVIGATION IDENTIFIED
NA

PHOTO NUMBER	OBJECT NAME	PHOTO NUMBER	OBJECT NAME

5. GEOGRAPHIC NAMES: REPORT NONE

6. BOUNDARY AND LIMITS: REPORT NONE

7. SUPPLEMENTAL MAPS AND PLANS
NA

8. OTHER FIELD RECORDS (Sketch books, etc. DO NOT list data submitted to the Geodesy Division)
2 Form 76-53, Control Station Identification Card.
2 Form 266, Observation of Sun for Azimuth and Time
2 Form 269c, Computation of Altitude and Time Azimuth.

TP-00697

HISTORY OF FIELD OPERATIONS

1. FIELD INSPECTION OPERATION FIELD EDIT OPERATION

OPERATION	NAME	DATE
1. CHIEF OF FIELD PARTY	Philip B. Walbolt	Oct. 1974
2. HORIZONTAL CONTROL	RECOVERED BY	NA
	ESTABLISHED BY	NA
	PRE-MARKED OR IDENTIFIED BY	NA
3. VERTICAL CONTROL	RECOVERED BY	NA
	ESTABLISHED BY	NA
	PRE-MARKED OR IDENTIFIED BY	NA
4. LANDMARKS AND AIDS TO NAVIGATION	RECOVERED (Triangulation Stations) BY	NA
	LOCATED (Field Methods) BY	Philip B. Walbolt
	IDENTIFIED BY	NA
5. GEOGRAPHIC NAMES INVESTIGATION	TYPE OF INVESTIGATION <input type="checkbox"/> COMPLETE <input type="checkbox"/> SPECIFIC NAMES ONLY <input checked="" type="checkbox"/> NO INVESTIGATION	
6. PHOTO INSPECTION	CLARIFICATION OF DETAILS BY	NA
7. BOUNDARIES AND LIMITS	SURVEYED OR IDENTIFIED BY	NA

II. SOURCE DATA

1. HORIZONTAL CONTROL IDENTIFIED		2. VERTICAL CONTROL IDENTIFIED	
None		None	
PHOTO NUMBER	STATION NAME	PHOTO NUMBER	STATION DESIGNATION

3. PHOTO NUMBERS (Clarification of details)
None

4. LANDMARKS AND AIDS TO NAVIGATION IDENTIFIED
Data for objects located by field methods are listed under 8. below.

PHOTO NUMBER	OBJECT NAME	PHOTO NUMBER	OBJECT NAME
	TANK		

5. GEOGRAPHIC NAMES: REPORT NONE

6. BOUNDARY AND LIMITS: REPORT NONE

7. SUPPLEMENTAL MAPS AND PLANS
None

8. OTHER FIELD RECORDS (Sketch books, etc. DO NOT list data submitted to the Geodesy Division)

- 1 Form 76-40 Landmarks for Charts
- 1 Traverse computation
- 1 Field Edit Report
- 1 Field Edit Ozalid

RECORD OF SURVEY USE

I. MANUSCRIPT COPIES

COMPILATION STAGES			DATE MANUSCRIPT FORWARDED	
DATA COMPILED	DATE	REMARKS	MARINE CHARTS	HYDRO SUPPORT
Compilation complete pending field edit	May, 1973	Class III Manuscript Superseded	None	5/8/73
Field edit applied, compilation complete	Oct. 1974	Class I Manuscript Superseded	6/3/75	
Final Review	Apr. 1976			

II. LANDMARKS AND AIDS TO NAVIGATION

1. REPORTS TO MARINE CHART DIVISION, NAUTICAL DATA BRANCH

NUMBER	CHART LETTER NUMBER ASSIGNED	DATE FORWARDED	REMARKS
1	118574	10/31/74	Landmark for Charts

2. REPORT TO MARINE CHART DIVISION, COAST PILOT BRANCH. DATE FORWARDED: 10/31/74
3. REPORT TO AERONAUTICAL CHART DIVISION, AERONAUTICAL DATA SECTION. DATE FORWARDED: _____

III. FEDERAL RECORDS CENTER DATA

1. BRIDGING PHOTOGRAPHS; DUPLICATE BRIDGING REPORT; COMPUTER READOUTS.
2. CONTROL STATION IDENTIFICATION CARDS; FORM NOS. ~~76-20~~ SUBMITTED BY FIELD PARTIES.
3. SOURCE DATA (except for Geographic Names Report) AS LISTED IN SECTION II, NOAA FORM 76-36C. ACCOUNT FOR EXCEPTIONS: Records for location of landmark were not submitted to Photogrammetry.
4. DATA TO FEDERAL RECORDS CENTER. DATE FORWARDED: _____

IV. SURVEY EDITIONS (This section shall be completed each time a new map edition is registered)

SECOND EDITION	SURVEY NUMBER	JOB NUMBER	TYPE OF SURVEY				
	TP - _____ (2)	PH - _____	<input type="checkbox"/> REVISED	<input type="checkbox"/> RESURVEY			
	DATE OF PHOTOGRAPHY	DATE OF FIELD EDIT	MAP CLASS				
			<input type="checkbox"/> II.	<input type="checkbox"/> III.	<input type="checkbox"/> IV.	<input type="checkbox"/> V.	<input type="checkbox"/> FINAL
THIRD EDITION	SURVEY NUMBER	JOB NUMBER	TYPE OF SURVEY				
	TP - _____ (3)	PH - _____	<input type="checkbox"/> REVISED	<input type="checkbox"/> RESURVEY			
	DATE OF PHOTOGRAPHY	DATE OF FIELD EDIT	MAP CLASS				
			<input type="checkbox"/> II.	<input type="checkbox"/> III.	<input type="checkbox"/> IV.	<input type="checkbox"/> V.	<input type="checkbox"/> FINAL
FOURTH EDITION	SURVEY NUMBER	JOB NUMBER	TYPE OF SURVEY				
	TP - _____ (4)	PH - _____	<input type="checkbox"/> REVISED	<input type="checkbox"/> RESURVEY			
	DATE OF PHOTOGRAPHY	DATE OF FIELD EDIT	MAP CLASS				
			<input type="checkbox"/> II.	<input type="checkbox"/> III.	<input type="checkbox"/> IV.	<input type="checkbox"/> V.	<input type="checkbox"/> FINAL

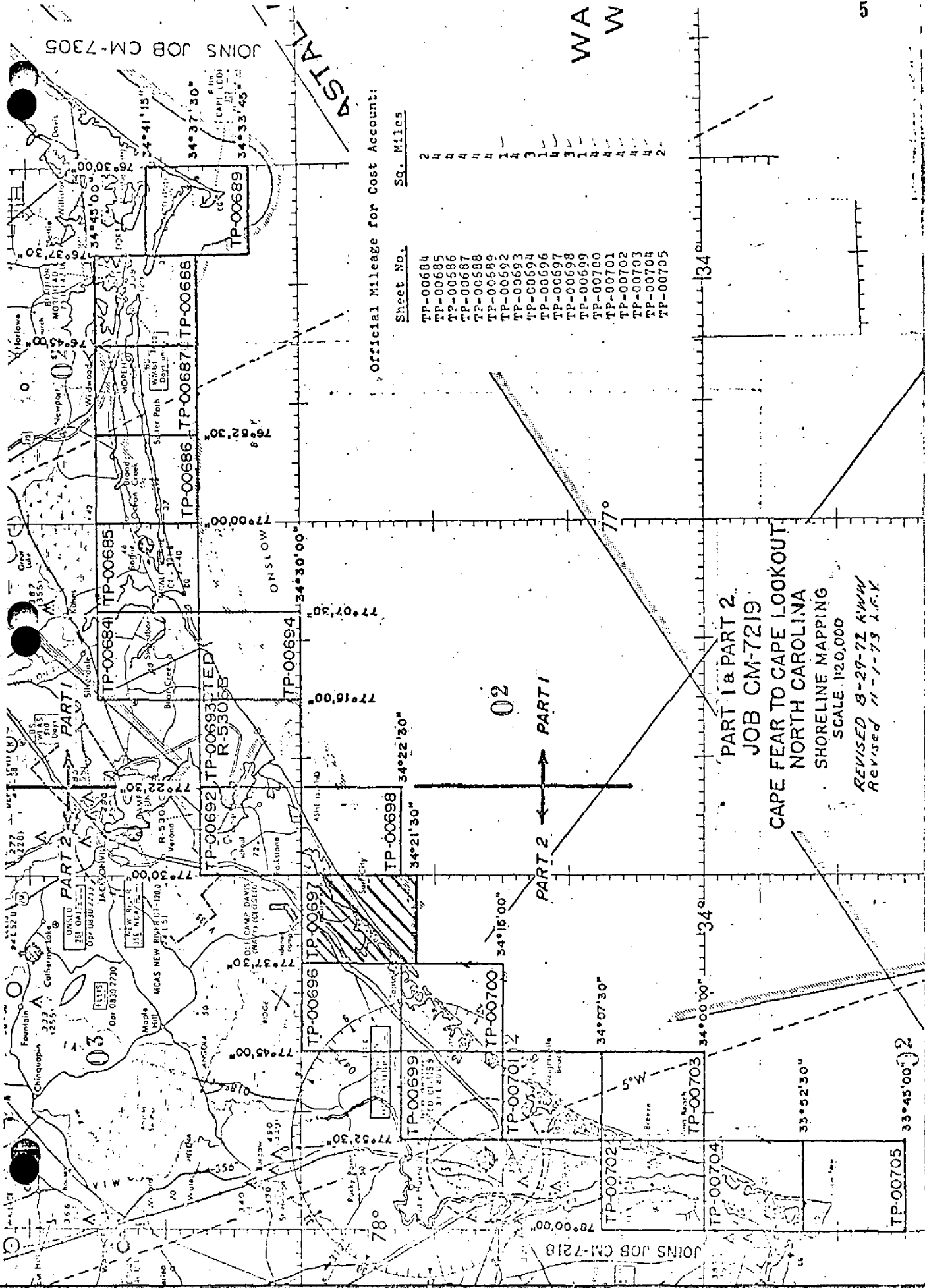

JOINS JOB CM-7305

JOINS JOB CM-7218

Official Mileage for Cost Account:

Sheet No.	Sq. Miles
TP-00684	2
TP-00685	4
TP-00686	4
TP-00687	4
TP-00688	4
TP-00689	4
TP-00692	1
TP-00693	4
TP-00694	3
TP-00696	1
TP-00697	4
TP-00698	3
TP-00699	1
TP-00700	4
TP-00701	4
TP-00702	4
TP-00703	4
TP-00704	4
TP-00705	2

PART 1 & PART 2
 JOB CM-7219
 CAPE FEAR TO CAPE LOOKOUT
 NORTH CAROLINA
 SHORELINE MAPPING
 SCALE 1:20,000
 REVISED 8-29-72 KWW
 REVISED 11-1-73 J.C.V.

WA
W

33°45'00" 2

SUMMARY TO ACCOMPANY

DESCRIPTIVE REPORTS TP-00692 and TP-00697 through TP-00705

Project CM-7219 is one of several projects that comprise the Southern Coastal Plains Expedition (SCOPE). It is a 1:20,000 scale shoreline mapping project which contains eighteen maps. Except for Map TP-00705, the maps referred to in this summary are not standard shoreline surveys because compilation was limited to the ocean shoreline only, per Instructions - OFFICE - Job CM-7219, Part II, Cape Fear to Cape Lookout, North Carolina, Shoreline Mapping, dated 4/4/73, Items 4.03 and 4.04. The entire area of TP-00705 was mapped; it was copied from a reduction of 1:10,000 scale Map TP-00683 (Job CM-7218) which covers the same area.

This summary is for Part II of the project. It covers the area between New River Inlet and Cape Fear.

Field work prior to compilation consisted of recovery and premarking horizontal control required for bridging and the obtaining of beach profiles. These profiles were not made within the time limit specified in instructions dated September 28, 1972 and were too widely spaced. Therefore, they were considered of no value and were not used as a source for mean high or mean low water lines.

Bridging was done in the Rockville Office in March 1973 using the Zeiss C-8 stereoplanigraph with 1:40,000 scale photography dated October 20, 1972. See Photogrammetric Plot Report following this summary.

Compilation was done at the Atlantic Marine Center in April and May 1973, using the 1972 bridging photography for compilation of interior details and initial compilation of the mean high water line. Later, at the time field edit was applied and the tide coordinated infrared photography (based on predicted tides) was available, the mean high water line was corrected where necessary, to agree with the photographs taken at MHW and the mean low water line was delineated graphically from the MLW photographs.

Field edit was done in May and July 1974, except for the area covered by TP-00705, which was edited in August 1973.

Final review was done at the Atlantic Marine Center in March through June 1976.

The original manuscripts were stabilene sheets $7\frac{1}{2}$ minutes in latitude by $7\frac{1}{2}$ minutes in longitude.

A cronaflex positive copy and a negative of each final reviewed map were forwarded for record and registry.

Photogrammetric Plot Report
Job CM-7219
Cape Fear - Cape Lookout, North Carolina
Part II
March 21, 1973

21. Area Covered

The area covered in this report extends along the North Carolina shoreline from Cape Fear to the vicinity of New River Inlet. Included in this area are 11 T-sheets: TP-00692; TP-00696 thru TP-00705; all are at 1:20,000 scale.

22. Method

Two strips of 1:40,000 color photography were bridged on the Zeiss C-8 stereoplanigraph and adjusted by the IBM computer. The two strips were used to obtain pass point positions for the models and to determine the scale ratio for strips #4, #5, and #6.

Compilation points were positioned on strip #5 to set photos 72E(c) 6756 thru 6760.

Strip #1 (72E(c) 6722 thru 6739) was adjusted on four field identified triangulation stations with five office identified stations as checks.

Strip #2 (72E(c) 6706 thru 6720) was adjusted on five triangulation stations, three tie points and three triangulation stations were used as checks. All horizontal tie points were averaged. T-sheets were ruled on North Carolina plane coordinates and plotted on the Coradomat.

23. Adequacy of Control

Horizontal control complied with project instruction and held within the National Map Accuracy Standard.

24. Supplemental Data

All vertical control needed for adjustment was taken from USGS quadrangles and are approximate mean sea level. The vertical points obtained by bridging are not necessarily true values.

25. Photography

Photography was adequate as to overlap, definition, and coverage.

Respectfully submitted

James E. Schad
James E. Schad

Approved by

John D. Perrow, Jr.
John D. Perrow, Jr.

Chief, Aerotriangulation Section

Notes to Compiler
Job CM-7219
Cape Fear - Cape Lookout, North Carolina

The shoreline area from the vicinity of Mason Inlet to New Topsoil Inlet (TP-00700) must be compiled from strip #5 (72E(c)6756 thru 6760) either by setting the models or by graphic methods. In order to control this area, "900" series points were determined from bridging strip #2.

Beach cross section points, which were field identified on black/white contact print, have been horizontally positioned from bridging strips #1 and #2 and are identified with "400" series numbers.

Strip #	Photo number	Field number
Strip # 1	25401	01-02 (68E 3232)
	25400	03-03 (68E 3232)
	26400	01-01 (68E 3419)
	31400	02-01 (68E 3428)
Strip #2	10400	00-01 (68E 3244)
	14400	97-01 (68E 3249)
	16400	97-02 (68E 3252)
	18400	98-02 (68E 3270)
	19400	98-01 (68E 3272)

Rather of strips 4, 5, and 6 were ordered
JSP

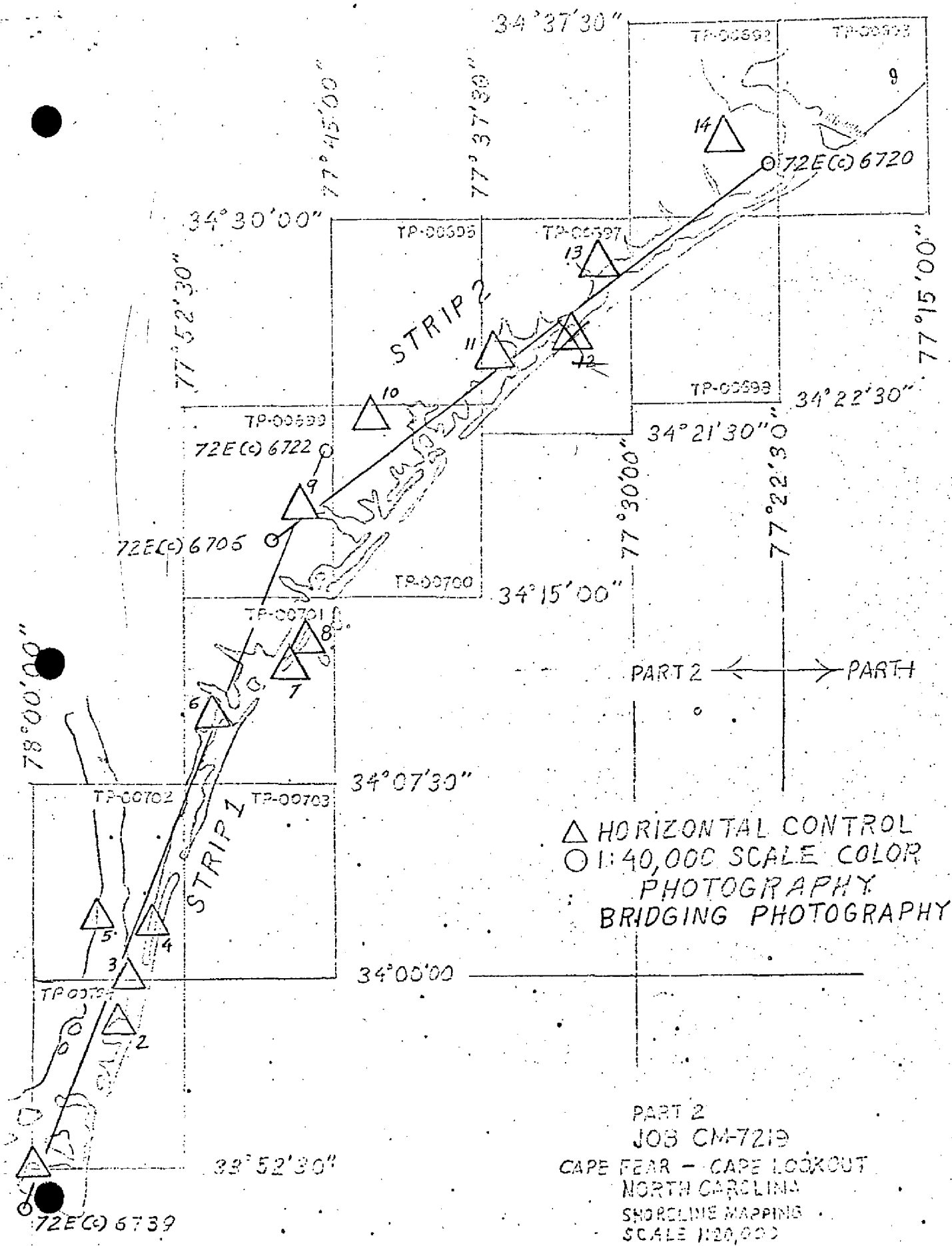

PART 2 ← → PART 1
 △ HORIZONTAL CONTROL
 ○ 1:40,000 SCALE COLOR PHOTOGRAPHY
 BRIDGING PHOTOGRAPHY

PART 2
 JOB CM-7219
 CAPE FEAR - CAPE LOOKOUT
 NORTH CAROLINA
 SHORELINE MAPPING
 SCALE 1:20,000

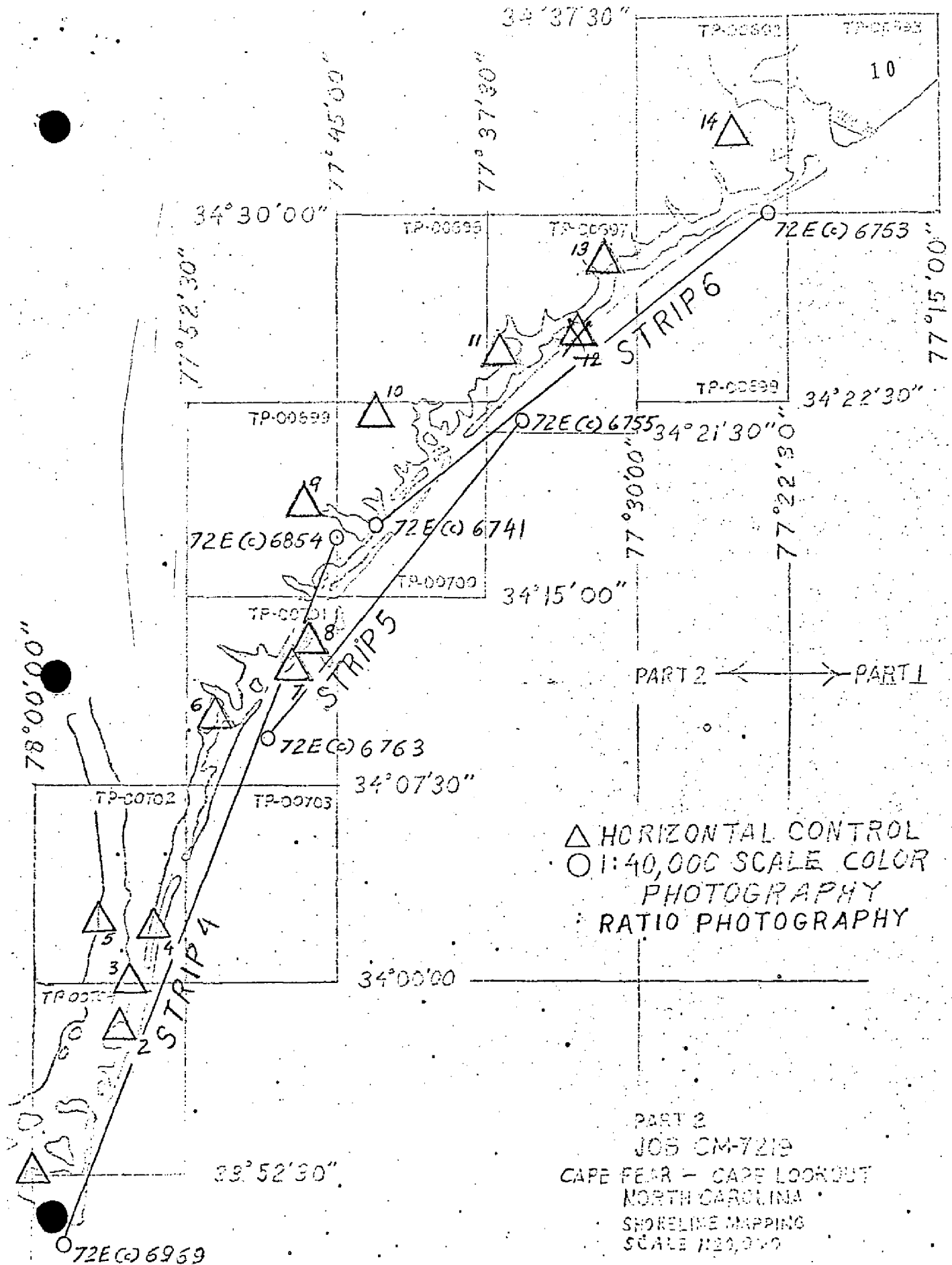

JOB CM-7219

KEY TO HORIZONTAL CONTROL
USE FOR BRIDGING.

1. BALD HEAD LIGHTHOUSE, 1851
2. FEDERAL POINT, 1913
3. KURE BEACH W.T., 1913
4. CAROLINA BEACH MUN. W.T., 1968
5. RUINS, 1917
6. MASON, 1918
7. WRIGHTSVILLE BEACH SOUTH MUN. W.T., 1962
8. WRIGHTSVILLE BEACH NORTH MUN. W.T., 1962
9. KIRKLAND, 1932
10. HAMPSTEAD 2, 1947
11. ATKINSON, 1914
- ~~12. SEARS LANDING, TANK 1943~~
13. BETHEA, 1932
14. GRANT, 1932

DESCRIPTIVE REPORT CONTROL RECORD

MAP NO.	JOB NO.	GEODETTIC DATUM		AEROTRI- ANGULATION POINT NUMBER	SOURCE OF INFORMATION (Index)	COORDINATES IN FEET		GEOGRAPHIC POSITION		REMARKS
		STATE	ZONE			φ	λ	φ	λ	
TP-00697	CM-7219					North Carolina				
					Vol. III P. 2868		x=	φ 34	22 53.70825	1654.9 (193.9)
TOWER TWO, 1947					Bridge Form 164		y=	λ 77	36 46.41576	1185.8 (347.1)
TOWER THREE, 1947							x=	φ		7,078.97 (2,921.03)
TOWER FOUR, 1947					Vol. III P. 2870		y=	λ		4,398.70 (5,601.30)
TOWER FIVE, 1947					Bridge Form 164		x=	φ 34	24 43.18200	1330.6 (518.2)
KYLE, 1962					Vol. III P. 2872		y=	λ 77	33 59.34613	1515.6 (16.7)
ATKINSON, 1914					Bridge Form 164		x=	φ		182.73 (9,817.27)
BETHEA, 1932					Vol. III P. 2873		y=	λ 34	26 45.88288	367.71 (9,632.29)
					Bridge Form 164		x=	φ 34	26 45.88288	1413.8 (435.0)
							y=	λ 77	30 44.70987	1141.4 (390.3)
							x=	φ		9,120.16 (879.84)
							y=	λ		7,499.60 (2,500.40)
							x=	φ 34	28 28.38263	874.6 (974.2)
							y=	λ 77	30 42.40854	1082.3 (448.9)
							x=	φ		
							y=	λ		
							x=	φ		
							y=	λ		
COMPUTED BY	A. C. Rauck, Jr.			DATE		COMPUTATION CHECKED BY				DATE
LISTED BY				3/29/73		C. Blood & L.B. Foltz				4/27/73
HAND PLOTTING BY				DATE		LISTING CHECKED BY				DATE
				DATE		HAND PLOTTING CHECKED BY				DATE

COMPILATION REPORT

TP-00697

31. DELINEATION

This map was not delineated as a standard shoreline survey. See Summary, page 6 of this Descriptive Report.

Delineation was by the Wild B-8 stereoplotter, using the 1:40,000 scale color photography taken Oct. 20, 1972 (Bridging photography). Only the outer coast was mapped, per Instructions - OFFICE - dated April 4, 1973, Par. 4.03.

32. CONTROL

See Photogrammetric Plot Report, dated Mar. 21, 1973.

33. SUPPLEMENTAL DATA

None

34. CONTOURS AND DRAINAGE

Contours are inapplicable.

There was no drainage to delineate.

35. SHORELINE AND ALONGSHORE DETAILS

The mean high water line and alongshore details were delineated from office interpretation of the photographs.

36. OFFSHORE DETAILS

None

37. LANDMARKS AND AIDS

Preliminary Forms 76-40, Nonfloating Aids or Landmarks for Charts, were prepared by the Compilation Office and forwarded to the Field Editor and/or the Hydrographer for verification, location, or deletion.

38. CONTROL FOR FUTURE SURVEYS

None

39. JUNCTIONS

See Form 76-36b, item #5, of the Descriptive Report.

40. HORIZONTAL AND VERTICAL ACCURACY

No statement

46. COMPARISON WITH EXISTING MAPS

A comparison was made with the following U.S. Geological Survey Quadrangle: TOPSAIL, N.C., scale 1:62,500, dated 1948.

47. COMPARISON WITH NAUTICAL CHARTS

A comparison was made with the following National Ocean Survey chart: C&GS 1235, scale 1:80,000, 9th edition, dated May 1, 1971; 833-SC, scale 1:40,000, 10th edition, dated March, 1973.

ITEMS TO BE APPLIED TO NAUTICAL CHARTS IMMEDIATELY

None

ITEMS TO BE CARRIED FORWARD

None

Submitted by:

*Charles H. Bishop**for* L.B. Foltz, Carto. Aid, May, 1973

Approved:

*Albert C. Rauck, Jr.*Albert C. Rauck, Jr.
Chief, Coastal Mapping Section, AMC

ADDENDUM TO THE COMPILATION REPORT

TP-00697

FIELD EDIT

Field edit of this map is complete.

At the time of field edit application, the mean high water line compiled from the 1972 color photographs was verified by comparison with the tide coordinated*high water photography listed on Form 76-36b 1, and corrected if necessary. The mean low water line was delineated graphically, using the tide coordinated*low water photography listed on Form 76-36b 1.

*Based on predicted tide.

Charles H. Bishop
Charles H. Bishop
Final Reviewer
9 April 1976

16 Oct. 1975

GEOGRAPHIC NAMES

FINAL NAME SHEET

CM-7219 (Cape Fear to Cape Lookout, N.C.)

TP-00697

Atlantic Ocean

Onslow Bay

Surf City

Topsail Beach

West Onslow Beach

Approved by

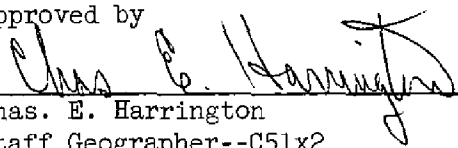
Chas. E. Harrington
Staff Geographer--C51x2

NOAA FORM 75-74 (7-75)		PHOTOGRAMMETRIC OFFICE REVIEW TP -00697		U.S. DEPARTMENT OF COMMERCE NOAA NATIONAL OCEAN SURVEY	
1. PROJECTION AND GRIDS FPM		2. TITLE FPM		3. MANUSCRIPT NUMBERS FPM	
				4. MANUSCRIPT SIZE FPM	
CONTROL STATIONS					
5. HORIZONTAL CONTROL STATIONS OF THIRD-ORDER OR HIGHER ACCURACY FPM			6. RECOVERABLE HORIZONTAL STATIONS OF LESS THAN THIRD-ORDER ACCURACY (Topographic stations) X X		7. PHOTO HYDRO STATIONS X X
8. BENCH MARKS X X		9. PLOTTING OF SEXTANT FIXES X X		10. PHOTOGRAMMETRIC PLOT REPORT FPM	11. DETAIL POINTS FPM
ALONGSHORE AREAS (Nautical Chart Data)					
12. SHORELINE FPM		13. LOW-WATER LINE X X		14. ROCKS, SHOALS, ETC. FPM	15. BRIDGES X X
16. AIDS TO NAVIGATION FPM		17. LANDMARKS FPM		18. OTHER ALONGSHORE PHYSICAL FEATURES FPM	19. OTHER ALONGSHORE CULTURAL FEATURES FPM
PHYSICAL FEATURES					
20. WATER FEATURES FPM			21. NATURAL GROUND COVER NA		22. PLANETABLE CONTOURS NA
23. STEREOSCOPIC INSTRUMENT CONTOURS NA		24. CONTOURS IN GENERAL NA		25. SPOT ELEVATIONS NA	26. OTHER PHYSICAL FEATURES FPM
CULTURAL FEATURES					
27. ROADS FPM		28. BUILDINGS FPM		29. RAILROADS FPM	30. OTHER CULTURAL FEATURES FPM
BOUNDARIES					
31. BOUNDARY LINES NA			32. PUBLIC LAND LINES NA		
MISCELLANEOUS					
33. GEOGRAPHIC NAMES FPM			34. JUNCTIONS FPM		35. LEGIBILITY OF THE MANUSCRIPT FPM
36. DISCREPANCY OVERLAY FPM		37. DESCRIPTIVE REPORT FPM		38. FIELD INSPECTION PHOTOGRAPHS X X	39. FORMS FPM
40. REVIEWER <i>Frank P. Margiotta</i> Frank P. Margiotta 4/4/73			SUPERVISOR, REVIEW SECTION OR UNIT <i>Albert C. Rauck, Jr.</i> Albert C. Rauck, Jr.		
41. REMARKS (See attached sheet)					
FIELD COMPLETION ADDITIONS AND CORRECTIONS TO THE MANUSCRIPT					
42. Additions and corrections furnished by the field completion survey have been applied to the manuscript. The manuscript is now complete except as noted under item 43.					
COMPILER C. Blood <i>C. Blood</i> 10/16/74 R. White <i>R. White</i> 1/1975			SUPERVISOR <i>Albert C. Rauck, Jr.</i> Albert C. Rauck, Jr.		
43. REMARKS Field Edit Ozalid, One Form 76-40					

FIELD EDIT FOR SHEET TP-00697
TOPSAIL BEACH; Job CM-7219, part 2

51. METHODS

This manuscript was inspected by truck, by walking the beach, and by boat. As per Paragraph 2 of Letter C344 dated 28 May 1974, it was determined that no extensive changes have occurred.

52. ACCURACY OF COMPILATION

The four (4) piers on the map have been named. One tank is recommended as a Nautical Landmark. Its position is from a traverse to locate hydro stations. Two trails have been deleted.

Philip B. Walbolt

Philip B. Walbolt
Chief, Photo Party 63

REVIEW REPORT TP-00697

SHORELINE

April 7, 1976

61. GENERAL STATEMENT:

See Summary, which is page 6 of this Descriptive Report.

A comparison print, showing differences noted in Par. 65 is bound with the original of this report.

62. COMPARISON WITH REGISTERED TOPOGRAPHIC SURVEYS:

No registered topographic surveys later than 1933 were available. No comparison was made.

In the area mapped, TP-00697 supersedes prior registered topographic surveys for nautical chart construction purposes.

63. COMPARISON WITH MAPS OF OTHER AGENCIES:

A comparison was made with USGS Quadrangle HOLLY RIDGE, N.C., 1:24,000 scale, dated 1970. No significant differences were noted.

64. COMPARISON WITH CONTEMPORARY HYDROGRAPHIC SURVEYS:

No contemporary hydrographic surveys were available for comparison.

65. COMPARISON WITH NAUTICAL CHARTS:

A comparison was made with Chart 11541, 1:40,000 scale, 12th edition, dated March 1975. The charted mean high water line is inshore from the mean high water line mapped on TP-00697. Charted piers are not in the same positions as the positions of corresponding piers on TP-00697. Significant differences are shown in red on the comparison print.

66. ADEQUACY OF RESULTS AND FUTURE SURVEYS:

This map complies with Instructions - OFFICE - Job CM-7219, Part II, Cape Fear to Cape Lookout, North Carolina, Shoreline Mapping, and meets requirements for Bureau Standards and National Standards of Map Accuracy.

Submitted by:

Charles H Bishop

Charles H. Bishop
Cartographer
April 7, 1976

Approved for forwarding:

Joseph W Vonasek
Joseph W. Vonasek
Chief, Photogrammetric Branch, AMC

Approved: *S. H. Blankenship*
for A. K. Heywood

Chief, Photogrammetric Branch

Walter D. ...
Chief, Coastal Mapping Division

0 FT.

24'

24'

△ ATKINSON, 1914

△ TOWER THREE 1947

23'

Topsail Beach

23'

△ TOWER TWO, 1947

Dolphin Pier

Charted pier ends here

0 FT.

22'

22'

COMPARISON PRINT

Red = Chart 11541

TP-00697
1:20,000

34°
21' 30"

34° 21' 30"

77° 37' 30"

37'

77° 36'

x = 2,420,000 FT.

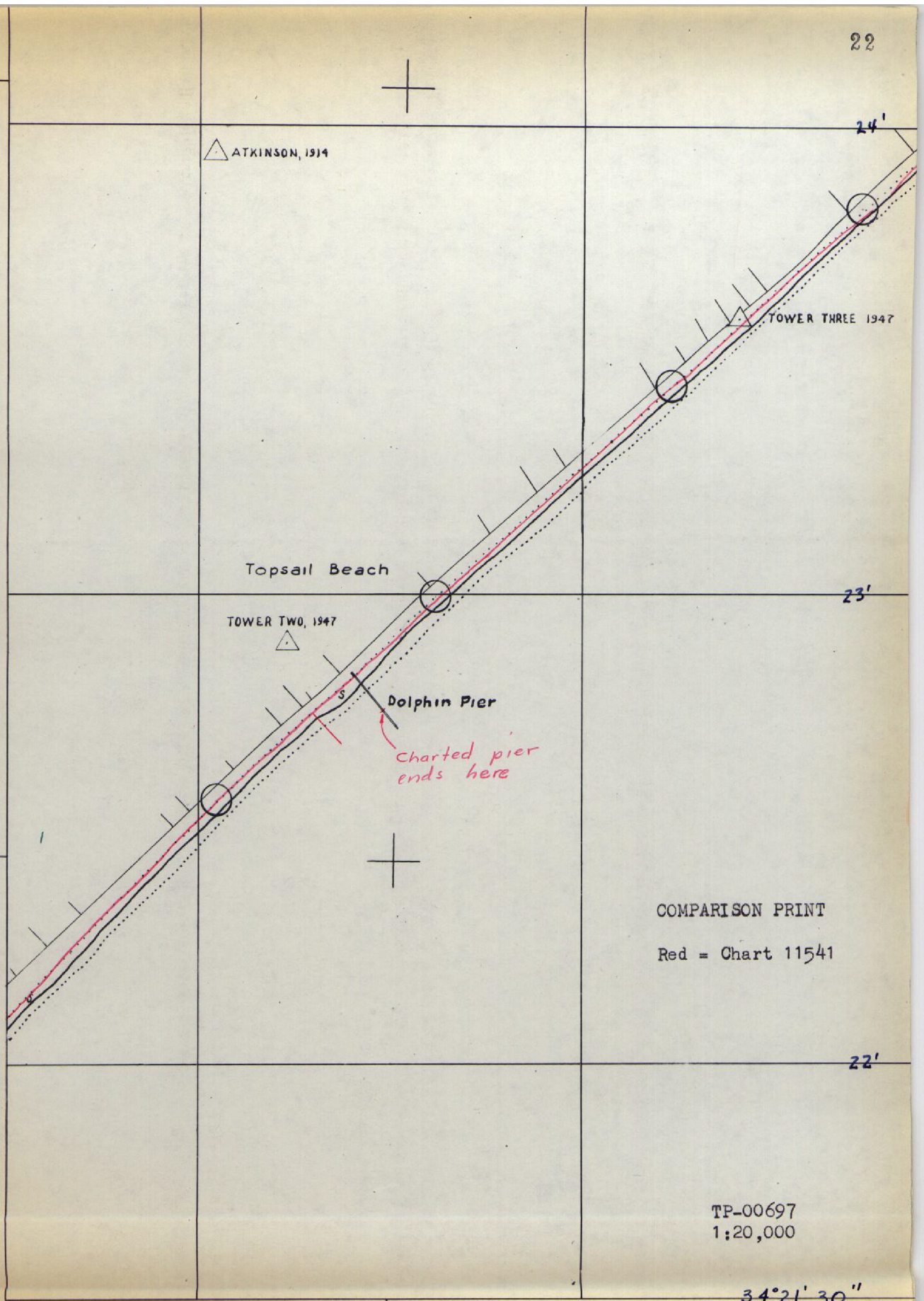

Surf City

SURF CITY MUNICIPAL
WATER TANK, 1974
HT= 138 (142) FT.

Surf Ci

No charted
pier here.

34°25'

TOWER FOUR 1947

24'

COMPARISON PRINT

Red = Chart 11541

TP-00697
1:20,000

NOT
"The photogrammetric location
offshore from the mean high
may not be complete or fi
reviewed hydrographic survey
should be consulted for

W

0

34'

77°33'

L

24

27'

West Onslow Beach

KYLE, 1962

No charted pier here.

Scotch Bonnet Pier

26'

Barnacle Bills Pier

No pier here on chart

TOWER FIVE 1947

ty Pier

COMPARISON PRINT

Red = Chart 11541

34°
25'

TP-00697
1:20,000

77° 30' 00"

A

Y

B

32'

31'

3

RECORD OF APPLICATION TO CHARTS

FILE WITH DESCRIPTIVE REPORT OF SURVEY NO.

TP-00697

INSTRUCTIONS

A basic hydrographic or topographic survey supersedes all information of like nature on the uncorrected chart.

1. Letter all information.
2. In "Remarks" column cross out words that do not apply.
3. Give reasons for deviations, if any, from recommendations made under "Comparison with Charts" in the Review.

CHART	DATE	CARTOGRAPHER	REMARKS
777	5/78	M. Sutherland	Full Part Before After Verification Review Inspection Signed Via Drawing No. 18
Recap'd 777	6/79	R. Hickey	Full Part Before After Verification Review Inspection Signed Via Drawing No. 19
833 ^{6/18}	6/79	R. Hickey	Full Part Before After Verification Review Inspection Signed Via Drawing No. 17
1235	4/78	M. Sutherland	Full Part Before After Verification Review Inspection Signed Via Drawing No. 21
			Full Part Before After Verification Review Inspection Signed Via Drawing No.
			Full Part Before After Verification Review Inspection Signed Via Drawing No.
			Full Part Before After Verification Review Inspection Signed Via Drawing No.
			Full Part Before After Verification Review Inspection Signed Via Drawing No.
			Full Part Before After Verification Review Inspection Signed Via Drawing No.
			Full Part Before After Verification Review Inspection Signed Via Drawing No.
			Full Part Before After Verification Review Inspection Signed Via Drawing No.
			Full Part Before After Verification Review Inspection Signed Via Drawing No.
			Full Part Before After Verification Review Inspection Signed Via Drawing No.
			Full Part Before After Verification Review Inspection Signed Via Drawing No.
			Full Part Before After Verification Review Inspection Signed Via Drawing No.
			Full Part Before After Verification Review Inspection Signed Via Drawing No.
			Full Part Before After Verification Review Inspection Signed Via Drawing No.
			Full Part Before After Verification Review Inspection Signed Via Drawing No.

ORIGINAL COPY