

ORIGINAL

TP-00682

TP-00682

NOAA FORM 76-35	
U.S. DEPARTMENT OF COMMERCE NATIONAL OCEANIC AND ATMOSPHERIC ADMINISTRATION NATIONAL OCEAN SURVEY	
DESCRIPTIVE REPORT	
Shoreline	
Type of Survey	
Job No. CM-7218	Map No. TP-00682
Classification No.	Edition No. 1
Field Edited Map	
LOCALITY	
State	North Carolina
General Locality	Lower Cape Fear River
Locality	Bald Head
<hr/> 1972 TO 1975 <hr/>	
REGISTRY IN ARCHIVES	
DATE	

NOAA FORM 76-36A (3-72) U. S. DEPARTMENT OF COMMERCE NATIONAL OCEANIC AND ATMOSPHERIC ADMIN. <h3 style="text-align: center;">DESCRIPTIVE REPORT - DATA RECORD</h3>		TYPE OF SURVEY <input checked="" type="checkbox"/> ORIGINAL <input type="checkbox"/> RESURVEY <input type="checkbox"/> REVISED	SURVEY TP. <u>00682</u> MAP EDITION NO. <u>d</u> MAP CLASS <u>Final (FE)</u> JOB <u>PH-CM-7218</u>
PHOTOGRAMMETRIC OFFICE Coastal Mapping Divison, Norfolk, Va.		LAST PRECEDING MAP EDITION TYPE OF SURVEY <input type="checkbox"/> ORIGINAL <input type="checkbox"/> RESURVEY <input type="checkbox"/> REVISED JOB PH. _____ MAP CLASS _____ SURVEY DATES: 19__ TO 19__	
OFFICER-IN-CHARGE Jeffrey G. Carlen, Cdr.			
I. INSTRUCTIONS DATED			
1. OFFICE		2. FIELD	
Part I Compilation Feb. 27, 1973 Part II Aerotriangulation Mar. 7, 1974 Compilation July 15, 1974		Oct 5, 1973	
II. DATUMS			
1. HORIZONTAL: <input checked="" type="checkbox"/> 1927 NORTH AMERICAN		OTHER (Specify)	
2. VERTICAL: <input type="checkbox"/> MEAN HIGH-WATER <input checked="" type="checkbox"/> MEAN LOW-WATER <input type="checkbox"/> MEAN LOWER LOW-WATER <input type="checkbox"/> MEAN SEA LEVEL		OTHER (Specify)	
3. MAP PROJECTION Polyconic		4. GRID(S) STATE North Carolina ZONE	
5. SCALE 1:10,000		STATE ZONE	
III. HISTORY OF OFFICE OPERATIONS			
OPERATIONS		NAME	DATE
1. AEROTRIANGULATION BY J. E. Schad METHOD: Stereoplantgraph LANDMARKS AND AIDS BY Mar. 1973			
2. CONTROL AND BRIDGE POINTS PLOTTED BY Unknown METHOD: Calcomp. CHECKED BY Mar. 1973			
3. STEREOSCOPIC INSTRUMENT PLANIMETRY BY F. Margiotta COMPILATION CHECKED BY L. o. Neterer INSTRUMENT: Wild B-8 SCALE: 1:20,000 CONTOURS BY NA CHECKED BY NA			Mar. 1973 Mar. 1973
4. MANUSCRIPT DELINEATION PLANIMETRY BY Charles Parker CHECKED BY A. L. Shands CONTOURS BY NA CHECKED BY NA HYDRO SUPPORT DATA BY C. Parker CHECKED BY A. L. Shands SCALE: 1:10,000			Apr. 1973 Apr. 1973 Apr. 1973 Apr. 1973
5. OFFICE INSPECTION PRIOR TO FIELD EDIT BY A. L. Shands CHECKED BY Apr. 1973			
6. APPLICATION OF FIELD EDIT DATA BY J. Desch CHECKED BY F. Margiotta Apr. 1975			Mar. 1975 Apr. 1975
7. COMPILATION SECTION REVIEW BY F. Margiotta CHECKED BY Apr. 1975			
8. FINAL REVIEW BY Billy H. Barnes CHECKED BY June 1976			
9. DATA FORWARDED TO PHOTOGRAMMETRIC BRANCH BY			
10. DATA EXAMINED IN PHOTOGRAMMETRIC BRANCH BY S. BLANKENBAKER CHECKED BY SEPT 1976			
11. MAP REGISTERED - COASTAL SURVEY SECTION BY R.T. CATDR CHECKED BY SEP 1976			

TP-00682
COMPILATION SOURCES

1. COMPILATION PHOTOGRAPHY

CAMERA(S) Wild RC 8 "E" & RC 10 "C"		TYPES OF PHOTOGRAPHY LEGEND		TIME REFERENCE	
TIDE STAGE REFERENCE CHARLESTON, S.C. <input checked="" type="checkbox"/> PREDICTED TIDES (Southport, N.C.) <input type="checkbox"/> REFERENCE STATION RECORDS <input type="checkbox"/> TIDE CONTROLLED PHOTOGRAPHY		(C) COLOR X (P) PANCHROMATIC (I) INFRARED X		ZONE Eastern MERIDIAN 75th	
				<input checked="" type="checkbox"/> STANDARD <input type="checkbox"/> DAYLIGHT	
NUMBER AND TYPE	DATE	TIME	SCALE	STAGE OF TIDE	
72E(C) 6738-6739	20 OCT 72	13:50	1:40,000	2.0 ft. Above MLW	
73C(C) 6079 (I)	10 NOV 73	13:04	1:30,000	+0.2 ft. of MLW	
73C(C) 4807 (I)	15 OCT 73	11:57	1:30,000	+0.2 ft. of MHW	

REMARKS
*This "Tide Coordinated" photography is based on predicted times of MH and ML waters.

2. SOURCE OF MEAN HIGH-WATER LINE:

The MHW line was compiled from 1972 color photography, field edit measurements and profiles before 1973 photos were available. When the 1973 photos became available, comparison was made with them and corrections made where necessary.

3. SOURCE OF MEAN LOW-WATER OR MEAN LOWER LOW-WATER LINE:

The MLW line was graphically delineated from the 1973 photographs listed in #1 above.

4. CONTEMPORARY HYDROGRAPHIC SURVEYS (List only those surveys that are sources for photogrammetric survey information.)

SURVEY NUMBER	DATE(S)	SURVEY COPY USED	SURVEY NUMBER	DATE(S)	SURVEY COPY USED

5. FINAL JUNCTIONS			
NORTH TP-00680	EAST TP-00683	SOUTH No Survey	WEST Ph-7019 T-12291 (2)

REMARKS
1:20,000

HISTORY OF FIELD OPERATIONS

I. FIELD INSPECTION OPERATION FIELD EDIT OPERATION

OPERATION	NAME	DATE
1. CHIEF OF FIELD PARTY	Robert S. Tibbetts	Oct. Nov 73
2. HORIZONTAL CONTROL	RECOVERED BY NA ESTABLISHED BY NA PRE-MARKED OR IDENTIFIED BY NA	Sept. 1972 Sept. 1972 Sept. 1972
3. VERTICAL CONTROL	RECOVERED BY NA ESTABLISHED BY NA PRE-MARKED OR IDENTIFIED BY NA	Sept. 1972
4. LANDMARKS AND AIDS TO NAVIGATION	RECOVERED (Triangulation Stations) BY R. D. Black LOCATED (Field Methods) BY R. D. Black IDENTIFIED BY R. D. Black	Oct. Nov 73 Oct. Nov 73 Oct. Nov 73
5. GEOGRAPHIC NAMES INVESTIGATION	TYPE OF INVESTIGATION <input type="checkbox"/> COMPLETE BY <input type="checkbox"/> SPECIFIC NAMES ONLY <input type="checkbox"/> NO INVESTIGATION	
6. PHOTO INSPECTION	CLARIFICATION OF DETAILS BY R. D. Black	Oct. Nov 73
7. BOUNDARIES AND LIMITS	SURVEYED OR IDENTIFIED BY NA	Oct. Nov 73

II. SOURCE DATA

1. HORIZONTAL CONTROL IDENTIFIED		2. VERTICAL CONTROL IDENTIFIED	
PHOTO NUMBER	STATION NAME	PHOTO NUMBER	STATION DESIGNATION
			None

3. PHOTO NUMBERS (Clarification of details) Field edit
72E 6868

4. LANDMARKS AND AIDS TO NAVIGATION IDENTIFIED
One Landmark; 2 landmark bldgs

PHOTO NUMBER	OBJECT NAME	PHOTO NUMBER	OBJECT NAME

5. GEOGRAPHIC NAMES: REPORT NONE 6. BOUNDARY AND LIMITS: REPORT NONE

7. SUPPLEMENTAL MAPS AND PLANS
Film ozalid, no notes

8. OTHER FIELD RECORDS (Sketch books, etc. DO NOT list data submitted to the Goodey Division)
1. Form 76-40; 1. Page Distances to MHWL

I. MANUSCRIPT COPIES				
COMPILATION STAGES			DATE MANUSCRIPT FORWARDED	
DATA COMPILED	DATE	REMARKS	MARINE CHARTS	HYDRO SUPPORT
Compilation complete pending field edit.	APR 73	Class III manuscript superseded	6/8/73	4/30/73
Field edit applied. Compilation complete	Mar 75	Class I manuscript. Superseded	5/9/75	
Final Review	June 76			

II. LANDMARKS AND AIDS TO NAVIGATION
 1. REPORTS TO MARINE CHART DIVISION, NAUTICAL DATA BRANCH

NUMBER	CHART LETTER NUMBER ASSIGNED	DATE FORWARDED	REMARKS
			Submitted under Ph 7019 T-12291 (2)

2. REPORT TO MARINE CHART DIVISION, COAST PILOT BRANCH. DATE FORWARDED: 5/12/75
 3. REPORT TO AERONAUTICAL CHART DIVISION, AERONAUTICAL DATA SECTION. DATE FORWARDED: _____

III. FEDERAL RECORDS CENTER DATA

1. BRIDGING PHOTOGRAPHS; DUPLICATE BRIDGING REPORT; COMPUTER READOUTS.
 2. CONTROL STATION IDENTIFICATION CARDS; FORM NOS 76-40 SUBMITTED BY FIELD PARTIES.
 3. SOURCE DATA (except for Geographic Names Report) AS LISTED IN SECTION II, NOAA FORM 76-36C. ACCOUNT FOR EXCEPTIONS:
 4. DATA TO FEDERAL RECORDS CENTER. DATE FORWARDED: _____

IV. SURVEY EDITIONS (This section shall be completed each time a new map edition is registered)

EDITION	SURVEY NUMBER	JOB NUMBER	TYPE OF SURVEY	
	TP - _____ (2)	PH - _____	<input type="checkbox"/> REVISED	<input type="checkbox"/> RESURVEY
	DATE OF PHOTOGRAPHY	DATE OF FIELD EDIT	MAP CLASS	
			<input type="checkbox"/> II.	<input type="checkbox"/> III. <input type="checkbox"/> IV. <input type="checkbox"/> V. <input type="checkbox"/> FINAL
SECOND EDITION				
THIRD EDITION				
FOURTH EDITION				

CM-7218
 LOWER CAPE FEAR RIVER
 NORTH CAROLINA
 SHORELINE MAPPING
 SCALE 1:10,000

Sheet No.	Sq. Miles
TP-00 669	11
TP-00 670	2
TP-00 671	11
TP-00 672	9
TP-00 673	1
TP-00 674	4
TP-00 675	6
TP-00 676	3
TP-00 677	7
TP-00 678	9
TP-00 679	5
TP-00 680	7
TP-00 681	13
TP-00 682	1
TP-00 683	3
Total	92

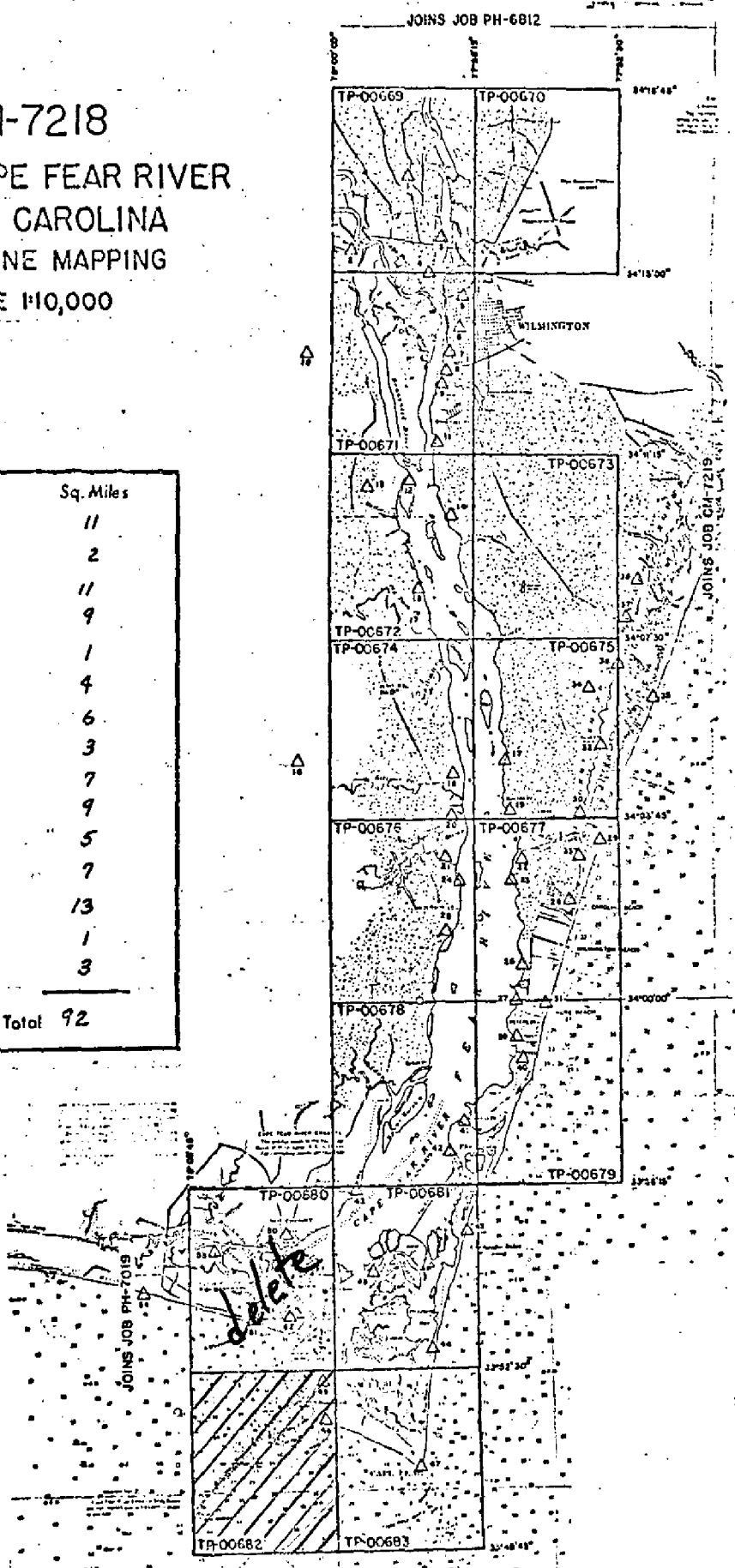

SUMMARY TO ACCOMPANY
DESCRIPTIVE REPORT TP-00682

This shoreline manuscript is one of fourteen 1:10,000 scale maps which comprise Parts I and II of Project CM-7218, Lower Cape Fear River, North Carolina. This map is in Part I. It falls within the limits of map T-12291(2), PH-7019, scale 1:20,000 which is a part of the Southern Coastal Plains Expedition or SCOPE project. It was photo-reduced and the shoreline used on the final reviewed copy of T-12291(2).

Field work prior to compilation consisted of recovery and premarking horizontal control required for bridging.

Bridging for Part I was done in the Rockville Office in March 1973 using the Zeiss Stereoplanigraph with 1:40,000 scale photography dated October 20, 1972. This bridge is an original part of CM-7219. A copy of the bridging report is included with the Descriptive Report.

Compilation was done at the Atlantic Marine Center in March and April 1973 using the 1972 bridging photographs. The Wild B-8 was used. In October and November of 1973, 1:30,000 scale color infrared photographs were flown based on PREDICTED mean high and mean low waters. These photographs were used where necessary to revise and update the mean high and mean low water lines.

Field edit was done in August 1973.

Final review was done at the Atlantic Marine Center in June 1976.

The original manuscript is a stabilene sheet 3 minutes 45 seconds in latitude by 3 minutes 45 seconds in longitude.

A stable base copy and a negative of the final reviewed manuscript were forwarded for record and registry.

7

Photogrammetric Plot Report
Job CM-7219
Cape Fear - Cape Lookout, North Carolina
Part II
March 21, 1973

21. Area Covered

The area covered in this report extends along the North Carolina shoreline from Cape Fear to the vicinity of New River Inlet. Included in this area are 11 T-sheets: TP-00692; TP-00696 thru TP-00705; all are at 1:20,000 scale.

22. Method

Two strips of 1:40,000 color photography were bridged on the Zeiss C-8 stereoplanigraph and adjusted by the IBM computer. The two strips were used to obtain pass point positions for the models and to determine the scale ratio for strips #4, #5, and #6.

Compilation points were positioned on strip #5 to set photos 72E(c) 6756 thru 6760.

Strip #1 (72E(c) 6722 thru 6739) was adjusted on four field identified triangulation stations with five office identified stations as checks.

Strip #2 (72E(c) 6706 thru 6720) was adjusted on five triangulation stations, three tie points and three triangulation stations were used as checks. All horizontal tie points were averaged. T-sheets were ruled on North Carolina plane coordinates and plotted on the Coradomat.

23. Adequacy of Control

Horizontal control complied with project instruction and held within the National Map Accuracy Standard.

24. Supplemental Data

All vertical control needed for adjustment was taken from USGS quadrangles and are approximate mean sea level. The vertical points obtained by bridging are not necessarily true values.

25. Photography

Photography was adequate as to overlap, definition, and coverage.

Respectfully submitted

James E. Schad

James E. Schad

Approved by:

John D. Perrow, Jr.
John D. Perrow, Jr.

Chief, Aerotriangulation Section

Notes to Compiler
Job CM-7219
Cape Fear - Cape Lookout, North Carolina

The shoreline area from the vicinity of Mason Inlet to New Topsoil Inlet (TP-00700) must be compiled from strip #5 (72E(c)6756 thru 6760) either by setting the models or by graphic methods. In order to control this area, "900" series points were determined from bridging strip #2.

Beach cross section points, which were field identified on black/white contact print, have been horizontally positioned from bridging strips #1 and #2 and are identified with "400" series numbers.

Strip # 1	Photo number	Field number
	25401	01-02 (68E 3232)
	25400	03-03 (68E 3232)
	26400	01-01 (68E 3419)
	31400	02-01 (68E 3428)
Strip #2	10400	00-01 (68E 3244)
	14400	97-01 (68E 3249)
	16400	97-02 (68E 3252)
	18400	98-02 (68E 3270)
	19400	98-01 (68E 3272)

Ratios of strips #4, 5 and 6 were ordered.
100

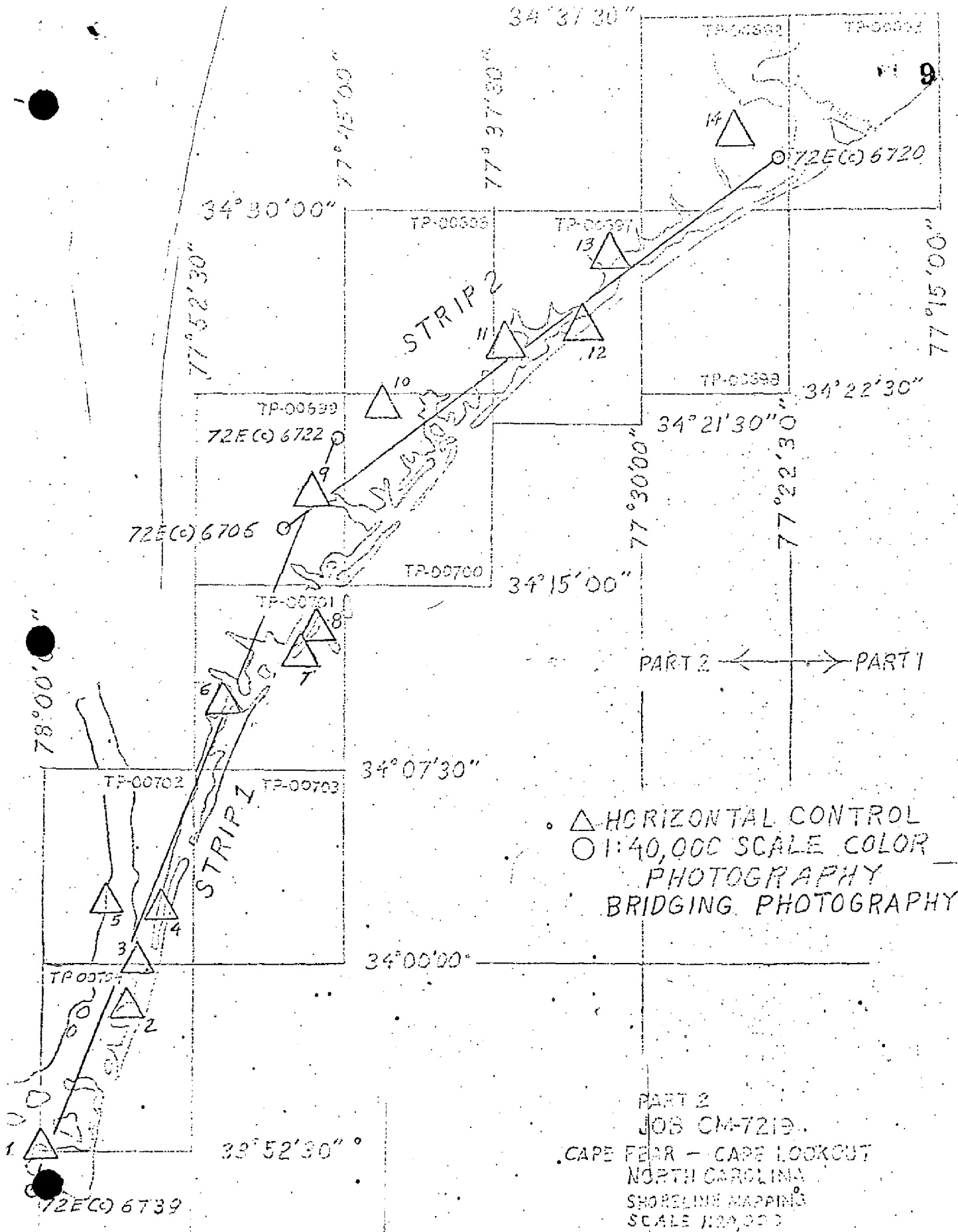

△ HORIZONTAL CONTROL
 ○ 1:40,000 SCALE COLOR
 PHOTOGRAPHY
 BRIDGING PHOTOGRAPHY

PART 2
 JOB CM-7219
 CAPE FEAR - CAPE LOOKOUT
 NORTH CAROLINA
 SHORELINE MAPPING
 SCALE 1:24,000

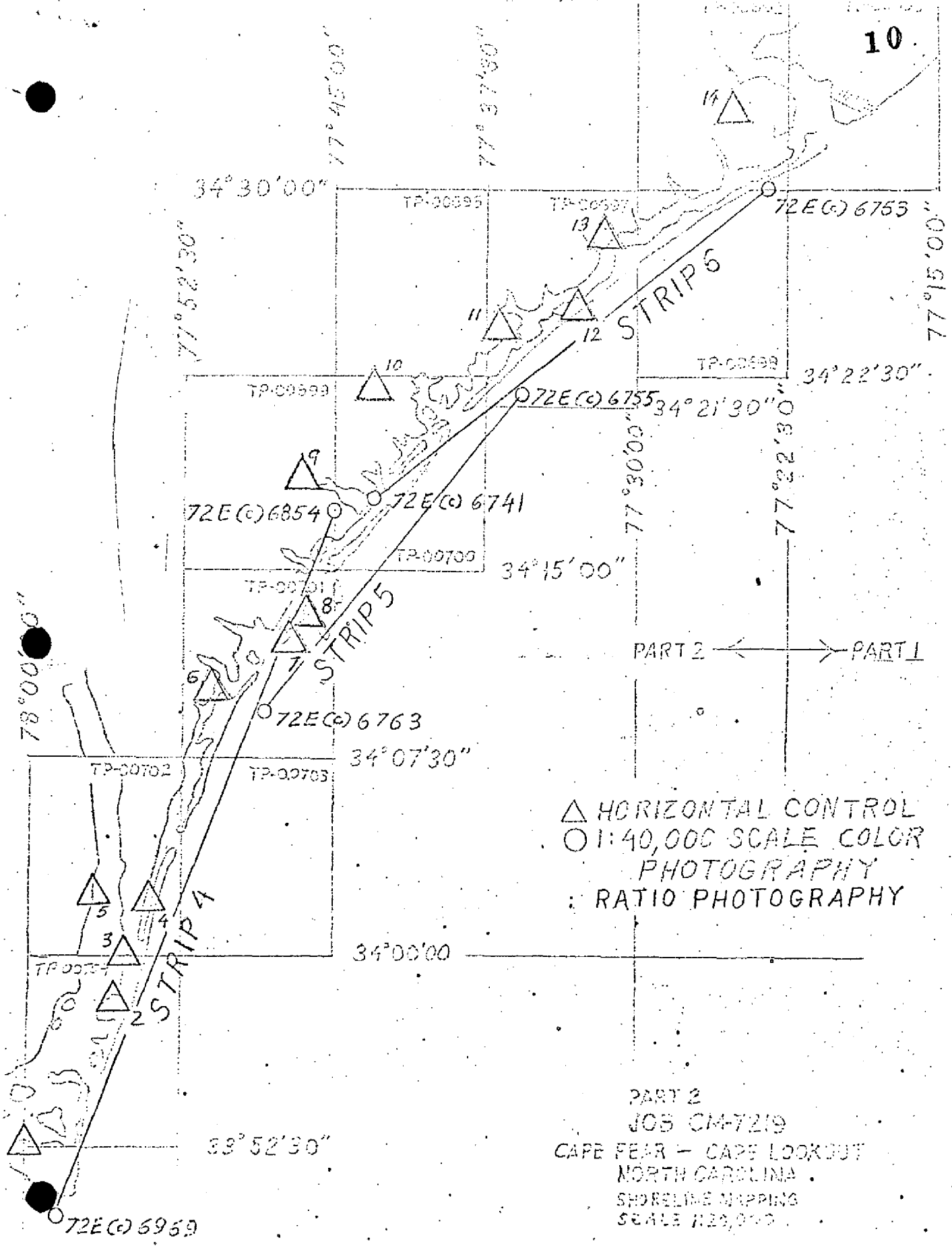

△ HORIZONTAL CONTROL
 ○ 1:40,000 SCALE COLOR PHOTOGRAPHY
 : RATIO PHOTOGRAPHY

PART 2
 JOB CM-7219
 CAPE FEAR - CAPE LOOKOUT
 NORTH CAROLINA
 SHORELINE MAPPING
 SCALE 1:25,000

JOB CM-7219

KEY TO HORIZONTAL CONTROL
USE FOR BRIDGING.

1. BALD HEAD LIGHTHOUSE, 1851
2. FEDERAL POINT, 1913
3. KURE BEACH W.T., 1913
4. CAROLINA BEACH MUN. W.T., 1968
5. RUINS, 1917
6. MASON, 1918
7. WRIGHTSVILLE BEACH SOUTH MUN. W.T., 1962
8. WRIGHTSVILLE BEACH NORTH MUN. W.T., 1962
9. KIRKLAND, 1932
10. HAMPSTEAD 2, 1947
11. ATKINSON, 1914
12. SEARS LANDING, TANK 1943
13. BETHEA, 1932
14. GRANT, 1932

DESCRIPTIVE REPORT CONTROL RECORD

MAP T- P-00682 PROJECT NO. CM-7218 SCALE OF MAP 1:10,000 SCALE FACTOR None

STATION	SOURCE OF INFORMATION (INDEX)	DATUM	LATITUDE OR Y COORDINATE LONGITUDE OR X COORDINATE	DISTANCE FROM GRID OR PROJECTION LINE IN METERS (1 Ft. = 3048006 meter)	
				FORWARD	(BACK)
BALD HEAD, 1962	VOL. III P. 2834	NA 1927	33° 51' 46.13802"	1421.5	(427.1)
			78° 00' 33.44702"	859.8	(682.5)
BALD HEAD LIGHTHOUSE, 1851	VOL. III P. 2835	"	33° 52' 24.06300"	741.4	(1107.2)
			78° 00' 02.34499"	60.3	(1481.8)
COMPUTED BY A. C. Rauck Jr	DATE 3/29/73	CHECKED BY L. B. Foltz	DATE 3/29/73		

COMPILATION REPORT

TP-00682

31. DELINEATION

Delineation was by the Wild B-8 stereoplotter using 1:40,000 scale color photography originally intended for mapping of CM-7219 at 1:20,000 scale. CM-7219 was a part of the SCOPE project and no hydro-support data was compiled. The ratios were preprocessed for office use only.

32. CONTROL

See the CM-7219 Photogrammetric Plot Report, Part II dated March 21, 1973 submitted with this report.

33. SUPPLEMENTAL DATA

None

34. CONTOURS AND DRAINAGE

Contours are not applicable to the project. Drainage was delineated by the Wild B-8 stereoplotter and by office interpretation of the photographs.

35. SHORELINE AND ALONGSHORE DETAILS

Alongshore details were delineated by the Wild B-8 stereoplotter from office interpretation of the photographs.

The mean high water line was delineated from the photographs.

36. OFFSHORE DETAILS

None

37. LANDMARKS AND AIDS

Preliminary Forms 76-40, Nonfloating Aids for Charts, were prepared by the Compilation Office and forwarded to the Field Editor and/or the Hydrographer for verification, location,

or deletion.

38. CONTROL FOR FUTURE SURVEYS

None

39. JUNCTIONS

See the attached Form 76-36b, item #5 of the Descriptive Report concerning junctions.

40. HORIZONTAL AND VERTICAL ACCURACY

No statement

46. COMPARISON WITH EXISTING MAPS

A comparison has been made with the following U.S. Geological Survey Quadrangle: CAPE FEAR, NORTH CAROLINA, scale 1:24,000, dated 1970.

47. COMPARISON WITH NAUTICAL CHARTS

A comparison has been made with the following National Ocean Survey chart: No. 1236, 6th edition, Feb. 17, 1969; No. 426, 13th edition, Apr. 20, 1974.

ITEMS TO BE APPLIED TO NAUTICAL CHARTS IMMEDIATELY

None

ITEMS TO BE CARRIED FORWARD

None

Submitted by:

Albert C. Rauck, Jr.
for Charles Parker
Cartographic Aid; Apr. 3, 1973

Approved:

Albert C. Rauck, Jr.
Albert C. Rauck, Jr.
Chief, Coastal Mapping Section, AMC

ADDENDUM TO THE COMPILATION REPORT

TP-00682

FIELD EDIT

Field edit was adequate - all questions were answered.

The height of Bald Head Lighthouse was given as 101.5 feet, but was rounded up to 102 feet; the height above sea level was not measured by the field editor, but was estimated from a 5 ft. contour interval quadrangle of the area.

The shoreline was re-compiled from 1973 MHW photograph (73C(C)4807(I)). The MLW line was added from 1973 MLW photograph (73C(C)6079R).

The wooden walkway in the northeast corner of the manuscript was identified on photo 72 E 6868 in field edit notes for adjoining sheet TP-00683; the 2 sheets were junctioned and the walkway was extended across onto TP-00682.

2 Oct. 1975

GEOGRAPHIC NAMES

FINAL NAME SHEET

CM-7218 (Lower Cape Fear River, N.C.)

TP-00682

Atlantic Ocean

Bald Head

Bald Head Island

Long Bay

Smith Island

Approved by

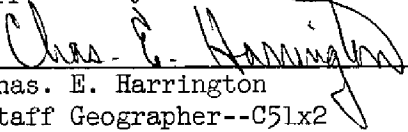
Chas. E. Harrington
Staff Geographer--C51x2

NOAA FORM 75-74 (2-74)		U.S. DEPARTMENT OF COMMERCE NOAA NATIONAL OCEAN SURVEY	
PHOTOGRAMMETRIC OFFICE REVIEW T-10363			
1. PROJECTION AND GRIDS A. L. S.	2. TITLE A. L. S.	3. MANUSCRIPT NUMBERS A. L. S.	4. MANUSCRIPT SIZE A. L. S.
CONTROL STATIONS			
5. HORIZONTAL CONTROL STATIONS OF THIRD-ORDER OR HIGHER ACCURACY A. L. S.	6. RECOVERABLE HORIZONTAL STATIONS OF LESS THAN THIRD-ORDER ACCURACY (Topographic stations) NA	7. PHOTO HYDRO STATIONS XX	
8. BENCH MARKS NA	9. PLOTTING OF SEXTANT FIXES XX	10. PHOTOGRAMMETRIC PLOT REPORT A. L. S.	11. DETAIL POINTS A. L. S.
ALONGSHORE AREAS (Nautical Chart Data)			
12. SHORELINE A. L. S.	13. LOW-WATER LINE XX	14. ROCKS, SHOALS, ETC. XX	15. BRIDGES XX
16. AIDS TO NAVIGATION XX	17. LANDMARKS A. L. S.	18. OTHER ALONGSHORE PHYSICAL FEATURES XX	19. OTHER ALONGSHORE CULTURAL FEATURES XX
PHYSICAL FEATURES			
20. WATER FEATURES XX	21. NATURAL GROUND COVER NA	22. PLANETABLE CONTOURS NA	
23. STEREOSCOPIIC INSTRUMENT CONTOURS NA	24. CONTOURS IN GENERAL NA	25. SPOT ELEVATIONS NA	26. OTHER PHYSICAL FEATURES
CULTURAL FEATURES			
27. ROADS A. L. S.	28. BUILDINGS XX	29. RAILROADS XX	30. OTHER CULTURAL FEATURES XX
BOUNDARIES			
31. BOUNDARY LINES NA		32. PUBLIC LAND LINES NA	
MISCELLANEOUS			
33. GEOGRAPHIC NAMES No standard available at this time.	34. JUNCTIONS A. L. S.	35. LEGIBILITY OF THE MANUSCRIPT A.L.S. Except Grid Values	
36. DISCREPANCY OVERLAY A. L. S.	37. DESCRIPTIVE REPORT A. L. S.	38. FIELD INSPECTION PHOTOGRAPHS XX	39. FORMS A. L. S.
40. REVIEWER A. L. Shands 4/5/72		SUPERVISOR, REVIEW SECTION OR UNIT Albert C. Rauck Jr.	
41. REMARKS (See attached sheet)			
FIELD COMPLETION ADDITIONS AND CORRECTIONS TO THE MANUSCRIPT			
42. Additions and corrections furnished by the field completion survey have been applied to the manuscript. The manuscript is now complete except as noted under item 43.			
COMPILER J. Desch March 1975 Frank Margiotta April 1975		SUPERVISOR Albert C. Rauck Jr.	
43. REMARKS Field edit applied from field edit ozalid, photo 72E 6868 (road delineation) field edit report.			



U.S. DEPARTMENT OF COMMERCE
National Oceanic and Atmospheric Administration

Date: 12 Dec. 1973

Photo Party 62
P.O. Box 3044
Wilmington, N.C. 28401

Reply to
Attn of: Chief, Photo Party 62

Subject: Field Edit Report
TP - 00682
Bald Head

To: Coastal Mapping Compilation Section CAM 521

51. Methods

All deletions, additions, corrections and answers to office questions are referred to on the "FIELD EDIT OZALID - Field Copy". All field edit writing is in purple ink, except that deletions are in green ink.

Buildings located at Pos. #1 and #2 were located by sextant and tape. Roads on photo E-6868 were inadvertently classified as per page 424 of Topographic Manual Part II. Bald Head Lighthouse was measured by tape.

MHWL measurements were made with tape from hydrographic control stations, see attachments.

52. Accuracy of compilation

The compilation will be complete and adequate when field edit information is included.

53. Map accuracy

No accuracy tests were made.

54. Recommendations

None.

55. Examination of proof copy

Mr. Jerry R. Mitchell
Wm. F. Freeman Associates
P.O. Box 2103
High Point, N.C. 27261

Mr. David Wakefield
Carolina Cape Fear Corporation
P.O. Box 6
Southport, N.C. 28461

phone: 885-4031

phone: 919-457-6763

56. Field editors

Field edit of this manuscript was done by Lt.(jg) R. David Black and Mr. Joel J. Marin. Work was supervised by Mr. Robert S. Tibbetts. If there are any questions concerning this field edit, please contact the Chief, Photo Party 62 at the address above or phone FTS 919-763-9544 or commercial 919-763-9971 Ext. 544.

R. David Black
R. David Black Lt.(jg) NOAA

STATION NAME	X coordinate	Y coordinate	July-Aug. 1973 Distance to MHWL
B1	2,301,211.23	41,451.06	23 ft.
B2	2,302,103.14	40,311.87	29 ft.
B3	2,303,474.70	40,167.99	93 ft.
B4	2,304,568.30	39,653.96	22 ft.
B5	2,305,959.25	39,221.89	80 ft.
B6	2,307,244.91	38,706.45	19 ft.
B7	2,308,617.68	38,252.26	91 ft.
B8	2,309,988.38	37,650.15	137 ft.
B9	2,311,291.43	36,901.99	69 ft.
B10	2,312,273.19	36,431.30	149 ft.
B11	2,313,682.47	35,420.53	27 ft.
B12	2,315,322.68	35,831.75	272 ft.
BUZZARD 1962	2,316,552. ^{1.90} 56	48,813. ³⁷ 85	225 ft.
VUB	2,317,465.48	53,275. ¹³ 51	239 ft.
MARK	2,315,542.29	40,396.33	145 ft.
BAT	2,320,178.43	64,752.77	
COW	2,320,579.69	66,154.67	
ACE	2,319,759.41	63,347.88	
DUN	2,319,146.63	58,932.30	47 ft.
RED	2,319,925.21	61,855.34	
OL1	2,319,596.47	60,621.14	10 ft.
POL	2,317,961.30	55,879.23	290 ft.
OL2	2,318,549.95	57,395.42	264 ft.

STATION NAME	x coordinate	y coordinate	July - Aug. 1973 Distance to MHWL
312	2,315,183.06	34,852.77	12 ft.
OL 3	2,317,294.00	52,162.36	163 ft.
OL 4	2,316,826.94	49,853.38	183 ft.
RAT	2,317,092.71	50,858.36	138 ft.
SIG	2,315,893.75	42,992.72	115 ft.
321	2,316,396.68	47,487.87	142 ft.
320	2,316,180.03	45,637.72	91 ft.
319	2,316,013.12	44,212.33	158 ft.
PR1	2,317,576.03	54,360.36	346 ft.
317	2,316,744.54	41,694.72	91 ft.
315	2,315,470.21	39,049.89	210 ft.
314	2,315,422.39	37,306.50	227 ft.

REVIEW REPORT TP-00682

SHORELINE

June 1976

61. GENERAL STATEMENT

See Summary which is page six of this Descriptive Report.

Project instructions for Job CM-7218, Part I, dated Feb 27, 1973 state that hydro support photographs should be processed. Since Del Norte was used to fix positions, hydro support photos were not required and were not processed.

The term "tide coordinated" is loosely used with this project. Photography was flown at mean high water and mean low water based on predicted tides not based on staff readings, as is generally thought of when "tide coordinated" is used. The word "predicted" is used in the remarks column on Form 76-15, Photographic Flight Report, for the 1973 photography, which is referred to in the project instructions as being tide coordinated.

A comparison print showing differences noted in paragraphs 62 through 65 is included with the original of this report.

62. COMPARISON WITH REGISTERED TOPOGRAPHIC SURVEYS

A comparison was made with T-8203, scale 1:20,000, dated 1942. Significant differences are shown in blue on the comparison print. In the area compared, TP-00682 supersedes T-8203 for nautical chart construction purposes. T-8203 is the latest registered prior survey of the area.

63. COMPARISON WITH MAPS OF OTHER AGENCIES

A comparison was made with U.S.G.S. Quadrangle CAPE FEAR, NC., scale 1:24,000 dated 1970. Differences are shown in brown on the comparison print.

64. COMPARISON WITH CONTEMPORARY HYDROGRAPHIC SURVEYS

A comparison was made with the verified smooth sheet H-9359 (AHP-10-7-73), scale 1:10,000, dated 1973. The high water line on the final reviewed TP-sheet was moved inshore from the

shoreline on the hydro sheet. This was a result of "tide-coordinated" photography being taken of this area in October and November of 1973. The shoreline was revised using the photography. This difference is noted in purple on the comparison print.

65. COMPARISON WITH NAUTICAL CHARTS

The area covered by this map lies within the limits of NOAA-NOS Chart 11537 (426), scale 1:40,000, 14th edition, dated March 8, 1975. A submerged wreck shown at latitude 33° 51.3 longitude 78°00.6 could not be seen on photography and was not shown on the TP sheet. This and other significant differences are shown in red on the comparison print.

66. ADEQUACY OF RESULTS AND FUTURE SURVEYS

This map complies with Project Instructions (See Summary and Section 61 of this report), meets the requirements for Bureau Standards, and National Standards of Map Accuracy.

Reviewed by:

Billy H. Barnes

Billy H. Barnes
Cartographer

Approved for forwarding:

Joseph W. Vonasek
Joseph W. Vonasek
Chief, Photogrammetric Branch, AMC

Approved:

Joseph W. Vonasek
Chief, Photogrammetric Branch JB

Jan C. ...
Chief, Coastal Mapping Div.

TP-00682
Scale 1:10,000

23

X=2,300,000 FT.

00'30"

78°00'00"

39101

33°52'30"

COMPARISON PRINT
Red = Chart 11537(426)
Blue = T-8203
Purple = H-9359
Brown = USGS QUAD

BALD HEAD
LIGHTHOUSE 1851
ht=102(114)

Wooden
walkway

Y=45,000 FT.

Wreck

52'

Bald
Head

Wreck

BALD
HEAD
1962

Smith
Bald Head Island

BAY

51'30"

Y=40,000 FT.

Subm. Wreck

