

TP-00406

TP-00406

NOAA FORM 76-35

U.S. DEPARTMENT OF COMMERCE
NATIONAL OCEANIC AND ATMOSPHERIC ADMINISTRATION
NATIONAL OCEAN SURVEY

DESCRIPTIVE REPORT

Type of Survey SHORELINE

Job No. PH-7107 Map No. .. TP-00406 ..

Classification No. Final Edition No. 1

Field Edited Map

LOCALITY

State California

General Locality ... Dana Point to Point Vicente ..

NOAA FORM 76-36A (3-72)		U. S. DEPARTMENT OF COMMERCE NATIONAL OCEANIC AND ATMOSPHERIC ADMIN.		TYPE OF SURVEY <input checked="" type="checkbox"/> ORIGINAL <input type="checkbox"/> RESURVEY <input type="checkbox"/> REVISED		SURVEY TP. 00406 MAP EDITION NO. (1) MAP CLASS Final JOB PH. 7107	
DESCRIPTIVE REPORT - DATA RECORD				LAST PRECEDING MAP EDITION			
PHOTOGRAMMETRIC OFFICE Coastal Mapping Division, Atlantic Marine Center, Norfolk, VA				TYPE OF SURVEY <input type="checkbox"/> ORIGINAL <input type="checkbox"/> RESURVEY <input type="checkbox"/> REVISED		JOB PH. _____ MAP CLASS _____ SURVEY DATES: 19__ TO 19__	
OFFICER-IN-CHARGE Jeffrey G. Carlen, CDR							
I. INSTRUCTIONS DATED							
1. OFFICE				2. FIELD			
Aerotriangulation August 17, 1971 Compilation Nov. 05, 1971 Supplement 1 Oct. 09, 1973 Amendment 1 Oct. 30, 1973 Amend. 1 to Supp. 1 Jan. 28, 1974				Premarking March 1, 1971 Premarking Supplement I February 25, 1972			
II. DATUMS							
1. HORIZONTAL:				OTHER (Specify)			
<input checked="" type="checkbox"/> 1927 NORTH AMERICAN							
2. VERTICAL:				OTHER (Specify)			
<input checked="" type="checkbox"/> MEAN HIGH-WATER <input type="checkbox"/> MEAN LOW-WATER <input checked="" type="checkbox"/> MEAN LOWER LOW-WATER <input type="checkbox"/> MEAN SEA LEVEL							
3. MAP PROJECTION				4. GRID(S)			

COMPILATION SOURCES

1. COMPILATION PHOTOGRAPHY

CAMERA(S) Wild RC-8 "L"		TYPES OF PHOTOGRAPHY LEGEND (C) COLOR (P) PANCHROMATIC (I) INFRARED		TIME REFERENCE	
TIDE STAGE REFERENCE <input checked="" type="checkbox"/> PREDICTED TIDES <input type="checkbox"/> REFERENCE STATION RECORDS <input checked="" type="checkbox"/> TIDE CONTROLLED PHOTOGRAPHY				ZONE Pacific MERIDIAN 120th	<input checked="" type="checkbox"/> STANDARD <input type="checkbox"/> DAYLIGHT
NUMBER AND TYPE	DATE	TIME	SCALE	STAGE OF TIDE	
71L(C) 1602 - 1605 *71L(I) 1982 - 1985	3/5/71 3/6/71	13:05 14:55	1:15,000 1:15,000	0.2 ft. above MLLW ±0.2 ft. of MLLW	

REMARKS

*Denotes tide controlled photography

2. SOURCE OF MEAN HIGH-WATER LINE:

Office interpretation of the above listed photography.

3. SOURCE OF MEAN LOW-WATER OR MEAN LOWER LOW-WATER LINE:

*Air photo compilation-tide controlled infrared photography at ±0.2 ft., dated March 6, 1971. Photo centers not mapped.

4. CONTEMPORARY HYDROGRAPHIC SURVEYS (List only those surveys that are sources for photogrammetric survey information.)

SURVEY NUMBER	DATE(S)	SURVEY COPY USED	SURVEY NUMBER	DATE(S)	SURVEY COPY USED

5. FINAL JUNCTIONS

NORTH No Contemporary Survey	EAST TP-00407 1:5,000 scale	SOUTH No Contemporary Survey	WEST TP-00405 1:10,000 scale
------------------------------------	-----------------------------------	------------------------------------	---------------------------------

REMARKS

NOAA FORM 76-36C
(3-72)U. S. DEPARTMENT OF COMMERCE
NATIONAL OCEANIC AND ATMOSPHERIC ADMINISTRATION
NATIONAL OCEAN SURVEY

HISTORY OF FIELD OPERATIONS

I. ☒ FIELD INSPECTION OPERATION☐ FIELD EDIT OPERATION

OPERATION	NAME	DATE
1. CHIEF OF FIELD PARTY	R. B. Melby	Feb/Mar 1971
2. HORIZONTAL CONTROL	RECOVERED BY ESTABLISHED BY PRE-MARKED OR IDENTIFIED BY	None None None
3. VERTICAL CONTROL	RECOVERED BY ESTABLISHED BY PRE-MARKED OR IDENTIFIED BY	None None None
4. LANDMARKS AND AIDS TO NAVIGATION	RECOVERED (<i>Triangulation Stations</i>) BY LOCATED (<i>Field Methods</i>) BY IDENTIFIED BY	None None None
5. GEOGRAPHIC NAMES INVESTIGATION	TYPE OF INVESTIGATION <input type="checkbox"/> COMPLETE <input type="checkbox"/> SPECIFIC NAMES ONLY BY <input checked="" type="checkbox"/> NO INVESTIGATION	
6. PHOTO INSPECTION	CLARIFICATION OF DETAILS BY	None
7. BOUNDARIES AND LIMITS	SURVEYED OR IDENTIFIED BY	NA

II. SOURCE DATA

1. HORIZONTAL CONTROL IDENTIFIED

None

2. VERTICAL CONTROL IDENTIFIED

None

PHOTO NUMBER	STATION NAME	PHOTO NUMBER	STATION DESIGNATION

3. PHOTO NUMBERS (*Clarification of details*)

None

4. LANDMARKS AND AIDS TO NAVIGATION IDENTIFIED

None

PHOTO NUMBER	OBJECT NAME	PHOTO NUMBER	OBJECT NAME

5. GEOGRAPHIC NAMES: ☐ REPORT ☒ NONE6. BOUNDARY AND LIMITS: ☐ REPORT ☒ NONE

7. SUPPLEMENTAL MAPS AND PLANS

None

8. OTHER FIELD RECORDS (*Sketch books, etc. DO NOT list data submitted to the Geodesy Division*)

None

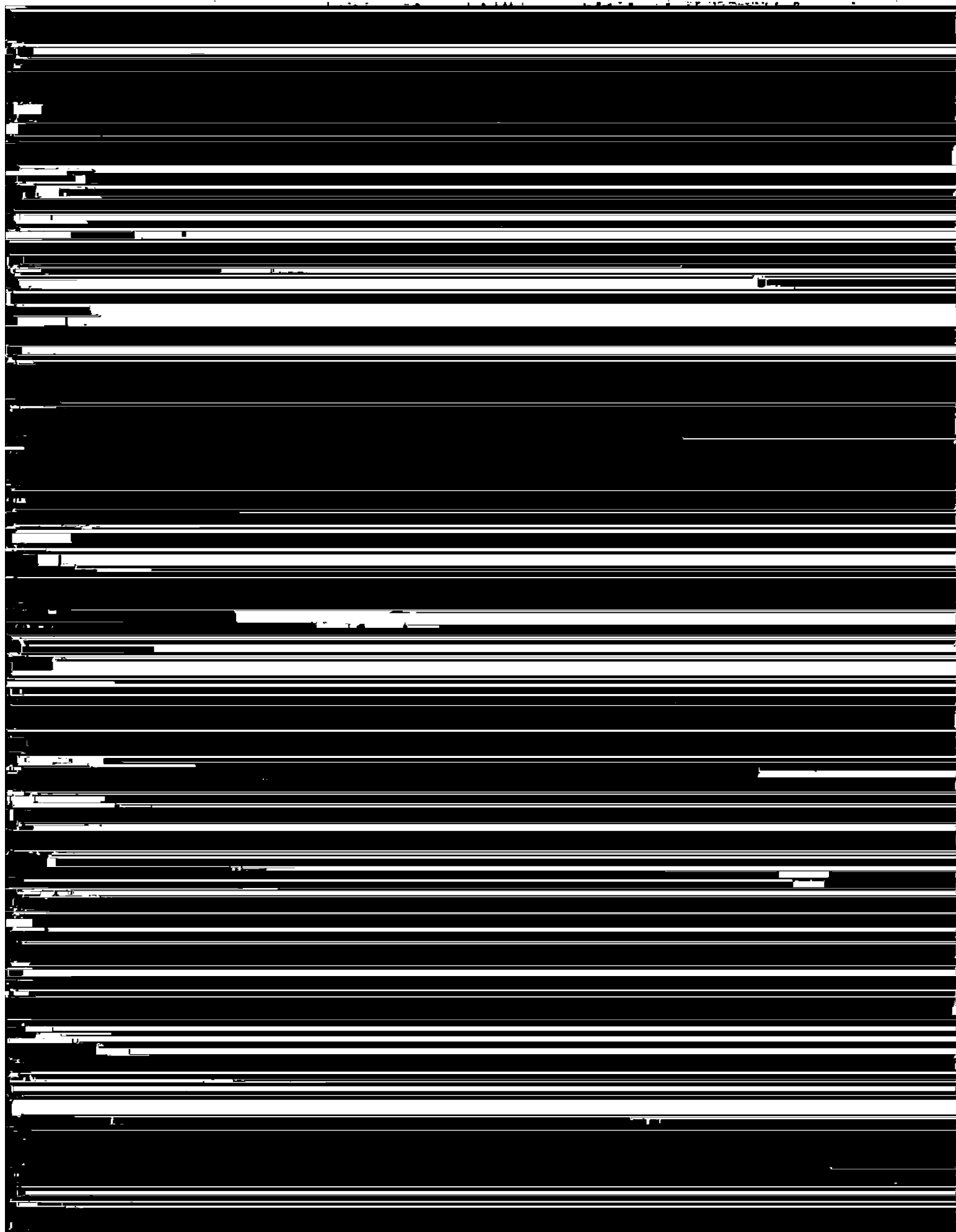

SUMMARY TO ACCOMPANY

TP-00404 through TP-00415

Maps included in this summary comprise roughly the southern half of Project PH-7107. Maps TP-00406 through TP-00411 are 1:5,000 scale. TP-00404, TP-00405 and TP-00412 through TP-00415 are 1:10,000 scale.

These maps cover the mainland coast of California from Dana Point northward to Huntington Beach. Each map is a standard shoreline map the purpose, of which, is to provide shoreline in support of contemporary hydrographic operations and for nautical chart construction.

The shoreline is composed primarily of sand. Large amounts are deposited from runoff during the winter and spring rains. Much of the sand is then eroded during the dry months. This cycle of erosion and deposition causes the shoreline to meander in and out. As a result, the mean high water line throughout the entire area is constantly changing.

Field operations prior to compilation consisted of the recovery and identification of horizontal control used in the bridge and leveling operations used to establish the mean lower low water datum in connection with the tide coordinated infrared photography.

The job was bridged in two parts. Bridging for this part of the job was done at the Rockville Office in November, 1971. All ratios were determined and photographs were ordered at that time.

All maps were compiled at the Atlantic Marine Center in January and February, 1972. Field edit was accomplished in October, 1974.

Field edit application and Final Review was performed at the Atlantic Marine Center. All pertinent data was forwarded to the Rockville Office for reproduction and final registration.

7

Field Report
Project PH-7107
Dana Point to Point Vicente, California
Shoreline Mapping
February - March 1971

The field work pertaining to this project consisted of premarking horizontal control stations prior to aerial photography and furnishing tidal observations necessary for tide control photography.

Horizontal Control:

The horizontal control requirements consisted of paneling preselected triangulation stations. The panels were the conventional, white, opaque polyethylene plastic, cut to the specifications as required for 1:30,000 scale photography.

Form 152, Control Station Identification cards will be submitted for each station paneled. All of the panels are in open areas and shadows or cliffs should not be a problem. Panel array No. 1 was used exclusively, although in some instances, the length or position of the rays were altered to conform to the existing terrain.

Tide Observations:

At Newport Bay, three existing tidal bench marks were tied by spirit levels to the stop on the portable tide staff, of the operating tide gage. The values agreed favorably with the results as determined by a party from the San Francisco Field Office on 2 February 1971. Staff reading of 3.18 feet equals 0.00 feet mean lower low water.

The staff was read at least one hour prior to, during, and one hour after the anticipated or actual aerial photography. The readings were at five minute intervals to the nearest 0.05 foot. The air photo mission was informed by radio of the tide staff readings, during the overflights. The field level observations are recorded in Form 258, "Leveling Record - Tide Station".

A bubbler tide gage was installed on the Oceanside Pier, Oceanside, California, 3 March 1971 to provide tidal data for the proposed tide-controlled photography, scheduled for October 1971.

Respectfully Submitted,

Robert B. Melby

Robert B. Melby
Chief, PMC Field Party

PHOTOGRAMMETRIC PLOT REPORT
Part 1
Dana Point to Point Vicente
California
Job PH-7107
November 1971

21. Area Covered

The area covered by this report is along the west coast of California. Control was extended for the shoreline compilation of the following maps:

<u>1:5,000 scale</u>	<u>1:10,000 scale</u>
TP-00406	TP-00404
TP-00407	TP-00405
TP-00408	TP-00412
TP-00409	TP-00413
TP-00410	TP-00414
TP-00411	TP-00415

22. Method

Strip #1 (1:30,000 scale photography) was bridged using analytical aerotriangulation methods. Sketch #1 shows the flight line of the photography and the placement of the control used in the adjustment. Compilation points were located between Strip #1 and Strips #2, #3 and #4 (1:15,000 scale photography) to control the 1:5,000 scale compilation. Compilation points were also located between Strip #1 and Strip #5 (1:30,000 scale photography) where coverage from Strip #1 was not sufficient to control the 1:10,000 scale

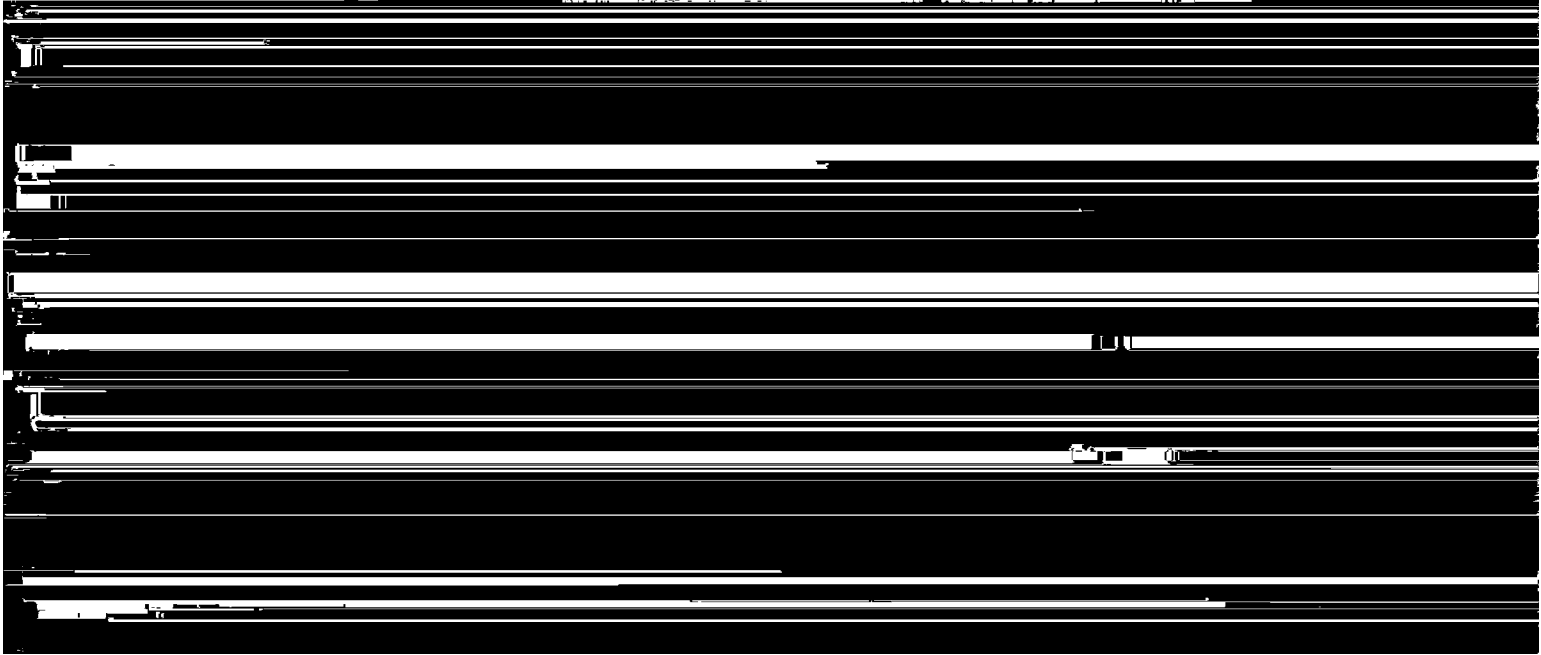

2

24. Supplemental Data

USGS quadrangles were used to provide vertical control for the adjustment.

25. Photography

The following 1:30,000 scale RC-8 color photography was used in bridging Strip #1:

71-L(C)-1653 thru 1674

The definition and quality of photography was adequate.

Submitted by:



Donald M. Brant

Approved by:



Henry E. Eichert, Chief
Aerotriangulation Section

Sketch #1 8c

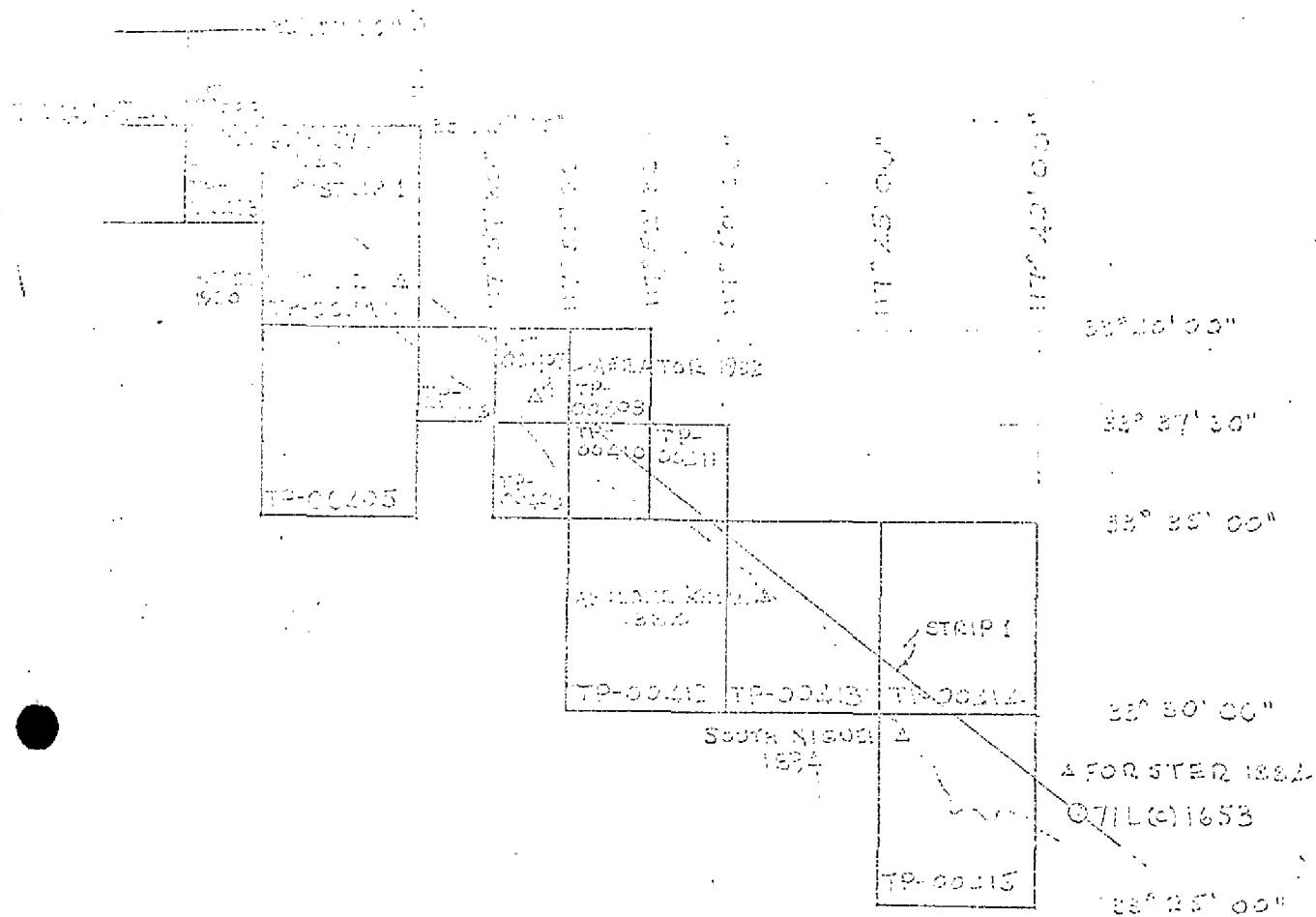

A CONTROL USED IN ADJUSTMENT
O 1:50,000 SCALE PHOTOGRAPHY

JOB PH - 7167
DANA POINT TO POINT VICENTE
CALIFORNIA
SHORE LINE MAPPING
SCALE 1:10,000 & 1:5,000

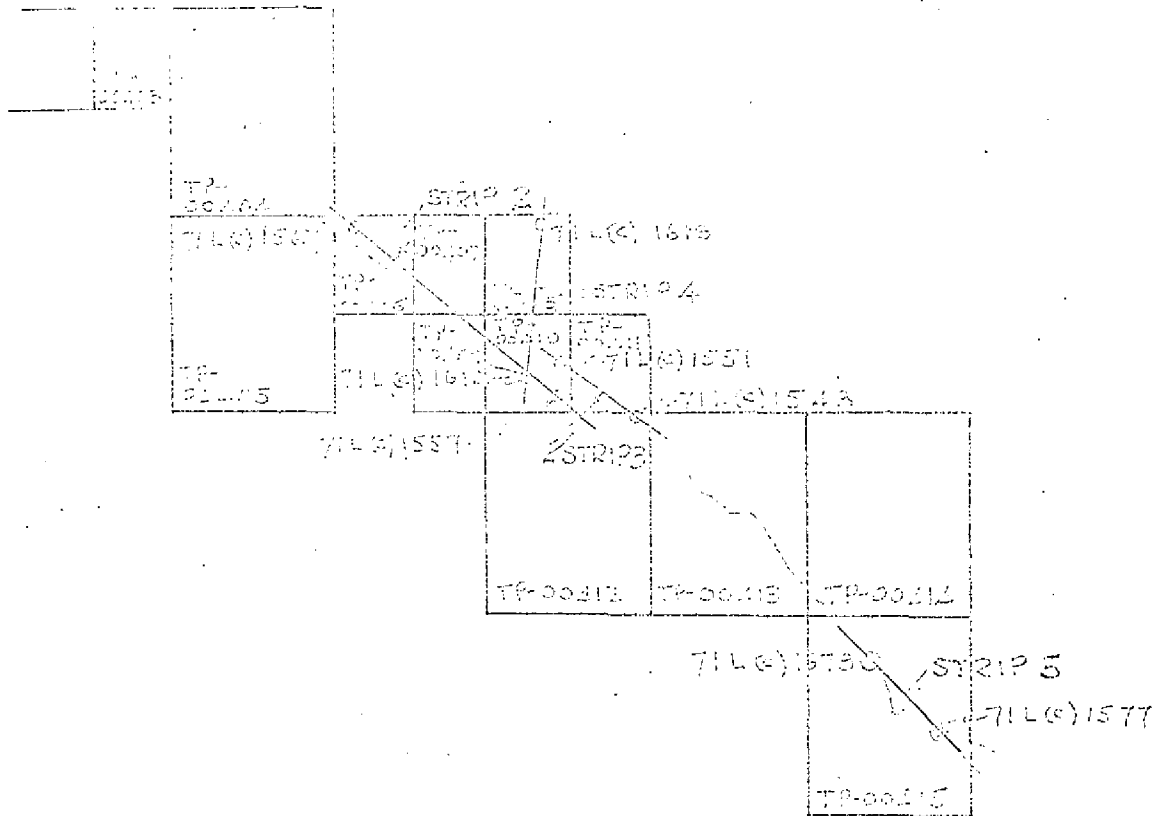

0 115,000 PHOTOGRAPHY

0 1150,000 PHOTOGRAPHY

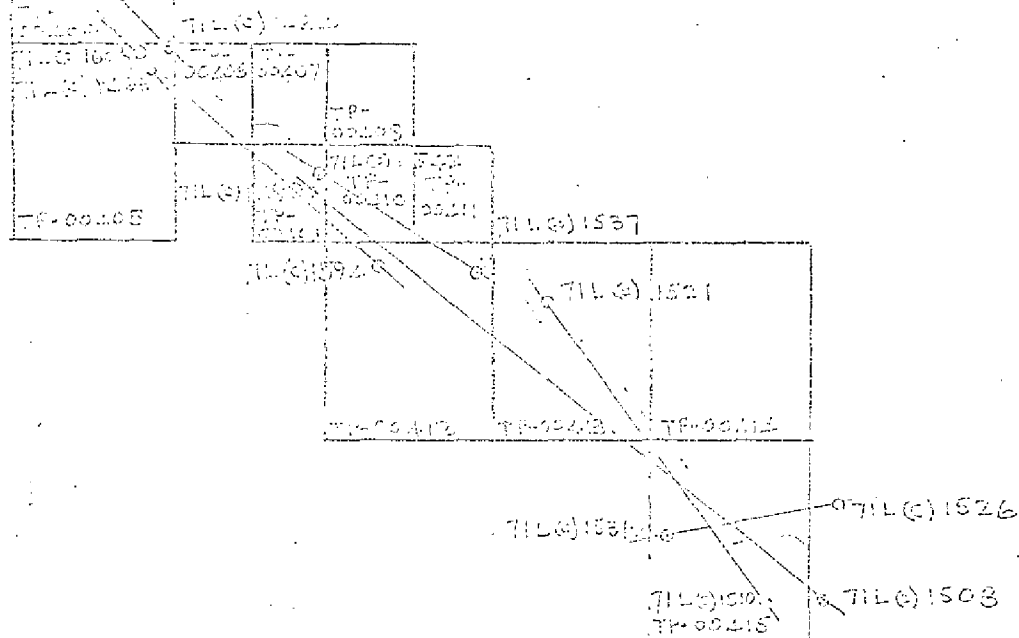

0115,000 SLICE HYDRO COMPACT PHOTOGRAPH
0112,000 SLICE HYDRO COMPACT PHOTOGRAPH

COMPILATION REPORT

TP-00406

31. DELINEATION:

The Wild B-8 stereoplotter was used. Photograph coverage was adequate.

A short portion of MHWL was graphically delineated at the junction of this map and TP-00405 (1:10,000 scale). Insufficient stereo model coverage at either of the two scales necessitated a graphic solution.

There was no field inspection prior to compilation.

32. CONTROL:

See Photogrammetric Plot Report, Part 1 dated November, 1971.

33. SUPPLEMENTAL DATA:

None.

34. CONTOURS AND DRAINAGE:

Contours are inapplicable. Drainage has been shown from office interpretation of the photographs.

35. SHORELINE AND ALONGSHORE DETAILS:

The mean high water line and foreshore areas were delineated from office interpretation of the photographs.

The mean lower low water line was taken from infrared photography, taken at mean lower low water.

36. OFFSHORE DETAILS:

None.

37. LANDMARKS AND AIDS:

Compilation office prepared work copies of Forms 76-40 were forwarded to the field editor for verification, location and/or deletion.

38. CONTROL FOR FUTURE SURVEYS:

No Statement.

39. JUNCTIONS:

See Form 76-36B.

40. HORIZONTAL AND VERTICAL ACCURACY:

No Statement.

46. COMPARISON WITH EXISTING MAPS:

Comparison was made with USGS Quadrangle, Newport Beach, CA, scale 1:24,000, dated 1965.

47. COMPARISON WITH NAUTICAL CHARTS:

Comparison has been made with Chart No. 5142, scale 1:80,000, 9th edition, dated April 7, 1971

ITEMS TO BE APPLIED TO NAUTICAL CHARTS IMMEDIATELY

None.

ITEMS TO BE CARRIED FORWARD

None.

Submitted by:

Charles E. Blood
Charles E. Blood
Cartographic Technician
December 28, 1971

Approved:

Albert C. Rauck, Jr.
Albert C. Rauck, Jr.
Chief, Coastal Mapping Section, AMC

ADDENDUM TO THE COMPILATION REPORT

TP-00406

FIELD EDIT

Field edit was adequate. Field editor did not submit form 76-40 for landmarks.

Submerged ~~oil, gasoline and water~~ pipelines were located from plans furnished by the editor.

Gene W. Perkinson

June 16, 1978

GEOGRAPHIC NAMES

FINAL NAME SHEET

PH-7107, Dana Point to Point Vicente, California

TP-00406

Huntington Beach (locality)

Huntington Beach Channel

Pacific Ocean

Santa Ana River

Talbert Channel

Approved by:

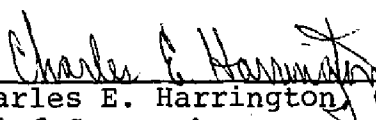
Charles E. Harrington C3x8
Chief Geographer

PHOTOGRAMMETRIC OFFICE REVIEW

TP - 00406

12

1. PROJECTION AND GRIDS LLG	2. TITLE LLG	3. MANUSCRIPT NUMBERS LLG	4. MANUSCRIPT SIZE LLG
CONTROL STATIONS			
5. HORIZONTAL CONTROL STATIONS OF THIRD-ORDER OR HIGHER ACCURACY LLG	6. RECOVERABLE HORIZONTAL STATIONS OF LESS THAN THIRD-ORDER ACCURACY (Topographic stations) NA	7. PHOTO HYDRO STATIONS NA	
8. BENCH MARKS NA	9. PLOTTING OF SEXTANT FIXES NA	10. PHOTOGRAMMETRIC PLOT REPORT ROCKVILLE SCIENCE CENTER	11. DETAIL POINTS LLG
ALONGSHORE AREAS (Nautical Chart Data)			
12. SHORELINE LLG	13. LOW-WATER LINE LLG	14. ROCKS, SHOALS, ETC. LLG	15. BRIDGES LLG
16. AIDS TO NAVIGATION NA	17. LANDMARKS LLG	18. OTHER ALONGSHORE PHYSICAL FEATURES LLG	19. OTHER ALONGSHORE CULTURAL FEATURES LLG
PHYSICAL FEATURES			
20. WATER FEATURES	21. NATURAL GROUND COVER	22. MAN-MADE FEATURES	

FIELD EDIT REPORT

MAP TP-00406

HUNTINGTON CHANNEL, CALIFORNIA

OCTOBER 1974

Field edit of map TP-00406 was done by Lcdr Joseph A. Sowers and Ltjg Andrew M. Snella during October 1974. Field inspection of the area was done at various stages of the tide by land vehicle.

METHOD

Photographs and a copy of the field edit ozalid were examined in the field. Photogrammetric techniques were used for location of features in question. The shore was virtually straight, regular sandy beach and the foreshore area was unfouled, requiring no verification of the existence of rocks, reefs, etc. All times are based on GMT.

ADEQUACY OF COMPILATION

Compilation of this map is good. The hydrography for this area has not yet been run. A Signal Oil and Gas Co. survey map "Platform Emmy Pipe Line Right of Way" has been included on the Field Edit Ozalid for an aid to locating pipelines and cables. Field inspection of this map is complete.

RECOMMENDATIONS

It is recommended that this map be revised in accordance with the notes and fix information on the ozalid and photographs, and then be accepted as an advanced manuscript.

Respectfully submitted:

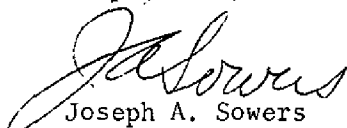
Joseph A. Sowers
LCDR, NOAA

REVIEW REPORT
TP-00406

SHORELINE

August 7, 1978

61. GENERAL STATEMENT:

See Summary, page 6 of this Descriptive Report.

62. COMPARISON WITH REGISTERED TOPOGRAPHIC SURVEYS:

No comparison was made.

63. COMPARISON WITH MAPS OF OTHER AGENCIES:

No comparison was made.

64. COMPARISON WITH CONTEMPORARY HYDROGRAPHIC SURVEYS:

Comparison was made with a copy of Final Verified Smooth Sheet H-9487 (FA-10-4 and 5-74-75). There are no differences of common details.

65. COMPARISON WITH NAUTICAL CHARTS:

Comparison was made with Chart 18746, 1:80,000 scale, 17th edition, dated March 19, 1977. There are no significant differences.

66. ADEQUACY OF RESULTS AND FUTURE SURVEYS:

This map complies with the Project Instructions and meets the requirements for Bureau Standards and the National Standards of Map Accuracy.

Submitted by:

A. L. Shands

A. L. Shands
Final Reviewer

Approved for forwarding:

Bill H. Barn

for Chief, Photogrammetric Branch, AMC

Approved:

Chief, Photogrammetric Branch

Chief, Coastal Mapping Division

RECORD OF APPLICATION TO CHARTS

FILE WITH DESCRIPTIVE REPORT OF SURVEY NO.

INSTRUCTIONS

A basic hydrographic or topographic survey supersedes all information of like nature on the uncorrected chart.

1. Letter all information.
2. In "Remarks" column cross out words that do not apply.
3. Give reasons for deviations, if any, from recommendations made under "Comparison with Charts" in the Review.

[illegible]