

TP-00181

NOAA FORM 76-35

U.S. DEPARTMENT OF COMMERCE
NATIONAL OCEANIC AND ATMOSPHERIC ADMINISTRATION
NATIONAL OCEAN SURVEY

DESCRIPTIVE REPORT

Type of Survey Shoreline

Job No. PH-6603 (PART II) Map No. TP-00181

Classification No. Edition No.

Field Edited

LOCALITY

State New York

Port Jefferson & Mt. Sinai

General Locality Harbor Long Island

Locality Crane Neck Point

1971 TO 1972

Alfred C. Holmes, Director, AMC

REGISTRY IN ARCHIVES

DATE

MAP NOT INSPECTED IN QUALITY CONTROL PRIOR
TO REGISTRATION

one item was investigated at the request
of the hydro survey reviewer. Refer to
page 18 S.B.

DESCRIPTIVE REPORT - DATA RECORD

TYPE OF SURVEY

- ☒ ORIGINAL
☐ RESURVEY
☐ REVISED

SURVEY TP. 00181

MAP EDITION NO. (1)

MAP CLASS Field edited

JOB PH. 6603 (PART II)

PHOTOGRAMMETRIC OFFICE

NOS Atlantic Marine Center

OFFICER-IN-CHARGE

Alfred C. Holmes, Director, AMC

LAST PRECEDING MAP EDITION

TYPE OF SURVEY

- ☐ ORIGINAL
☐ RESURVEY
☐ REVISED

JOB PH. _____

MAP CLASS _____

SURVEY DATES:

19__ TO 19__

I. INSTRUCTIONS DATED

1. OFFICE

Supplement I, April 1, 1971

2. FIELD

II. DATUMS

1. HORIZONTAL:

☒ 1927 NORTH AMERICAN

OTHER (Specify)

2. VERTICAL:

- ☒ MEAN HIGH-WATER
☐ MEAN LOW-WATER
☐ MEAN LOWER LOW-WATER
☐ MEAN SEA LEVEL

OTHER (Specify)

3. MAP PROJECTION

Polyconic

4. GRID(S)

STATE

New York

ZONE

Long Island

5. SCALE

1:5,000

STATE

ZONE

III. HISTORY OF OFFICE OPERATIONS

OPERATIONS	NAME	DATE
1. AEROTRIANGULATION BY METHOD: Stereoplanigraph LANDMARKS AND AIDS BY	John D. Perrow, Jr.	?
2. CONTROL AND BRIDGE POINTS PLOTTED BY METHOD: Coradomat CHECKED BY	D. Phillips II	April 12/71
3. STEREOSCOPIC INSTRUMENT PLANIMETRY BY COMPILATION CHECKED BY INSTRUMENT: Wild B-8 SCALE: 1:7,500 CONTOURS BY CHECKED BY	L.O. Neterer, Jr. A.L. Shands N.A. N.A.	Oct. 1971 Oct. 1971
4. MANUSCRIPT DELINEATION PLANIMETRY BY CHECKED BY CONTOURS BY CHECKED BY METHOD: HYDRO SUPPORT DATA BY SCALE: 1:5,000 CHECKED BY	C. Blood R.J. Pate N.A. N.A. None	Oct. 1971 Nov. 1971
5. OFFICE INSPECTION PRIOR TO FIELD EDIT BY	R.J. Pate	Nov. 1971
6. APPLICATION OF FIELD EDIT DATA BY CHECKED BY	C. Blood L.O. Neterer, Jr.	June 1972 June 1972
7. COMPILATION SECTION REVIEW BY	L.O. Neterer, Jr.	June 1972
8. FINAL REVIEW BY	B. Kurs, AMC	Aug. 1973
9. DATA FORWARDED TO PHOTOGRAMMETRIC BRANCH BY		
10. DATA EXAMINED IN PHOTOGRAMMETRIC BRANCH BY		
11. MAP REGISTERED - COASTAL SURVEY SECTION BY	R.T. CATDE	MAR 1976

TP-00181

HISTORY OF FIELD OPERATIONS

See Comp Report F.E. INST

I. ☐ FIELD INSPECTION OPERATION☒ FIELD EDIT OPERATION

OPERATION	NAME	DATE
1. CHIEF OF FIELD PARTY	R. Tibbetts	May 1972
2. HORIZONTAL CONTROL	RECOVERED BY R. Tibbetts-J. Wilson	May/72-Sept./70
	ESTABLISHED BY None	
	PRE-MARKED OR IDENTIFIED BY J. Wilson	Oct. 1970
3. VERTICAL CONTROL	RECOVERED BY N.A.	
	ESTABLISHED BY "	
	PRE-MARKED OR IDENTIFIED BY "	
4. LANDMARKS AND AIDS TO NAVIGATION	RECOVERED (Triangulation Stations) BY None	
	LOCATED (Field Methods) BY "	
	IDENTIFIED BY "	
5. GEOGRAPHIC NAMES INVESTIGATION	TYPE OF INVESTIGATION <input checked="" type="checkbox"/> COMPLETE BY A.J. Wraight <input type="checkbox"/> SPECIFIC NAMES ONLY <input type="checkbox"/> NO INVESTIGATION	1967-68
6. PHOTO INSPECTION	CLARIFICATION OF DETAILS BY A. Bricknell	May 1972
7. BOUNDARIES AND LIMITS	SURVEYED OR IDENTIFIED BY N.A.	

II. SOURCE DATA

1. HORIZONTAL CONTROL IDENTIFIED

2. VERTICAL CONTROL IDENTIFIED

N.A.

PHOTO NUMBER	STATION NAME	PHOTO NUMBER	STATION DESIGNATION
70-L-(c)-8464	Crane Neck, 1838		

3. PHOTO NUMBERS (Clarification of details)

4. LANDMARKS AND AIDS TO NAVIGATION IDENTIFIED

None

PHOTO NUMBER	OBJECT NAME	PHOTO NUMBER	OBJECT NAME

5. GEOGRAPHIC NAMES: ☒ REPORT ☐ NONE6. BOUNDARY AND LIMITS: ☐ REPORT ☒ NONE

7. SUPPLEMENTAL MAPS AND PLANS

None

8. OTHER FIELD RECORDS (Sketch books, etc. DO NOT list data submitted to the Geodesy Division)

TP-00181
RECORD OF SURVEY USE

I. MANUSCRIPT COPIES

COMPILATION STAGES			DATE MANUSCRIPT FORWARDED	
DATA COMPILED	DATE	REMARKS	MARINE CHARTS	HYDRO SUPPORT
Compilation Complete Pending Field Edit of MHWL. Oct. 1967, Field	Oct. 1971	Superseded		
Edit Applied				
Field Edit Applied	May 1972	Superseded		
Final Review	Aug. 1973			

II. LANDMARKS AND AIDS TO NAVIGATION

1. REPORTS TO MARINE CHART DIVISION, NAUTICAL DATA BRANCH

NUMBER	CHART LETTER NUMBER ASSIGNED	DATE FORWARDED	REMARKS

2. ☐ REPORT TO MARINE CHART DIVISION, COAST PILOT BRANCH. DATE FORWARDED: _____3. ☐ REPORT TO AERONAUTICAL CHART DIVISION, AERONAUTICAL DATA SECTION. DATE FORWARDED: _____

III. FEDERAL RECORDS CENTER DATA

1. ☐ BRIDGING PHOTOGRAPHS; ☐ DUPLICATE BRIDGING REPORT; ☐ COMPUTER READOUTS.
2. ☐ CONTROL STATION IDENTIFICATION CARDS; ☐ FORM NOS 567 SUBMITTED BY FIELD PARTIES.
3. ☐ SOURCE DATA (except for Geographic Names Report) AS LISTED IN SECTION II, NOAA FORM 76-36C.
ACCOUNT FOR EXCEPTIONS:

4. ☐ DATA TO FEDERAL RECORDS CENTER. DATE FORWARDED: _____

IV. SURVEY EDITIONS (This section shall be completed each time a new map edition is registered)

SECOND EDITION	SURVEY NUMBER TP - _____ (2)	JOB NUMBER PH - _____	TYPE OF SURVEY <input type="checkbox"/> REVISED <input type="checkbox"/> RESURVEY MAP CLASS <input type="checkbox"/> II. <input type="checkbox"/> III. <input type="checkbox"/> IV. <input type="checkbox"/> V. <input type="checkbox"/> FINAL
	DATE OF PHOTOGRAPHY	DATE OF FIELD EDIT	
THIRD EDITION	SURVEY NUMBER TP - _____ (3)	JOB NUMBER PH - _____	TYPE OF SURVEY <input type="checkbox"/> REVISED <input type="checkbox"/> RESURVEY MAP CLASS <input type="checkbox"/> II. <input type="checkbox"/> III. <input type="checkbox"/> IV. <input type="checkbox"/> V. <input type="checkbox"/> FINAL
	DATE OF PHOTOGRAPHY	DATE OF FIELD EDIT	
FOURTH EDITION	SURVEY NUMBER TP - _____ (4)	JOB NUMBER PH - _____	TYPE OF SURVEY <input type="checkbox"/> REVISED <input type="checkbox"/> RESURVEY MAP CLASS <input type="checkbox"/> II. <input type="checkbox"/> III. <input type="checkbox"/> IV. <input type="checkbox"/> V. <input type="checkbox"/> FINAL
	DATE OF PHOTOGRAPHY	DATE OF FIELD EDIT	

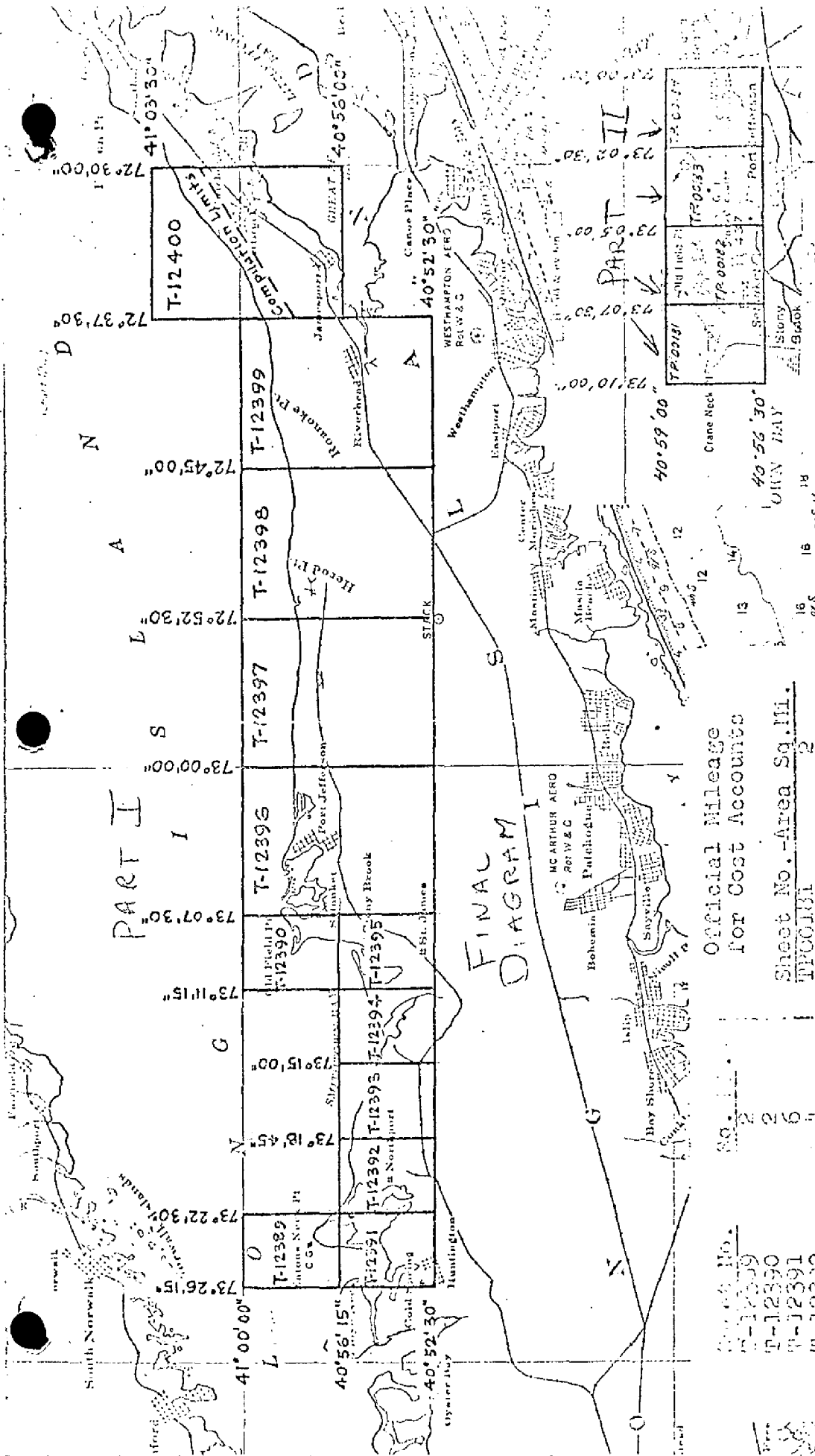

JOB PH-6603 SHORELINE MAPPING

NORTH SHORE, LONG ISLAND N.Y.
Eatons Neck to Mattituck Inlet
SCALE 1:5000 & 1:20,000

Official Mileage
For Cost Accounts
Sheet No. - Area Sq. Mi.
TP000181
TP000182
TP000183
TP000184

Sheet No.	Area Sq. Mi.
T-12389	0.00
T-12390	0.00
T-12391	0.00
T-12392	0.00
T-12393	0.00
T-12394	0.00
T-12395	0.00
T-12396	0.00
T-12397	0.00
T-12398	0.00
T-12399	0.00
T-12400	0.00
Total	0.00

Sheet No.	Area Sq. Mi.
T-12389	0.00
T-12390	0.00
T-12391	0.00
T-12392	0.00
T-12393	0.00
T-12394	0.00
T-12395	0.00
T-12396	0.00
T-12397	0.00
T-12398	0.00
T-12399	0.00
T-12400	0.00
Total	0.00

PART II

PORT JEFFERSON

27

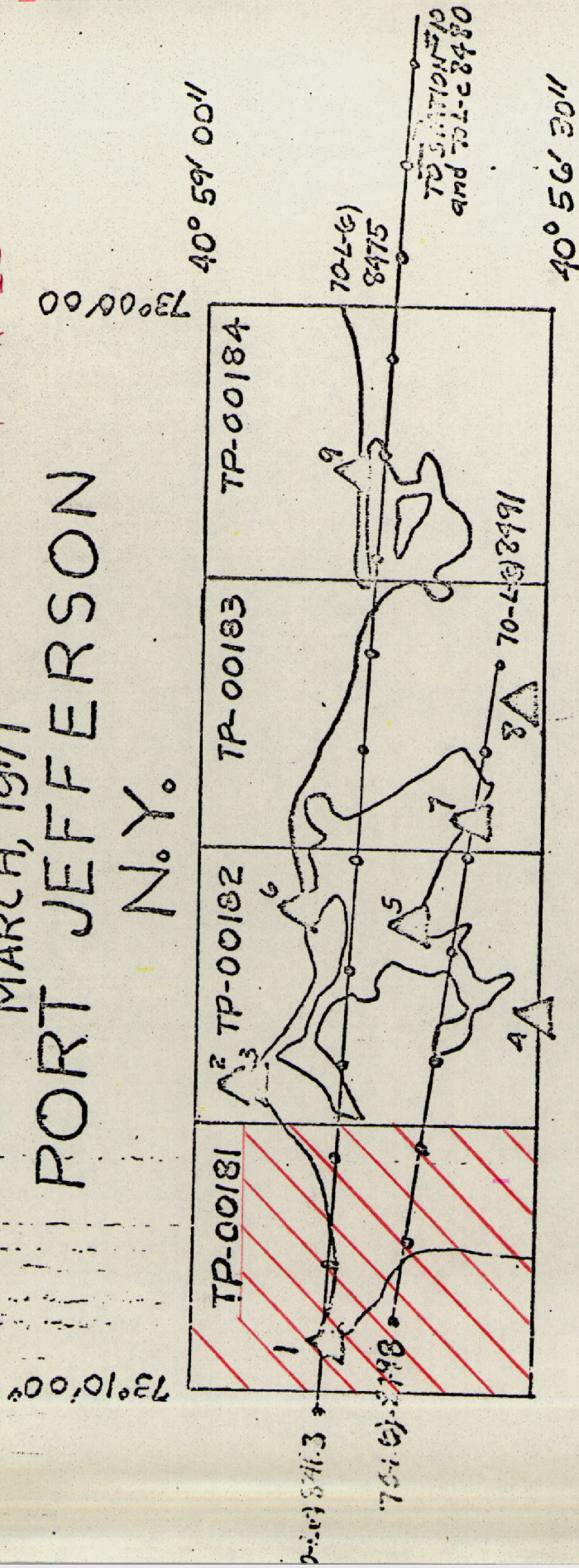

- #1 CRANE NECK, 1834
#2 OLD FIELD PT. L.H., 1882
#3 WEST RANGE 2, 1969
#4 SETAUKET, METH. CH. SPIRE, 1931
#5 TANK RM#1, 1831
#6 JETTY (PORT JEFFERSON EAST BREAKWATER LT.) 19
#7 PORT JEFFERSON, LONG ISLAND LIGHTING CO. CENTER
#8 PORT JEFFERSON, ST. CHARLES HOSP. CROSS, 196

SUMMARY TO ACCOMPANY
DESCRIPTIVE REPORT TP-00181

Shoreline survey TP-00181 is one of four 1:5,000 scale manuscripts added to Project PH-6603. These four sheets cover Port Jefferson and Mt. Sinai Harbor. This sheet is just west of the entrance to Port Jefferson.

This area was field inspected in June, 1966 for survey T-12390 (Registered) at 1:10,000 scale. The field inspection consisted of identification of horizontal control, shoreline and interior inspection, location of fixed aids to navigation and a Geographic Names Investigation. Job PH-6603
PART I

Compilation was at 1:5,000 scale by B-8 plotter using September, 1970 photography. Hydrography was completed prior to compilation therefore no specially prepared photos were ordered or made. See Instructions - Office - PH-6603 Supplement I 5.02 dated April 1, 1971. These were interpreted, by the compiler, to mean no photo centers were required. A field edit ozalid and two clean ozalids plus a set of matte ratio prints were sent for the use of the field editor.

After the application of field edit, the manuscript was scribed, stuck-up and reproduced on cronaflex. Final review was accomplished without the benefit of photo centers, at AMC during August, 1973. One cronaflex copy and a negative of the final reviewed manuscript are forwarded for record and registry.

FIELD INSPECTION

Area was field inspected under T-12390 dated June, 1966.

Photogrammetric Plot Report
Job PH-6603
Port Jefferson, New York

21. Area Covered This project covers an area of Long Island, New York, from Crane Neck Point to Sound Beach. Included in this area are shoreline surveys TP-00181 through TP-00184.

22. Method Two bridges were run on the C-8 Stereoplanigraph to provide control for the compilation of the area. The bridges were adjusted to the Lambert projection in the Long Island zone. All pass points and control were plotted on the Coradimat. Strip #1 was adjusted on five horizontal control points with two additional control points and three tie points as checks. Strip #2 was adjusted on three horizontal control points with four additional control points and three tie points as checks.

23. Adequacy of Control The horizontal control, which was provided, complied with project instructions and was adequate for bridging. All control held within National Map Accuracy Standards.

24. Supplemental Data Local USGS quads were used to provide rough vertical control for bridging purposes.

25. Photography All photography was adequate as to coverage, overlap and definition.

Submitted by:

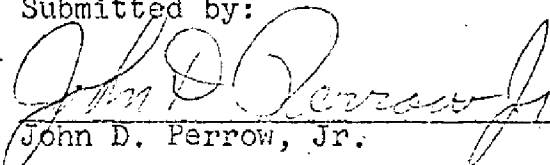
John D. Perrow, Jr.

Approved by:

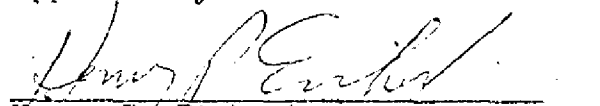
Henry P. Eichert
Chief, Aerotriangulation Section

40° 59' 00"



- #1 CRANE NECK, 1834
#2 OLD FIELD PT. L.H., 1882
#3 WEST RANGE 2, 1769
#4 SETAUKET, METH. CH. SPIKE, 1931
#5 WINK RUN#1, 1831
#6 JETTY (PORT JEFFERSON EAST BREAKWATER LT.) 1931
#7 PORT JEFFERSON, LONG ISLAND LIGHTING CO. CENTER STACK, 1962⁹
#8 PORT JEFFERSON, ST. CHARLES HOSP. CROSS. 1967

WORD

88

SCALE FACTOR

None

Y COORDINATE : X COORDINATE	N.A. 1927 - DATUM DISTANCE FROM GRID OR PROJECTION LINE IN METERS (1 Ft. = 3048006 meter) FORWARD	(BACK)
"	1695.2	(155.7)
"	415.7	(987.3)
"	1814.1	(36.8)
10"	308.7	(1094.3)
"	1142.6	(708.3)
"	1078.8	(324.4)
5"	996755	(435.9)
"		
"		
terer, Jr.	DATE Oct. 8, 1971	

terer, Jr.

DATE Oct. 8, 1971

COMPILATION REPORT TP-00181

31. DELINEATION

The Wild B-8 was used.

32. CONTROL

See Photogrammetric Plot Report, Port Jefferson, New York.

33. SUPPLEMENTAL DATA

None

34. CONTOURS AND DRAINAGE

Contours are not applicable.

Drainage was compiled from office interpretation of the photographs.

35. SHORELINE AND ALONGSHORE DETAILS

The mean high water line was delineated from office interpretation of the photographs. There were no low water photographs available at time of compilation, no low water line was mapped.

36. OFFSHORE DETAILS

Rocks and wrecks detached from the foreshore area were compiled from office interpretation of photographs.

37. LANDMARKS AND AIDS

38. CONTROL FOR FUTURE SURVEYS

None

12

39. JUNCTIONS

A satisfactory junction has been made with TP-00182; scale 1:5,000 to the east. There are no contemporary surveys to the north, west, or south.

40. HORIZONTAL AND VERTICAL ACCURACY

No statement.

46. COMPARISON WITH EXISTING MAPS

A comparison with U.S.G.S. Quadrangle SAINT JAMES, NY 1:24,000 scale, dated 1969.

47. COMPARISON WITH NAUTICAL CHARTS

A comparison with U.S.G.S. Chart 117-SC, 1:40,000 scale, 10th Edition, September 1970.

ITEMS TO BE APPLIED TO NAUTICAL CHARTS IMMEDIATELY

None

ITEMS TO BE CARRIED FORWARD

None

Submitted by:

Charles Blood
Charles Blood
Cartographic Technician
Nov. 3, 1971

Approved for forwarding:

Malvin J. Umbach
Malvin J. Umbach, CDR, NOAA
Chief, Coastal Mapping Division, AMC

Approved:

Alfred C. Holmes
Alfred C. Holmes, RADM, NOAA
Director, Atlantic Marine Center

July 27, 1973

GEOGRAPHIC NAMES

FINAL NAME SHEETS

Ph-6603 (New York)

TP-00181

Conscience Bay

Crane Neck

Crane Neck Point

Flax Pond

Long Island Sound

Old Field

West Meadow Beach

Approved:

F. F. Ceely, Jr.

F. F. Ceely, Jr.

Chief, Scientific Services Division

Prepared by:

C. E. Harrington

C. E. Harrington

Geographic Names

Job Ph-6603 Port Jefferson

NOTES FOR THE FIELD EDITOR

These four 1:5,000 scale sheets were previously mapped as T-12390 at 1:10,000 scale and T-12396 at 1:20,000 scale. They have been finally reviewed. Field edit ~~of~~^{of} the shoreline and interior details for these two sheets was done during 1967 and 1968 and was applied prior to final review.

Additional field edit of the mean high water line for these four sheets will be required. The Sept. 1970 photos indicate several berm lines on the beaches and other apparent shoreline changes, making an accurate delineation of the mean high water line difficult. An interior field edit is not required.

The mean high water line may be edited by measurements to the line from photo points or by delineating it on the matte ratios furnished.

FORM C&GS-1002
(9-68)

U.S. DEPARTMENT OF COMMERCE
ESSA
COAST AND GEODETIC SURVEY

PHOTOGRAMMETRIC OFFICE REVIEW

T. 00181

1. PROJECTION AND GRIDS RJP	2. TITLE RJP	3. MANUSCRIPT NUMBERS RJP	4. MANUSCRIPT SIZE RJP
CONTROL STATIONS			
5. HORIZONTAL CONTROL STATIONS OF THIRD-ORDER OR HIGHER ACCURACY RJP	6. RECOVERABLE HORIZONTAL STATIONS OF LESS THAN THIRD-ORDER ACCURACY (Topographic stations) XX		7. PHOTO HYDRO STATIONS N.A.
8. BENCH MARKS XX	9. PLOTTING OF SEXTANT FIXES XX	10. PHOTOGRAMMETRIC PLOT REPORT RJP	11. DETAIL POINTS RJP
ALONGSHORE AREAS (Nautical Chart Data)			
12. SHORELINE RJP	13. LOW-WATER LINE XX	14. ROCKS, SHOALS, ETC. RJP	15. BRIDGES XX
16. AIDS TO NAVIGATION XX	17. LANDMARKS RJP	18. OTHER ALONGSHORE PHYSICAL FEATURES RJP	19. OTHER ALONGSHORE CULTURAL FEATURES XX
PHYSICAL FEATURES			
20. WATER FEATURES RJP		21. NATURAL GROUND COVER N.A.	22. PLANETABLE CONTOURS N.A.
23. STEREOSCOPIC INSTRUMENT CONTOURS N.A.	24. CONTOURS IN GENERAL N.A.	25. SPOT ELEVATIONS N.A.	26. OTHER PHYSICAL FEATURES XX
CULTURAL FEATURES			
27. ROADS RJP	28. BUILDINGS RJP	29. RAILROADS XX	30. OTHER CULTURAL FEATURES XX
BOUNDARIES			
31. BOUNDARY LINES N.A.		32. PUBLIC LAND LINES N.A.	
MISCELLANEOUS			
33. GEOGRAPHIC NAMES RJP		34. JUNCTIONS RJP	35. LEGIBILITY OF THE MANUSCRIPT RJP
36. DISCREPANCY OVERLAY	37. DESCRIPTIVE REPORT	38. FIELD INSPECTION	39. REMARKS

FIELD EDIT REPORT
Job PH-6603
PORT JEFFERSON AND MT. SINAI
HARBOR, LONG ISLAND, NEW YORK

This report is submitted for Manuscript No. TP 00181.
The field edit for this sheet was completed April, 1972, with
some delays encountered due to bad weather.

52. ADEQUACY OF COMPILATION

The compilation was generally good, except for some
bath houses that were plotted as a seawall and 3 walkways
and a fallen tree plotted as groins. When field edit
corrections, additions, and deletions have been applied
compilation will be adequate.

54. RECOMMENDATIONS

None.

56. SHORELINE AND ALONGSHORE FEATURES

The mean high water line was indicated by frequent
measurements from photo points pricked on photos 70L 8465,
8467, and 8498.

All changes to the manuscript are indicated on these
three photos and/or the manuscript, and are cross referenced.

58. LANDMARKS AND AIDS

There were no aids indicated on this sheet.

59. GENERAL STATEMENT

All field edit notes have been made in Violet ink on the
field edit sheet and ratio photographs.

12 May 1972
Submitted by:

Arthur R. Bricknell

ARTHUR R. BRICKNELL
Surveying Technician

REVIEW REPORT TP-00181

SHORELINE

August, 1973

61. GENERAL STATEMENT

There are numerous charted rocks, both sunken and awash, in the vicinity of Crane Neck Point. Neither of the field inspections of 1967 or 1972 gave data pertaining to these. Wave action on the 1970 photography, which was taken at between five and six feet (predicted) above MLW made positive identification of most of these rocks impossible. Some rocks were visible and shown on the manuscript with no height.

See summary which is page 6 of the Descriptive Report.

62. COMPARISON WITH REGISTERED TOPOGRAPHIC SURVEYS

Comparison was made with T-12390 PH-6603 1:10,000 scale and reviewed and registered in 1969. There is very good agreement with the exception of minor natural changes of MHW line along sandy beaches. TP-00181 supersedes all previous registered surveys and should be used for nautical chart construction purposes.

63. COMPARISON WITH MAPS OF OTHER AGENCIES

A visual comparison was made with U.S.G.S. Quadrangle St. James, NY, 1:24,000 scale, dated 1967. There is good agreement.

64. COMPARISON WITH CONTEMPORARY HYDROGRAPHIC SURVEYS

Comparison was made with smooth sheet 8951 dated 1967 at 1:10,000 scale. Rock shown on this sheet, in Crane Neck Point area are numerous. This sheet should be used for rock information since these rocks are not visible on the photography, taken at near predicted high tide. Differences are noted on the discrepancy print in purple. *See note page 18*

65. COMPARISON WITH NAUTICAL CHARTS

A visual comparison was made with Chart 117-SC, 12th edition dated November, 1972 at 1:40,000 scale. Agreement is very good except for rock information at Crane Neck Point.

66. ADEQUACY OF RESULTS AND FUTURE SURVEYS

This survey complies with instructions and meets the National Standards of Map Accuracy.

Rocks in the vicinity of Crane Neck Point bear further investigation in future surveys.

Reviewed by:

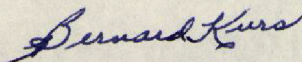

Bernard Kurs
Cartographer

Approved for forwarding:

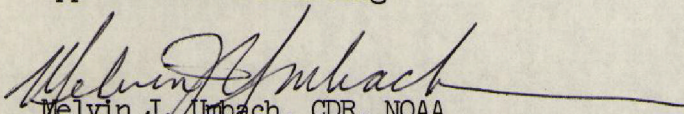

Melvin J. Umbach, CDR, NOAA
Chief, Coastal Mapping Division, AMC

Approved:

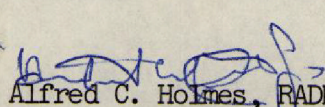

Alfred C. Holmes, RADM, NOAA
Director, Atlantic Marine Center

Approved:

Chief, Photogrammetric Branch Chief, Coastal Mapping Division

- * NOTE: Wreck west of entrance
to Flax Pond. Shown as rock
bare 3 ft on hydro survey
The object was not investigated
by the field editor

0° 58' 15"

+ Cont. 5 MLW

Very few rocks visible on photos

Naut. Chart
117 30 1:40,000
shows many rocks
in area. Visual
Comparison.

+ Cont. 3 at MLW

— Registered Survey

+ Cont. 3 MLW

Numerous rocks inshore and offshore from those mapped

Crane Neck Point

CRANE NECK 18M

58'

57' 45"

73° 09' 45"

09' 30"

09' 15"

TP-00181

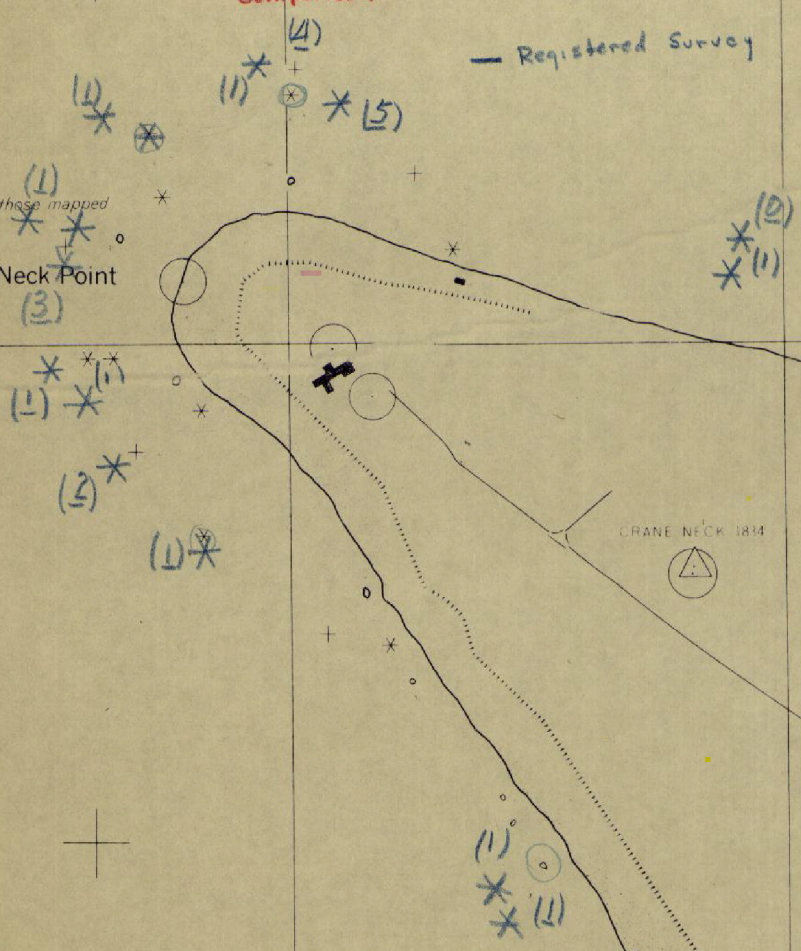

FILE WITH DESCRIPTIVE REPORT OF SURVEY NO. T-00181

INSTRUCTIONS

A basic hydrographic or topographic survey supersedes all information of like nature on the uncorrected chart.

1. Letter all information.

2. In "Remarks" column cross out words that do not apply.

3. Give reasons for deviations, if any, from recommendations made under "Comparison with Charts" in the Review.

CHART	DATE	CARTOGRAPHER	REMARKS
361	4-12-74	J. Bailey	Full Part Before After Verification Review Inspection Signed Via Drawing No. 18 <i>Fully Applied</i>
			Full Part Before After Verification Review Inspection Signed Via Drawing No.
			Full Part Before After Verification Review Inspection Signed Via Drawing No.
			Full Part Before After Verification Review Inspection Signed Via Drawing No.
			Full Part Before After Verification Review Inspection Signed Via Drawing No.
			Full Part Before After Verification Review Inspection Signed Via Drawing No.