

original

TP-00156

TP-00156

NOAA FORM 76-35	
U.S. DEPARTMENT OF COMMERCE NATIONAL OCEANIC AND ATMOSPHERIC ADMINISTRATION NATIONAL OCEAN SURVEY	
DESCRIPTIVE REPORT	
Type of Survey .Coastal .Boundary.....	
Job No. PH-6910.....	Map No. TP-00156..
Classification No. Final	Edition No. ....1.....
Field Edited Map	
LOCALITY	
State ...Florida.....	
General Locality .St...Lucie..County.....	
Locality .Hutchinson .Island.....	
.....	
<hr/> 19 70 TO 1973 <hr/>	
REGISTRY IN ARCHIVES	
DATE .....	

NOAA FORM 76-36A (3-72)		U. S. DEPARTMENT OF COMMERCE NATIONAL OCEANIC AND ATMOSPHERIC ADMIN.		TYPE OF SURVEY <input checked="" type="checkbox"/> ORIGINAL <input type="checkbox"/> RESURVEY <input type="checkbox"/> REVISED		SURVEY TP. 00156 MAP EDITION NO. (1) MAP CLASS Final JOB PH. 6910	
DESCRIPTIVE REPORT - DATA RECORD  PHOTOGRAMMETRIC OFFICE  Rockville, Maryland OFFICER-IN-CHARGE  Commander Wesley V. Hull				LAST PRECEDING MAP EDITION			
				TYPE OF SURVEY <input type="checkbox"/> ORIGINAL <input type="checkbox"/> RESURVEY <input type="checkbox"/> REVISED		JOB PH. _____ MAP CLASS _____ SURVEY DATES: 19__ TO 19__	
I. INSTRUCTIONS DATED							
1. OFFICE General Instructions-OFFICE-NOS Cooperative Coastal Boundary Mapping, Job PH-7000, June 19, 1973 OFFICE-Supplement I, August 19, 1973 Note: Office and Field Edit instructions (1973) incorporate applicable prior operational instructions. OFFICE-Supplement II, Sept. 24, 1973				2. FIELD Aerial Photography 9/2/69 Supplement I, 1/28/70 Supplement II, 3/26/70 Supplement III, 8/10/72 Field Edit (PH-7000, General Instructions for Florida Coastal Zone Mapping) 1973			
II. DATUMS							
1. HORIZONTAL: <input checked="" type="checkbox"/> 1927 NORTH AMERICAN				OTHER (Specify)			
2. VERTICAL: <input checked="" type="checkbox"/> MEAN HIGH-WATER <input checked="" type="checkbox"/> MEAN LOW-WATER <input type="checkbox"/> MEAN LOWER LOW-WATER <input type="checkbox"/> MEAN SEA LEVEL				OTHER (Specify)			
3. MAP PROJECTION  Transverse Mercator				4. GRID(S) STATE Florida ZONE East			
5. SCALE 1:10,000				STATE ZONE			
III. HISTORY OF OFFICE OPERATIONS							
OPERATIONS				NAME		DATE	
1. AEROTRIANGULATION BY METHOD: Analytic LANDMARKS AND AIDS BY				D.M. Brant		8/71	
2. CONTROL AND BRIDGE POINTS PLOTTED BY METHOD: Coradomat CHECKED BY				D. Phillips		8/71	
3. STEREOSCOPIC INSTRUMENT PLANIMETRY BY COMPILATION CHECKED BY				Inapplicable			
INSTRUMENT: CONTOURS BY				Inapplicable			
SCALE: CHECKED BY				Inapplicable			
4. MANUSCRIPT DELINEATION PLANIMETRY BY Shoreline: Graphic CHECKED BY				P. Dempsey		3/72	
METHOD: CONTOURS BY				J. Richter		3/72	
Interior: Orthophoto Mosaic CHECKED BY				Inapplicable			
SCALE: 1:10,000 CHECKED BY				J. Taylor		2/72	
5. OFFICE INSPECTION PRIOR TO FIELD EDIT BY				J.P. Battley, Jr.		2/72	
6. APPLICATION OF FIELD EDIT DATA BY				J.P. Battley, Jr.		11/72	
CHECKED BY				R. Rich		2/73	
7. COMPILATION SECTION REVIEW BY				J.P. Battley, Jr.		2/73	
8. FINAL REVIEW BY				P. Dempsey		10/73	
9. DATA FORWARDED TO PHOTOGRAMMETRIC BRANCH BY				D.M. Brant		12/73	
10. DATA EXAMINED IN PHOTOGRAMMETRIC BRANCH Edit BY				D.M. Brant		12/73	
11. MAP REGISTERED - COASTAL SURVEY SECTION BY				R. Cator		8/75	



NOAA FORM 76-36B  
(3-72)U. S. DEPARTMENT OF COMMERCE  
NATIONAL OCEANIC AND ATMOSPHERIC ADMINISTRATION  
NATIONAL OCEAN SURVEY

## COMPILATION SOURCES

TP-00156

## 1. COMPILATION PHOTOGRAPHY

CAMERA(S) Wild RC-8 E & L Cameras 6" focal length		TYPES OF PHOTOGRAPHY LEGEND		TIME REFERENCE	
TIDE STAGE REFERENCE		(C) COLOR (P) PANCHROMATIC (I) INFRARED <i>B&amp;W</i>		ZONE	
<input type="checkbox"/> PREDICTED TIDES <input type="checkbox"/> REFERENCE STATION RECORDS <input checked="" type="checkbox"/> TIDE CONTROLLED PHOTOGRAPHY				Eastern MERIDIAN 60th&75th	
				<input type="checkbox"/> STANDARD <input checked="" type="checkbox"/> DAYLIGHT	
NUMBER AND TYPE	DATE	TIME	SCALE	STAGE OF TIDE	
*70E(C)5878-5880	2/14/70	13:54	1:40,000	Inapplicable	
70L7090R-7095R	8/19/70	09:38	1:25,000		
70L6361R-6364R	8/12/70	10:40	1:25,000		
70L8985R-8989R	2/10/70	15:15	1:20,000	See Remarks	
70L8810R-8813R	2/10/70	10:10	1:20,000		
70L8851R-8856R	2/10/70	10:45	1:20,000		
70L6368R-6369R	8/12/70	10:47	1:20,000		
*Photographs used for the orthophoto mosaic.					

## REMARKS

Refer to page 5 for tide data.

## 2. SOURCE OF MEAN HIGH-WATER LINE:

*black and white tide coordinated*

The data and source of the mean high-water line is the high-water ^ infrared photography listed under item 1. The map was field edited in 1972 and 1973.

## 3. SOURCE OF MEAN LOW-WATER OR MEAN LOWER LOW-WATER LINE:

*black and white tide coordinated*

The data and source of the mean low-water line along the Atlantic Coast is the infrared photography listed under item 1. There is no mean low-water lines mapped in the Indian River. Refer to the Review Report for the explanation on the application of "shallow" and "shoal" areas on the Registration Copy for nautical charts.

## 4. CONTEMPORARY HYDROGRAPHIC SURVEYS (List only those surveys that are sources for photogrammetric survey information.)

SURVEY NUMBER	DATE(S)	SURVEY COPY USED	SURVEY NUMBER	DATE(S)	SURVEY COPY USED
Inapplicable					

## 5. FINAL JUNCTIONS

NORTH	EAST	SOUTH	WEST
TP-00155	No contempor- porary Survey	TP-00157	No contempor- porary Survey

## REMARKS

Junctions were made by the Coastal Mapping Section.



NOAA FORM 76-36C  
(3-72)U. S. DEPARTMENT OF COMMERCE  
NATIONAL OCEANIC AND ATMOSPHERIC ADMINISTRATION  
NATIONAL OCEAN SURVEY

TP-00156

## HISTORY OF FIELD OPERATIONS

I. ☒ FIELD INSPECTION OPERATION  
\*See below☒ FIELD EDIT OPERATION Jan. 1973

OPERATION	NAME	DATE
1. CHIEF OF FIELD PARTY	R.R. Wagner	1/73
2. HORIZONTAL CONTROL	RECOVERED BY W.H. Shearouse ESTABLISHED BY N.A. PRE-MARKED OR IDENTIFIED BY N.A.	1/72
3. VERTICAL CONTROL	RECOVERED BY W.H. Shearouse ESTABLISHED BY N.A. PRE-MARKED OR IDENTIFIED BY R.R. Wagner	1/72 11/72
4. LANDMARKS AND AIDS TO NAVIGATION	RECOVERED (Triangulation Stations) BY N.A. LOCATED (Field Methods) BY R.R. Wagner IDENTIFIED BY N.A.	1/73
5. GEOGRAPHIC NAMES INVESTIGATION	TYPE OF INVESTIGATION <input type="checkbox"/> COMPLETE BY <input type="checkbox"/> SPECIFIC NAMES ONLY <input checked="" type="checkbox"/> NO INVESTIGATION	
6. PHOTO INSPECTION	CLARIFICATION OF DETAILS BY R.R. Wagner	1/73
7. BOUNDARIES AND LIMITS	SURVEYED OR IDENTIFIED BY N.A.	

## II. SOURCE DATA

1. HORIZONTAL CONTROL IDENTIFIED

None

2. VERTICAL CONTROL IDENTIFIED

PHOTO NUMBER	STATION NAME	PHOTO NUMBER	STATION DESIGNATION
		70E5877	Q231
		70E5878	A34, F225, C308
		70E5879	H236, T307(SRD) U307(SRD)
			V307(SRD)
		70E5880	N231, K307
		70L6364R	A308
		70L8811R	P231

3. PHOTO NUMBERS (Clarification of details)

70E5878, 5879, 5880  
70L6362R, 8811R, 8813R70L8813R D225  
DRAIN 2(to be plotted)

4. LANDMARKS AND AIDS TO NAVIGATION IDENTIFIED

Aids to navigation located by sextant fixes. There are no landmarks.

PHOTO NUMBER	OBJECT NAME	PHOTO NUMBER	OBJECT NAME

5. GEOGRAPHIC NAMES: ☐ REPORT ☒ NONE6. BOUNDARY AND LIMITS: ☐ REPORT ☒ NONE

7. SUPPLEMENTAL MAPS AND PLANS

None

8. OTHER FIELD RECORDS (Sketch books, etc. DO NOT list data submitted to the Geodesy Division)

\* See field inspection report.

Sketchbook Vol. 1.



NOAA FORM 76-36D  
(3-72)

U. S. DEPARTMENT OF COMMERCE  
NATIONAL OCEANIC AND ATMOSPHERIC ADMINISTRATION

# RECORD OF SURVEY USE

TP-00156

## I. MANUSCRIPT COPIES

COMPILATION STAGES			DATE MANUSCRIPT FORWARDED	
DATA COMPILED	DATE	REMARKS	MARINE CHARTS	HYDRO SUPPORT
No map copies furnished for Nautical Chart use prior to final review.				

## II. LANDMARKS AND AIDS TO NAVIGATION

### 1. REPORTS TO MARINE CHART DIVISION, NAUTICAL DATA BRANCH

NUMBER	CHART LETTER NUMBER ASSIGNED	DATE FORWARDED	REMARKS
	1728 73	9/13/73	One report for TP-00156 B

2. ☒ REPORT TO MARINE CHART DIVISION, COAST PILOT BRANCH. DATE FORWARDED: 9/13/73  
 3. ☐ REPORT TO AERONAUTICAL CHART DIVISION, AERONAUTICAL DATA SECTION. DATE FORWARDED: \_\_\_\_\_

## III. FEDERAL RECORDS CENTER DATA

1. ☒ BRIDGING PHOTOGRAPHS; ☒ DUPLICATE BRIDGING REPORT; ☒ COMPUTER READOUTS.  
 2. ☒ CONTROL STATION IDENTIFICATION CARDS; ☒ FORM NOS 567 SUBMITTED BY FIELD PARTIES.  
 3. ☒ SOURCE DATA (except for Geographic Names Report) AS LISTED IN SECTION II, NOAA FORM 76-36C.  
 ACCOUNT FOR EXCEPTIONS:  
 4. ☐ DATA TO FEDERAL RECORDS CENTER. DATE FORWARDED: \_\_\_\_\_

## IV. SURVEY EDITIONS (This section shall be completed each time a new map edition is registered)

SECOND EDITION	SURVEY NUMBER TP - _____ (2)	JOB NUMBER PH - _____	TYPE OF SURVEY <input type="checkbox"/> REVISED <input type="checkbox"/> RESURVEY	
	DATE OF PHOTOGRAPHY	DATE OF FIELD EDIT	MAP CLASS <input type="checkbox"/> II. <input type="checkbox"/> III. <input type="checkbox"/> IV. <input type="checkbox"/> V. <input type="checkbox"/> FINAL	
THIRD EDITION	SURVEY NUMBER TP - _____ (3)	JOB NUMBER PH - _____	TYPE OF SURVEY <input type="checkbox"/> REVISED <input type="checkbox"/> RESURVEY	
	DATE OF PHOTOGRAPHY	DATE OF FIELD EDIT	MAP CLASS <input type="checkbox"/> II. <input type="checkbox"/> III. <input type="checkbox"/> IV. <input type="checkbox"/> V. <input type="checkbox"/> FINAL	
FOURTH EDITION	SURVEY NUMBER TP - _____ (4)	JOB NUMBER PH - _____	TYPE OF SURVEY <input type="checkbox"/> REVISED <input type="checkbox"/> RESURVEY	
	DATE OF PHOTOGRAPHY	DATE OF FIELD EDIT	MAP CLASS <input type="checkbox"/> II. <input type="checkbox"/> III. <input type="checkbox"/> IV. <input type="checkbox"/> V. <input type="checkbox"/> FINAL	

TP-00156  
Tide Data

<u>Tide Coordinated</u> <u>Infrared Photography</u>	<u>Tide Station(s) in operation</u> <u>at time of Photography</u>	<u>Stage of</u> <u>tide at</u> <u>time of</u> <u>photography</u>	<u>Mean</u> <u>Range of</u> <u>Tide</u>
Atlantic Coast			
70L7091R thru 7095R	Fort Pierce Inlet	+0.15MHW	1.84
70L6360R thru 6364R	Fort Pierce Inlet	-0.34MLW	1.84
Indian River			
70L8811R thru 8814R	Fort Pierce Indian River (West Coast)	-0.30MHW	1.23
70L7091R thru 7095R	Fort Pierce Indian River (East Coast)	+0.18MHW	1.23
70L8983R thru 8989R	Fort Pierce Indian River (West Coast)	+0.28MLW	1.23
70L9039R thru 9043R	Fort Pierce Indian River (East Coast)	+0.05MLW	1.23



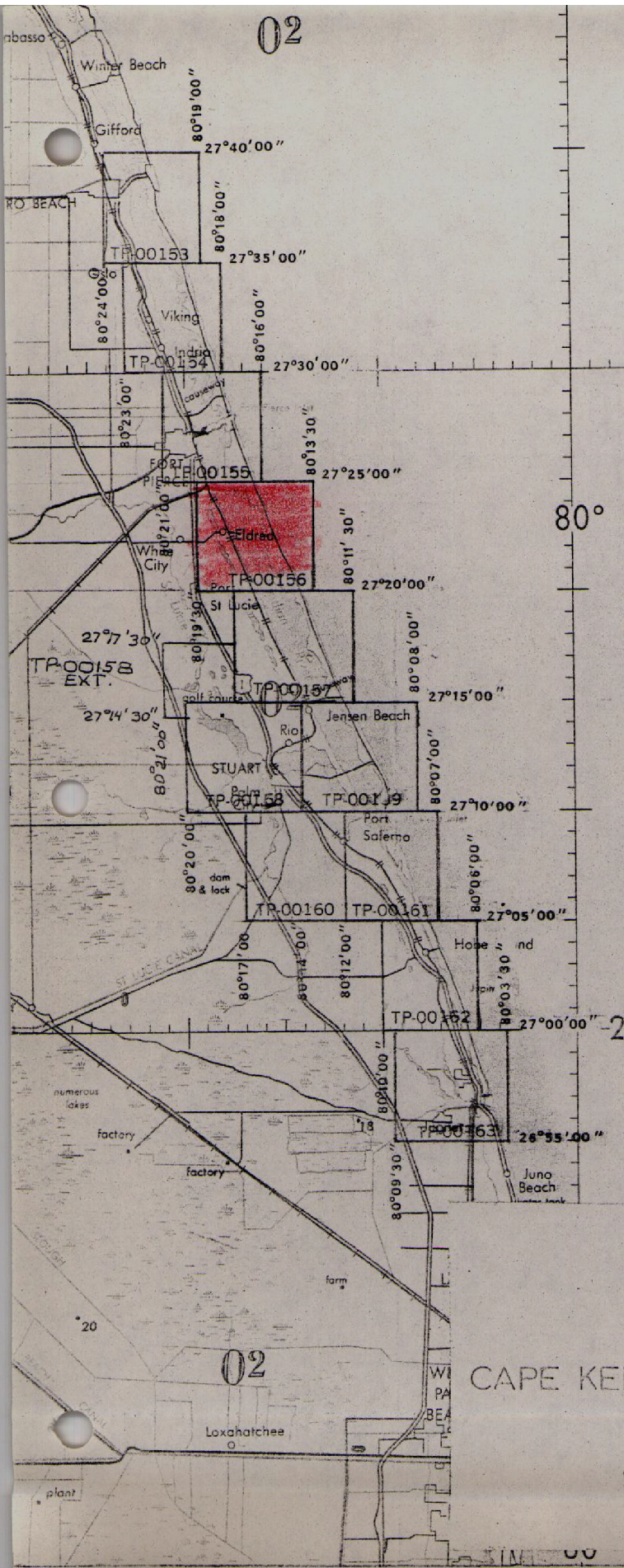

# Official Mileage for Cost Accounts

Sheet No. - Area Sq. Mi.

TP-00153	7
00154	6
00155	6
00156	7
00157	7
00158	13
00159	16
00160	1
00161	2
00162	4
00163	13

Total 82

Mullet Key water tank

Egmont Key

29° 32'45"

NAUTICAL MILES 5 0 0

STATUTE MILES 5 0 0

JOB PH-6910

PART 2

CAPE KENNEDY TO JUPITER INLET  
FLORIDA

SHORELINE MAPPING

SCALE 10,000



Record of Decisions  
TP-00156

The Record of Decisions was discontinued on June 17, 1975.  
Refer to Form 76-36B bound in this Descriptive Report for  
tidal datum information.



SUMMARY  
TP-00153 thru TP-00163

Coastal Zone Map TP-001 56 is one of eleven (11) similar maps in project PH-6910, Part 2. The layout of sheets (page 6 of this report) will show its location. These maps are intended for planning purposes by the State of Florida and for the compilation of NOS Nautical Charts.

The area is covered by aerial photography taken in 1970 on color and black and white infrared film. The infrared film was tide coordinated.

Field operations consisted of the establishment of tidal datums, control recovery, pre-marking of control, and field edit. Data for the compilation of tide stations and tidal bench marks were furnished by the Tidal Datum Planes Section. Condensed descriptions of both tidal and geodetic bench marks shown on this map were furnished by the Coastal Surveys Section.

Horizontal control was extended by analytical aerotriangulation methods using the stereo comparator. This provided control for the orthophot mosaic and compilation.

Shoreline and alongshore features were compiled from tide coordinated black and white infrared photography using a stereo plotter and graphic methods. The interior of the maps are depicted by an orthophoto mosaic.

All line work is scribed, approved symbols are shown in the marginal data.

Explanatory notes relating to datum determinations approved by a special ad hoc committee are shown on the reverse side of the maps.

All maps are published by the NOS and were printed in three colors by the Reproduction Division. A special registration copy was prepared to meet the requirements for Nautical Charts. This registration copy shows additional offshore details not shown on the published map and will be noted "Registration Copy" under the title block.

The following items will be registered in the Bureau Archives:

1. A plastic copy of the published map (1:10,000 scale).
2. A stable base positive of the registration copy (1:10,000 scale).
3. The Descriptive Report.

All negatives will be filed with the Reproduction Division.

All field data such as Forms 152, field edit photographs, profiles, field edit ozalids, etc., are filed in the Federal Records Center.



FIELD REPORT  
PREMARKING HORIZONTAL CONTROL  
JOB PH-6910, CAPE KENNEDY TO JUPITER INLET, FLORIDA

In accordance with Instructions - FIELD - Supplement I, Job PH-6910; Coastal Boundary Mapping, Cape Kennedy to Jupiter Inlet, Florida, twenty-two horizontal control stations were recovered and paneled in accordance with practices in use at this time. All stations were premarked for 1:40,000 scale photography.

White polyethylene plastic sheeting was used for all but 2 stations. Sketches on the CSI cards show the pattern used in each instance but most stations were paneled with a 5-ft. square target placed directly over the station mark and 3 runner-type wing panels 3.5/4' X 20' approximating 120° angles around the square.

TRIPOD 3, 1963 and WHITE 2, 1966 were premarked with black plastic, the center panel being 10' X 10' and the wing panels 8' X 20'. The ground surface at these 2 locations was considered too white for the white targets to be seen, hence the use of black material.

In addition to the sketches shown on the CSI cards the station locations have been spotted on USGS Quadrangle maps which are transmitted as part of the job data.

A recap, showing the stations as numbered on the job control diagram, the TP-map number and the quadrangle map on which it falls, follows:

STATION No.	NAME	MAP NO.	USGS QUADRANGLE
1	CENTRAL	1950 TP-00136	CAPE CANAVERAL
2	ARTESIA	1953 "	" "
3	POSE	1966 TP-00138	COCOA BEACH
4	MUNSON	1940 TP-00139	" "
5	PATRICK N. BASE	1960 TP-00140	" "
6	TRIPOD 3	1963 TP-00142	TROPIC
7	COLLEGE 2	1934 TP-00143	"
8	TURKEY CREEK	1934 TP-00144	MELBOURNE EAST
9	VALKARIA	1966 TP-00146	GRANT
10	SLIP 2	1934 TP-00149	SEBASTIAN NW
11	SEBASTIAN 2	1934 TP-00150	SEBASTIAN
12	SCORPION 2	1961 TP-00153	VERO BEACH
13	RIGMAR 2	1960 TP-00154	INDRIO
14	PIERCE 2	1963 TP-00155	FORT PIERCE
15	WHITE 2	1966 TP-00156	" "

STATION NO.	NAME		MAP NO.	USGS QUADRANGLE
16	WALTON	1930	TP-00157	ANKONA
17	REFUGE 2 RM # 4	1967	TP-00160	ST. LUCIE INLET
18	SEWALL	1934	TP-00159	" " "
19	PINE	1929	TP-00162	GOMEZ
20	CISTERN	1956	TP-00163	HOBE SOUND
21	RADAR	1954	TP-00164	JUPITER
22	GOLF RM # 1	1934	South of TP-00164	RIVIERA BEACH

Targets were visited after photography and found to be in good condition. No center panels were damaged except GOLF RM 1 and it was only slightly torn on its north edge. Images of all targets should be visible on the photographs.

Submitted 2/24/70

*William H. Shearouse*  
 William H. Shearouse  
 Chief, Photo Party 60



PHOTOGRAMMETRIC PLOT REPORT  
Cape Kennedy to Jupiter Inlet, Florida (Part 2)  
Job PH-6910  
August 1971

21. Area Covered

This report covers the area south from an area about eight miles north of Fort Pierce Inlet to Jupiter Inlet. The job consists of eleven (11) 1:10,000 scale sheets, TP-00153 thru TP-00163.

22. Method

Two (2) strips of photographs (Nos. 27 and 28) were bridged using analytical aerotriangulation methods. Ties were made between the two strips and with a previous bridge (strip 26) from Part 1 of this project. Image points were located to rectify photographs for mosaics and to ratio infrared photography. Additional points were located for the construction of mosaic type nautical and small craft charts. The final positions of points for the two strips of photographs were determined by a 35-photo block adjustment. Closures to control have been noted on the read-outs. The attached sketch of the strips bridged shows the placement of the control used in the block adjustment. All bridge points have been plotted by the Coradimat on the Florida East Zone plane coordinate system.

23. Adequacy of Control

Horizontal control was premarked and was adequate for bridging.

24. Supplemental Data

None

25. Photography

The following 1:40,000 scale, RC-8, color photography was used in bridging:

Strip 27	70-E(C)-5861 thru 5886
Strip 28	70-E(C)-5850 thru 5858

The definition and quality of the photography was good.

Respectfully submitted,



Donald M. Brant

Approved and Forwarded:

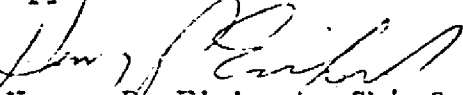

Henry P. Eichert, Chief  
Aerotriangulation Section



## 13

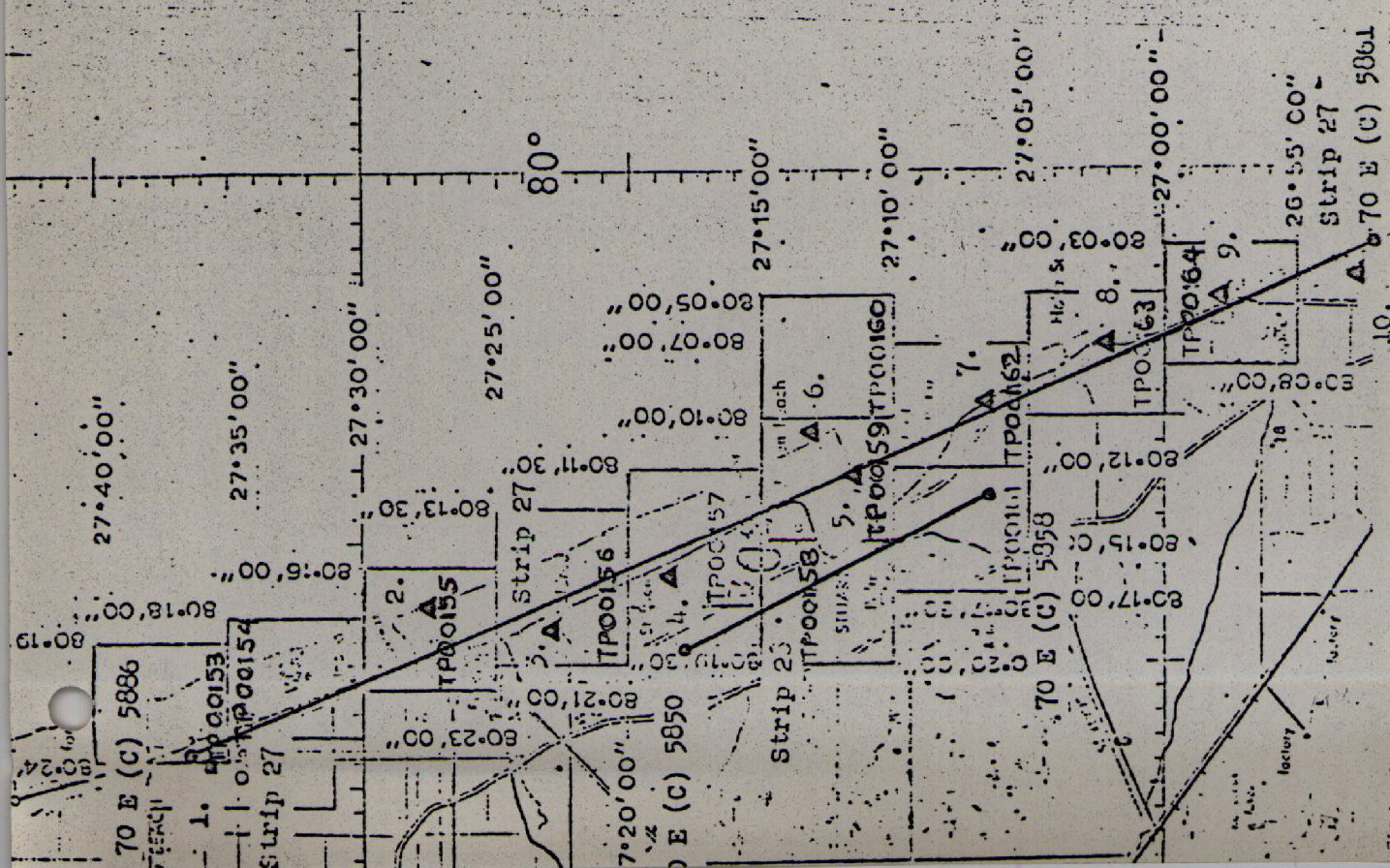



## Horizontal Control

Map TP- 00156

Station	NOS Geodetic Data Reference for Description, Positions, Coordinates and Azimuths
DRAIN 2, 1934	Book 421, P. 1, 37, 46 G.P.-Fla. Vol. 1, P. 157, P.C. Fla. E Zone, P. 20
EHRHART, 1930	Book 421, P. 1, 43 G.P.-Fla. Vol. 1, P. 716, P.C. Fla. E Zone, P. 161
WHITE 2, 1966	Fla. Vol. II, P. 609



# FLORIDA--NOAA Coastal Boundary Mapping Program

Vertical Control--Geodetic

Map TP-- 00156

15

Geodetic Bench Mark	Elevations (feet)	Condensed Description
	NGVD 1929	
Q 231	23.917	C&GS disk stamped Q 231-1965; 28.5 ft. E of E rail, 13.5 ft. S centerline of old road, 16 ft. W of 12-inch scrub pine tree, 1.7 ft. N of metal witness post.
A 34	38.166	C&GS disk stamped A 34 1933; 38.041; 18.9 ft. E of E rail, 192 ft. N of semaphore No. 2485.
DRAIN 2	2.982	C&GS disk stamped DRAIN 2 1934 1947; approx. 60 yds. W of ocean beach, 132 ft. W road centerline, 33.5 ft. S of E-W sand road centerline.
D 225	30.148	C&GS disk stamped D 225 1964; 28.9 ft. E or E rail, 2 ft. S of telegraph pole, 1.2 ft. N of metal witness post.
F 225	33.740	C&GS disk stamped F 225 1964; 43.5 ft. W of W rail, 3 ft. S of "Cable Warning Sign" in line with a barrier of railroad ties projecting approx. 1 ft. above the level of the ground.
N 231	31.024	C&GS disk stamped N 231 1965; 26 ft. N centerline gravel road, 55.5 ft. W of W rail, 7.5 ft. NE of power pole, 1.8 ft. S of metal witness post.
P 231	35.089	C&GS disk stamped P 231 1965; 30.2 ft. E or E rail, 9 ft. N road centerline, 1.5 ft. S of metal witness post, in rear and at tracks of house No. 3553 So. Indian River Drive.
H 236	31.850	C&GS disk stamped H 236 1965; 45.3 ft. W or W rail, 1.5 ft. N of power pole, 1.4 ft. S of metal witness post.
K 307	3.419	C&GS disk stamped K 307-1970; 45 ft. E centerline ALA, 66 ft. S road centerline, 0.5 ft. W of metal witness post.
T 307 (SRD)	12.549	F.S.R.D. disk stamped T 307; set on top of W end of N abutment of concrete bridge, 23 ft. W centerline ALA.
U 307 (SRD)	12.608	F.S.R.D. disk stamped U 307; set on top of W end of N abutment of concrete bridge, 23 ft. W centerline ALA.

Geodetic Bench Mark	Elevations (feet)	Condensed Description
	NGVD 1929	
V 307 (SRD)	12.503	F.S.R.D. disk stamped V 307; set on top of W end of N abutment of concrete bridge, 23 ft. W centerline ALA.
A 308	3.176	C&GS disk stamped A 308 1970; set on top of S end of E concrete head-wall, 39 ft. E centerline ALA.
C 308	4.987	C&GS disk stamped C 308 1970; 49.5 ft. E centerline ALA, 1.5 ft. S of metal witness post.

Compilation Report  
TP-00156

31. Delineation

The shoreline and offshore features were compiled by graphic methods from office interpreted, tide-coordinated infrared photography. Color bridging photography was used as an aid in interpreting culture features. The limits of shallow and shoal areas for nautical charts were compiled from the color photography.

Control for graphic compilation consisted of planimetric features and map points compiled from the rectified color photography.

Interior features are shown by an orthophoto mosaic constructed with rectified black and white prints of the color photography.

32. Horizontal Control

Refer to the photogrammetric plot report bound with this Descriptive Report.

33. Supplemental Data None.

34. Contours and Drainage

Contours are inapplicable. Drainage is depicted by the orthophoto mosaic.

35. Shoreline and Alongshore Details

The infrared photography was adequate for the delineation of the shoreline, except along the Atlantic Coast where extensive surf made the interpretation of the photographs for the mean low-water line questionable. Foreshore profiles are requested to aid in the interpretation of the photography.

36. Offshore Details

No unusual problems were encountered.

37. Landmarks and Aids to Navigation

Light 197 was located by photogrammetric methods and will be verified by the field editor. The other aids will be located by field methods.

38. Control for Future Surveys

No tidal bench marks were established for Ankona Tide Station.



39. Junctions

Refer to form 76-36b (page 2 of the Descriptive Report).

40. Horizontal Accuracy

This map complies with the accuracy requirements for the Florida Coastal Zone Mapping Program as outlined by project instructions, PH-7000.

41.. thru 45. Inapplicable.

46. Comparison with Existing Maps

USGS Quad Fort Pierce, 1:24,000, 1949, photorevised 1970.  
USGS Quad Ankona, 1:24,000, 1948, photorevised 1970.  
USGS Quad, Eden, 1:24,000, 1948, photorevised 1970.

47. Comparison with Nautical Charts

845-SC, 10th edition, August 7, 1971

No significant differences were noted.

Items to be Applied to Nautical Charts Immediately: None.

Items to be Carried Forward: None.

Respectfully submitted,

  
P. J. Dempsey

Approved and forwarded:

  
J.P. Battley, Jr.

Field Edit Report, Map TP-00156, Job PH-691051. Methods

The Atlantic Ocean shoreline was verified visually from roads leading to the shore or by walking where necessary. Three profiles were obtained along this shoreline using Ft. Pierce South Jetty gage. ~~The Indian River shoreline was verified visually from a skiff while cruising and polling just offshore. Four profiles were obtained on the west side of the river. Ankona gage was used as the base for these river profiles.~~ The east side is mostly apparent with Mg. trees and no profiles were taken. Notes regarding apparent and fast shoreline, piers and other structures were made on the rectified photographs with cross referenced to H.W. and L.W. photographs for clarification. Some new piers, piling were located by sextant fixes and are recorded in Sketchbook.

*Refer to  
Page 20*

No landmarks were submitted.

Form 76-40 is submitted for nonfloating aids. The aids were located by sextant and are recorded in Sketchbook.

Bench marks were searched for and reported on Form 685A. The identified bench marks are on the rectified photographs and HW & LW photographs.

All known triangulation stations were searched for and reported on Form 526.

State highway numbers were obtained during the course of travel and are shown on the photographs.

Field edit notes will be found on the Discrepancy Print, Field Edit Sheet and photographs.

52. ADEQUACY OF COMPILATION

Adequate with application of field edit information.

53. MAP ACCURACY

No tests were required.

54. RECOMMENDATIONS

None.

55. EXAMINATION OF PROOF COPY

Not required.

56. GEOGRAPHIC NAMES

No investigation required.

Submitted 1/29/73

*Robert R. Wagner*  
Robert R. Wagner  
Chief, Photo Party 60

Remarks: The application of Field Edit, TP-00156

As mentioned in the compilation report (item 35), it was difficult to interpret the MHWL and MLWL on the Atlantic Coast due to heavy surf on the tide-coordinated infrared photography. The mean low-water line was not interpreted pending the three requested beach profiles. Upon receipt of the field edit, the profiles were plotted on the infrared high and low water photography for analysis. This confirmed the line photo-interpreted as the mean high-water line and verified the line which was apparent on the low water photography as the dividing line between wet sand and surf.

The four profiles mentioned in the field edit report for the west shore of the Indian River were not requested, nor were they received in this Office.

Submitted by,

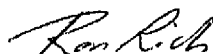

Ron Rich



Review Report  
Coastal Zone Map TP-00156  
December 1973

61. General

The following major parts of this map have been examined prior to its publication by the Quality Control Group and are adequate:

1. Field operations
2. Extension of control
3. Compilation

The map was reviewed in its Class I stage (field edit applied). The review consisted of an examination of (1) the manuscript; (2) the infrared photography; (3) the application of field edit; (4) the reproduction plates and (5) the descriptive report.

A proof copy of this map was edited by the Quality Control Group prior to printing and distribution. This edit comprised of a careful inspection of map details to verify the accuracy of reproduction with reference to the map manuscript and the quality of reproduction.

62. Registration Copy

The special Registration Copy of this map was prepared and checked by the Coastal Mapping Section. This Registration Copy shows "shallow" and "shoal" areas for Marine Chart use that are not shown on the published map. The interpretation of the infrared photography indicates that some of these areas uncover at low water. In this case, the areas are labeled "tint" which means that if used for nautical charts they will be shown with a "green tint" without any outline. Two such areas are shown on the Registration Copy for TP-00156.

63. thru 64. Inapplicable.

65. Cartographic Comparisons

Comparison was made with this map and the following USGS quadrangles and Nautical Chart:

Fort Pierce, 1:24,000 scale, 1949, photorevised 1970  
Ankona, 1:24,000 scale, 1948, photorevised 1970  
Eden, 1:24,000 scale, 1948, photorevised 1970

Nautical Chart 845-SC, 11th Edition, dated July 15, 1972

No significant differences were noted in making the comparisons.

66. Adequacy of Results and Future Surveys

This map complies with the project instructions for NOS Cooperative Coastal Boundary Mapping, Job PH-7000. This map meets the National Map Accuracy Standards.

Submitted by,

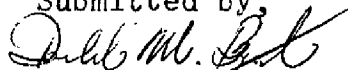

Donald M. Brant

Approved:

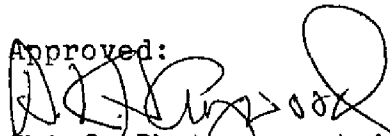

Chief, Photogrammetric Branch



Chief, Coastal Mapping Division



July 11, 1974

GEOGRAPHIC NAMES  
FINAL NAMES SHEET  
PH-6910 (Florida)

TP-00156

Ankona  
Atlantic Ocean  
Big Mud Creek  
Blind Creek  
Collins Park Estates  
Herman Bay  
Herman Bay Pt.  
Hutchinson Island  
Indian River  
Little Mud Creek  
Middle Cove  
Middle Point  
Florida East Coast R.R.  
The Savannahs  
White City  
White City Station

Prepared by:

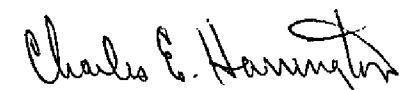
  
Charles E. Harrington  
Staff Geographer

NOAA FORM 76-40 (2-71)		U.S. DEPARTMENT OF COMMERCE-NATIONAL OCEANIC AND ATMOSPHERIC ADMINISTRATION		NONFLOATING AIDS OR LANDMARKS FOR CHARTS		ORIGINATING ACTIVITY	
PRESCRIBED BY PHOTOGRAMMETRY INSTRUCTION NO. 64.		DATE		FIELD INSPECTION		FIELD EDIT	
TO BE CHARTED TO BE DELETED		DATE		FIELD INSPECTION		FIELD EDIT	
The following objects have (have not) been inspected from seaward to determine their value as landmarks:		DATE		FIELD INSPECTION		FIELD EDIT	
JOB NUMBER PH-6910		SURVEY NUMBER T-TP-00156		METHOD AND DATE OF LOCATION (See instructions on reverse of this form)		CHARTS AFFECTED	
STATE: Florida		N.A. 1927		FIELD INSPECTION		FIELD EDIT	
ORIGINATING LOCATION Rockville, Maryland		POSITION		FIELD INSPECTION		FIELD EDIT	
LATITUDE		LONGITUDE		FIELD INSPECTION		FIELD EDIT	
D.M. METERS		D.M. METERS		FIELD INSPECTION		FIELD EDIT	
D.M. METERS		D.M. METERS		FIELD INSPECTION		FIELD EDIT	
CHARTING NAME	DESCRIPTION	DATUM	POSITION	LATITUDE	LONGITUDE	FIELD INSPECTION	FIELD EDIT
	EAU GALLIE-ST. LUCIE INLET-INDIAN RIVER (SOUTH SECTION)	N.A. 1927					
DYBN 194		27 24	35.77 80 17	54.28		P.4	845-SC
DYBN 195		27 24	12.49 80 17	42.04		P.4	"
DYBN 196		27 23	46.49 80 17	33.23		P.4	"
LIGHT 197		27 23	22.26 80 17	20.47		P.4 Verif.	"
DYBN 198		27 22	56.61 80 17	12.92		P.4	"
DYBN 199		27 22	32.08 80 16	59.08		P.4	"
DYBN 200		27 22	07.06 80 16	51.11		P.4	"
DYBN 201		27 21	43.36 80 16	37.86		P.4	"
DYBN 202	NOTE: LIGHT NOT IN PLACE. ON 1/18/73	27 21	17.76 80 16	29.71		P.4	"
			546.7	816.5		12/6/72	24

RESPONSIBLE PERSONNEL		TITLE	
TYPE OF ACTION	NAME		
1. Objects inspected from seaward		<input type="checkbox"/> FIELD INSPECTOR	<input type="checkbox"/> FIELD EDITOR
2. Positions determined and/or verified	R. Warner	FIELD INSPECTOR	
	#See below	FIELD EDITOR	
3. Forms originated by Quality Control and Review Group and final review activities		COMPILER	REVIEWER QUALITY CONTROL AND REVIEW GROUP REPRESENTATIVE

### INSTRUCTIONS FOR 'METHOD AND DATE OF LOCATION' SECTION

NOTE: 'Photogrammetric Positions' are dependent entirely, or in part, upon control established by photogrammetric methods. 'Field Positions' are determined by field observations based entirely upon ground control.

### COLUMN TITLE

### COMPILATION

Applicable to office identified and located objects only. Enter the number and date of the photograph used to identify the object.

### TYPE OF ENTRIES

### FIELD INSPECTION

AND

### FIELD EDIT

1. New Position Determined—Enter the applicable data by symbols as indicated below:

F — Field

P — Photogrammetric

EXAMPLES:

NOTE: Positions scaled in

1. Triangulation

1. Field identified

Compilation Section and

2. Traverse

2. Theodolite

F. 3.c

entered on Form 76040, submitted by field editor.

3. Intersection

3. Planetable

Forms 4. Resection

4. Sextant

P. 2

typed for submission to

a. Theodolite

Marine Chart Division. Trans-

b. Planetable

ferred data checked after typing

c. Sextant

in Quality Control Group.

Immediately beneath the data described above, enter the following:

a. For 'Field Positions' enter the date of location.

b. For 'Photogrammetric Positions' enter the date of field work; and, if a photograph

was used in locating the object or the object was identified on a photograph, enter the number of the photograph used.

2. Triangulation Station Recovered — Enter 'Triang. Rec. mo/day/yr.'

3. Position Verified — Enter 'Verif. mo/day/yr.'

\* U.S. GOVERNMENT PRINTING OFFICE: 1971-769374/445 REC.#6

U.S. DEPARTMENT OF COMMERCE-NATIONAL OCEANIC AND ATMOSPHERIC ADMINISTRATION									
NONFLOATING AIDS OR LANDMARKS FOR CHARTS									
TO BE CHARTED <input checked="" type="checkbox"/> TO BE DELETED		ORIGINATING LOCATION		DATE		ORIGINATING ACTIVITY			
		Rockville, Maryland		Aug. 10, '73		<input type="checkbox"/> FIELD INSPECTION <input type="checkbox"/> FIELD EDIT <input type="checkbox"/> COMPILATION <input type="checkbox"/> FINAL REVIEW <input checked="" type="checkbox"/> QUALITY CONTROL AND REVIEW (See reverse for responsible personnel)			
JOB NUMBER PH-6910		SURVEY NUMBER T-TP-00156		DATUM N.A. 1927		METHOD AND DATE OF LOCATION (See instructions on reverse of this form)			
STATE: Florida		POSITION		LATITUDE		LONGITUDE		CHARTS AFFECTED	
CHARTING NAME		DESCRIPTION		0 /		0 /		FIELD INSPECTION	
				D.M. METERS		D.M. METERS		FIELD EDIT	
DYBN 203	EAU GALLIE-ST. LUCIE INLET - INDIAN RIVER (SOUTH SECTION)	27 21	19.06	80 16	27.25			P.4 1/18/73	845-SC
DYBN 205		27 20	586.5	80 16	749.0			P.4 12/6/72	"
DYBN 206		27 20	54.86	80 16	14.09			P.4 12/6/72	"
DYBN 207		27 20	1688.5	80 15	387.3			P.4 1/18/73	"
DYBN 1	FPL BARGE CHANNEL (PRIVATE)	27 21	30.52	80 16	04.04			P.4 12/6/72	"
DYBN 2		27 21	939.5	80 15	111.0			P.4 12/6/72	"
DYBN 3		27 21	06.95	80 15	48.21			P.4 12/6/72	"
DYBN 4		27 21	214.0	80 15	1325.0			P.4 12/6/72	"
DYBN 5		27 21	05.22	80 16	18.45			P.4 12/6/72	"
		27 21	160.8	80 16	507.0			P.4 12/6/72	"
		27 21	02.29	80 16	05.95			P.4 12/6/72	"
		27 21	070.5	80 15	163.6			P.4 12/6/72	"
		27 21	03.82	80 15	52.49			P.4 12/6/72	"
		27 21	117.5	80 15	1442.5			P.4 12/6/72	"
		27 21	0.86	80 15	39.72			P.4 12/6/72	"
		27 21	026.5	80 15	1091.5			P.4 12/6/72	"
		27 21	02.53	80 15	27.82			P.4 12/6/72	"
		27 21	078.0	80 15	764.5			P.4 12/6/72	"



TYPE OF ACTION	NAME	TITLE
1. Objects inspected from seaward		<input type="checkbox"/> FIELD INSPECTOR <input type="checkbox"/> FIELD EDITOR
2. Positions determined and/or verified		FIELD INSPECTOR
	R. Warner	FIELD EDITOR
	# See below	COMPILER
3. Forms originated by Quality Control and Review Group and final review activities		<input type="checkbox"/> REVIEWER <input type="checkbox"/> QUALITY CONTROL AND REVIEW GROUP REPRESENTATIVE

INSTRUCTIONS FOR 'METHOD AND DATE OF LOCATION' SECTION

NOTE: 'Photogrammetric Positions' are dependent entirely, or in part, upon control established by photogrammetric methods. 'Field Positions' are determined by field observations based entirely upon ground control.

COLUMN TITLE

TYPE OF ENTRIES

COMPILATION

Applicable to office identified and located objects only. Enter the number and date of the photograph used to identify the object.

FIELD INSPECTION

1. New Position Determined - Enter the applicable data by symbols as indicated below:

AND

FIELD EDIT

F - Field

P - Photogrammetric

EXAMPLES:

NOTE: Positions scaled in Compilation Section and entered on Form 76040, submitted by field editor, typed for submission to Marine Chart Division. Transferred data checked after typing in Quality Control Group.

- |                  |                     |        |
|------------------|---------------------|--------|
| 1. Triangulation | 1. Field identified | F. 3.c |
| 2. Traverse      | 2. Theodolite       |        |
| 3. Intersection  | 3. Planetable       |        |
| 4. Resection     | 4. Sextant          | P. 2   |
| a. Theodolite    |                     |        |
| b. Planetable    |                     |        |
| c. Sextant       |                     |        |

Immediately beneath the data described above, enter the following:

- For 'Field Positions' enter the date of location.
- For 'Photogrammetric Positions' enter the date of field work; and, if a photograph was used in locating the object or the object was identified on a photograph, enter the number of the photograph used.

2. Triangulation Station Recovered - Enter 'Triang. Rec. mo/day/yr.'

3. Position Verified - Enter 'Verif. mo/day/yr.'

\* U.S. GOVERNMENT PRINTING OFFICE: 1971-769374/445 REG. #6

T-00156  
Federal Records Center Data

1 Field Edit sheet  
1 Discrepancy Print  
1 Form 76-36c(History of Field Operations)  
2 Forms 76-40 (Aids to Navigation)  
1 Profile Sheet  
Photographs: (Field Edit Notes)  
70E5877 thru 5880  
70L6362R and 6364R  
70L8811R and 8813R

1 Sketch book (Sextant fixes for TP-00156)