

12812

12812

FORM C&GS-504  U.S. DEPARTMENT OF COMMERCE ENVIRONMENTAL SCIENCE SERVICES ADMINISTRATION COAST AND GEODETIC SURVEY	
<h2>DESCRIPTIVE REPORT</h2>	
<i>Type of Survey</i> Shoreline (Photogrammetric)	
<i>Field No.</i> .....	<i>Office No.</i> T-12812
<b>LOCALITY</b>	
<i>State</i> Alaska	
<i>General locality</i> Keku Strait	
<i>Locality</i> N. W. of the Summit	
<hr/> 1961-1969 <hr/>	
<b>CHIEF OF PARTY</b> Alfred C. Holmes Director, Atlantic Marine Center	
<b>LIBRARY &amp; ARCHIVES</b>	
DATE .....	

MAP NOT INSPECTED IN QUALITY CONTROL PRIOR  
TO REGISTRATION

DESCRIPTIVE REPORT - DATA RECORD

T- 12812

PROJECT NO. (II): PH-6206		
FIELD OFFICE (III): None		CHIEF OF PARTY
PHOTOGRAMMETRIC OFFICE (III): Atlantic Marine Center, Norfolk, Virginia		OFFICER-IN-CHARGE Alfred C. Holmes, Director
INSTRUCTIONS DATED (II) (III): OFFICE INSTRUCTIONS            January 18, 1965 OFFICE SUPPLEMENT III        December 19, 1967 OFFICE SUPPLEMENT IV        April 14, 1970 FIELD INSTRUCTIONS            February 11, 1969		
METHOD OF COMPILATION (III): Wild B-8 and Graphic		
MANUSCRIPT SCALE (III): 1:5,000		STEREOSCOPIC PLOTTING INSTRUMENT SCALE (III): 1:7,500 Pantographed to 1:5,000
DATE RECEIVED IN WASHINGTON OFFICE (IV):		DATE REPORTED TO NAUTICAL CHART BRANCH (IV):
APPLIED TO CHART NO.	DATE:	DATE REGISTERED (IV): Sept. 4, 1975
GEOGRAPHIC DATUM (III): N.A. 1927		VERTICAL DATUM (III): <del>MEAN SEA LEVEL</del> High Water MEAN SEA LEVEL EXCEPT AS FOLLOWS: Elevations shown as (25) refer to mean high water Elevations shown as (5) refer to sounding datum i.e., mean-low-water or mean lower low water
REFERENCE STATION (III): HAY 1927		
LAT.: 56°42'53.324"(1649.4m)	LONG.: 133°45'21.423"(364.4m)	<input checked="" type="checkbox"/> ADJUSTED <input type="checkbox"/> UNADJUSTED
PLANE COORDINATES (IV): 1,783,026.93 ft.      x = 2,667,706.33 ft.		STATE: Alaska      ZONE: 1
ROMAN NUMERALS INDICATE WHETHER THE ITEM IS TO BE ENTERED BY (II) FIELD PARTY, (III) PHOTOGRAMMETRIC OFFICE, OR (IV) WASHINGTON OFFICE. WHEN ENTERING NAMES OF PERSONNEL ON THIS RECORD GIVE THE SURNAME AND INITIALS, NOT INITIALS ONLY.		

DESCRIPTIVE REPORT - DATA RECORD

T-12812

FIELD INSPECTION BY (II):  None		DATE:
MEAN HIGH WATER LOCATION (III) (STATE DATE AND METHOD OF LOCATION):  AIR PHOTO COMPILATION DATE OF PHOTOGRAPHY: June 16, 1964		
PROJECTION AND GRIDS RULED BY (IV):  L. F. Van Scoy		DATE Sept. 19, 1967
PROJECTION AND GRIDS CHECKED BY (IV):  R. Glaser		DATE Sept. 20, 1967
CONTROL PLOTTED BY (III): L. O. Neterer		DATE Nov. 16, 1967
CONTROL CHECKED BY (III):  L. Barge		DATE Nov. 16, 1967
RADIAL PLOT OR STEREOSCOPIC CONTROL EXTENSION BY (III):  W. Heinbaugh WSC		DATE
STEREOSCOPIC INSTRUMENT COMPILATION (III):	PLANIMETRY Richard Minton Reviewed: L. O. Neterer	DATE June 5, 1968 June 13, 1968
	CONTOURS  Not Applicable	DATE
MANUSCRIPT DELINEATED BY (III):  Richard Minton		DATE May 15, 1968
SCRIBING BY (III): F. P. Margiotta		DATE Jan. 26, 1972
PHOTOGRAMMETRIC OFFICE REVIEW BY (III): Compilation: L. L. Graves		DATE July 3, 1968

REMARKS:



DESCRIPTIVE REPORT - DATA RECORD

T-12812

ERA (KIND OR SOURCE) (III):

Wild RC-8 "W"

PHOTOGRAPHS (III)

NUMBER	DATE	TIME	SCALE	STAGE OF TIDE
64-W(c)-1142 thru 1144	16 June 1964	10:44 <i>PST</i>	1:15,000	5.2 ft. Above MLLW
61W9427 and 9426	16 July 1961	09:02 PST	1:20,000	1.2 ft. Above MLLW

Predicted TIDE (III)

Diurnal

		RATIO OF RANGES	MEAN RANGE	SPRING RANGE
REFERENCE STATION:	Ketchikan, Alaska		13.0	15.4
SUBORDINATE STATION:	The Summit, Keku Strait		13.2	15.7
SUBORDINATE STATION:				
WASHINGTON OFFICE REVIEW BY (IV): Leo F. Beugnet, AMC		DATE: May 1972		
PROOF EDIT BY (IV):		DATE:		
NUMBER OF TRIANGULATION STATIONS SEARCHED FOR (II): 1	RECOVERED: 1	IDENTIFIED: 1		
NUMBER OF BM(S) SEARCHED FOR (III): None	RECOVERED: None	IDENTIFIED: None		
NUMBER OF RECOVERABLE PHOTO STATIONS ESTABLISHED (III): None				
NUMBER OF TEMPORARY PHOTO HYDRO STATIONS ESTABLISHED (III): None				

REMARKS:

T-12812

COMPILATION RECORD	COMPLETION DATE	REMARKS
Compilation Complete pending field edit	June 5, 1968	Superseded
Field Edit applied	Dec. 2, 1969	
Final Review	May 1972	

SHORELINE MAPPING PROJECT

Ph-6206

KEKU STRAITS, ALASKA

SCALE 1:10,000

5

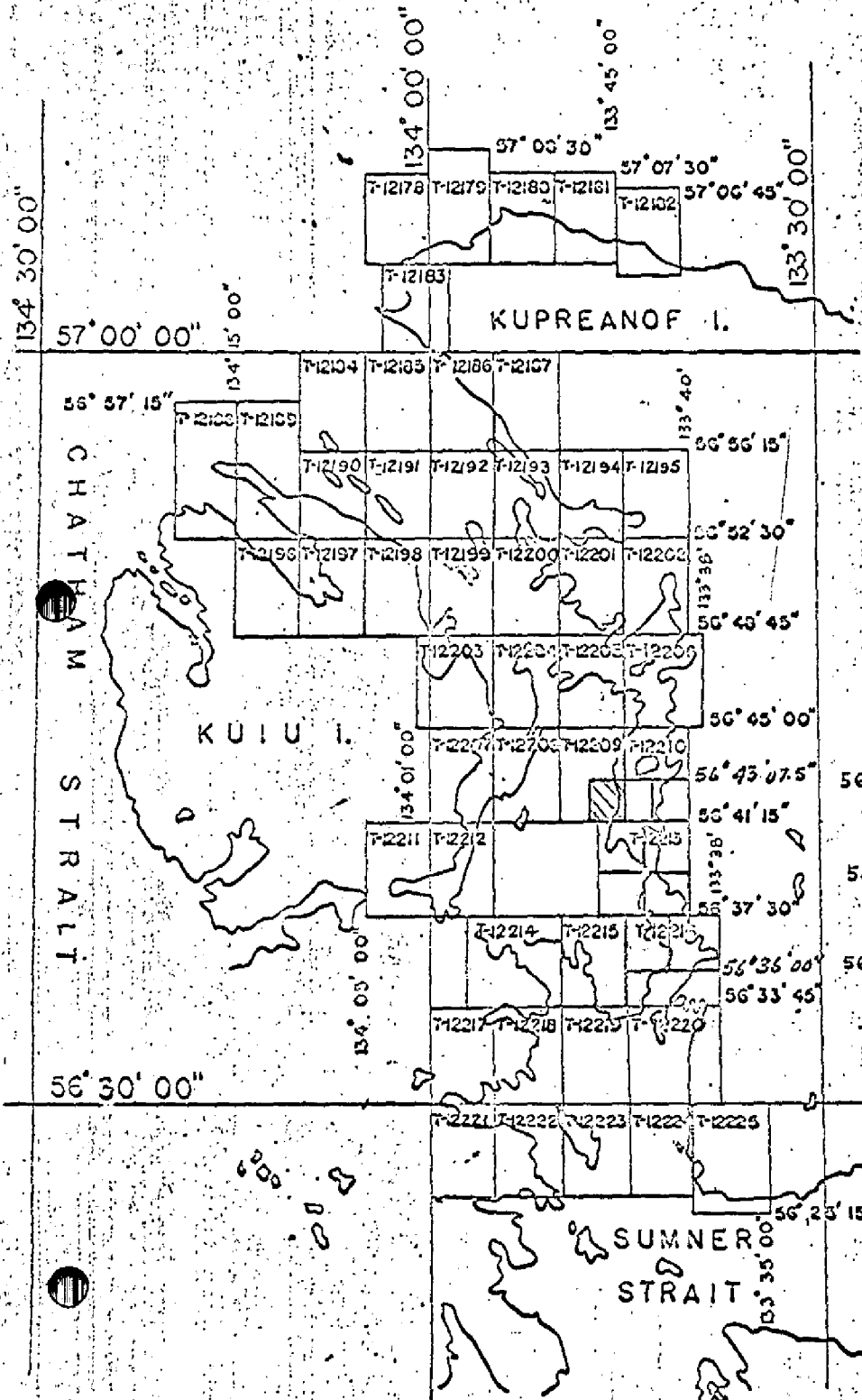

AN ENLARGED  
DIAGRAM OF THE  
1:5,000 SCALE SHEETS

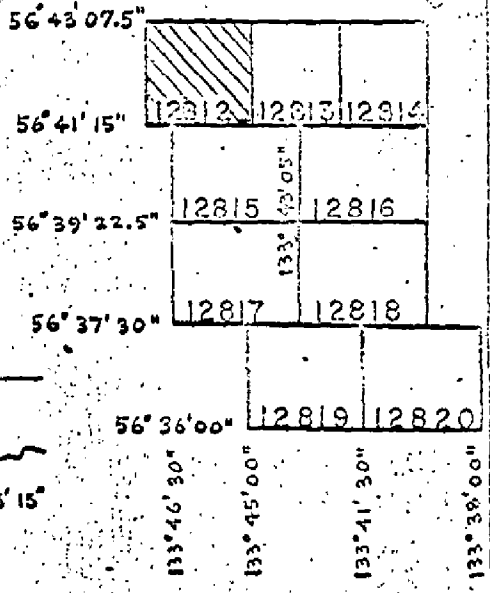

REV. 9-65 R.G.  
REVISED 1-6-65

A.R.

SUMMARY TO ACCOMPANY  
DESCRIPTIVE REPORT T-12812

Shoreline survey T-12812 is one of 53 similar surveys in project PH-6206. The primary purpose of the surveys was to provide modern shoreline for nautical charts and photo-hydro support data for hydrographic surveys to be made in the area.

This survey covers a part of the western shore of Kuiu Island bordering Keku Strait. See page 5 of the descriptive report for the area within the project.

There was no field work prior to compilation with the exception of identification of horizontal control for aerotriangulation. The survey was subsequently field edited during the 1969 field season.

Compilation was at 1:5,000 scale using the photography of July 1961 and June 1964. Film positives, ozalids and specially prepared photographs were furnished for transfer of the shoreline to the boat sheet, photo-hydro support and field edit use.

The manuscript was a vinylite sheet 1 minute 52.5 seconds in latitude by 2 minutes 30 seconds in longitude. After application of field edit data the survey was scribed and reproduced on cronaflex. Final review was in the Atlantic Marine Center in May 1972. One cronaflex positive and a negative of the final reviewed survey are forwarded for record and registry.



FIELD INSPECTION REPORT

PROJECT PH 6206

T-12812

There was no field inspection prior to compilation.

AEROTRIANGULATION REPORT  
Keku Straits, Alaska  
Job PH-6206

21. Area Covered

This report pertains to that portion of Keku Straits between 56° 33' 45" and 56° 45' 00".

22. Method

Two strips of photography were bridged using stereoplani-graph and emulsion-drilled diapositives. Measurements made by the stereoscopic instruments were adjusted using 1620 IBM programs.

23. Adequacy of Control

Number and location of field-identified horizontal control stations were adequate to control the bridges with sufficient accuracy to comply with National Standards of Map Accuracy. Station LO 1927 did not hold in the adjustment but closer investigation revealed that an apparent transposition of distances to the substitute stations had occurred. After re-computing the positions all control held satisfactorily.

24. Supplemental Data

U.S.G.S. quadrangles, Petersburg (C-5 and C-6), Alaska, scale 1:63,360, 1948 edition, were used to determine elevations to provide vertical control where required.

25. Photography

Photography was adequate for coverage, definition and endlap.

Respectfully submitted:

*W. Heinbaugh*  
W. Heinbaugh

Approved by:

*John D. Perrow Jr.*

# KEKU STRAITS, ALASKA PH - 6206

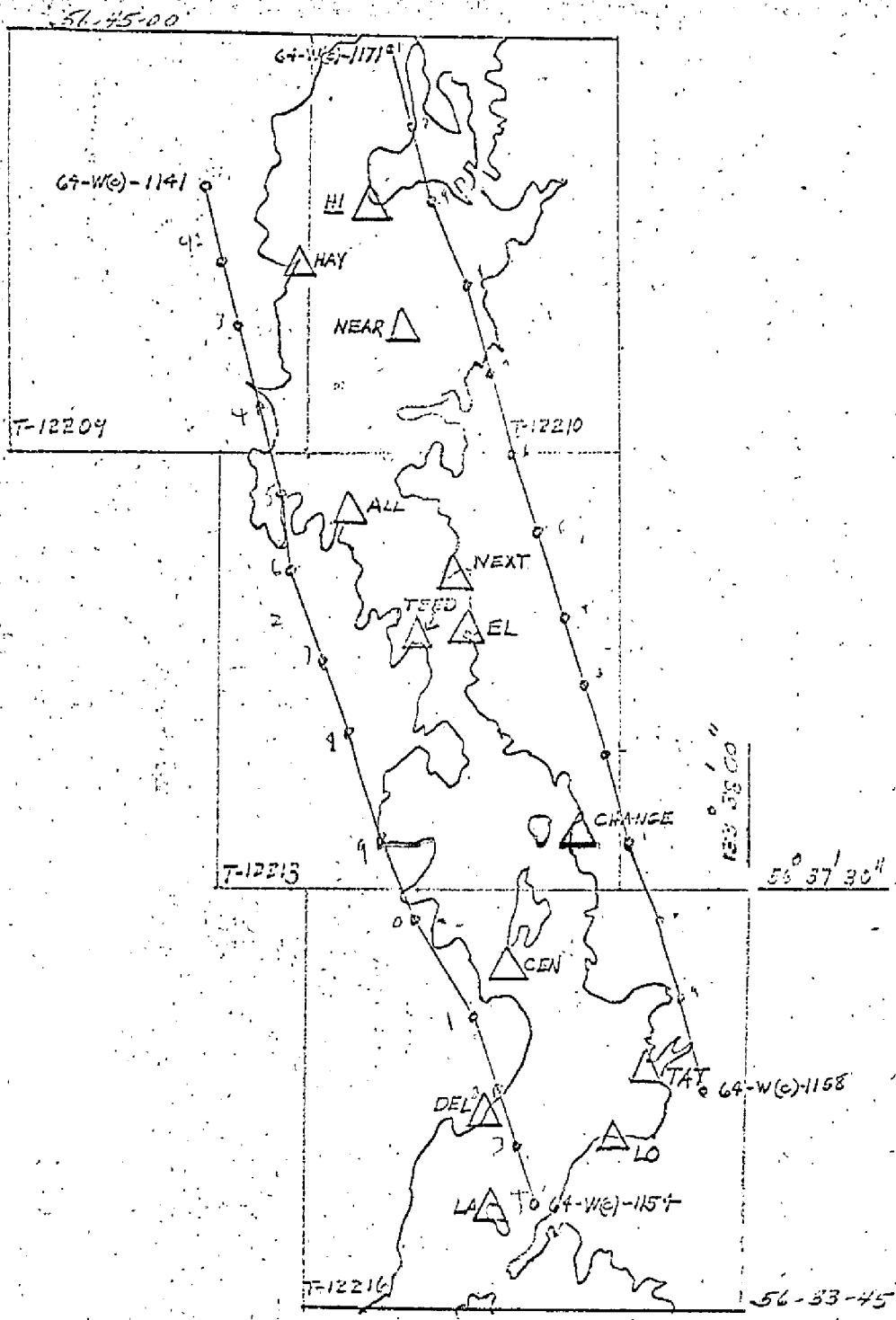



COMPILATION REPORT

Map Manuscript T-12812

Project PH-6206

31. DELINEATION

The Wild B-8 was used. Photography was adequate for the delineation of this manuscript.

32. CONTROL

See "Aerotriangulation Report," (Not dated)

33. SUPPLEMENTAL DATA

None

34. CONTOURS AND DRAINAGE

Contours are inapplicable. Drainage was delineated from office interpretation of the photographs.

35. SHORELINE AND ALONGSHORE DETAILS

The approximate mean lower low water line was delineated from 1964 color photographs taken at a 5.2 feet stage of tide and supplemented by 1961 photographs taken at 1 foot stage of tide.

A more defined interpretation of rocks and ledges could be ascertained from the photographs taken in 1961.

36. OFFSHORE DETAILS

Offshore details were delineated in the same manner as alongshore details.

12

37. LANDMARKS AND AIDS

38. CONTROL FOR FUTURE SURVEYS

None

39. JUNCTIONS

Satisfactory junctions were made with T-12209, scale 1:10,000 to the north and west, T-12210, scale 1:10,000 and T-12813, scale 1:5,000 to the east, T-12213, scale 1:10,000 and T-12815, scale 1:5,000 to the south.

40. HORIZONTAL AND VERTICAL ACCURACY

No statement.

46. COMPARISON WITH EXISTING MAPS

A comparison was made with USGS Quadrangle, PETERSBURG (C-6), Scale 1:63,360, dated 1948.

47. COMPARISON WITH NAUTICAL CHARTS

A comparison was made with chart 8272, KEKU STRAIT, Scale 1:20,000, 2nd Edition dated November 14, 1960; Revised March 18, 1963.

ITEMS TO BE APPLIED TO NAUTICAL CHARTS IMMEDIATELY

None

ITEMS TO BE CARRIED FORWARD

None

Submitted:

*L L Graves*  
L. L. Graves  
Carto. Technician

Approved for forwarding:

*Melvin J. Umbach*  
Melvin J. Umbach, CDR, NOAA  
Chief, Photogrammetry Division, AMC

Approved:

*Alfred C. Holmes*  
Alfred C. Holmes, RADM, NOAA  
Director, Atlantic Marine Center

GEOGRAPHIC NAMES

FINAL NAME SHEET

PH-6206 (Keku Strait, Alaska)

T-12812

Keku Strait

Kuiu Island

Rocky Pass

Approved by:

*A. J. Wraight*

A. Joseph Wraight  
Chief Geographer

Prepared by:

*Frank W. Pickett*  
Frank W. Pickett  
Cartographic Technician



49. NOTES FOR THE HYDROGRAPHER:

- 1- There was no field inspection prior to compilation; therefore, occasional measurements should be made from identifiable points on the photographs to the TTMW to verify compilation.
- 2- If there are landmarks or fixed aids to navigation within the area of this map, investigate and submit Form 567.
- 3- Give character of foreshore areas (sand, mud, etc.).
- 4- Foul, shoal, and reef areas and rocks shown on this manuscript were determined by office interpretation of aerial photographs of the area. Their existence and extent should be verified by the hydrographer. If a foul, shoal, or reef area or rock does not exist, this fact should be noted on the Field Edit Ozalid.
- 5- See Field Edit Ozalid for other notes.

PHOTOGRAMMETRIC OFFICE REVIEW

T-12812

15

1. PROJECTION AND GRIDS LLG		2. TITLE LLG		3. MANUSCRIPT NUMBERS LLG		4. MANUSCRIPT SIZE LLG	
CONTROL STATIONS							
5. HORIZONTAL CONTROL STATIONS OF THIRD-ORDER OR HIGHER ACCURACY LLG				6. RECOVERABLE HORIZONTAL STATIONS OF LESS THAN THIRD-ORDER ACCURACY (Topographic stations) X		7. PHOTO HYDRO STATIONS X	
8. BENCH MARKS X		9. PLOTTING OF SEXTANT FIXES X		10. PHOTOGRAMMETRIC PLOT REPORT W.O.		11. DETAIL POINTS LLG	
ALONGSHORE AREAS (Nautical Chart Data)							
12. SHORELINE LLG		13. LOW-WATER LINE LLG		14. ROCKS, SHOALS, ETC. LLG		15. BRIDGES X	
16. AIDS TO NAVIGATION X		17. LANDMARKS X		18. OTHER ALONGSHORE PHYSICAL FEATURES LLG		19. OTHER ALONGSHORE CULTURAL FEATURES LLG	
PHYSICAL FEATURES							
20. WATER FEATURES LLG				21. NATURAL GROUND COVER X		22. PLANETABLE CONTOURS X	
23. STEREOSCOPIC INSTRUMENT CONTOURS X		24. CONTOURS IN GENERAL X		25. SPOT ELEVATIONS X		26. OTHER PHYSICAL FEATURES X	
CULTURAL FEATURES							
27. ROADS X		28. BUILDINGS X		29. RAILROADS X		30. OTHER CULTURAL FEATURES X	
BOUNDARIES							
31. BOUNDARY LINES X				32. PUBLIC LAND LINES X			
MISCELLANEOUS							
33. GEOGRAPHIC NAMES LLG			34. JUNCTIONS LLG			35. LEGIBILITY OF THE MANUSCRIPT LLG	
36. DISCREPANCY OVERLAY LLG		37. DESCRIPTIVE REPORT LLG		38. FIELD INSPECTION PHOTOGRAPHS X		39. FORMS CHB	
40. REVIEWER J.L. Graves				SUPERVISOR, REVIEW SECTION OR UNIT Albert C. Rauck, Jr.			
41. REMARKS (See attached sheet)							
FIELD COMPLETION ADDITIONS AND CORRECTIONS TO THE MANUSCRIPT							
42. Additions and corrections furnished by the field completion survey have been applied to the manuscript. The manuscript is now complete except as noted under item 43.							
COMPILER C. H. Bishop 12-2-69				SUPERVISOR Albert C. Rauck, Jr.			
43. REMARKS Field edit applied from: Field edit ozalid and Field Photos 64 W 1142 through 1145.							

## FIELD EDIT REPORTS

Keku Strait  
Southeast Alaska  
OPR-448

June-August 1969

INTRODUCTION

Field edit reports are attached for the following maps:

T-12812	T-12817
T-12813	T-12818
T-12814	T-12819
T-12815	T-12820
T-12816	

Field photographs and copies of the field edit ozalids were taken into the field. The mean high water line was verified by visual inspection of the shoreline and ozalids in the field. Isolated rocks, high points of ledges, ledge limits, and some shoreline were located by three-point fixes with check angles. Fixes were plotted on boat sheets:

DA-5-2-69  
DA-5-3-69  
DA-5-4-69  
DA-5-5-69

and then transferred to the T-sheets and ozalids for comparison.

Notes have been made in violet on the field photographs and have been cross-referenced on the Field Edit Ozalids by photograph number. All times are based on 105° West meridian.

Generally compilation of the maps is good. It is recommended that the maps be revised in accordance with the notes on the photographs and that the maps, with the exceptions of T-12813, T-12815, and T-12818, be accepted as advance manuscripts. Maps T-12813, T-12815, and T-12818 should be compiled using the recent photographs. It is recommended that the compiler obtain copies of the above boat sheets and use them in compiling the advance manuscripts.

Field inspection of these maps is complete except for map T-12820.

Copies of "Nonfloating Aids or Landmarks for Charts", form C&GS 567, are attached.

FIELD EDIT REPORT  
MAP T-12812

Keku Strait  
Southeast Alaska  
June 1969

Field edit of map T-12812 was done by LT Edward Gelb and Lt(jg) Bruce Fisher during June 1969. Inspection was done on foot and in a 12-foot whaler.

METHOD

Field photographs and a copy of the field edit ozalid were taken into the field. The mean high water line was verified by visual inspection of the shoreline and ozalid in the field. Isolated rocks, high points of ledges, ledge limits, and some shoreline were located by three-point fixes with check angles. Fixes were plotted on boat sheets DA-5-2-69 & DA-5-3-69 and then transferred to the T-sheet and ozalid for comparison.

Notes have been made in violet on the field photographs and have been cross-referenced on the "Field Edit Ozalid" by photograph number. All times are based on 105° West meridian. Notes are on the following photographs:

64W1142	64W1144
64W1143	64W1145

ADEQUACY OF COMPILATION

Compilation of this map is good. Hydrographic location of isolated boulders compares well to the photogrammetric location of the same boulders.

The building shown on this map does not exist.

Field inspection of this map is complete.

RECOMMENDATIONS

It is recommended that the map be revised in accordance with the notes on the photographs and that the map be accepted as an advance manuscript.

Respectfully submitted

*Bruce W. Fisher*

Bruce W. Fisher  
LTJG USESSA

APPROVAL SHEET  
for  
FIELD EDIT  
Keku Strait  
Southeast Alaska  
OPR-448  
June-August 1969

The field edit of the following manuscripts was accomplished under my supervision:

T-12812	T-12817
T-12813	T-12818
T-12814	T-12819
T-12815	T-12820
T-12816	

Frequent inspections of the field edit work and of plotted comparisons on the boat sheets were made.

*Ray E. Moses*  
Ray E. Moses  
CDR, USESSA  
Commanding Officer  
USC&GSS DAVIDSON

REVIEW REPORT T-12812

SHORELINE

May 22, 1972

61. GENERAL STATEMENT

See Summary, which is page 6 of the descriptive report.

62. COMPARISON WITH REGISTERED TOPOGRAPHIC SURVEYS

A visual comparison was made with a copy of Registered Survey No. 4341. This is a 1:10,000 scale survey made in September-October 1927 and is on a different datum than T-12812. The two surveys are in fair agreement although the delineation of the mean high water line is more detailed on T-12812.

Registered survey No. 4341 is now superseded by T-12812 for nautical chart construction purposes.

63. COMPARISON WITH MAPS OF OTHER AGENCIES

A visual comparison was made with USGS PETERSBURG (C-6), ALASKA, 1:63,360 scale quadrangle, edition of 1948. Because of its scale this survey is necessarily generalized and does not show all of the offshore features in detail.

64. COMPARISON WITH CONTEMPORARY HYDROGRAPHIC SURVEYS

Comparison was made with copies of boat sheets H-9078 (DA 5-2-69) and H-9079 (DA 5-3-69). The shoreline of the boat sheets and T-12812 are in good agreement. Many of the rocks on these two boat sheets appear to have not been verified by either the hydrographer or the field editor. The source of these rocks was probably an incomplete manuscript. During the time of final review a number of these rocks which were clearly in conflict with the hydrography or were determined to be kelp or a bottom characteristic were removed from the shoreline survey.

The mean lower low water line of the hydrographic surveys is not in complete agreement with that of T-12812. This line has been noted as approximate and retained on the shoreline survey ~~as approximate~~ for any value it may have to the nautical chart compiler.

65. COMPARISON WITH NAUTICAL CHARTS

Comparison was made with Chart 8272, 4th edition, November 21, 1970. The difference in the mean high water line of the two surveys has been indicated on the comparison print in red.

There appears to be a small difference in the position of some rocks between the two surveys. These have also been noted on the comparison print in red.

66. ADEQUACY OF RESULTS AND FUTURE SURVEYS

This survey complies with instructions and meets the National Standards of Map Accuracy.

Reviewed by:

*Leo F. Beugnet*  
Leo F. Beugnet  
Cartographer

Approved for forwarding:

*Melvin J. Umbach*  
Melvin J. Umbach, CDR, NOAA  
Chief, Photogrammetry Division, AMC

Approved:

*Alfred C. Holmes*  
Alfred C. Holmes, RADM, NOAA  
Director, Atlantic Marine Center

Approved:

Chief, Photogrammetric Branch    Chief, Coastal Mapping Division

y=1,782,000 FT.  
61-W-9426

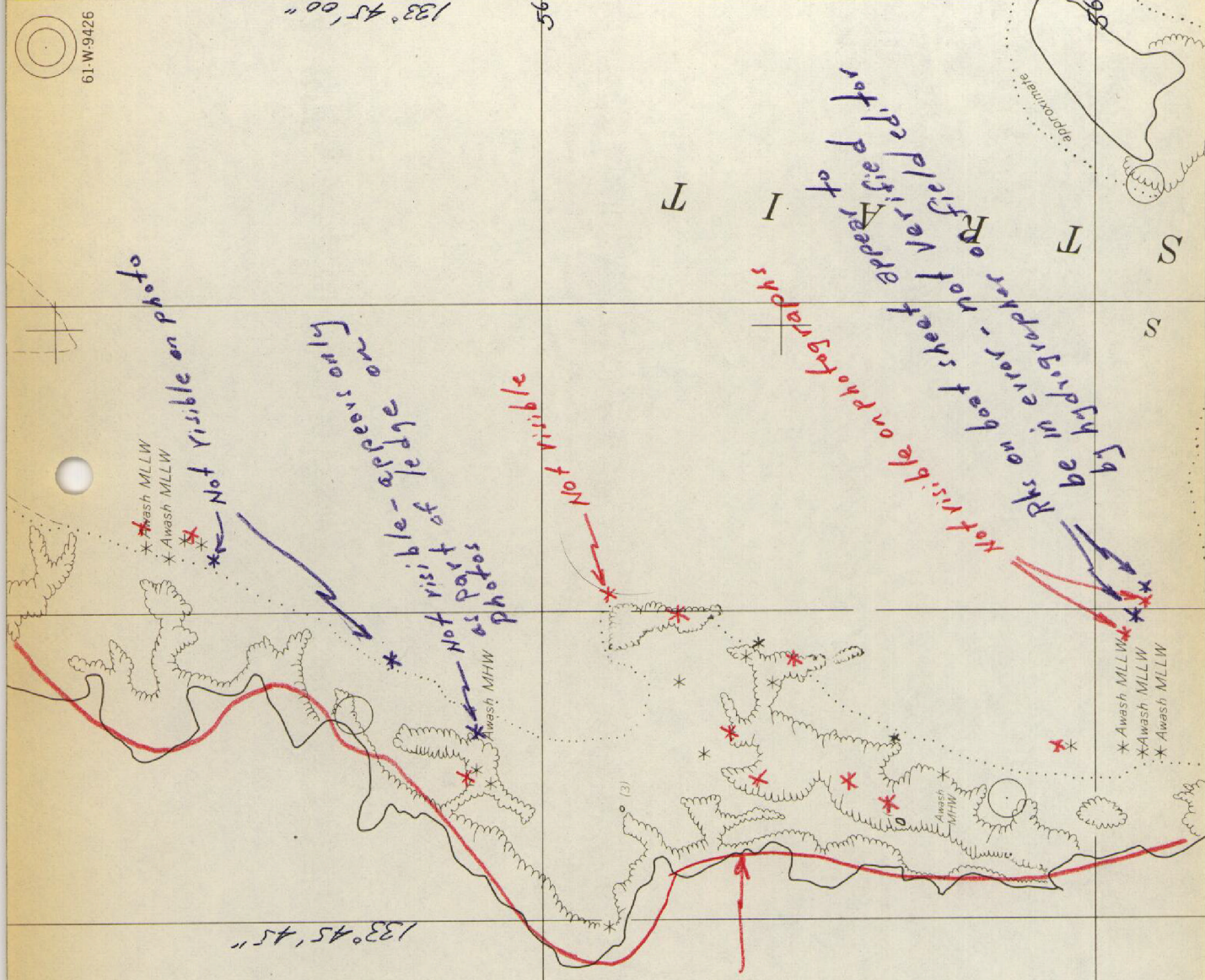

133° 45' 00"

56° 42' 30"

133° 45' 45"

Shoreline from  
Chart 8272

y=1,780,000 FT.

56° 42' 15"

T-12 812  
1:5,000

S I S I S I S I  
Not visible on photographs  
Rks on boat sheet appear to  
be in error - not verified  
by hydrographer or field editor

Not visible on photo  
Not visible - appears only  
Not visible as photos  
Awash MHW

\*Awash MLLW  
\*Awash MLLW

\*Awash MLLW  
\*Awash MLLW  
\*Awash MLLW



46° 00" x = 2,656,000 FT. | 45° 45" | 45° 30" | 45° 15" | 133° 45' 00" | 56° 43' 07.5"

y = 1,784,000 FT.

43' 00"

T-12812  
1:5000  
42' 45"

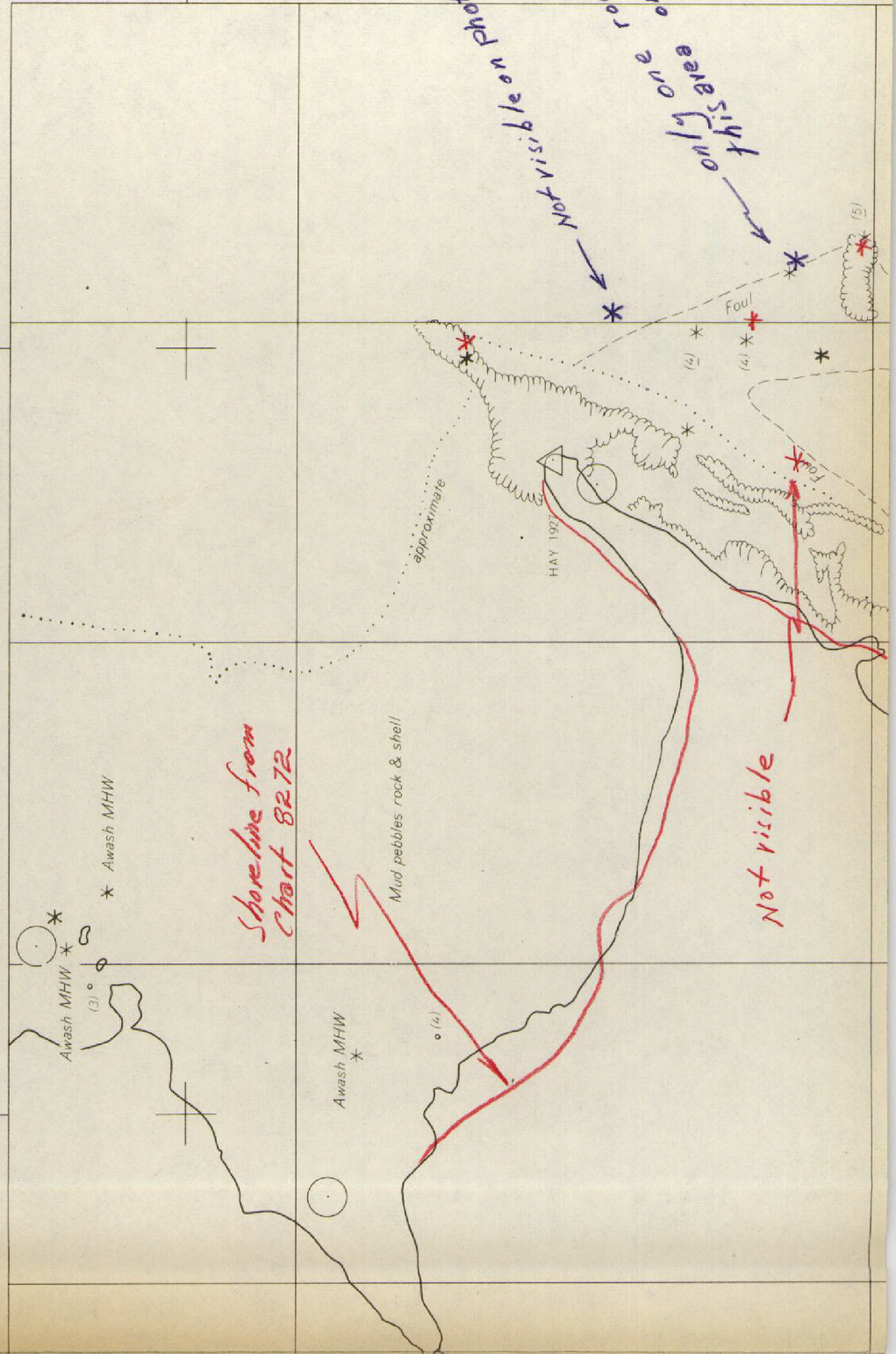



y = 1,778,000 FT.

y = 1,776,000 FT.

T-12812

1:5,000

56° 42' 00"

56° 41' 45"

133° 45' 00"

133° 45' 45"

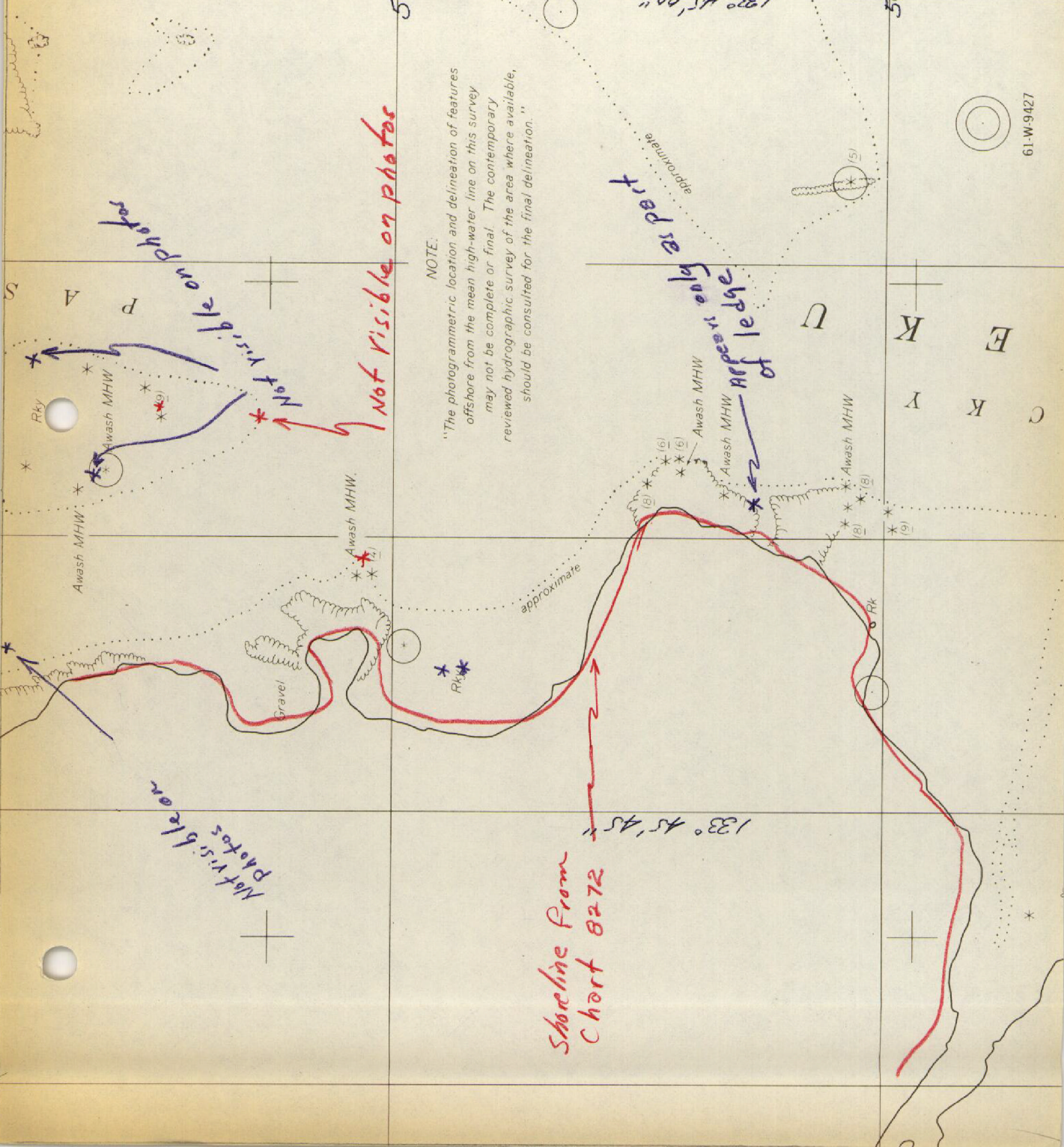

Not visible on photos

Not visible on photos

Not visible on photos

Not visible on photos

Shoreline from Chart 8272

NOTE:  
 "The photogrammetric location and delineation of features offshore from the mean high-water line on this survey may not be complete or final. The contemporary reviewed hydrographic survey of the area where available, should be consulted for the final delineation."

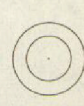

61-W-9427