

8424

Diag. Cht. No 124R-2

Form 504

U. S. COAST AND GEODETIC SURVEY

DEPARTMENT OF COMMERCE

DESCRIPTIVE REPORT

Type of Survey Air Photo Compilation

Field No. T-8424 Office No. _____

LOCALITY

State Florida

General locality Broward County

Locality West Dixie Bend

1942-45

CHIEF OF PARTY

Lt. Comdr. J. C. Bose

LIBRARY & ARCHIVES

DATE May 14, 1948

8424

DATA RECORD

T- 8424

Quadrangle (II): T-8424 West Dixie Bend Project No. (II): 312

Declination 1°15' East

Field Office: Tampa, Florida Chief of Party: J. C. Bose

Compilation Office: Tampa, Fla. Chief of Party: J. C. Bose

Instructions dated (II III):

25 May 1945

Copy filed in Descriptive
Report No. T- (VI)
Div. of Photogrammetry
Office Files

Completed survey received in office: 6-5-46

Reported to Nautical Chart Section:

Reviewed: 15 Aug. 1947 Applied to chart No. Date:

Redrafting Completed:

Registered: ~~12 Apr~~ ^{May} 1948

Published:

Compilation Scale: 1:20,300

Published Scale: 1:24,000

Scale Factor (III): 98522

Geographic Datum (III): N.A.1927 Datum Datum Plane (III): M.S.L.

Reference Station (III): Deerfield, 1934 (d.m.)

Lat.: 26°19'03".840(118.2m) Long.: 80°08'17".450(484.0m) Adjusted
~~Unadjusted~~

State Plane Coordinates (VI): Florida East Zone

X = 782,310.61 feet

Y = 722,085.06 feet

Military Grid Zone (VI) "B"

PHOTOGRAPHS (III)

<u>Number</u>	<u>Date</u>	<u>Time</u>	<u>Scale</u>	<u>Stage of Tide</u>
12167	11/25/42	11:50AM	1:20,000	+4.2
12168	"	"	"	+4.2
12169	"	"	"	+4.2
12155	"	11:21AM	"	+4.6
12156	"	"	"	+4.6
12157	"	"	"	+4.6
11927	11/14/42	1:37PM	"	+5.3
11928	"	"	"	+5.3

Tide from (III), Mayport, Hillsboro Inlet

Mean Range: 2.3

Spring Range: 2.7

Camera: (Kind or source) U.S.C.&G.S. 9 lens (8 1/2" focal length)

Field Inspection by: F. R. Elrod

date: April 14, 1945

Field Edit by: J.K. Wilson

date: Jan/June 1946

Date of Mean High Water Line Location (III); March, 1945

Projection and Grids ruled by (III) R. Dossett

date: May 1945

" " " checked by: B. H. Lyon

date: May 1945

Control plotted by: R. Dossett & J. Collins

date: May 1944-May 1945

Control checked by: B. H. Lyon & J. A. Giles

date: May 1944-May 1945

Radial Plot by: B. H. Lyon

date: May 1944-May 1945

Detailed by: R. Dossett

date: May-June 1945

Reviewed in compilation office by: J. A. Giles

date: June & Aug. 1945

MAP MANUSCRIPT
Elevations on Field Edit Sheet
checked by: J.A.R.

date: AUG. 1947

STATISTICS (III)

Land Area (Sq. Statute Miles): 66

Shoreline (More than 200 meters to opposite shore): 0.0

Shoreline (Less than 200 meters to opposite shore): 9.2

Number of Recoverable Topographic Stations established: 7

Number of Temporary Hydrographic Stations located by radial plot: None

Leveling (to control contours) - miles: 72

Roman numerals indicate whether the item is to be entered by,

(II) Field Party, (III) Compilation Party, or, (VI) the Washington Office.

When entering names of personnel on this record give the surname
and initials (not initials only).

Remarks:

MAP T. 8.424 PROJECT NO. 312-A SCALE OF MAP SCALE FACTOR

STATION	SOURCE OF INFORMATION (INDEX)	DATUM	LATITUDE OR Y-COORDINATE LONGITUDE OR X-COORDINATE		DISTANCE FROM GRID IN FEET. OR PROJECTION LINE IN METERS		DATUM CORRECTION	N.A. 1927-DATUM DISTANCE FROM GRID OR PROJECTION LINE IN METERS		FACTOR DISTANCE FROM GRID OR PROJECTION LINE IN METERS	
			FORWARD	(BACK)	FORWARD	(BACK)		FORWARD	(BACK)		
Raton, 1934	p131	NA-27	26° 22'	03.291"	101.3	(17452)					
			80° 12'	13.333"	369.6	(1293.8)					
Hammond, 1934			26	15	53446	(201.8)					
			80	12	06.885	(1478.9)					
Deerfield, 1934			26	17	03.840						
			80	08	17.450						
B-3, 1945			26	20							
			80	12							
B-4, 1945			26	19							
			80	12							
B-21, 1945			26	20							
			80	14							
			Prepared during review.								
			J.R.								

1 FT. = 3048008 METER
 COMPUTED BY: _____ DATE: _____
 CHECKED BY: _____ DATE: _____
 M-2388-12

FIELD INSPECTION REPORT

QUADRANGLE T- 8424

Project CS-312 A.

1. DESCRIPTION OF AREA:

This quadrangle is located near the east coast of Florida in Palm Beach and Broward Counties. It extends north from Eastitude 26°15'00" to Latitude 26°22'30" and west from Longitude 80°07'30" to Longitude 80°15'00". The quadrangle covers an area of approximately 66 square miles.

Important features of this area are low relief and poor drainage of large areas; particularly, the Everglades. During the rainy season large sections are inundated.

The land rises gradually from an elevation of 11 feet at the southern boundary of the sheet to an elevation of 17 and 28 feet in the north east portion.

Scattered over the southeastern part of this quadrangle, are small ridges with an underlying strata of marl. This marl is being used to improve the roads in this vicinity; consequently, the County and State are constantly creating borrow pits.

The Everglades and the adjoining cypress swamps cover a greater part of the area west of the Range Line Road. Much of the land is under cultivation, and more is being cleared for future farming.

The Hillsboro Canal, which cuts across the quadrangle diagonally, furnishes the principal means of drainage and irrigation for the farm lands.

The Range Line Road, which extends the full length of the quadrangle, from south to north, is a good second-class road.

Dense to medium dense saw-grass marshes cover the Everglades section. Cypress swamp, mixed with pine adjoins the marshes of the Everglades, with sand-pine, saw-palmetto and scrub predominating on the higher ground and smaller ridges. Intermittent ponds and small patches of cypress swamp or cypress ponds dot the higher flatlands.

2. COMPLETENESS OF FIELD INSPECTION:

Field inspection has been completed in accordance with current instructions, relating to this project. Part of this area has been inspected previously for planimetric maps in July-1944.* This area was completed so as to conform with instructions for Project CS-312. The remainder of the quadrangle was field inspected for the first time and complies with present instructions.

This project was started as a planimetric mapping project and was then converted to photographic mapping during progress of the field work and office compilation.

3. INTERPRETATION OF PHOTOGRAPHS:

Generally dark wooded areas with a profusion of white specks, indicate higher ground. Small dark isolated blotches on the photographs are intermittent ponds or small cypress swamps. The white streaks, visible through the vegetation on photograph 12167 are outcropping sections of the underlying strata of marl. In this section are large areas of stunted cypress, underlain by rock with a very thin covering of soil.

4. HORIZONTAL CONTROL:

Horizontal control in this quadrangle was recovered by the party doing field inspection and recovery for planimetric maps. Later it became necessary to establish additional control.

5. VERTICAL CONTROL:

For information on vertical control refer to Item 5 (Vertical control) Quadrangle T-8425. Levels are shown on photographs 11928 B, 12155, 12156, 12157 A, 12168 and 12169.

6. CONTOURS AND DRAINAGE:

Contouring of this quadrangle was accomplished by standard plane-table methods. All closures were within the prescribed limits of accuracy. Contours are shown on photographs 11928 B, 12155, 12156, 12157 A, 12168, and 12169. The scale of the photographs was checked frequently, while contouring was in progress. This was done by taking stadia distance between two easily identifiable points on the photographs. The contour interval for this quadrangle is 5 feet.

Elevations are shown along the top of the large spoil banks. In most cases the smaller spoil banks are without elevations, as they are less than one contour interval. Contours are shown crossing the smaller ditches and turning into the larger ones. Few water surface elevations were shown in the ditches, because the water level is controlled by dams and pumps. There appears to be no definite drainage in this quadrangle.

Elevations were placed in most of the intermittent ponds, and on the surrounding terrain. Notes have been made on the photographs to show where similar conditions exist over large areas. An example of this is shown on Photograph 12155.

ITEMS 7,8,9 and 10:

The above items are inapplicable to Quadrangle T-8424.

11. LANDMARKS AND AIDS TO NAVIGATION:

There are no landmarks recommended for charting, within the limits of this quadrangle.

12. ITEM ¹² is inapplicable to this quadrangle.

13. LANDING FIELDS AND AERONAUTICAL AIDS:

There are no landing fields or aeronautical aids appearing on this quadrangle.

14. ROAD CLASSIFICATION:

Roads have been classified according to current instructions,

15. BRIDGES:

Bridges have been classified according to instructions, by G. E. Varnadoe, Principal Photogrammetric Aid, and are shown on photographs 12169 A, 12154, and 11927 A.

16. BUILDINGS AND STRUCTURES:

All buildings to be shown have been circled in red. Deletions are inked in green.

17. BOUNDARY MONUMENTS LINES:

Palm Beach - Broward County Line is shown on photographs 12168 A and 11927 A. Precinct Boundaries are shown on photographs 12168 A, 11927 A, 12167 and 11928 A.

18. GEOGRAPHIC NAMES:

See approved list attached to this report.
This will be the subject of a separate report.

19. GENERAL NOTES:

The field inspection was completed during the driest season of the past ten years.

Names of farm roads appear on the Broward County Map.

24 section corners were recovered in this quadrangle. The section corners were recovered on contour, level and field inspection photographs. A notation has been made on the pricking cards, which will show the kind of photograph used.

Field inspection notes appear on photographs 11928 C, 12154, 12167, 12168 A and 12169 A.

Approved and Forwarded by:

Respectfully submitted,

J. C. Bose
J. C. Bose,
Chief of Party.

Frank H. Elrod
Frank H. Elrod,
Prin. Photo. Aid.

DESCRIPTIVE REPORT
TO ACCOMPANY T-8424

26 & 27 Control & Radial Plot:

A special report has been submitted under separate cover
by B. H. Lyon, Chief Engineering Draftsman.

photogrammetry
Division
In file section
under "Special Re-
ports"

28. Detailing:

The area within the following limits was originally detailed according to planimetric instructions dated January 27, 1944; Lat. $26^{\circ} 15'$ to Lat. $26^{\circ} 21' 30''$ and Long. $80^{\circ} 03'$ to Long. $80^{\circ} 12' 06''$. That portion of this quadrangle not falling within the above limits was detailed according to instructions dated Aug. 3, 1944 (War Mapping Specifications)

The following procedure was used in converting from planimetric mapping to ~~War Mapping~~ ^{photographic} Specifications.

A new projection was made covering that part of this quadrangle from Lat. $26^{\circ} 15'$ to Lat. $26^{\circ} 21' 30''$ and Long. $80^{\circ} 10'$ to Long. $80^{\circ} 15'$. All new detailing not covered by Planimetric Map T-5575, was done on the new projection. Detail on the Planimetric Map T-5575, from Lat. $26^{\circ} 17' 30''$ northward and Long. $80^{\circ} 10'$ westward was erased and recompiled on the new projection, due to a small discrepancy in the original plot. (See special report on radial plot by B. H. Lyon, Chief Engineering Draftsman. An overlay showing the vegetation according to instructions dated June 30, 1945 has been prepared and is being submitted with this sheet.

All new detail features such as new roads, borrow pits and cleared areas shown by the latest field inspection has been delineated.

The photographs were clear and of good scale.

29. Supplemental Data.

No supplemental Data was used.

30 to 35 Incl.

The above items are inapplicable to this quadrangle.

36. Landing Fields and Aeronautical Aids.

No landing fields or aeronautical aids appear on this quadrangle.

37. Bridges.

All bridges sufficiently important have ^{been} classified according to instructions for this detail.

38. Section Corners.

Twenty three (23) section corners were recovered within this quadrangle and have been located on the sheet by radial line intersections. They are shown by black crosses one-half centimeter long, with the numbers of the sections in their respective corners. Picking cards are being submitted with the sheet.

44. Comparison with Existing Topo. Quad.

No Topographic Quadrangle was available for a comparison of this area.

45. Comparison With Nautical Charts.

No comparison with Nautical Charts could be made for this quadrangle, as charts 1248 and 847 do not extend far enough inland to cover this area.

Respectfully submitted

Rudolph Dossett
Rudolph Dossett
Prin. Photogrammetric Aid

Forwarded

J. C. Bose
J. C. Bose, Chief of Party

FIELD EDIT REPORT
QUADRANGLE T-8424
PROJECT CS-312A

46. METHODS.

In checking the map compilation all roads were traversed by truck. Walking was necessary in a number of places because of the sandiness of some of the road 4's. All buildings, ditches, roads etc. that were added were plotted from topographic features except in areas where new developments had been made and these were added by planetable methods.

47. ADEQUACY OF THE COMPILATION.

The compilation was adequate and complete except for a few details omitted during drafting and field inspection. Many 4th class roads that were marked on the field inspection photographs were omitted on the compilation. Many of these roads should be added and sufficient notes to add them will be found on the field edit sheet or cross referenced to the photographs.

Many canals and ditches along roads were not shown on the field inspection photographs. These ditches and canals follow parallel to the roads as close as the draftsman can draft them and in most instances can be seen easily on the photographs. No contours have been shown along these ditches and canals because of the changes of the water level. See field edit report of T-8427 for water level changes.

These ditches and canals are self explanatory regarding depressions.

Many small ditches have been deleted in the south-western portion of this quadrangle. These ditches are from 1 to 4 feet wide and are only temporary ditches. The farmer uses them for irrigation purposes and most of them don't exist after a period of two years.

There is usually some spoil along all of the ditches. Most of the spoil along the smaller ditches is of a temporary nature, so therefore the spoil that appears on the compilation is usually along the larger ditches and canals.

Many areas are being cleared for cultivation at this time.

The railroad spur at Latitude $26^{\circ}-18'$ and Longitude $80^{\circ}-09'$ has been changed since the field inspection.

Attention is called to the 15 foot contour at Latitude $26^{\circ}-18' - 30''$ and Longitude $80^{\circ}-09' - 30''$. This contour is correct as of now, but in the near future it may not exist because of the active borrow pit nearby.

Attention is called to the borrow pit at Latitude $26^{\circ}-15' - 30''$ and Longitude $80^{\circ}-08' - 30''$. The road still exists and is still subject to change. This road can be deleted if desired. The contour that stops at the borrow pit edge is correct. If desired this contour can be drawn along edge of pit. This contour is also subject to change at any time. The other end of the 15 foot contour near the railroad is correct as shown on the photograph. The railroad is higher than surrounding ground.

Attention is called to the 6 ponds at Latitude $26^{\circ}-16' - 30''$ and Longitude $80^{\circ}-12' - 30''$. These ponds have been detailed

on the photograph. The 15 foot depression contours follow the shoreline of each pond.

48. ACCURACY TESTS.

No vertical accuracy test was run in this quadrangle. See field edit report of T-8425.

49. WOODLAND.

Woodland was checked during the field edit and the overlay made by the Tampa office was very good.

14. ROAD CLASSIFICATION.

All roads were reclassified according to the new instructions dated June 30, 1945.

18. GEOGRAPHIC NAMES.

The geographic names were submitted in a special report by Mr. Lowell I. Bass in July 1944.

Attention is called to the Seaboard Railroad. See field edit report of quadrangle T-8427.

50. JUNCTIONS.

Enclosed with this field edit sheet is a copy of T-8426 with the junctions of canals and ditches.

Respectfully submitted,

JOSEPH K. WILSON,
Photogrammetric Aid.

Forwarded:

J. C. Bose, Chief of Party.

*Most of the field edit corrections were made
on the manuscript by the Tampa Compiling Office.
J.R.*

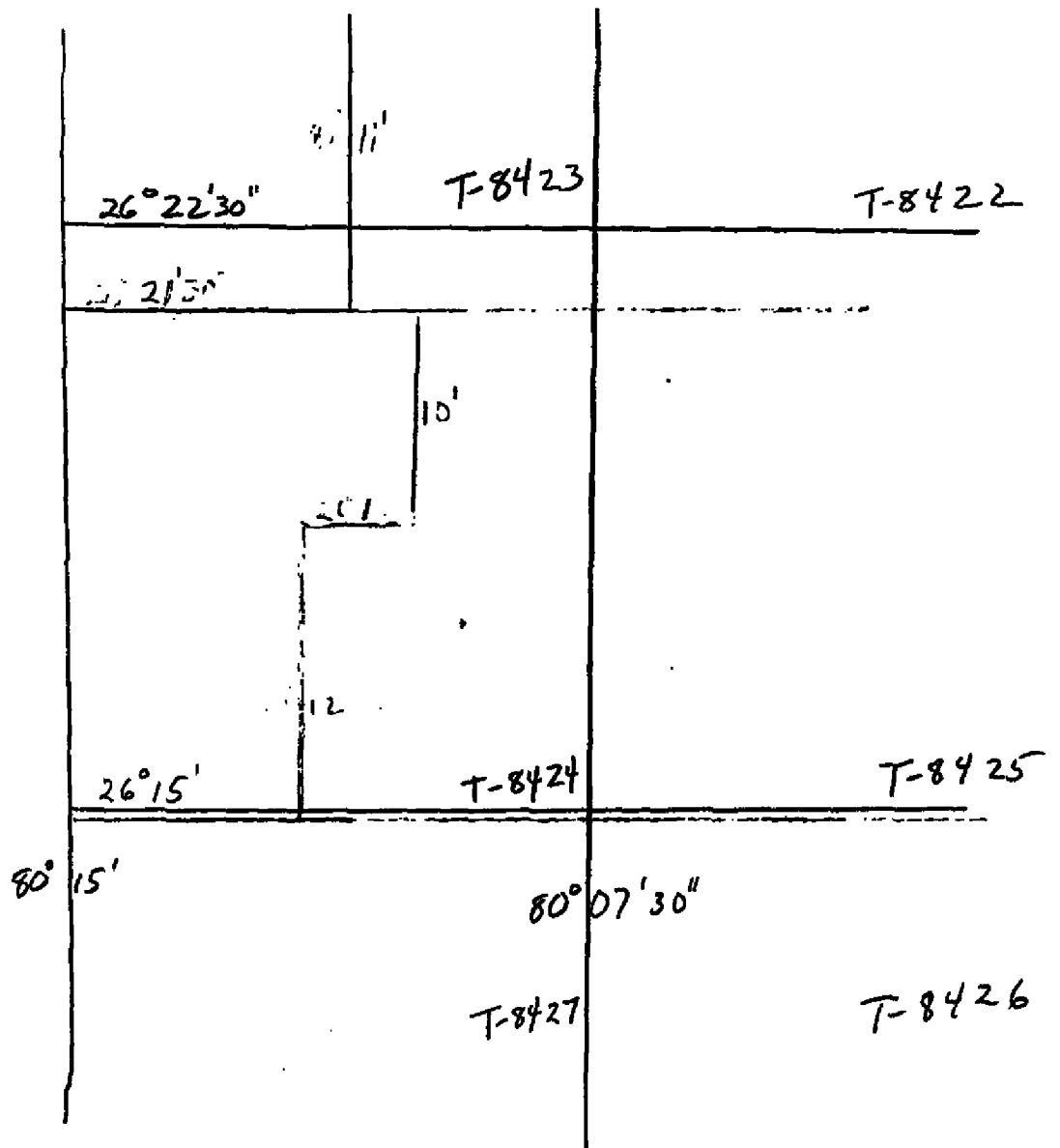

The four pieces of the ^{map} manuscript for T-8424 are indicated by the lines in red.

Division of Photogrammetry
Review Report of
Topographic Map Manuscript T-8424

The map manuscript for this quadrangle has been compiled in four parts. A sketch of the quadrangle is included in this report. *Following review a new manuscript T8421 was drafted from the original four sections.*

Subject numbers not used in this report have been adequately covered in other parts of the Descriptive Report.

28. Detailing. -

The compilation office made vegetation overlays for three of the four pieces of the map manuscript. Additions and corrections to the vegetation classification in these areas were made on the overlays. Changes were made on the map manuscript in the area covered by the fourth piece.

A drafting overlay was prepared by the reviewer as an aid to the smooth draftsman. It shows road classifications, control, spot elevations, etc.

See attached copy of letter on "Redrafting"

Much of the detail on the map manuscript had become very indistinct necessitating considerable re-inking.

Areas labeled "Everglades" in the western part of the quadrangle are quite different from adjoining areas. It is recommended that the "land subject to inundation" symbol be used for these areas.

38. Section Lines. - Block lines and corners of the survey subdividing the West Palm Beach Farms were somewhat confused with the section lines and corners of the General Land Office on the map manuscript, as received from the compilation office. This situation has been clarified by the reviewer and only section lines, corners, and numbers have been shown on the map manuscript. (Ref: Letter dated 6 December 1946 from L. V. Evans.)

39. Datum. - The ^{original} compilation is on the North American datum. ^{in four parts} ~~Recommendations for transferring the compilation to the North American 1927 datum have been indicated in the Review Report of T-8421.~~

48. Accuracy Tests. - No accuracy tests were made in this quadrangle. However, the vertical accuracy test in the adjoining quadrangle, T-8425 was well within the limits of accuracy required. It is believed that this map manuscript complies with the national standard map accuracy requirements.

Reviewed by:

Jack L. Rihn

Jack L. Rihn
Photogrammetrist
15 August 1947

Reviewed under direction of:

S. V. Griffith

S. V. Griffith
Chief, Review Section

APPROVED BY:

B. A. Jones 5/48

Technical Assistant to the
Chief, Div. of Photogrammetry

R. S. ...

Chief, Nautical Chart Br.
Division of Charts

K. T. Adams

Chief, Div. of Photogrammetry

C. K. Green

Chief, Div. of Coastal Surveys

This map manuscript was forwarded to the Tampa Office, subsequent to Review for redrafting on a new projection showing both datums. (See copy of letter to Lt. Comdr. Morris immediately following this Review Report).

A note in red ink, designating the datums, has been placed on the registered copy of the map manuscript. The published map will show only the North American 1927 datum.

22 December 1947

To: Lt. Comdr. George E. Morris, Jr.
U. S. Coast and Geodetic Survey
P. O. Box 1689
Tampa, Florida

Subject: Redrafting of Map Manuscripts T-8422 to T-8425 inclusive,
Project CS-312

The original manuscripts T-8422 to T-8425 inclusive, are being forwarded to you today for the drafting of new manuscripts by copying the originals.

Drafting of new manuscripts is necessary because the originals have become so illegible that it is impracticable to prepare adequate blue line copies for final reproduction drafting.

New projection bases showing both the North American and the North American 1927 polyconic projections and state grid lines, together with field edit sheets and descriptive reports of these manuscripts are also being forwarded. The new manuscripts shall be prepared by copying or tracing directly from originals onto the new projection bases.

No compilation work is contemplated and, therefore, photographs are not being forwarded. The field edit sheets are being forwarded because in some cases they may show the details somewhat more clearly than the original manuscripts.

These new manuscripts shall be drawn in the same style as were the originals, and shall not conform to Photogrammetry Instructions No. 17, with the exception of Woodland. In copying the Woodland outlines, the classification shall be combined to conform with Photogrammetry Instructions No. 15 and 17.

The assignment of this work to the Tampa Office is in no way intended as a criticism of your compilation of the original manuscripts. The poor condition of the manuscripts is due largely to the fact that in accordance with instructions from the Washington Office they were converted from planimetric manuscripts, which has been started and were unfinished at the time Project CS-312 was undertaken. The work is being assigned to the field office to relieve the Drafting Section of the Washington Office, which has a large back log of final drafting on hand.

/s/ J. H. HAWLEY
Acting Director.

New manuscript compiled in Tampa and completed 2/48

New manuscript verified by Jesse A. Giles

Inspected in the Washington Office by *Lena T. Stevens, March, 1948*

The new manuscript now supersedes the old manuscript for all future work.

GEOGRAPHIC NAMES

Survey No. T-8424

WEST DIXIE BEND

Name on Survey

	On Chart No.	On previous survey No.	On U. S. quadrangle Maps	From local information	On local Maps	P. O. Guide or Map	Rand McNally Atlas	U. S. Light List		
	A	B	C	D	E	F	G	H	K	
<u>Florida</u>									USGE	1
<u>Palm Beach County</u> ✓										2
<u>Broward County</u> ✓										3
<u>Seaboard</u> ✓										4
<u>Hillsboro Canal</u> ✓										5
<u>West Dixie Bend</u> ✓										6
<u>State 810</u>										7
<u>State No. 7</u> <u>Range Line Road</u>										8
										9
										10
										11
										12
										13
										14
										15
										16
										17
										18
										19
										20
										21
										22
										23
										24
										25
										26
										27

Names underlined in red are approved. 4/9/48 L. Beck.